

WATER WELL RECORD

Form WWC-5

Division of Water Resources App. No.

Well ID

MW10

Original Record Correction Change in Well Use

1 LOCATION OF WATER WELL: County Franklin Fraction NE 1/4 SE 1/4 NE 1/4 NE 1/4 Section Number 11 Township Number T 17 S Range Number R 19 E W
2 WELL OWNER: Last Name: Business: KDHE Address: 1000 SW Jackson Blvd City: Topeka State: KS ZIP: 66612 Street or Rural Address where well is located (if unknown, distance and direction from nearest town or intersection): 1621 S. Main. St., Ottawa, KS
3 LOCATE WELL WITH "X" IN SECTION BOX: [Diagram showing section box with 'X' in NE corner]
4 DEPTH OF COMPLETED WELL: 29 ft Depth(s) Groundwater Encountered: 1) 1 ft 2) ft 3) ft, or 4) Dry Well WELL'S STATIC WATER LEVEL: 23.8 ft. [X] below land surface, measured on (mo-day-yr) 12/21/21
5 Latitude: 38.59191 (decimal degrees) Longitude: 95.26833 (decimal degrees) Horizontal Datum: [X] WGS 84 [] NAD 83 [] NAD 27 Source for Latitude/Longitude: [] GPS (unit make/model:) (WAAS enabled? [] Yes [] No) [X] Land Survey [] Topographic Map [] Online Mapper
6 Elevation 944.58 ft [] Ground Level [X] TOC Source [X] Land Survey [] GPS [] Topographic Map [] Other

7 WELL WATER TO BE USED AS:
1 Domestic: [] Household [] Lawn & Garden [] Livestock [] Irrigation [] Feedlot [] Industrial
2 Public Water Supply: well ID
3 Dewatering: how many wells?
4 Aquifer Recharge: well ID
5 Monitoring: well ID MW10
6 Environmental Remediation: well ID
7 Air Sparge [] Soil Vapor Extractor [] Recovery [] Injection
8 Oil Field Water Supply: lease
9 Test Hole: well ID
10 Cased [] Uncased [] Geotechnical
11 Geothermal: How many bores?
12 a) Closed Loop [] Horizontal [] Vertical b) Open Loop [] Surface Discharge [] Inj. of Water [] Other (specify):

Was a chemical/bacteriological sample submitted to KDHE? [] Yes [X] No If yes, date sample was submitted:
Water well disinfected? [] Yes [X] No

8 TYPE OF CASING USED: [] Steel [X] PVC [] Other CASING JOINTS: [] Glued [] Clamped [] Welded [X] Threaded
Casing diameter 2 in. to 14 ft, Diameter in. to ft, Diameter in. to ft,
Casing height above land surface -0.29 in. Weight lbs./ft. Well thickness or gauge No
TYPE OF SCREEN OR PERFORATION MATERIAL: [] Steel [] Stainless Steel [] Fiberglass [X] PVC [] Other (Specify)
[] Brass [] Galvanized Steel [] Concrete tile [] None used (open hole)
SCREEN OR PERFORATION OPENINGS ARE: [] Continuous Slot [X] Mill Slot [] Gauze Wrapped [] Torch Cut [] Drilled Holes [] Other (Specify)
[] Louvered Shutter [] Key Punched [] Wire Wrapped [] Saw Cut [] None (Open Hole)
SCREEN-PERFORATED INTERVALS: From 14 ft. to 29 ft. From ft. to ft. From ft. to ft.
GRAVEL PACK INTERVALS: From 12 ft. to 29 ft. From ft. to ft. From ft. to ft.

9 GROUT MATERIAL: [] Neat cement [] Cement grout [X] Bentonite [X] Other Concrete: 0-0.5'
Grout intervals: From 0.5 ft. to 12 ft. From ft. to ft. From ft. to ft.

Nearest source of possible contamination:
[] Septic Tank [] Lateral Lines [] Pit Privy [] Livestock Pens [] Insecticide Storage
[] Sewer Lines [] Cess Pool [] Sewage Lagoon [X] Fuel Storage [] Abandoned Water Well
[] Watertight Sewer Lines [] Seepage Pit [] Feedyard [] Fertilizer Storage [] Oil Well / Gas Well
[] Other (Specify)
Direction from well? S Distance from well? ~45 ft

Table with 6 columns: FROM, TO, LITHOLOGIC LOG, FROM, TO, LITHO. LOG (cont.) or PLUGGING INTERVALS. Rows show depth intervals and lithology: 0-0.5 Concrete, 0.5-19.5 Clay, 19.5-24 Fatty clay, 24-29 Silty clay.

Notes: KDHE ID: Kicks 66; U4-030-15093
Target of monitoring well is shallow groundwater, <20' of grout was installed at the direction of KDHE.

11 CONTRACTOR'S OR LANDOWNER'S CERTIFICATION: This water well was [X] constructed, [] reconstructed, or [] plugged under my jurisdiction and was completed on (mo-day-year) 11/12/21 and this record is true to the best of my knowledge and belief. Kansas Water Well Contractor's License No 757 This Water Well Record was completed on (mo-day-year) 2/16/22 under the business name of Larsen & Associates, Inc. Signature: [Signature]

NOTE: Figures exhibited within this report are only to be used within the context of this report. Placement of property lines, wells, structures, and roads is based on the available information from county appraiser maps, surveys, site visits, and/or previous vendor reports and should be considered approximate.

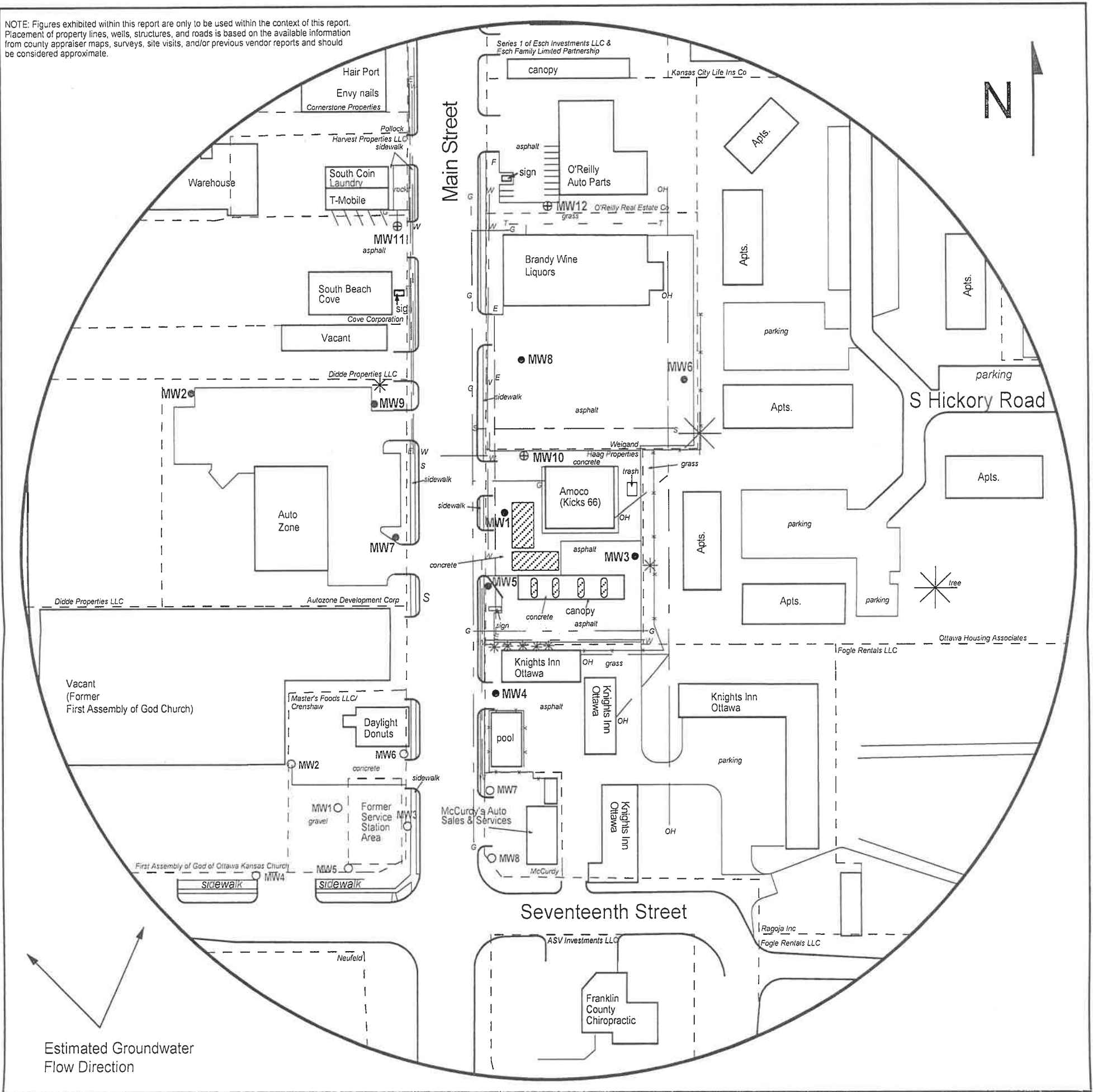

FIGURE 2.2 - 500 FT RADIUS AREA BASE MAP

LEGEND:

- Approximate Location of Active UST Basin and Pump Islands
- Approximate Location of Property Line
- Existing Monitoring Well
- Plugged Well
- Monitoring Well (Installed 11/12/21)
- Fire Hydrant
- Gas Lines (2 - 6 ft BGS)
- Overhead Lines (25-40 ft high)
- Electric Lines (2 - 6 ft BGS)
- Sewer Lines (2 - 6 ft BGS)
- Water Lines (2 - 6 ft BGS)

NOTE: Location of product active lines is unknown.
NOTE: Utility depths, heights and locations are approximate.



PROJECT:

Kicks 66
1621 South Main
Ottawa, KS
KDHE ID: U4-030-15093
Date: 12/21/21



1311 E 25th St., Suite B (785) 841-8707 office
Lawrence, KS 66046 (785) 865-4282 fax

RECEIVED
FEB 23 2022
BUREAU OF WATER