

WATER WELL RECORD

Form WWC-5

Division of Water Resources App. No.

Well ID

MW11

Original Record Correction Change in Well Use

1 LOCATION OF WATER WELL: County Franklin Fraction SW 1/4 NE 1/4 NE 1/4 NE 1/4 Section Number 11 Township Number T 17 S Range Number R 19 E W

2 WELL OWNER: Last Name: Business: KDHE Address: 1000 SW Jackson Blvd City: Topeka State: KS ZIP: 66612 Street or Rural Address where well is located: 1608 S. Main. St., Ottawa, KS

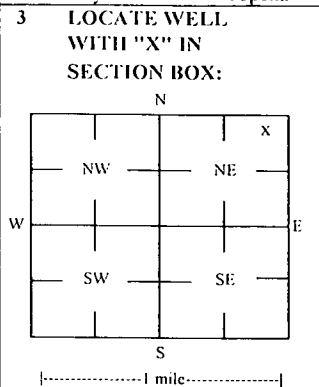

3 LOCATE WELL WITH "X" IN SECTION BOX: 4 DEPTH OF COMPLETED WELL: 26 ft Depth(s) Groundwater Encountered: 1) 26 ft 2) 3) 4) Dry Well WELL'S STATIC WATER LEVEL: Dry ft. X below land surface, measured on (mo-day-yr) 12/21/21

5 Latitude: 38.59211 (decimal degrees) Longitude: 95.26900 (decimal degrees) Horizontal Datum: X WGS 84 NAD 83 NAD 27 Source for Latitude/Longitude: GPS (unit make/model:) (WAAS enabled? Yes No) X Land Survey Topographic Map Online Mapper

6 Elevation: 946.05 ft Ground Level: X TOC Source: X Land Survey GPS Topographic Map Other

7 WELL WATER TO BE USED AS: 1 Domestic: Household Lawn & Garden Livestock Irrigation Feedlot Industrial 2 Public Water Supply: well ID 3 Dewatering: how many wells? 4 Aquifer Recharge: well ID 5 Monitoring: well ID MW11 6 Environmental Remediation: well ID Air Sparge Soil Vapor Extractor Recovery Injection 7 Oil Field Water Supply: lease 8 Test Hole: well ID Cased Uncased Geotechnical 9 Geothermal: How many bores? a) Closed Loop Horizontal Vertical b) Open Loop Surface Discharge Inj. of Water Other (specify):

Was a chemical/bacteriological sample submitted to KDHE? Yes No X No If yes, date sample was submitted: Water well disinfected? Yes No X No

8 TYPE OF CASING USED: Steel PVC Other CASING JOINTS: Glued Clamped Welded X Threaded Casing diameter 2 in. to 11 ft, Diameter in. to ft, Diameter in. to ft, Casing height above land surface -0.56 in. Weight lbs./ft. Well thickness or gauge No TYPE OF SCREEN OR PERFORATION MATERIAL: Steel Stainless Steel Fiberglass PVC Other (Specify) Brass Galvanized Steel Concrete tile None used (open hole) SCREEN OR PERFORATION OPENINGS ARE: Continuous Slot X Mill Slot Gauze Wrapped Torch Cut Drilled Holes Other (Specify) Louvered Shutter Key Punched Wire Wrapped Saw Cut None (Open Hole) SCREEN-PERFORATED INTERVALS: From 11 ft. to 26 ft, From ft. to ft, From ft. to ft, GRAVEL PACK INTERVALS: From 9 ft. to 26 ft, From ft. to ft, From ft. to ft,

9 GROUT MATERIAL: Neat cement Cement grout X Bentonite X Other Concrete: 0-0.5' Grout intervals: From 0.5 ft. to 9 ft, From ft. to ft, From ft. to ft,

Nearest source of possible contamination: Septic Tank Lateral Lines Pit Privy Livestock Pens Insecticide Storage Sewer Lines Cess Pool Sewage Lagoon X Fuel Storage Abandoned Water Well Watertight Sewer Lines Seepage Pit Feedyard Fertilizer Storage Oil Well / Gas Well Other (Specify) Direction from well? SE Distance from well? ~280 ft

Table with columns: FROM, TO, LITHOLOGIC LOG, FROM, TO, LITHO. LOG (cont.) or PLUGGING INTERVALS. Rows: 0-0.5 Asphalt, 0.5-5 Clay, 5-24 Fatty clay, 24-26 Limestone

Notes: KDHE ID: Kicks 66; U4-030-15093 Target of monitoring well is shallow groundwater, <20' of grout was installed at the direction of KDHE.

11 CONTRACTOR'S OR LANDOWNER'S CERTIFICATION: This water well was X constructed, reconstructed, or plugged under my jurisdiction and was completed on (mo-day-year) 11/12/21 and this record is true to the best of my knowledge and belief. Kansas Water Well Contractor's License No 757 This Water Well Record was completed on (mo-day-year) 2/16/22 under the business name of Larsen & Associates, Inc. Signature

DENNIS L HANDKE

1820 NW 59th Terrace
TOPEKA, KANSAS 66618
785-286-4047 Home

Jess Chapman
Larsen & Associates
1311 E. 25th Street, Suite B
Lawrence, Kansas, 66046

November 19, 2021

RE: Monitor Well Elevation Survey
1621 S. Main, Ottawa, Kansas

Proj. 21-00NN
Kicks 66
U4-030-15093

Bench Mark: Square cut on West center of concrete storm inlet at NW Corner of property.
Elev: 944.83 North 4453.83 West 246.68 (from SE Cor. Sec. 11-17-19E)

MW-10	rim	944.87	North	4585.77	NE1/4,SE1/4,NE1/4,NE1/4
	top pipe	944.58	West	131.39	Lat= 38.59191 Long = 95.26833
MW-11	rim	946.61	North	4660.06	SW1/4,NE1/4,NE1/4,NE1/4
	top pipe	946.05	West	321.93	Lat= 38.59211 Long = 95.26900
MW-12	rim	946.15	North	4673.26	SE1/4,NE1/4,NE1/4,NE1/4
	top pipe	945.86	West	194.10	Lat= 38.59115 Long = 95.26855

Lat & Long derived from Ottawa South 7.5' quad map. WGS84

Elevation established from existing project.

If you have any questions, please feel free to call me. Thank you for the opportunity to be of service to you.

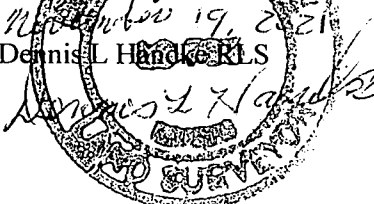
November 19, 2021
Dennis L Handke RLS

BUREAU OF WATER
FEB 23 2022
RECEIVED

NOTE: Figures exhibited within this report are only to be used within the context of this report. Placement of property lines, wells, structures, and roads is based on the available information from county appraiser maps, surveys, site visits, and/or previous vendor reports and should be considered approximate.

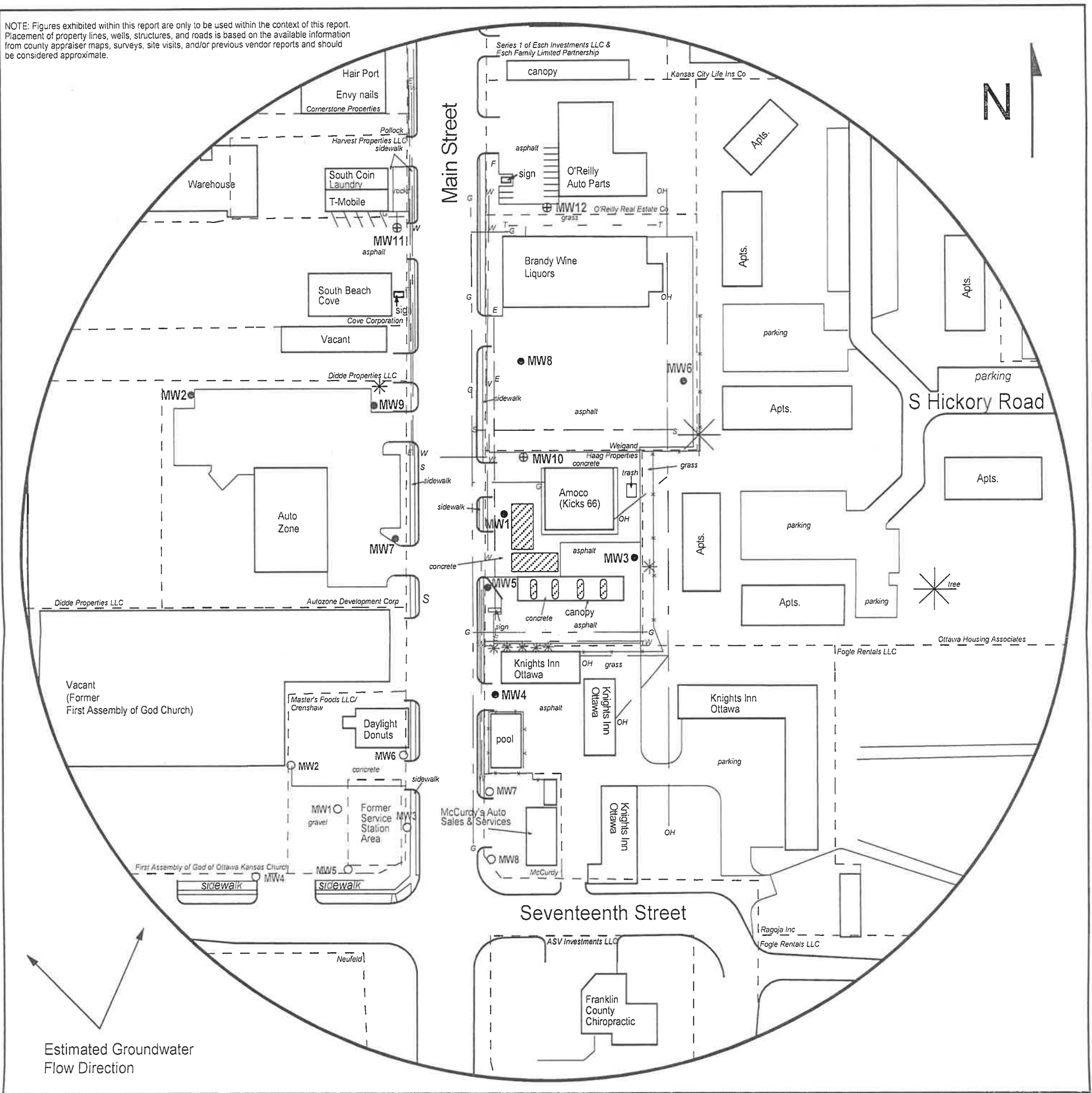

FIGURE 2.2 - 500 FT RADIUS AREA BASE MAP

LEGEND:

- Approximate Location of Active UST Basin and Pump Islands
- Approximate Location of Property Line
- Existing Monitoring Well
- Plugged Well
- Monitoring Well (Installed 11/12/21)
- Fire Hydrant
- Gas Lines (2 - 6 ft BGS)
- Overhead Lines (25-40 ft high)
- Electric Lines (2 - 6 ft BGS)
- Sewer Lines (2 - 6 ft BGS)
- Water Lines (2 - 6 ft BGS)

NOTE: Location of product active lines is unknown.
NOTE: Utility depths, heights and locations are approximate.



PROJECT:

Kicks 66
1621 South Main
Ottawa, KS
KDHE ID: U4-030-15093
Date: 12/21/21



1311 E 25th St., Suite B (785) 841-8707 office
Lawrence, KS 66046 (785) 865-4282 fax

RECEIVED
FEB 23 2022
BUREAU OF WATER