

WATER WELL RECORD

Form WWC-5

Division of Water Resources App. No.

1 LOCATION OF WATER WELL: County: Miami	Fraction SE ¼ SE ¼ SE ¼ ¼	Section Number 2	Township No. T 17 S	Range Number R 21 <input checked="" type="checkbox"/> E <input type="checkbox"/> W
Street/Rural Address of Well Location; if unknown, distance & direction from nearest town or intersection: If at owner's address, check here <input type="checkbox"/> 295th & Pleasant Valley Road		Global Positioning System (GPS) information: Latitude: 38.593664 (in decimal degrees) Longitude: 95.0471 (in decimal degrees) Elevation: Datum: <input type="checkbox"/> WGS 84, <input type="checkbox"/> NAD 83, <input checked="" type="checkbox"/> NAD 27 Collection Method: <input type="checkbox"/> GPS unit (Make/Model:) <input type="checkbox"/> Digital Map/Photo, <input type="checkbox"/> Topographic Map, <input checked="" type="checkbox"/> Land Survey Est. Accuracy: <input type="checkbox"/> <3 m, <input type="checkbox"/> 3-5 m, <input type="checkbox"/> 5-15 m, <input type="checkbox"/> >15 m		
2 WATER WELL OWNER: Bob Busetti RR#, Street Address, Box #: PO Box 12713 City, State, ZIP Code : Shawnee Mission, KS 66282				

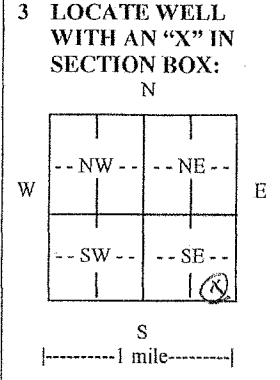

4 DEPTH OF COMPLETED WELL 100 ft.

Depth(s) Groundwater Encountered (1) 63 ft. (2) ft. (3) ft.

WELL'S STATIC WATER LEVEL 47 ft. below land surface measured on mo/day/yr.

Pump test data: Well water was ft. after hours pumping gpm

EST. YIELD ±/- 3 gpm. Well water was ft. after hours pumping gpm

Bore Hole Diameter 10 in. to 100 ft., and in. to ft.

WELL WATER TO BE USED AS: Public water supply Geothermal Injection well
 Domestic Feedlot Oil field water supply Dewatering Other (Specify below)
 Irrigation Industrial Domestic-lawn & garden Monitoring well

Was a chemical/bacteriological sample submitted to Department? Yes No

If yes, mo/day/yr sample was submitted.

Water well disinfected? Yes No

5 TYPE OF CASING USED: Steel PVC Other

CASING JOINTS: Glued Clamped Welded Threaded

Casing diameter 6.5/8 in. to 100 ft., Diameter in. to ft., Diameter in. to ft.

Casing height above land surface 18" in., Weight 220 PSI lbs./ft., Wall thickness or gauge No. SCH 40

TYPE OF SCREEN OR PERFORATION MATERIAL:

Steel Stainless Steel PVC Other (Specify)
 Brass Galvanized Steel None used (open hole)

SCREEN OR PERFORATION OPENINGS ARE:

Continuous slot Mill slot Gauze wrapped Torch cut Drilled holes None (open hole)
 Louvered shutter Key punched Wire wrapped Saw cut Other (specify)

SCREEN-PERFORATED INTERVALS: From 70 ft. to 90 ft., From ft. to ft.
 From ft. to ft., From ft. to ft.

GRAVEL PACK INTERVALS: From 20 ft. to 100 ft., From ft. to ft.
 From ft. to ft., From ft. to ft.

6 GROUT MATERIAL: Neat cement Cement grout Bentonite Other

Grout Intervals: From 0 ft. to 20 ft., From ft. to ft., From ft. to ft.

What is the nearest source of possible contamination:

Septic tank Lateral lines Pit privy Livestock pens Insecticide storage Other (specify below)
 Sewer lines Cesspool Sewage lagoon Fuel storage Abandoned water well
 Watertight sewer lines Seepage pit Feedyard Fertilizer storage Oil well/gas well None Yet

Direction from well Distance from well

FROM	TO	LITHOLOGIC LOG	FROM	TO	LITHO. LOG (cont.) or PLUGGING INTERVALS
0	3	Clay			
3	26	Limestone			
26	63	Shale			
63	65	Slate			
65	83	Shale			
83	100	Limestone			

7 CONTRACTOR'S OR LANDOWNER'S CERTIFICATION: This water well was constructed, reconstructed, or plugged under my jurisdiction and was completed on (mo/day/year) 5/14/10 and this record is true to the best of my knowledge and belief.

Kansas Water Well Contractor's License No. 595 This Water Well Record was completed on (mo/day/year) 10/18/10 under the business name of Jesse Yoakum Well Drilling by (signature) Jesse Yoakum

INSTRUCTIONS: Use typewriter or ball point pen. PLEASE PRESS FIRMLY and PRINT clearly. Please fill in blanks and check the correct answers. Send three copies (white, blue, pink) to Kansas Department of Health and Environment, Bureau of Water, Geology Section, 1000 SW Jackson St., Suite 420, Topeka, Kansas 66612-1367. Telephone 785-296-5522. Send one copy to WATER WELL OWNER and retain one for your records. Include fee of \$5.00 for each constructed well. Visit us at <http://www.kdheks.gov/waterwell/index.html>.