

**WATER WELL RECORD**

**Form WWC-5**

Division of Water Resources App. No.  

**1 LOCATION OF WATER WELL:** Fraction NW 1/4 SE 1/4 SE 1/4 SE 1/4 Section Number 31 Township No. T 17 S Range Number R 24 E  NE  W

County: Miami

Street/Rural Address of Well Location; if unknown, distance & direction from nearest town or intersection: If at owner's address, check here  **Global Positioning System (GPS) information:**  
 Latitude: ..... (in decimal degrees)  
 Longitude: ..... (in decimal degrees)  
 Elevation: .....  
 Datum:  WGS 84,  NAD 83,  NAD 27  
 Collection Method:  
 GPS unit (Make/Model: .....)  
 Digital Map/Photo,  Topographic Map,  Land Survey  
 Est. Accuracy:  <3 m,  3-5 m,  5-15 m,  >15 m

**2 WATER WELL OWNER:** Tim Porter  
 RR#, Street Address, Box #: 17652 335<sup>th</sup> St  
 City, State, ZIP Code: Paola, KS 66071

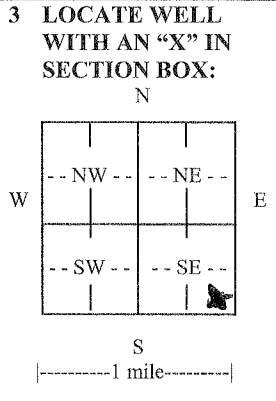

**4 DEPTH OF COMPLETED WELL** 350 ft. 4-350' bores

Depth(s) Groundwater Encountered (1) None ft. (2)..... ft. (3)..... ft.  
 WELL'S STATIC WATER LEVEL None ft. below land surface measured on mo/day/yr.....  
 Pump test data: Well water was.....ft. after..... hours pumping..... gpm  
 EST. YIELD None gpm. Well water was.....ft. after..... hours pumping..... gpm  
 Bore Hole Diameter 6 in. to 350 ft., and .....in. to .....ft.  
 WELL WATER TO BE USED AS:  Public water supply  Geothermal  Injection well  
 Domestic  Feedlot  Oil field water supply  Dewatering  Other (Specify below)  
 Irrigation  Industrial  Domestic-lawn & garden  Monitoring well Closed loop  
 Was a chemical/bacteriological sample submitted to Department?  Yes  No  
 If yes, mo/day/yr sample was submitted.....  
 Water well disinfected?  Yes  No

**5 TYPE OF CASING USED:**  Steel  PVC  Other H.D. Polyethylene

CASING JOINTS:  Glued  Clamped  Welded  Threaded Fusion  
 Casing diameter 1 in. to 350 ft., Diameter ..... in. to ..... ft., Diameter ..... in. to ..... ft.  
 Casing height above land surface 3.6 in., Weight SDR11 lbs./ft., Wall thickness or gauge No. 160 PST  
 TYPE OF SCREEN OR PERFORATION MATERIAL: None  
 Steel  Stainless Steel  PVC  Other (Specify) .....  
 Brass  Galvanized Steel  None used (open hole)  
 SCREEN OR PERFORATION OPENINGS ARE None  
 Continuous slot  Mill slot  Gauze wrapped  Torch cut  Drilled holes  None (open hole)  
 Louvered shutter  Key punched  Wire wrapped  Saw cut  Other (specify) .....  
 SCREEN-PERFORATED INTERVALS: From..... ft. to ..... ft., From..... ft. to ..... ft.  
 GRAVEL PACK INTERVALS: From..... ft. to ..... ft., From..... ft. to ..... ft.

**6 GROUT MATERIAL:**  Neat cement  Cement grout  Bentonite  Other .....

Grout Intervals: From 350 ft. to 3 ft., From..... ft. to ..... ft., From..... ft. to ..... ft.

What is the nearest source of possible contamination:  
 Septic tank  Lateral lines  Pit privy  Livestock pens  Insecticide storage  Other (specify below)  
 Sewer lines  Cesspool  Sewage lagoon  Fuel storage  Abandoned water well  
 Watertight sewer lines  Seepage pit  Feedyard  Fertilizer storage  Oil well/gas well .....

Direction from well ..... Distance from well .....

FROM	TO	LITHOLOGIC LOG	FROM	TO	LITHO. LOG (cont.) or PLUGGING INTERVALS
0	2	Soil + clay			
2	4	lime			
4	9	Clay			
9	26	Shale	350	3	4-350' Bores Plugged with High Solid Bentonite and Cement
26	35	lime			
35	61	Shale			
61	63	lime	350	250	Bentonite Grout
63	70	Shale	260	200	Cement
70	74	lime			
74	125	Shale			

**7 CONTRACTOR'S OR LANDOWNER'S CERTIFICATION:** This water well was  constructed,  reconstructed, or  plugged under my jurisdiction and was completed on (mo/day/year) 10-28-11 and this record is true to the best of my knowledge and belief.  
 Kansas Water Well Contractor's License No. 561 This Water Well Record was completed on (mo/day/year) 10-31-11  
 under the business name of Evans Energy Dev. Inc by (signature) [Signature]

**INSTRUCTIONS:** Use typewriter or ball point pen. PLEASE PRESS FIRMLY and PRINT clearly. Please fill in blanks and check the correct answers. Send three copies (white, blue, pink) to Kansas Department of Health and Environment, Bureau of Water, Geology Section, 1000 SW Jackson St., Suite 420, Topeka, Kansas 66612-1367. Telephone 785-296-5524. Send one copy to WATER WELL OWNER and retain one for your records. Include fee of \$5.00 for each constructed well. Visit us at <http://www.kdheks.gov/waterwell/index.html>.