

WATER WELL RECORD Form WWC-5

☐ Original Record ☐ Correction ☐ Change in Well Use

Division of Water
Resources App. No.

Well ID

MW-13

1 LOCATION OF WATER WELL:

County: Lyon

Fraction
SE ¼ SE ¼ SW ¼ NW ¼

Section Number
22

Township Number
T 18 S

Range Number
R 11 E W

2 WELL OWNER: Last Name:

Business: Kansas Turnpike Authority

Address: 9401 Kellogg

Address:

City: Wichita

State: KS ZIP: 67207

First:

Street or Rural Address where well is located (if unknown, distance and direction from nearest town or intersection): If at owner's address, check here: ☐
MP 132 I-335, Emporia, KS

3 LOCATE WELL WITH "X" IN SECTION BOX:

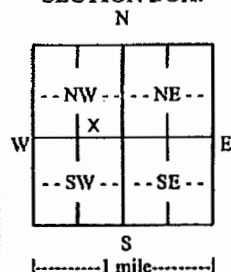

4 DEPTH OF COMPLETED WELL:

Depth(s) Groundwater Encountered: 1) 30 ft.

2) 26 ft. 3) 21 ft. or 4) ☐ Dry Well

WELL'S STATIC WATER LEVEL: 21.18 ft.

☒ below land surface, measured on (mo-day-yr) 9/16/18.

☐ above land surface, measured on (mo-day-yr)

Pump test data: Well water was ft.

after hours pumping gpm

Well water was ft.

after hours pumping gpm

Estimated Yield: gpm

Bore Hole Diameter: 8.25 in. to 30 ft. and

..... in. to ft.

5 Latitude: 38.47114 (decimal degrees)

Longitude: 96.18570 (decimal degrees)

Horizontal Datum: ☒ WGS 84 ☐ NAD 83 ☐ NAD 27

Source for Latitude/Longitude:

☐ GPS (unit make/model:)

(WAAS enabled? ☐ Yes ☐ No)

☒ Land Survey ☐ Topographic Map

☐ Online Mapper:

6 Elevation: 1160.81 ft. ☐ Ground Level ☒ TOC

Source: ☒ Land Survey ☐ GPS ☐ Topographic Map

☐ Other

7 WELL WATER TO BE USED AS:

1. Domestic:

- ☐ Household
☐ Lawn & Garden
☐ Livestock

2. ☐ Irrigation

3. ☐ Feedlot

4. ☐ Industrial

5. ☐ Public Water Supply: well ID

6. ☐ Dewatering: how many wells?

7. ☐ Aquifer Recharge: well ID

8. ☒ Monitoring: well ID MW-13

9. Environmental Remediation: well ID

☐ Air Sparge ☐ Soil Vapor Extraction

☐ Recovery ☐ Injection

10. ☐ Oil Field Water Supply: lease

11. Test Hole: well ID

☐ Cased ☐ Uncased ☐ Geotechnical

12. Geothermal: how many bores?

a) Closed Loop ☐ Horizontal ☐ Vertical

b) Open Loop ☐ Surface Discharge ☐ Inj. of Water

13. ☐ Other (specify):

Was a chemical/bacteriological sample submitted to KDHE? ☐ Yes ☒ No If yes, date sample was submitted:

Water well disinfected? ☐ Yes ☒ No

8 TYPE OF CASING USED: ☐ Steel ☒ PVC ☐ Other

Casing diameter 2 in. to 20 ft. Diameter 20 in. to 30 ft. Diameter 30 in. to 40 ft.

Casing height above land surface 0.5 in. Weight 40 lbs./ft. Wall thickness or gauge No. Sch. 40

TYPE OF SCREEN OR PERFORATION MATERIAL:

- ☐ Steel ☐ Stainless Steel ☐ Fiberglass ☒ PVC
☐ Brass ☐ Galvanized Steel ☐ Concrete tile ☐ None used (open hole)

☐ Other (Specify)

SCREEN OR PERFORATION OPENINGS ARE:

- ☐ Continuous Slot ☒ Mill Slot ☐ Gauze Wrapped ☐ Torch Cut ☐ Drilled Holes ☐ Other (Specify)
☐ Louvered Shutter ☐ Key Punched ☐ Wire Wrapped ☐ Saw Cut ☐ None (Open Hole)

SCREEN-PERFORATED INTERVALS: From 20 ft. to 30 ft. From 30 ft. to 40 ft. From 40 ft. to 50 ft.

GRAVEL PACK INTERVALS: From 18 ft. to 30 ft. From 30 ft. to 40 ft. From 40 ft. to 50 ft.

9 GROUT MATERIAL: ☐ Neat cement ☐ Cement grout ☒ Bentonite ☐ Other

Grout intervals: From 18 ft. to 16 ft. From 16 ft. to 10 ft. From 10 ft. to 5 ft.

Nearest source of possible contamination:

- ☐ Septic Tank ☐ Lateral Lines ☐ Pit Privy ☐ Livestock Pens ☐ Insecticide Storage
☐ Sewer Lines ☐ Cess Pool ☐ Sewage Lagoon ☐ Fuel Storage ☐ Abandoned Water Well
☐ Watertight Sewer Lines ☐ Seepage Pit ☐ Feedyard ☐ Fertilizer Storage ☐ Oil Well/Gas Well

☒ Other (Specify) Contaminated site U3-056-13023/-14555

Direction from well? On-site Distance from well? On-site ft.

10 FROM TO LITHOLOGIC LOG FROM TO LITHO. LOG (cont.) or PLUGGING INTERVALS

0 0.5 Asphalt

0.5 30 Silty Clay, brn to red brn, firm

TD 30

Notes:

11 CONTRACTOR'S OR LANDOWNER'S CERTIFICATION: This water well was ☐ constructed, ☐ reconstructed, or ☐ plugged under my jurisdiction and was completed on (mo-day-year) 6/25/18 and this record is true to the best of my knowledge and belief.

Kansas Water Well Contractor's License No. 585 This Water Well Record was completed on (mo-day-year) 8/14/2018

under the business name of Associated Environmental, Inc. Signature

Mail 1 white copy along with a fee of \$5.00 for each constructed well to: Kansas Department of Health and Environment, Bureau of Water, GWTS Section,

1000 SW Jackson St., Suite 420, Topeka, Kansas 66612-1367. Mail one to Water Well Owner and retain one for your records. Telephone 785-296-5524.

Visit us at <http://www.kdheks.gov/waterwell/index.html>

KSA 82a-1212

Revised 7/10/2015

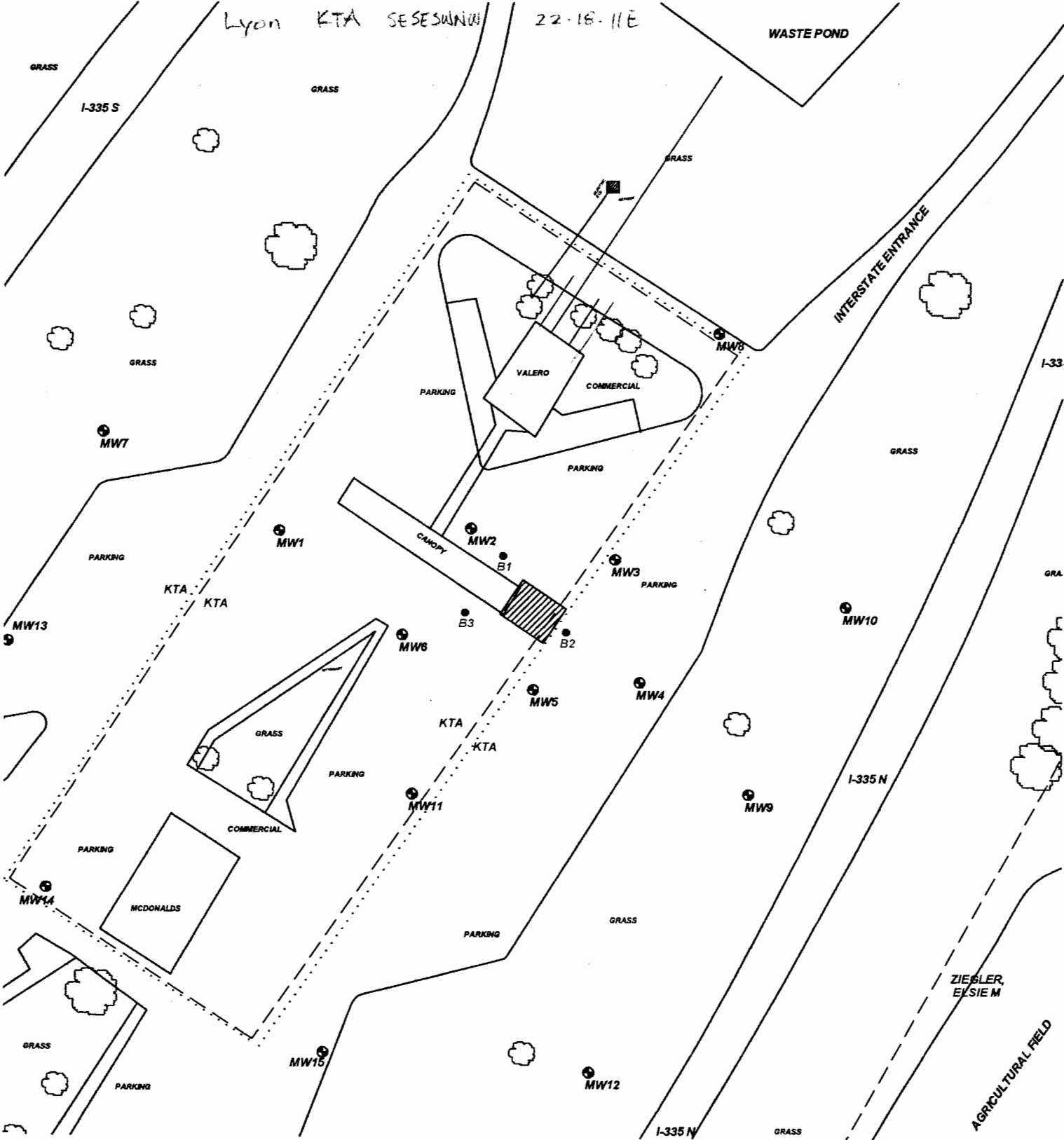

PROJECT: **COASTAL MART #1838 / EZ GO #72**

ADDRESS: **MP 132 I-335**

LOCATION: **EMPORIA, KS**

DRAWN BY: **B. STALNAKER** DATE: **3/19/18**

REVISED BY: **B. Johnson** DATE: **8/2/18**

ED JOB #: **TF510/511** KDHE JOB #: **U3-056-13023/14555**

TITLE: **FIGURE 2.1
AREA BASE MAP
350' RADIUS**

AE **ASSOCIATED
ENVIRONMENTAL
INC.**

- LEGEND:
- = ACTIVE UST BASIN
 - = MONITORING WELL
 - = SOIL BORING
 - = SUBJECT PROPERTY
 - = PARCEL BOUNDARY
 - = BURIED ELECTRIC (2-5')
 - = BURIED WATER (3-6')
 - = BURIED GAS (2-4')
 - = BURIED SEWER (2-12')
 - = BURIED CABLE (2-5')

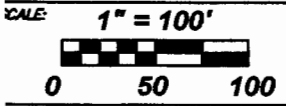

NOTES:
No basements observed within 500'.
Sample Date: 7/16/18

SMH

CONSULTANTS

July 18, 2018

Associated Environmental, Inc.
Cole Roe
404 Pottawatomie
Manhattan, Kansas 66502
Email: cole_taylor@sbcglobal.com

RE: Project No. 1807MN1182

Cole:

The following is the information requested on a Monitoring Well Site, Coastal Mart #1838 / EZ Go #72, Emporia, Lyon County, Kansas.

Point	North Coord.	East Coord.	Distance SE Cor. North	From S.22 West	Elev. Top Of Rim or PK Nail	Elev. Top of PVC Pipe	Latitude North	Longitude West
SE Corner S.22-T18S-R11E	5000	5000						
MW13	7711.75	753.17	2711.75	4246.83	1161.13	1160.81	38.47114	96.18570
MW14	7521.71	842.52	2521.71	4157.48	1162.88	1162.56	38.47056	96.18561
MW15	7439.63	1084.26	2439.62	3915.74	1162.25	1161.92	38.47014	96.18491
Site BM	7828.34	1112.26	2828.34	3887.74		BM Elevation = 1163.91		

BM Description: "□" Square cut on southeast corner of eastern most pump island.

MW13 is in the: SE¼ SE¼ SW¼ NW¼ S.22-T18S-R11E
MW14 is in the: NE¼ NE¼ NW¼ SW¼ S.22-T18S-R11E
MW15 is in the: NW¼ NW¼ NE¼ SW¼ S.22-T18S-R11E

If you have any questions, please do not hesitate in giving us a call.

Sincerely,

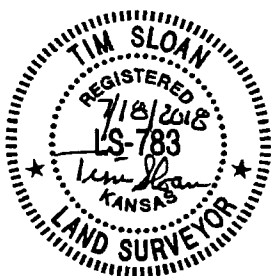

Tim Sloan, L.S.
SMH CONSULTANTS