

Well ID

Revised 7/10/2015

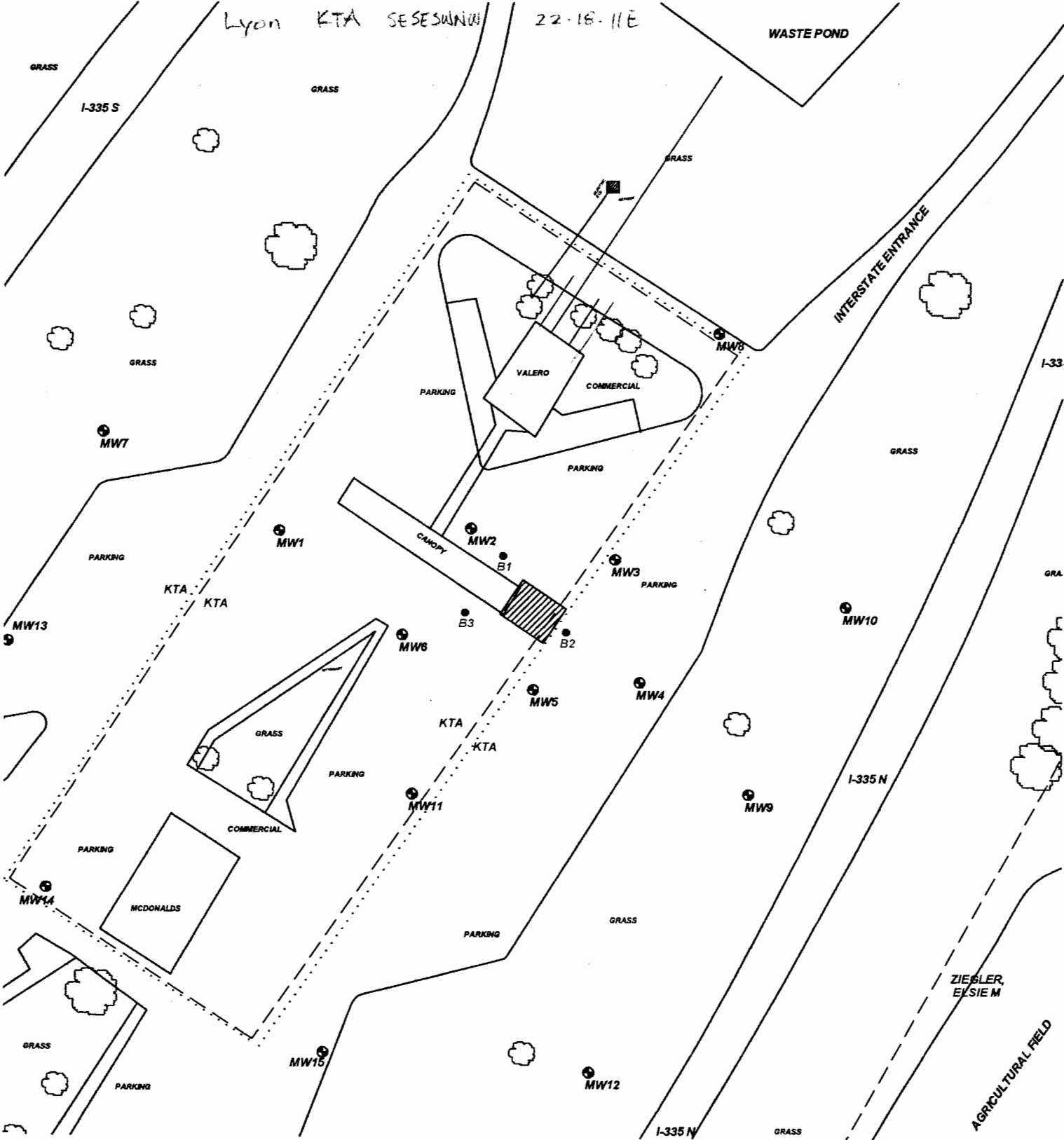

PROJECT: **COASTAL MART #1838 / EZ GO #72**

ADDRESS: **MP 132 I-335**

LOCATION: **EMPORIA, KS**

DRAWN BY: **B. STALNAKER** DATE: **3/19/18**

REVISED BY: **B. Johnson** DATE: **8/2/18**

ED JOB #: **TF510/511** KDH JOB #: **U3-056-13023/14555**

SCALE: **1" = 100'**

0 50 100

TITLE: **FIGURE 2.1
AREA BASE MAP
350' RADIUS**

AE **ASSOCIATED
ENVIRONMENTAL
INC.**

NOTES:
No basements observed within 500'.
Sample Date: 7/16/18

LEGEND:

- = ACTIVE UST BASIN
- = MONITORING WELL
- = SOIL BORING
- = SUBJECT PROPERTY
- = PARCEL BOUNDARY
- = BURIED ELECTRIC (2-5')
- = BURIED WATER (3-6')
- = BURIED GAS (2-4')
- = BURIED SEWER (2-12')
- = BURIED CABLE (2-5')

SMH

CONSULTANTS

July 18, 2018

Associated Environmental, Inc.
Cole Roe
404 Pottawatomie
Manhattan, Kansas 66502
Email: cole_taylor@sbcglobal.com

RE: Project No. 1807MN1182

Cole:

The following is the information requested on a Monitoring Well Site, Coastal Mart #1838 / EZ Go #72, Emporia, Lyon County, Kansas.

Point	North Coord.	East Coord.	Distance SE Cor. North	From S.22 West	Elev. Top Of Rim or PK Nail	Elev. Top of PVC Pipe	Latitude North	Longitude West
SE Corner S.22-T18S-R11E	5000	5000						
MW13	7711.75	753.17	2711.75	4246.83	1161.13	1160.81	38.47114	96.18570
MW14	7521.71	842.52	2521.71	4157.48	1162.88	1162.56	38.47056	96.18561
MW15	7439.63	1084.26	2439.62	3915.74	1162.25	1161.92	38.47014	96.18491
Site BM	7828.34	1112.26	2828.34	3887.74		BM Elevation = 1163.91		

BM Description: "□" Square cut on southeast corner of eastern most pump island.

MW13 is in the: SE¼ SE¼ SW¼ NW¼ S.22-T18S-R11E
MW14 is in the: NE¼ NE¼ NW¼ SW¼ S.22-T18S-R11E
MW15 is in the: NW¼ NW¼ NE¼ SW¼ S.22-T18S-R11E

If you have any questions, please do not hesitate in giving us a call.

Sincerely,

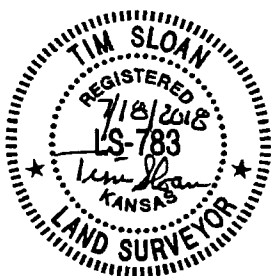

Tim Sloan, L.S.
SMH CONSULTANTS