

WATER WELL RECORD Form WWC-5

☐ Original Record ☐ Correction ☐ Change in Well Use

Division of Water
Resources App. No.

Well ID

MW-14

1 LOCATION OF WATER WELL: County: <u>Lyon</u>	Fraction <u>NE 1/4 NE 1/4 NW 1/4 SW 1/4</u>	Section Number <u>22</u>	Township Number <u>T 18 S</u>	Range Number <u>R 11 E</u> <input checked="" type="checkbox"/> <u>E</u> <input type="checkbox"/> <u>W</u>
---	--	-----------------------------	----------------------------------	--

2 WELL OWNER: Last Name: <u>Kansas Turnpike Authority</u> Business: <u>9401 Kellogg</u> Address: <u>Wichita</u> City: <u>Wichita</u> State: <u>KS</u> ZIP: <u>67207</u>	First: <u></u> Street or Rural Address where well is located (if unknown, distance and direction from nearest town or intersection): If at owner's address, check here: <input type="checkbox"/> <u>MP 132 I-335, Emporia, KS</u>
---	---

3 LOCATE WELL WITH "X" IN SECTION BOX: N <table border="1"><tr><td></td><td></td><td></td></tr><tr><td>-- NW --</td><td>-- NE --</td><td></td></tr><tr><td>W</td><td>X</td><td>E</td></tr><tr><td>-- SW --</td><td>-- SE --</td><td></td></tr><tr><td></td><td></td><td>S</td></tr></table> [-----1 mile-----]				-- NW --	-- NE --		W	X	E	-- SW --	-- SE --				S	4 DEPTH OF COMPLETED WELL: <u>30</u> ft. Depth(s) Groundwater Encountered: 1) <u>26</u> ft. 2) <u></u> ft. 3) <u></u> ft. or 4) <input type="checkbox"/> Dry Well WELL'S STATIC WATER LEVEL: <u>24.01</u> ft. <input checked="" type="checkbox"/> below land surface, measured on (mo-day-yr) <u>9/16/18</u> . <input type="checkbox"/> above land surface, measured on (mo-day-yr) <u></u> . Pump test data: Well water was <u></u> ft. after <u></u> hours pumping <u></u> gpm Well water was <u></u> ft. after <u></u> hours pumping <u></u> gpm Estimated Yield: <u></u> gpm Bore Hole Diameter: <u>8.25</u> in. to <u>30</u> ft. and <u></u> in. to <u></u> ft.	5 Latitude: <u>38.47056</u> (decimal degrees) Longitude: <u>96.18561</u> (decimal degrees) Horizontal Datum: <input checked="" type="checkbox"/> WGS 84 <input type="checkbox"/> NAD 83 <input type="checkbox"/> NAD 27 Source for Latitude/Longitude: <input type="checkbox"/> GPS (unit make/model: <u></u>) (WAAS enabled? <input type="checkbox"/> Yes <input type="checkbox"/> No) <input checked="" type="checkbox"/> Land Survey <input type="checkbox"/> Topographic Map <input type="checkbox"/> Online Mapper: <u></u>
-- NW --	-- NE --																
W	X	E															
-- SW --	-- SE --																
		S															
6 Elevation: <u>1162.56</u> ft. <input type="checkbox"/> Ground Level <input checked="" type="checkbox"/> TOC Source: <input checked="" type="checkbox"/> Land Survey <input type="checkbox"/> GPS <input type="checkbox"/> Topographic Map <input type="checkbox"/> Other <u></u>																	

7 WELL WATER TO BE USED AS:		
1. Domestic: <input type="checkbox"/> Household <input type="checkbox"/> Lawn & Garden <input type="checkbox"/> Livestock	5. <input type="checkbox"/> Public Water Supply: well ID <u></u> 6. <input type="checkbox"/> Dewatering: how many wells? <u></u> 7. <input type="checkbox"/> Aquifer Recharge: well ID <u></u> 8. <input checked="" type="checkbox"/> Monitoring: well ID <u>MW-14</u> 9. Environmental Remediation: well ID <u></u> <input type="checkbox"/> Air Sparge <input type="checkbox"/> Soil Vapor Extraction <input type="checkbox"/> Recovery <input type="checkbox"/> Injection	10. <input type="checkbox"/> Oil Field Water Supply: lease <u></u> 11. Test Hole: well ID <u></u> <input type="checkbox"/> Cased <input type="checkbox"/> Uncased <input type="checkbox"/> Geotechnical 12. Geothermal: how many bores? <u></u> a) Closed Loop <input type="checkbox"/> Horizontal <input type="checkbox"/> Vertical b) Open Loop <input type="checkbox"/> Surface Discharge <input type="checkbox"/> Inj. of Water 13. <input type="checkbox"/> Other (specify): <u></u>
3. <input type="checkbox"/> Irrigation 4. <input type="checkbox"/> Feedlot 6. <input type="checkbox"/> Industrial		

Was a chemical/bacteriological sample submitted to KDHE? ☐ Yes ☒ No If yes, date sample was submitted:
Water well disinfected? ☐ Yes ☒ No

8 TYPE OF CASING USED: ☐ Steel ☒ PVC ☐ Other CASING JOINTS: ☐ Glued ☐ Clamped ☐ Welded ☒ Threaded
Casing diameter 2 in. to 20 ft. Diameter in. to ft. Diameter in. to ft.
Casing height above land surface -0.5 in. Weight lbs./ft. Wall thickness or gauge No. Sch 40

TYPE OF SCREEN OR PERFORATION MATERIAL:
☐ Steel ☐ Stainless Steel ☐ Fiberglass ☒ PVC ☐ Other (Specify)
☐ Brass ☐ Galvanized Steel ☐ Concrete tile ☐ None used (open hole)

SCREEN OR PERFORATION OPENINGS ARE:
☐ Continuous Slot ☒ Mill Slot ☐ Gauze Wrapped ☐ Torch Cut ☐ Drilled Holes ☐ Other (Specify)
☐ Louvered Shutter ☐ Key Punched ☐ Wire Wrapped ☐ Saw Cut ☐ None (Open Hole)
SCREEN-PERFORATED INTERVALS: From 20 ft. to 30 ft., From ft. to ft., From ft. to ft.
GRAVEL PACK INTERVALS: From 18 ft. to 30 ft., From ft. to ft., From ft. to ft.

9 GROUT MATERIAL: ☐ Neat cement ☐ Cement grout ☒ Bentonite ☐ Other
Grout Intervals: From 18 ft. to 16 ft., From ft. to ft., From ft. to ft.

Nearest source of possible contamination:
☐ Septic Tank ☐ Lateral Lines ☐ Pit Privy ☐ Livestock Pans ☐ Insecticide Storage
☐ Sewer Lines ☐ Cess Pool ☐ Sewage Lagoon ☐ Fuel Storage ☐ Abandoned Water Well
☐ Watertight Sewer Lines ☐ Seepage Pit ☐ Feedyard ☐ Fertilizer Storage ☐ Oil Well/Gas Well
☒ Other (Specify) Contaminated site U3-056-13023-14555
Direction from well? On-site Distance from well? On-site ft.

10 FROM	TO	LITHOLOGIC LOG	FROM	TO	LITHO. LOG (cont.) or PLUGGING INTERVALS
0	0.5	Asphalt			
0.5	30	Silty Clay, brn to red brn, firm			
TD	30				

Notes:

11 CONTRACTOR'S OR LANDOWNER'S CERTIFICATION: This water well was ☐ constructed, ☐ reconstructed, or ☐ plugged under my jurisdiction and was completed on (mo-day-year) 6/25/18 and this record is true to the best of my knowledge and belief.
Kansas Water Well Contractor's License No. 585 This Water Well Record was completed on (mo-day-year) 8/14/2018
under the business name of Associated Environmental, Inc. Signature

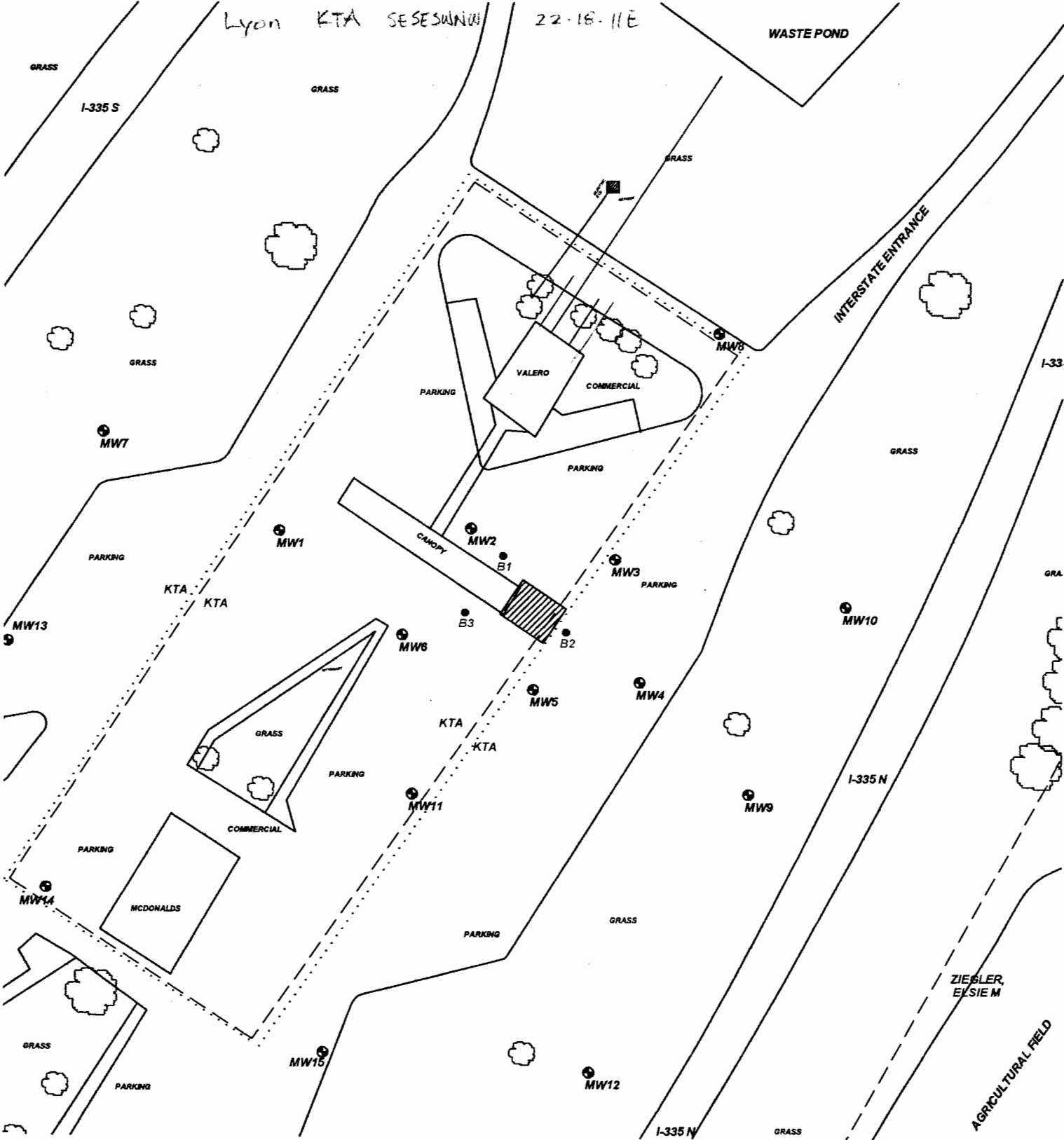

PROJECT: **COASTAL MART #1838 / EZ GO #72**

ADDRESS: **MP 132 I-335**

LOCATION: **EMPORIA, KS**

DRAWN BY: **B. STALNAKER** DATE: **3/19/18**

REVISED BY: **B. Johnson** DATE: **8/2/18**

UT JOB #: **TF510/511** KDHE JOB #: **U3-056-13023/14555**

TITLE: **FIGURE 2.1
AREA BASE MAP
350' RADIUS**

AE **ASSOCIATED
ENVIRONMENTAL
INC.**

- LEGEND:
- = ACTIVE UST BASIN
 - = MONITORING WELL
 - = SOIL BORING
 - = SUBJECT PROPERTY
 - = PARCEL BOUNDARY
 - = BURIED ELECTRIC (2-5')
 - = BURIED WATER (3-6')
 - = BURIED GAS (2-4')
 - = BURIED SEWER (2-12')
 - = BURIED CABLE (2-5')

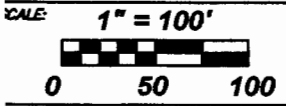

NOTES:
No basements observed within 500'.
Sample Date: 7/16/18

SMH

CONSULTANTS

July 18, 2018

Associated Environmental, Inc.
Cole Roe
404 Pottawatomie
Manhattan, Kansas 66502
Email: cole_taylor@sbcglobal.com

RE: Project No. 1807MN1182

Cole:

The following is the information requested on a Monitoring Well Site, Coastal Mart #1838 / EZ Go #72, Emporia, Lyon County, Kansas.

Point	North Coord.	East Coord.	Distance SE Cor. North	From S.22 West	Elev. Top Of Rim or PK Nail	Elev. Top of PVC Pipe	Latitude North	Longitude West
SE Corner S.22-T18S-R11E	5000	5000						
MW13	7711.75	753.17	2711.75	4246.83	1161.13	1160.81	38.47114	96.18570
MW14	7521.71	842.52	2521.71	4157.48	1162.88	1162.56	38.47056	96.18561
MW15	7439.63	1084.26	2439.62	3915.74	1162.25	1161.92	38.47014	96.18491
Site BM	7828.34	1112.26	2828.34	3887.74		BM Elevation = 1163.91		

BM Description: "□" Square cut on southeast corner of eastern most pump island.

MW13 is in the: SE¼ SE¼ SW¼ NW¼ S.22-T18S-R11E
MW14 is in the: NE¼ NE¼ NW¼ SW¼ S.22-T18S-R11E
MW15 is in the: NW¼ NW¼ NE¼ SW¼ S.22-T18S-R11E

If you have any questions, please do not hesitate in giving us a call.

Sincerely,

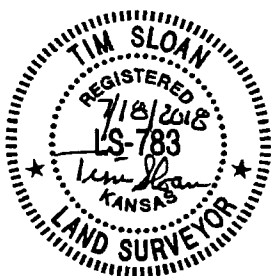

Tim Sloan, L.S.
SMH CONSULTANTS