

WATER WELL RECORD

Form WWC-5

Division of Water Resources App. No.

1 LOCATION OF WATER WELL: County: <u>Miami</u>	Fraction <u>NW 1/4 SE 1/4 SW 1/4 NE 1/4</u>	Section Number <u>30</u>	Township No. T <u>18</u> S	Range Number R <u>22</u> <input checked="" type="checkbox"/> E <input type="checkbox"/> W
Street/Rural Address of Well Location; if unknown, distance & direction from nearest town or intersection: If at owner's address, check here <input checked="" type="checkbox"/> .		Global Positioning System (GPS) information: Latitude: (in decimal degrees) Longitude: (in decimal degrees) Elevation: Datum: <input type="checkbox"/> WGS 84, <input type="checkbox"/> NAD 83, <input type="checkbox"/> NAD 27		
2 WATER WELL OWNER: <u>4 way Investment / P. / W. H. S.</u> RR#, Street Address, Box #: <u>35700 W. 379th St.</u> City, State, ZIP Code: <u>Oswatimie, KS. 66064</u>		Collection Method: <input type="checkbox"/> GPS unit (Make/Model:) <input type="checkbox"/> Digital Map/Photo, <input type="checkbox"/> Topographic Map, <input type="checkbox"/> Land Survey Est. Accuracy: <input type="checkbox"/> <3 m, <input type="checkbox"/> 3-5 m, <input type="checkbox"/> 5-15 m, <input type="checkbox"/> >15 m		

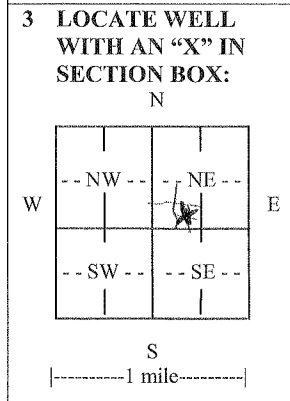

4 DEPTH OF COMPLETED WELL 100 ft.

Depth(s) Groundwater Encountered (1) 76-77 ft. (2) ft. (3) ft.

WELL'S STATIC WATER LEVEL... 72 ft. below land surface measured on mo/day/yr. 4-9-12

Pump test data: Well water was ft. after hours pumping gpm

EST. YIELD... 9 gpm. Well water was ft. after hours pumping gpm

Bore Hole Diameter 8.14 in. to 100 ft., and in. to ft.

WELL WATER TO BE USED AS: Public water supply Geothermal Injection well
 Domestic Feedlot Oil field water supply Dewatering Other (Specify below)
 Irrigation Industrial Domestic-lawn & garden Monitoring well

Was a chemical/bacteriological sample submitted to Department? Yes No

If yes, mo/day/yr sample was submitted.....

Water well disinfected? Yes No

5 TYPE OF CASING USED: Steel PVC Other

CASING JOINTS: Glued Clamped Welded Threaded

Casing diameter 5 in. to 76 ft., Diameter in. to ft., Diameter in. to ft.

Casing height above land surface..... 18 in., Weight SPR. 26 lbs./ft., Wall thickness or gauge No. 160 PSI

TYPE OF SCREEN OR PERFORATION MATERIAL:

Steel Stainless Steel PVC Other (Specify)
 Brass Galvanized Steel None used (open hole)

SCREEN OR PERFORATION OPENINGS ARE:

Continuous slot Mill slot Gauze wrapped Torch cut Drilled holes None (open hole)
 Louvered shutter Key punched Wire wrapped Saw cut Other (specify)

SCREEN-PERFORATED INTERVALS: From 76 ft. to 100 ft., From ft. to ft.
 From ft. to ft., From ft. to ft.

GRAVEL PACK INTERVALS: From 100 ft. to 93 ft., From ft. to ft.
 From ft. to ft., From ft. to ft.

6 GROUT MATERIAL: Neat cement Cement grout Bentonite Other

Grout Intervals: From 23 ft. to ft., From ft. to ft., From ft. to ft.

What is the nearest source of possible contamination:

Septic tank Lateral lines Pit privy Livestock pens Insecticide storage Other (specify below)
 Sewer lines Cesspool Sewage lagoon Fuel storage Abandoned water well 3 Plugged
 Watertight sewer lines Seepage pit Feedyard Fertilizer storage Oil well/gas well

Direction from well S.E. Distance from well

FROM	TO	LITHOLOGIC LOG	FROM	TO	LITHO. LOG (cont.) or PLUGGING INTERVALS
0	6	Soil + clay	76-94		lime
6	8	sand	94-100		Shale
8	9	lime			
9	12	sand			
12	14	lime			
14	16	sand			
16	27	shale			
27	43	lime			
43	66	shale			
66	76	sandy shale			

7 CONTRACTOR'S OR LANDOWNER'S CERTIFICATION: This water well was constructed, reconstructed, or plugged under my jurisdiction and was completed on (mo/day/year) 4/9/12 and this record is true to the best of my knowledge and belief.

Kansas Water Well Contractor's License No. 561 This Water Well Record was completed on (mo/day/year) 4/9/12 under the business name of Evans Energy Dev. Inc. by (signature) S. G. Evans

INSTRUCTIONS: Use typewriter or ball point pen. PLEASE PRESS FIRMLY and PRINT clearly. Please fill in blanks and check the correct answers. Send three copies (white, blue, pink) to Kansas Department of Health and Environment, Bureau of Water, Geology Section, 1000 SW Jackson St., Suite 420, Topeka, Kansas 66612-1367. Telephone 785-296-5524. Send one copy to WATER WELL OWNER and retain one for your records. Include fee of \$5.00 for each constructed well. Visit us at <http://www.kdheks.gov/waterwell/index.html>.