

WATER WELL RECORD Form WWC-5

Division of Water Resources App. No.

[]

Well ID

MW15

Original Record Correction Change in Well Use

1 LOCATION OF WATER WELL: County: MARION Fraction NE 1/4 NE 1/4 NE 1/4 NW 1/4 Section Number 14 Township Number T 18 S Range Number R 4 E W

2 WELL OWNER: Last Name: EHRlich First: CLIFF Business: LINCOLNVILLE AMOCO Address: HWY 77 & MAIN ST. LINCOLNVILLE City: LINCOLNVILLE State: KS ZIP: 66858 Street or Rural Address where well is located

3 LOCATE WELL WITH 'X' IN SECTION BOX: [Diagram] 4 DEPTH OF COMPLETED WELL: 15 ft. 5 Latitude: 38.49331 Longitude: 96.95858

7 WELL WATER TO BE USED AS: 1. Domestic: [] Household [] Lawn & Garden [] Livestock [] Irrigation [] Feedlot [] Industrial 2. [] Public Water Supply: well ID 3. [] Dewatering: how many wells? 4. [] Aquifer Recharge: well ID 5. [] Monitoring: well ID MW15 6. [] Air Sparge [] Soil Vapor Extraction 7. [] Recovery [] Injection 8. [] Oil Field Water Supply: lease 9. [] Test Hole: well ID 10. [] Cased [] Uncased [] Geotechnical 11. [] Geothermal: how many bores? 12. a) Closed Loop [] Horizontal [] Vertical b) Open Loop [] Surface Discharge [] Inj. of Water 13. [] Other (specify):

Was a chemical/bacteriological sample submitted to KDHE? [] Yes [X] No If yes, date sample was submitted: Water well disinfected? [] Yes [X] No

8 TYPE OF CASING USED: [] Steel [X] PVC [] Other CASING JOINTS: [] Glued [] Clamped [] Welded [X] Threaded Casing diameter 2 in. to 5 ft. Diameter in. to ft. Diameter in. to ft. Casing height above land surface in. Weight lbs./ft. Wall thickness or gauge No. 40 TYPE OF SCREEN OR PERFORATION MATERIAL: [] Steel [] Stainless Steel [] Fiberglass [X] PVC [] Brass [] Galvanized Steel [] Concrete tile [] None used (open hole) SCREEN OR PERFORATION OPENINGS ARE: [] Continuous Slot [X] Mill Slot [] Gauze Wrapped [] Torch Cut [] Drilled Holes [] Other (Specify) [] Louvered Shutter [] Key Punched [] Wire Wrapped [] Saw Cut [] None (Open Hole) SCREEN-PERFORATED INTERVALS: From 5 ft. to 15 ft. GRAVEL PACK INTERVALS: From 3 ft. to 15 ft.

9 GROUT MATERIAL: [] Neat cement [] Cement grout [X] Bentonite [] Other Grout Intervals: From 0 ft. to 3 ft., From ft. to ft., From ft. to ft. Nearest source of possible contamination: [] Septic Tank [] Lateral Lines [] Pit Privy [] Livestock Pens [] Insecticide Storage [] Sewer Lines [] Cess Pool [] Sewage Lagoon [X] Fuel Storage [] Abandoned Water Well [] Watertight Sewer Lines [] Seepage Pit [] Feedyard [] Fertilizer Storage [] Oil Well/Gas Well [] Other (Specify) Direction from well? SOUTHEAST Distance from well? 200 ft.

Table with columns: 10 FROM, TO, LITHOLOGIC LOG, FROM, TO, LITHO. LOG (cont.) or PLUGGING INTERVALS. Rows: 0-1 TOPSOIL, SILTY CLAY LOAM; 1-12 SILTY CLAY; 12-15 SHALE. Notes: LINCOLNVILLE AMOCO U5-057-13299 LINCOLNVILLE, KS

11 CONTRACTOR'S OR LANDOWNER'S CERTIFICATION: This water well was [X] constructed, [] reconstructed, or [] plugged under my jurisdiction and was completed on (mo-day-year) 1/31/22 and this record is true to the best of my knowledge and belief. Kansas Water Well Contractor's License No. 585 This Water Well Record was completed on (mo-day-year) 5/13/22 under the business name of ASSOCIATED ENVIRONMENTAL, INC. Signature

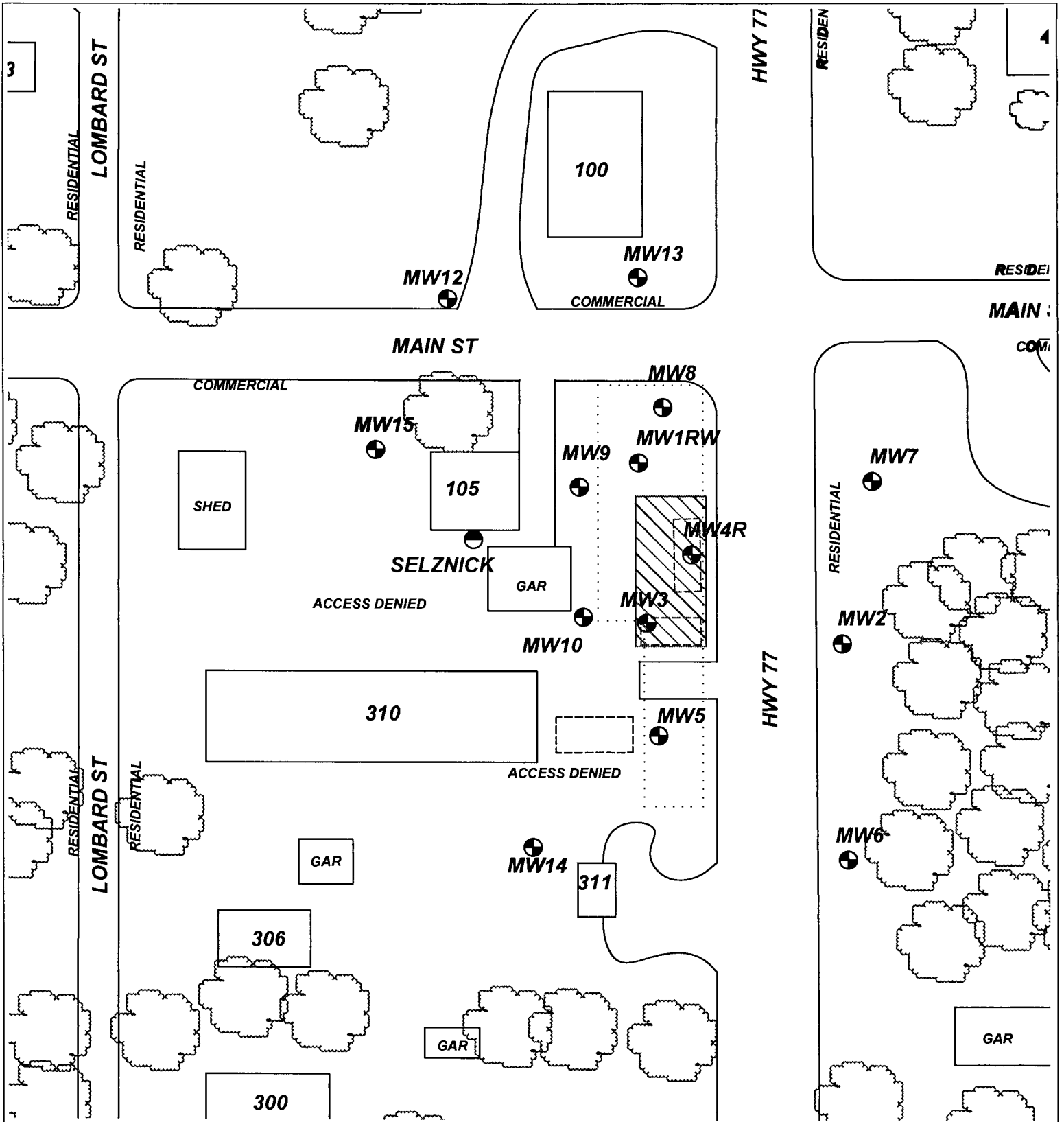

PROJECT: **LINCOLNVILLE AMOCO**

ADDRESS: **HWY 77 & MAIN ST.**

LOCATION: **LINCOLNVILLE, KS**

DRAWN BY: **B. STALNAKER** DATE: **9/22/20**

REVISED BY: **B. STALNAKER** DATE: **4/8/21**

AEI JOB #: **TF530** KDHE JOB #: **U5-057-13299**

TITLE: **FIGURE 2.3
AREA BASE MAP
CLOSE-UP**

AEI ASSOCIATED ENVIRONMENTAL INC.

LEGEND:

- [Dotted Line] = FORMER UST BASIN/EXCAVATION
- [Hatched Box] = EXCAVATION AREA
- [Dashed Box] = AST BASIN
- [Circle with Cross] = MONITORING WELL
- [Circle with Dot] = DOMESTIC WELL
- [Dotted Line] = SUBJECT PROPERTY

[North Arrow]

SCALE: **1" = 50'**

0 25 50

NOTES: