

1 LOCATION OF WATER WELL: Fraction SW 1/4 SE 1/4 NW 1/4 Section Number 11 Township Number T 19 S Range Number R 11 EW

Distance and direction from nearest town or city street address of well if located within city? 1202 E. 12th, Emporia, Kansas

2 WATER WELL OWNER: RR#, St. Address, Box # Stop 2 Shop #2 Attn: Betty McDonald Board of Agriculture, Division of Water Resources City, State, ZIP Code 1513 Rural Street, Emporia, Ks 66801 Application Number:

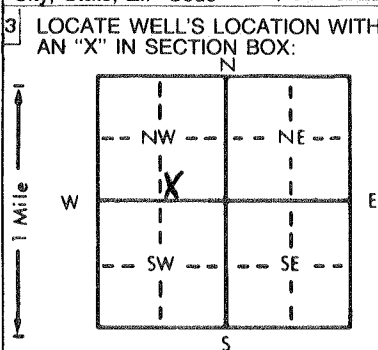

3 LOCATE WELL'S LOCATION WITH AN 'X' IN SECTION BOX: 4 DEPTH OF COMPLETED WELL 19.5 ft. ELEVATION: Depth(s) Groundwater Encountered 1. 14.5 ft. 2. ft. 3. ft. WELL'S STATIC WATER LEVEL 6.93 ft. below land surface measured on mo/day/yr Pump test data: Well water was ft. after hours pumping gpm Est. Yield gpm: Well water was ft. after hours pumping gpm Bore Hole Diameter 8.625 in. to 19.5 ft., and in. to ft. WELL WATER TO BE USED AS: 5 Public water supply 8 Air conditioning 11 Injection well 1 Domestic 3 Feedlot 6 Oil field water supply 9 Dewatering 12 Other (Specify below) 2 Irrigation 4 Industrial 7 Lawn and garden only 10 Monitoring well mw-7 Was a chemical/bacteriological sample submitted to Department? Yes No X; If yes, mo/day/yr sample was submitted Water Well Disinfected? Yes No X

5 TYPE OF BLANK CASING USED: 1 Steel 3 RMP (SR) 5 Wrought iron 8 Concrete tile CASING JOINTS: Glued Clamped 2 PVC 4 ABS 6 Asbestos-Cement 9 Other (specify below) Welded 7 Fiberglass Threaded X Blank casing diameter 2 in. to 9.5 ft., Dia in. to ft., Dia in. to ft. Casing height above land surface 0 in., weight SCH 40 PVC lbs./ft. Wall thickness or gauge No. TYPE OF SCREEN OR PERFORATION MATERIAL: 1 Steel 3 Stainless steel 5 Fiberglass 8 RMP (SR) 10 Asbestos-cement 2 Brass 4 Galvanized steel 6 Concrete tile 9 ABS 11 Other (specify) 12 None used (open hole) SCREEN OR PERFORATION OPENINGS ARE: 1 Continuous slot 3 Mill slot 5 Gauzed wrapped 8 Saw cut 11 None (open hole) 2 Louvered shutter 4 Key punched 6 Wire wrapped 9 Drilled holes 7 Torch cut 10 Other (specify) SCREEN-PERFORATED INTERVALS: From 9.5 ft. to 19.5 ft., From ft. to ft. GRAVEL PACK INTERVALS: From 8 ft. to 19.5 ft., From ft. to ft.

6 GROUT MATERIAL: 1 Neat cement 2 Cement grout 3 Bentonite 4 Other Grout Intervals: From 0 ft. to 5 ft., From 3.5 ft. to 8 ft., From ft. to ft. What is the nearest source of possible contamination: 1 Septic tank 4 Lateral lines 7 Pit privy 11 Fuel storage 15 Oil well/Gas well 2 Sewer lines 5 Cess pool 8 Sewage lagoon 12 Fertilizer storage 16 Other (specify below) 3 Watertight sewer lines 6 Seepage pit 9 Feedyard 13 Insecticide storage 14 Abandoned water well 15 Livestock pens

FROM	TO	LITHOLOGIC LOG	FROM	TO	PLUGGING INTERVALS
GL	1.00	Soil			
1.00	16.00	Clay			
16.00	16.50	Limestone			
16.50	20.00	Shale			
20.00	TD	End of Borehole			

Flush Mount waiver
D. Taylor
10/24/96

7 CONTRACTOR'S OR LANDOWNER'S CERTIFICATION: This water well was (1) constructed, (2) reconstructed, or (3) plugged under my jurisdiction and was completed on (mo/day/year) 1-23-97 and this record is true to the best of my knowledge and belief. Kansas Water Well Contractor's License No. 585 This Water Well Record was completed on (mo/day/yr) 2-5-97 under the business name of AEI by (signature) Johnson for Dawn R...

INSTRUCTIONS: Use typewriter or ball point pen. PLEASE PRESS FIRMLY and PRINT clearly. Please fill in blanks, underline or circle the correct answers. Send top three copies to Kansas Department of Health and Environment, Bureau of Water, Topeka, Kansas 66620-0001. Telephone: 913-296-5545. Send one to WATER WELL OWNER and retain one for your records.