

WATER WELL RECORD Form WWC-5

Original Record Correction Change in Well Use

Division of Water Resources App. No.

Well ID

1 LOCATION OF WATER WELL: County: Lyon	Fraction SW ¼ SE ¼ SE ¼ NW ¼	Section Number 10	Township Number T 19 S	Range Number R 11 <input checked="" type="checkbox"/> E <input type="checkbox"/> W
--	---------------------------------	----------------------	---------------------------	---

2 WELL OWNER: Last Name: First: Business: Chevron Environmental Management Company Address: 4800 Fournace Place Address: City: Bellaire State: TX ZIP: 77401	Street or Rural Address where well is located (if unknown, distance and direction from nearest town or intersection): If at owner's address, check here: <input type="checkbox"/> Former Chevron Station (CVS Pharmacy #10294) 12th and Merchant St. Emporia, KS 66801
---	--

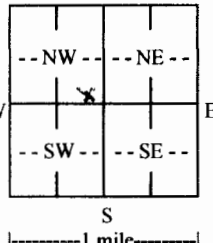
3 LOCATE WELL WITH "X" IN SECTION BOX: N  W E S 1 mile	4 DEPTH OF COMPLETED WELL: 22.5 ft. Depth(s) Groundwater Encountered: 1) 15 ft. 2) ft. 3) ft., or 4) <input type="checkbox"/> Dry Well WELL'S STATIC WATER LEVEL: 7.16 ft. <input checked="" type="checkbox"/> below land surface, measured on (mo-day-yr)..... <input type="checkbox"/> above land surface, measured on (mo-day-yr)..... Pump test data: Well water was ft. after hours pumping gpm Well water was ft. after hours pumping gpm Estimated Yield: gpm Bore Hole Diameter: 8.25 in. to 22.5 ft. and in. to ft.	5 Latitude: 38.41259 (decimal degrees) Longitude: 96.18210 (decimal degrees) Horizontal Datum: <input checked="" type="checkbox"/> WGS 84 <input type="checkbox"/> NAD 83 <input type="checkbox"/> NAD 27 Source for Latitude/Longitude: <input type="checkbox"/> GPS (unit make/model:) (WAAS enabled? <input type="checkbox"/> Yes <input type="checkbox"/> No) <input checked="" type="checkbox"/> Land Survey <input type="checkbox"/> Topographic Map <input type="checkbox"/> Online Mapper:
6 Elevation: 1165.49 ft. <input type="checkbox"/> Ground Level <input checked="" type="checkbox"/> TOC Source: <input checked="" type="checkbox"/> Land Survey <input type="checkbox"/> GPS <input type="checkbox"/> Topographic Map <input type="checkbox"/> Other		

7 WELL WATER TO BE USED AS:

1. Domestic: <input type="checkbox"/> Household <input type="checkbox"/> Lawn & Garden <input type="checkbox"/> Livestock 2. <input type="checkbox"/> Irrigation 3. <input type="checkbox"/> Feedlot 4. <input type="checkbox"/> Industrial	5. <input type="checkbox"/> Public Water Supply: well ID 6. <input type="checkbox"/> Dewatering: how many wells? 7. <input type="checkbox"/> Aquifer Recharge: well ID 8. <input checked="" type="checkbox"/> Monitoring: well ID MW-1 9. Environmental Remediation: well ID <input type="checkbox"/> Air Sparge <input type="checkbox"/> Soil Vapor Extraction <input type="checkbox"/> Recovery <input type="checkbox"/> Injection	10. <input type="checkbox"/> Oil Field Water Supply: lease 11. Test Hole: well ID <input type="checkbox"/> Cased <input type="checkbox"/> Uncased <input type="checkbox"/> Geotechnical 12. Geothermal: how many bores? a) Closed Loop <input type="checkbox"/> Horizontal <input type="checkbox"/> Vertical b) Open Loop <input type="checkbox"/> Surface Discharge <input type="checkbox"/> Inj. of Water 13. <input type="checkbox"/> Other (specify):
---	---	---

Was a chemical/bacteriological sample submitted to KDHE? Yes No If yes, date sample was submitted:

Water well disinfected? Yes No

8 TYPE OF CASING USED: Steel PVC Other **CASING JOINTS:** Glued Clamped Welded Threaded

Casing diameter 2 in. to 7.5 ft., Diameter in. to ft., Diameter in. to ft.
 Casing height above land surface 0 in. Weight lbs./ft. Wall thickness or gauge No. **Sched. 40**...

TYPE OF SCREEN OR PERFORATION MATERIAL:
 Steel Stainless Steel Fiberglass PVC Other (Specify)
 Brass Galvanized Steel Concrete tile None used (open hole)

SCREEN OR PERFORATION OPENINGS ARE:
 Continuous Slot Mill Slot Gauze Wrapped Torch Cut Drilled Holes Other (Specify)
 Louvered Shutter Key Punched Wire Wrapped Saw Cut None (Open Hole)

SCREEN-PERFORATED INTERVALS: From 7.5 ft. to 22.5 ft., From ft. to ft., From ft. to ft.
GRAVEL PACK INTERVALS: From 5.5 ft. to 22.5 ft., From ft. to ft., From ft. to ft.

9 GROUT MATERIAL: Neat cement Cement grout Bentonite Other

Grout Intervals: From 2 ft. to 5.5 ft., From ft. to ft., From ft. to ft.

Nearest source of possible contamination:

<input type="checkbox"/> Septic Tank	<input type="checkbox"/> Lateral Lines	<input type="checkbox"/> Pit Privy	<input type="checkbox"/> Livestock Pens	<input type="checkbox"/> Insecticide Storage
<input type="checkbox"/> Sewer Lines	<input type="checkbox"/> Cess Pool	<input type="checkbox"/> Sewage Lagoon	<input checked="" type="checkbox"/> Fuel Storage	<input type="checkbox"/> Abandoned Water Well
<input type="checkbox"/> Watertight Sewer Lines	<input type="checkbox"/> Seepage Pit	<input type="checkbox"/> Feedyard	<input type="checkbox"/> Fertilizer Storage	<input type="checkbox"/> Oil Well/Gas Well
<input type="checkbox"/> Other (Specify)				

Direction from well? **adjacent** Distance from well? 0 ft.

10 FROM	TO	LITHOLOGIC LOG	FROM	TO	LITHO. LOG (cont.) or PLUGGING INTERVALS
0	9	Fill Sand w/some clay highly plastic damp odor to 9'			
9	17	Silty clay, brown to gray highly plastic with interbedded limestone fragments and organic matter, damp, no odor			
17	22.5	Interbedded limestone fragments with weathered shale, dry, no odor			
22.5		Shale greenish brown blocky dry no odor			

Notes:

11 CONTRACTOR'S OR LANDOWNER'S CERTIFICATION: This water well was constructed, reconstructed, or plugged under my jurisdiction and was completed on (mo-day-year) **2-27-2017**..... and this record is true to the best of my knowledge and belief. Kansas Water Well Contractor's License No. **759**..... This Water Well Record was completed on (mo-day-year) **3-30-2017**..... under the business name of **RAZEK Environmental, LLC**..... Signature *[Signature]*

- LEGEND**
- ① PROPOSED MONITORING WELL LOCATION
 - ② PROPOSED SOIL BORING LOCATION
 - UTILITY POLE
 - FOUNDER TANK BASIN
 - POWER PRODUCT LINES
 - PROPERTY LINE
 - U1 WATER LINE - 30"
 - U2 TELECOM. LINE - 2.0'-3.0"
 - U3 STORM SEWER LINE - 30"
 - U4 SANITARY SEWER LINE - 30" - 12"
 - OVERHEAD ELECTRIC LINE

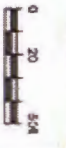
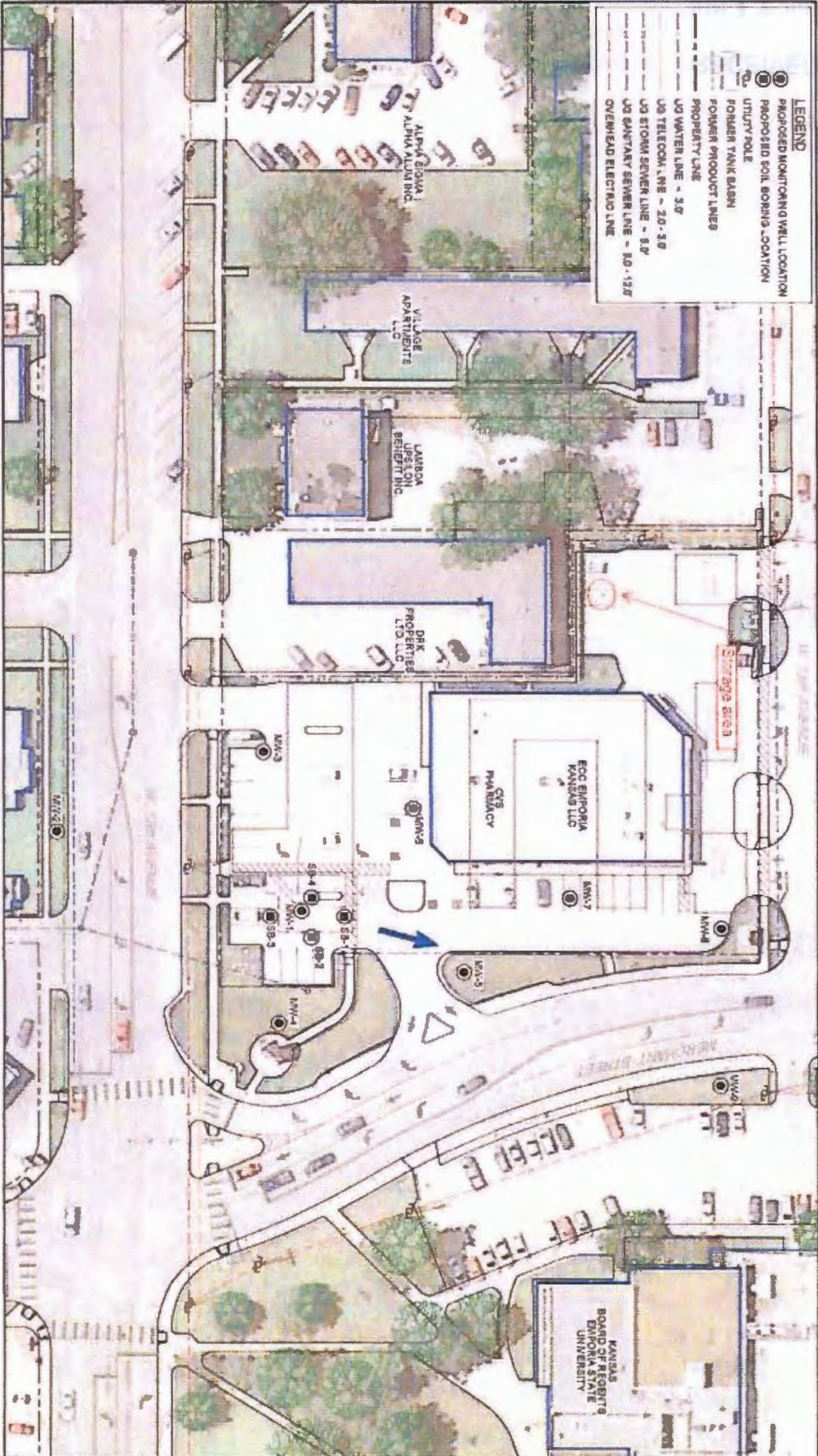

DATE: 08/27/16 BY: [illegible] FOR: [illegible] PROJECT: [illegible] SHEET: 02 OF 02



C/S PHARMACY STORE #1094
 (CHEYRON #073004) U3-058-14915
 12th AVENUE & MERCHANT STREET, EMPORIA, KANSAS

SITE PLAN

Lyons County

1108402
 May 17 2016

Figure 2