

WATER WELL RECORD Form WWC-5

Original Record Correction Change in Well Use

Division of Water Resources App. No.

Well ID

1 LOCATION OF WATER WELL: County: Lyon	Fraction SW ¼ SE ¼ SE ¼ NW ¼	Section Number 10	Township Number T 19 S	Range Number R 11 <input checked="" type="checkbox"/> E <input type="checkbox"/> W
--	---------------------------------	----------------------	---------------------------	---

2 WELL OWNER: Last Name: First: Business: Chevron Environmental Management Company Address: 4800 Fournace Place Address: City: Bellaire State: TX ZIP: 77401	Street or Rural Address where well is located (if unknown, distance and direction from nearest town or intersection): If at owner's address, check here: <input type="checkbox"/> Former Chevron Station (CVS Pharmacy #10294) 12th and Merchant St. Emporia, KS 66801
---	--

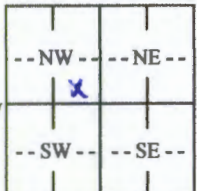
3 LOCATE WELL WITH "X" IN SECTION BOX: N  W E S 1 mile	4 DEPTH OF COMPLETED WELL: <u>22.5</u> ft. Depth(s) Groundwater Encountered: 1) ft. 2) ft. 3) ft., or 4) <input checked="" type="checkbox"/> Dry Well WELL'S STATIC WATER LEVEL: <u>11.74</u> ft. <input checked="" type="checkbox"/> below land surface, measured on (mo-day-yr)..... <input type="checkbox"/> above land surface, measured on (mo-day-yr)..... Pump test data: Well water was ft. after..... hours pumping gpm Well water was ft. after..... hours pumping gpm Estimated Yield: gpm Bore Hole Diameter: <u>8.25</u> in. to <u>22.5</u> ft. and in. to ft.	5 Latitude: <u>38.41272</u>(decimal degrees) Longitude: <u>96.18228</u>(decimal degrees) Horizontal Datum: <input checked="" type="checkbox"/> WGS 84 <input type="checkbox"/> NAD 83 <input type="checkbox"/> NAD 27 Source for Latitude/Longitude: <input type="checkbox"/> GPS (unit make/model:) (WAAS enabled? <input type="checkbox"/> Yes <input type="checkbox"/> No) <input checked="" type="checkbox"/> Land Survey <input type="checkbox"/> Topographic Map <input type="checkbox"/> Online Mapper:
6 Elevation: <u>1166.67</u> ft. <input type="checkbox"/> Ground Level <input checked="" type="checkbox"/> TOC Source: <input checked="" type="checkbox"/> Land Survey <input type="checkbox"/> GPS <input type="checkbox"/> Topographic Map <input type="checkbox"/> Other		

7 WELL WATER TO BE USED AS:

1. Domestic: <input type="checkbox"/> Household <input type="checkbox"/> Lawn & Garden <input type="checkbox"/> Livestock 2. <input type="checkbox"/> Irrigation 3. <input type="checkbox"/> Feedlot 4. <input type="checkbox"/> Industrial	5. <input type="checkbox"/> Public Water Supply: well ID 6. <input type="checkbox"/> Dewatering: how many wells? 7. <input type="checkbox"/> Aquifer Recharge: well ID 8. <input checked="" type="checkbox"/> Monitoring: well ID <u>MW-6</u> 9. Environmental Remediation: well ID <input type="checkbox"/> Air Sparge <input type="checkbox"/> Soil Vapor Extraction <input type="checkbox"/> Recovery <input type="checkbox"/> Injection	10. <input type="checkbox"/> Oil Field Water Supply: lease 11. Test Hole: well ID <input type="checkbox"/> Cased <input type="checkbox"/> Uncased <input type="checkbox"/> Geotechnical 12. Geothermal: how many bores? a) Closed Loop <input type="checkbox"/> Horizontal <input type="checkbox"/> Vertical b) Open Loop <input type="checkbox"/> Surface Discharge <input type="checkbox"/> Inj. of Water 13. <input type="checkbox"/> Other (specify):
---	---	---

Was a chemical/bacteriological sample submitted to KDHE? Yes No If yes, date sample was submitted:

Water well disinfected? Yes No

8 TYPE OF CASING USED: Steel PVC Other CASING JOINTS: Glued Clamped Welded Threaded

Casing diameter 2 in. to 7.5 ft., Diameter in. to ft., Diameter in. to ft.

Casing height above land surface 0 in. Weight lbs./ft. Wall thickness or gauge No. Sched. 40

TYPE OF SCREEN OR PERFORATION MATERIAL:
 Steel Stainless Steel Fiberglass PVC Other (Specify)
 Brass Galvanized Steel Concrete tile None used (open hole)

SCREEN OR PERFORATION OPENINGS ARE:
 Continuous Slot Mill Slot Gauze Wrapped Torch Cut Drilled Holes Other (Specify)
 Louvered Shutter Key Punched Wire Wrapped Saw Cut None (Open Hole)

SCREEN-PERFORATED INTERVALS: From 7.5 ft. to 22.5 ft., From ft. to ft., From ft. to ft.

GRAVEL PACK INTERVALS: From 5.5 ft. to 22.5 ft., From ft. to ft., From ft. to ft.

9 GROUT MATERIAL: Neat cement Cement grout Bentonite Other

Grout Intervals: From 2 ft. to 5.5 ft., From ft. to ft., From ft. to ft.

Nearest source of possible contamination:
 Septic Tank Lateral Lines Pit Privy Livestock Pens Insecticide Storage
 Sewer Lines Cess Pool Sewage Lagoon Fuel Storage Abandoned Water Well
 Watertight Sewer Lines Seepage Pit Feedyard Fertilizer Storage Oil Well/Gas Well
 Other (Specify)

Direction from well? Southeast Distance from well? 50 ft.

10 FROM	TO	LITHOLOGIC LOG	FROM	TO	LITHO. LOG (cont.) or PLUGGING INTERVALS
0	5	Air knifed no description available			
5	11	Silty clay, gray, medium plasticity, stiff black staining at 6 ft, moist, no odor			
11	19	Silty clay, red-brown to brown, stiff, with rock fragments and organic matter, moist no odor, slough at 10.5 to 11 ft.			
19	22.5	Shale bedrock			
Notes:					

11 CONTRACTOR'S OR LANDOWNER'S CERTIFICATION: This water well was constructed, reconstructed, or plugged under my jurisdiction and was completed on (mo-day-year) 2-28-2017..... and this record is true to the best of my knowledge and belief. Kansas Water Well Contractor's License No. 759..... This Water Well Record was completed on (mo-day-year) 3-30-2017..... under the business name of RAZEK Environmental, LLC..... Signature *[Signature]*

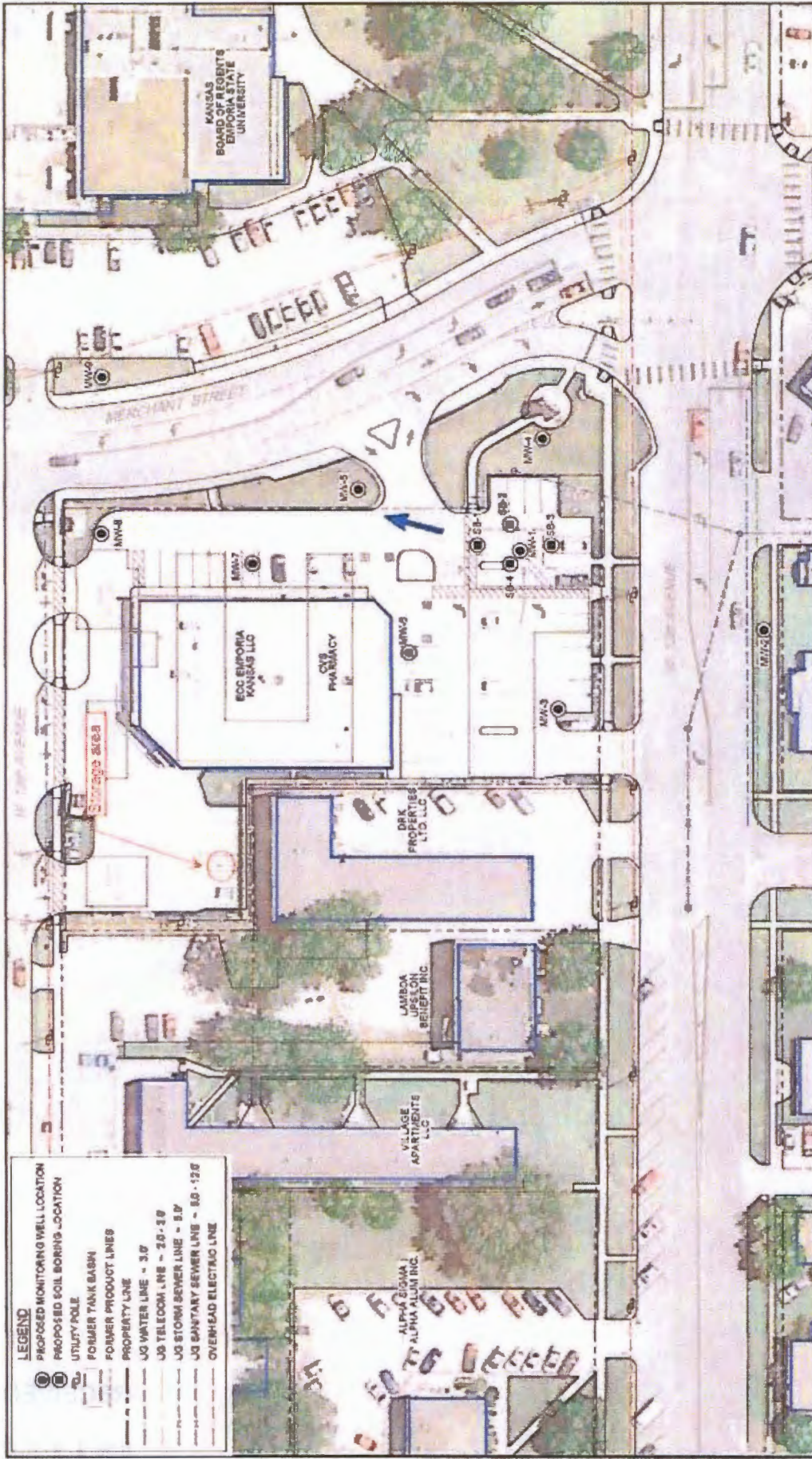

LEGEND

- PROPOSED MONITORING WELL LOCATION
- PROPOSED SOIL BORING LOCATION
- UTILITY POLE
- FORMER TANK BASIN
- FORMER PRODUCT LINES
- PROPERTY LINE
- UG WATER LINE - 3.0'
- UG TELECOM LINE - 2.0'-3.0'
- UG STORM SEWER LINE - 8.0'
- UG SANITARY SEWER LINE - 8.0'-12.0'
- OVERHEAD ELECTRIC LINE



CVS PHARMACY STORE #13294
 (CHEVRON #373904) US-05814615
 12th AVENUE & MERCHANT STREET, EMPORIA, KANSAS



SITE PLAN *Lyon County*

11106402
 May 17, 2016

Figure 2

ON THE 10th DAY OF MAY, 2016, I, THE ENGINEER, HEREBY CERTIFY THAT THE INFORMATION CONTAINED HEREON IS TRUE AND CORRECT TO THE BEST OF MY KNOWLEDGE AND BELIEF.