

WATER WELL RECORD

Form WWC-5

Division of Water Resources App. No.

Well ID

MW13

Original Record Correction Change in Well Ust

1 LOCATION OF WATER WELL: County Lyon Fraction SW 1/4 SE 1/4 SW 1/4 SE 1/4 Section Number 5 Township Number T 19 S Range Number R 11 E W

2 WELL OWNER: Last Name: First: Street or Rural Address where well is located (if unknown, distance and direction from nearest town or intersection): If at owner's address, check here: ~130ft E of 2628 W 18th St., Emporia, KS

3 LOCATE WELL WITH "X" IN SECTION BOX: N NW NE SW SE S

4 DEPTH OF COMPLETED WELL: 14.5 ft Depth(s) Groundwater Encountered: 1) 14.5 ft 2) ft 3) ft, or 4) Dry Well WELL'S STATIC WATER LEVEL: 5.18 ft

5 Latitude: 38.41982 (decimal degrees) Longitude: 96.21405 (decimal degrees) Horizontal Datum: X WGS 84 NAD 83 NAD 27

6 Elevation 1170.42 ft Ground Level X TOC Source: X Land Survey GPS Topographic Map

7 WELL WATER TO BE USED AS: 1 Domestic: Household Lawn & Garden Livestock Irrigation Feedlot Industrial 5 Public Water Supply: well ID 6 Dewatering: how many wells? 7 Aquifer Recharge: well ID 8 X Monitoring: well ID MW13 9 Environmental Remediation: well ID Air Sparge Soil Vapor Extractor Recovery Injection 10 Oil Field Water Supply: lease 11 Test Hole: well ID Cased Uncased Geotechnical 12 Geothermal: How many bores? a) Closed Loop Horizontal Vertical b) Open Loop Surface Discharge Inj. of Water Other (specify):

Was a chemical/bacteriological sample submitted to KDHE? Yes X No If yes, date sample was submitted: Water well disinfected? Yes X No

8 TYPE OF CASING USED: Steel X PVC Other CASING JOINTS: Glued Clamped Welded X Threaded Casing diameter 2 in. to 4.5 ft, Diameter in. to ft, Diameter in. to ft, Casing height above land surface -0.24 in. Weight lbs./ft. Well thickness or gauge No TYPE OF SCREEN OR PERFORATION MATERIAL: Steel Stainless Steel Fiberglass X PVC Other (Specify) SCREEN OR PERFORATION OPENINGS ARE: Continuous Slot X Mill Slot Gauze Wrapped Torch Cut Drilled Holes Other (Specify) Louvered Shutter Key Punched Wire Wrapped Saw Cut None (Open Hole) SCREEN-PERFORATED INTERVALS: From 4.5 ft. to 14.5 ft, From ft. to ft, From ft. to ft, GRAVEL PACK INTERVALS: From 2.5 ft. to 14.5 ft, From ft. to ft, From ft. to ft,

9 GROUT MATERIAL: Neat cement Cement grout X Bentonite X Other Concrete: 0-0.5' Grout intervals: From 0.5 ft. to 2.5 ft, From ft. to ft, From ft. to ft,

Nearest source of possible contamination: Septic Tank Lateral Lines Pit Privy Livestock Pens Insecticide Storage Sewer Lines Cess Pool Sewage Lagoon X Fuel Storage Abandoned Water Well Watertight Sewer Lines Seepage Pit Feedyard Fertilizer Storage Oil Well / Gas Well Other (Specify)

Direction from well? W Distance from well? ~190 ft

Table with 6 columns: FROM, TO, LITHOLOGIC LOG, FROM, TO, LITHO. LOG (cont.) or PLUGGING INTERVALS. Rows include Grass/topsoil, Silty clay, Shaley clay, Weathered shale.

Notes: KDHE ID: Emporia Stop 2 Shop #1; U3-056-00608 Target of monitoring well is shallow groundwater, <20' of grout was installed at the direction of KDHE.

11 CONTRACTOR'S OR LANDOWNER'S CERTIFICATION: This water well was X constructed, reconstructed or plugged under my jurisdiction and was completed on (mo-day-year) 11/21/19 and this record is true to the best of my knowledge and belief. Kansas Water Well Contractor's License No 757 This Water Well Record was completed on (mo-day-year) 12/13/19 under the business name of Larsen & Associates, Inc. Signature

Mail 1 white copy along with a fee of \$5.00 for each constructed well to: Kansas Department of Health and Environment, Bureau of Water, GWS Section, 1000 SW Jackson St., Suite 420, Topeka, Kansas 66612-1367. Mail one to Water Well Owner and retain one for your records. Telephone 785-296-5524.

DENNIS L HANDKE

1820 NW 59th Terrace
TOPEKA, KANSAS 66618
785-286-4047 Home

Jess Chapman
Larsen & Associates
1311 E. 25th Street, Suite B
Lawrence, Kansas, 66046

December 6, 2019

RE: Monitor Well Elevation Survey
2628.W. 18th St., Emporia, Kansas

Proj. 19-00NN
Emporia Stop 2 Shop #1
U3-056-00608

Bench Mark: Chisled Sq. on East end of East concrete pump island South of building.
Elev: 1172.24 North 72.15 West 2007.50 (from SE Cor. Sec. 5-19-11E)

MW-12	rim	1169.82	South	34.76	NE1/4,NW1/4,NW1/4,NE1/4	(Sec. 8-19-11E)
	top pipe	1169.60	West	2064.83	Lat= 38.41947	Long = 96.21491
MW-13	rim	1170.66	North	90.45	SW1/4,SE1/4,SW4,SE1/4	
	top pipe	1170.42	West	1819.66	Lat= 38.41982	Long = 96.21405

Lat & Long derived from Emporia 7.5 quad map. WGS84.

Elevation established from existing project.

If you have any questions, please feel free to call me. Thank you for the opportunity to be of service to you.

Dennis L Handke RLS
December 6, 2019
LS-785
Dennis L Handke
KANSAS
LAND SURVEYOR

NOTE: Figures exhibited within this report are only to be used within the context of this report. Placement of property lines, wells, structures, and roads is based on the available information from county appraiser maps, surveys, site visits, and/or previous vendor reports and should be considered approximate.

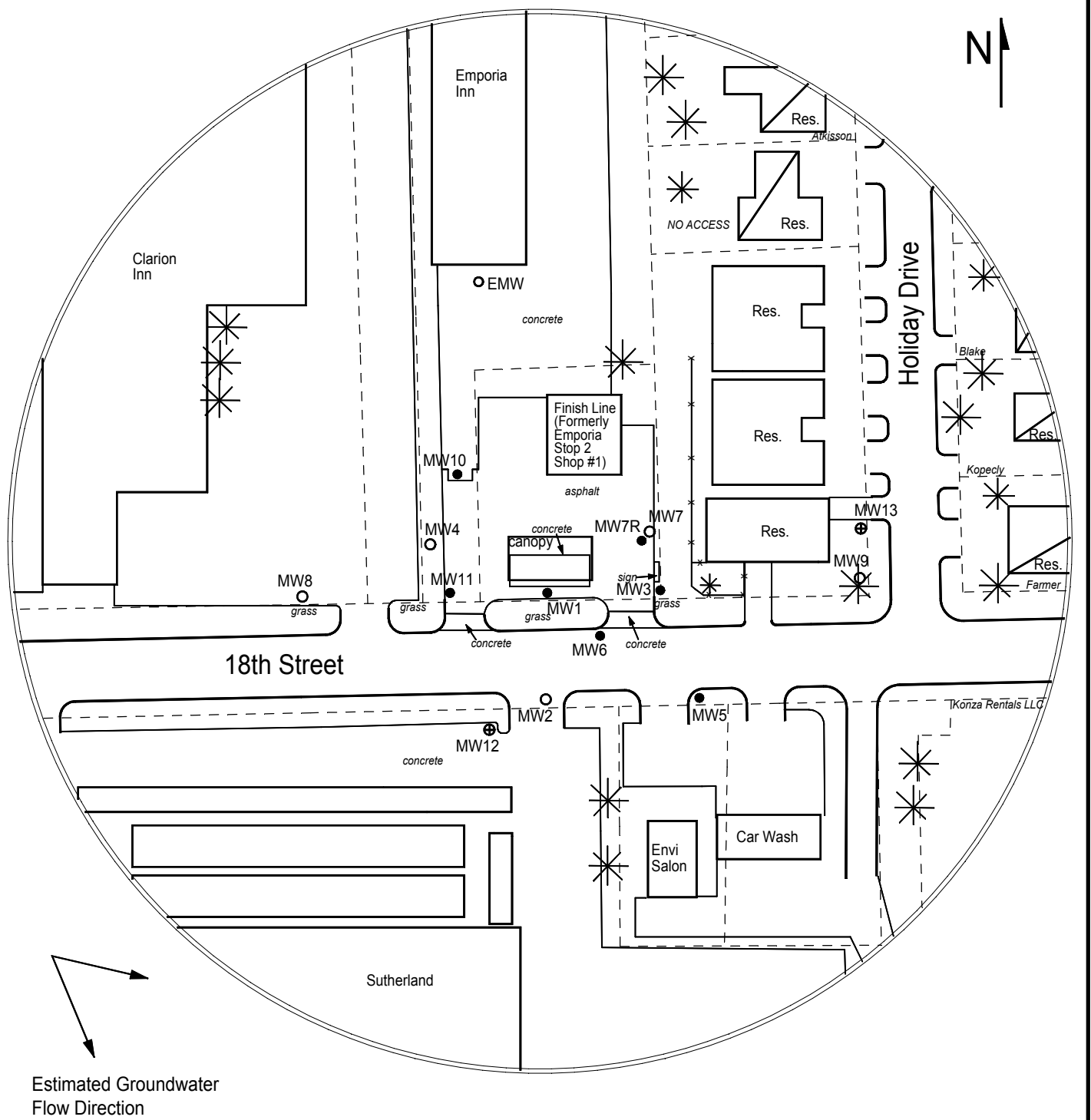

FIGURE 2.1 - 350 FT RADIUS AREA BASE MAP



PROJECT:
 Emporia Stop 2 Shop #1
 2628 W 18th St.
 Emporia, KS
 KDHE ID: U3-056-00608
 Date: 11/22/19

LEGEND:

- Approximate Location of Active UST Basin & Pump Islands
- Building with Basement
- Approximate Location of Property Line
- Existing Monitoring Well
- Monitoring Well (Drilled 11/21/19)
- Plugged Well
- Gas Lines (1.5 - 3 ft bgs)
- Overhead Lines (25'-40' high)
- Telephone Lines (2 - 6 ft bgs)
- Water Lines (1.5 - 3 ft bgs)

1311 E 25th St. Suite B 785-841-8707 office
 Lawrence, KS 66046 785-865-4282 fax



NOTE: SB8 & SB9 were drilled to collect hydrologic samples.
 NOTE: Utility depths, heights and locations are approximate.