

WATER WELL RECORD

Form WWC-5

Division of Water Resources App. No.

Well ID

MW12

Original Record Correction Change in Well Ust

1 LOCATION OF WATER WELL: County Lyon Section Number 8 Township Number T 19 S Range Number R 11 E W

2 WELL OWNER: Last Name: Business: KDHE (Emporia Stop 2 Shop #1) Address: 1000 SW Jackson Blvd City: Topeka State: KS ZIP: 66612 Street or Rural Address where well is located (if unknown, distance and direction from nearest town or intersection): If at owner's address, check here: ~70ft S of 2628 W 18th St., Emporia, KS

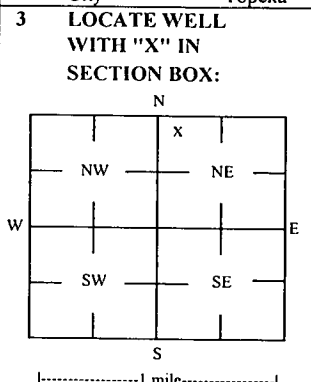

3 LOCATE WELL WITH 'X' IN SECTION BOX: 4 DEPTH OF COMPLETED WELL: 14.5 ft Depth(s) Groundwater Encountered: 1) 14.5 ft 2) ft 3) ft, or 4) Dry Well WELL'S STATIC WATER LEVEL: 7.03 ft. [X] below land surface, measured on (mo-day-yr) 11/22/19 [ ] above land surface, measured on (mo-day-yr) Pump test data: Well water was ft after hours pumping gpm Water well was ft after hours pumping gpm Estimated Yield: gpm Bore Hole Diameter: 7.25 in to ft, and in to ft

5 Latitude: 38.41947 (decimal degrees) Longitude: 96.21491 (decimal degrees) Horizontal Datum: [X] WGS 84 [ ] NAD 83 [ ] NAD 27 Source for Latitude/Longitude: [ ] GPS (unit make/model: ) (WAAS enabled? [ ] Yes [ ] No) [X] Land Survey [ ] Topographic Map [ ] Online Mapper 6 Elevation 1169.6 ft [ ] Ground Level [X] TOC Source [X] Land Survey [ ] GPS [ ] Topographic Map [ ] Other

7 WELL WATER TO BE USED AS: 1 Domestic: [ ] Household [ ] Lawn & Garden [ ] Livestock [ ] Irrigation [ ] Feedlot [ ] Industrial 5 [ ] Public Water Supply: well ID 6 [ ] Dewatering: how many wells? 7 [ ] Aquifer Recharge: well ID 8 [X] Monitoring: well ID MW12 9 Environmental Remediation: well ID [ ] Air Sparge [ ] Soil Vapor Extractor [ ] Recovery [ ] Injection 10 [ ] Oil Field Water Supply: lease 11 Test Hole: well ID [ ] Cased [ ] Uncased [ ] Geotechnical 12 Geothermal: How many bores? a) Closed Loop [ ] Horizontal [ ] Vertical b) Open Loop [ ] Surface Discharge [ ] Inj. of Water [ ] Other (specify):

Was a chemical/bacteriological sample submitted to KDHE? [ ] Yes [X] No If yes, date sample was submitted: Water well disinfected? [ ] Yes [X] No

8 TYPE OF CASING USED: [ ] Steel [X] PVC [ ] Other CASING JOINTS: [ ] Glued [ ] Clamped [ ] Welded [X] Threaded Casing diameter 2 in. to 4.5 ft, Diameter in. to ft, Diameter in. to ft, Casing height above land surface -0.22 in. Weight lbs./ft. Well thickness or gauge No TYPE OF SCREEN OR PERFORATION MATERIAL: [ ] Steel [ ] Stainless Steel [ ] Fiberglass [X] PVC [ ] Brass [ ] Galvanized Steel [ ] Concrete tile [ ] None used (open hole) [ ] Other (Specify) SCREEN OR PERFORATION OPENINGS ARE: [ ] Continuous Slot [X] Mill Slot [ ] Gauze Wrapped [ ] Torch Cut [ ] Drilled Holes [ ] Other (Specify) [ ] Louvered Shutter [ ] Key Punched [ ] Wire Wrapped [ ] Saw Cut [ ] None (Open Hole) SCREEN-PERFORATED INTERVALS: From 4.5 ft. to 14.5 ft, From ft. to ft, From ft. to ft, GRAVEL PACK INTERVALS: From 2.5 ft. to 14.5 ft, From ft. to ft, From ft. to ft,

9 GROUT MATERIAL: [ ] Neat cement [ ] Cement grout [X] Bentonite [X] Other Concrete: 0-0.5' Grout intervals: From 0.5 ft. to 2.5 ft, From ft. to ft, From ft. to ft,

Nearest source of possible contamination: [ ] Septic Tank [ ] Lateral Lines [ ] Pit Privy [ ] Livestock Pens [ ] Insecticide Storage [ ] Sewer Lines [ ] Cess Pool [ ] Sewage Lagoon [X] Fuel Storage [ ] Abandoned Water Well [ ] Watertight Sewer Lines [ ] Seepage Pit [ ] Feedyard [ ] Fertilizer Storage [ ] Oil Well / Gas Well [ ] Other (Specify)

Direction from well? N-NE Distance from well? ~100 ft

Table with 6 columns: FROM, TO, LITHOLOGIC LOG, FROM, TO, LITHO. LOG (cont.) or PLUGGING INTERVALS. Rows: 0-0.3 Concrete, 0.3-1 Gravel/fill, 1-7 Silty clay, 7-14.5 Weathered shale.

Notes: KDHE ID: Emporia Stop 2 Shop #1; U3-056-00608 Target of monitoring well is shallow groundwater, <20' of grout was installed at the direction of KDHE.

11 CONTRACTOR'S OR LANDOWNER'S CERTIFICATION: This water well was [X] constructed, [ ] reconstructed, or [ ] plugged under my jurisdiction and was completed on (mo-day-year) 11/21/19 and this record is true to the best of my knowledge and belief. Kansas Water Well Contractor's License No 757 This Water Well Record was completed on (mo-day-year) 12/13/19 under the business name of Larsen & Associates, Inc. Signature

# DENNIS L HANDKE

1820 NW 59th Terrace  
TOPEKA, KANSAS 66618  
785-286-4047 Home

Jess Chapman  
Larsen & Associates  
1311 E. 25<sup>th</sup> Street, Suite B  
Lawrence, Kansas, 66046

December 6, 2019

RE: Monitor Well Elevation Survey  
2628.W. 18<sup>th</sup> St., Emporia, Kansas

Proj. 19-00NN  
Emporia Stop 2 Shop #1  
U3-056-00608

Bench Mark: Chisled Sq. on East end of East concrete pump island South of building.  
Elev: 1172.24      North 72.15      West 2007.50      (from SE Cor. Sec. 5-19-11E)

MW-12	rim	1169.82	South	34.76	NE1/4,NW1/4,NW1/4,NE1/4	(Sec. 8-19-11E)
	top pipe	1169.60	West	2064.83	Lat= 38.41947	Long = 96.21491
MW-13	rim	1170.66	North	90.45	SW1/4,SE1/4,SW4,SE1/4	
	top pipe	1170.42	West	1819.66	Lat= 38.41982	Long = 96.21405

Lat & Long derived from Emporia 7.5 quad map. WGS84.

Elevation established from existing project.

If you have any questions, please feel free to call me. Thank you for the opportunity to be of service to you.

Dennis L Handke RLS  
December 6, 2019  
LS-785  
*Dennis L Handke*  
KANSAS  
LAND SURVEYOR

NOTE: Figures exhibited within this report are only to be used within the context of this report. Placement of property lines, wells, structures, and roads is based on the available information from county appraiser maps, surveys, site visits, and/or previous vendor reports and should be considered approximate.

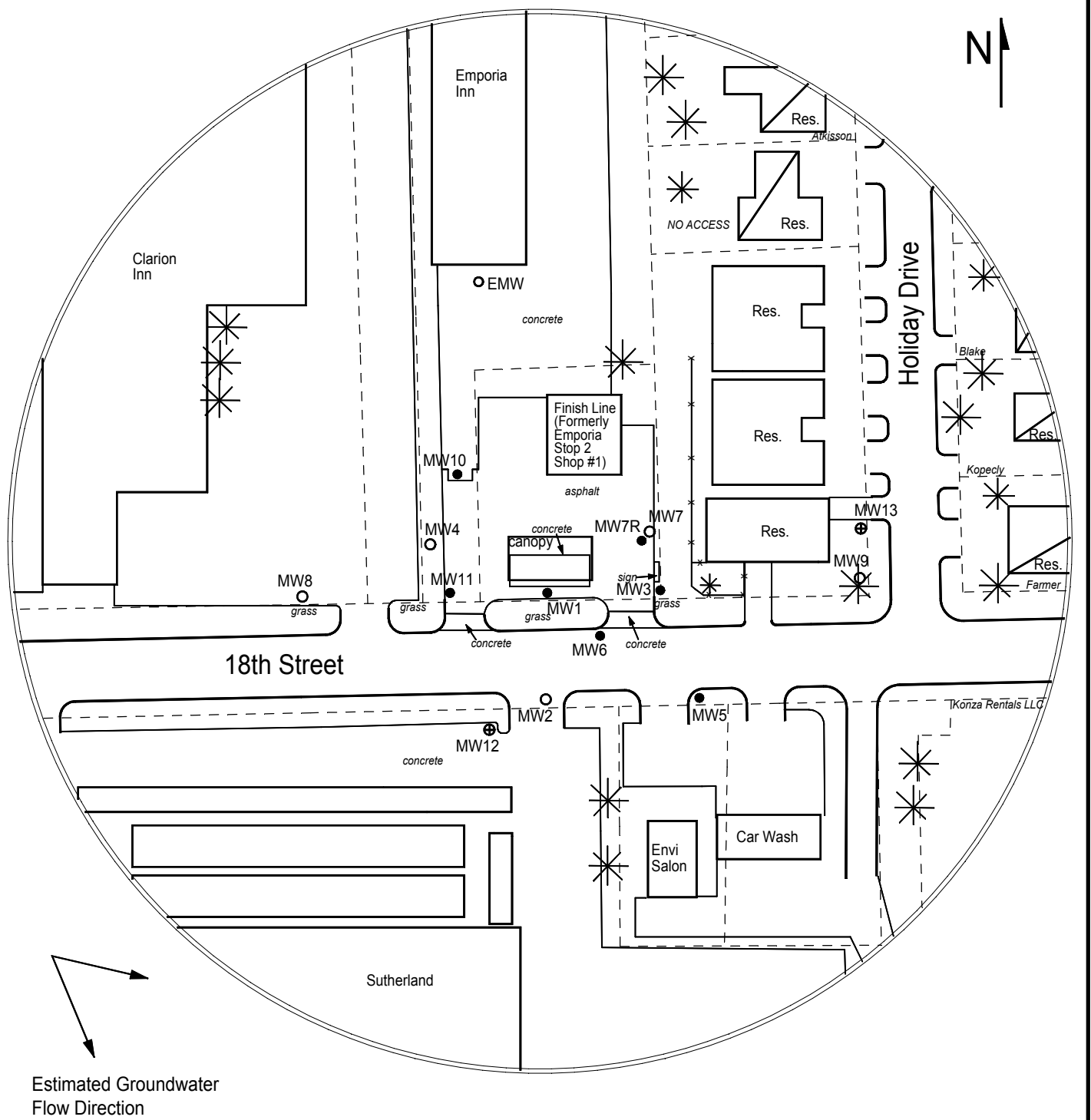

FIGURE 2.1 - 350 FT RADIUS AREA BASE MAP



**PROJECT:**  
 Emporia Stop 2 Shop #1  
 2628 W 18th St.  
 Emporia, KS  
 KDHE ID: U3-056-00608  
 Date: 11/22/19

1311 E 25th St. Suite B    785-841-8707 office  
 Lawrence, KS 66046      785-865-4282 fax



**LEGEND:**

- Approximate Location of Active UST Basin & Pump Islands
- Building with Basement
- Approximate Location of Property Line
- Existing Monitoring Well (Drilled 11/21/19)
- Plugged Well
- Gas Lines (1.5 - 3 ft bgs)
- Overhead Lines (25'-40' high)
- Telephone Lines (2 - 6 ft bgs)
- Water Lines (1.5 - 3 ft bgs)

NOTE: SB8 & SB9 were drilled to collect hydrologic samples.  
 NOTE: Utility depths, heights and locations are approximate.