

**WATER WELL PLUGGING RECORD Form WWC-5P KSA 82a-1212 ID NO.**

MW5

**1 LOCATION OF WATER WELL:** Fraction NE 1/4 NW 1/4 NW 1/4 Section Number 15 Township Number T 18 19 S R 8A Range Number 11  E  W  
 County: LYON

Street/Rural Address of Well Location; if unknown, distance & direction from nearest town or intersection: If at owner's address, check here  423 W. 6TH EMPORIA, KS 66801

**Global Positioning Systems (GPS) information:**  
 Latitude: 38.4048 (in decimal degrees)  
 Longitude: -96.18587 (in decimal degrees)  
 Elevation: 1153.76  
 Horizontal Datum:  WGS84,  NAD83,  NAD27  
 Collection Method:

**2 WATER WELL OWNER:** WENGER OIL, INC.  
 RR#, St. Address, Box #: PO BOX 295  
 City, State ZIP Code: NEWTON, KS 67114

GPS unit (Make/Model: \_\_\_\_\_)  
 Digital Map/Photo,  Topographic Map,  Land Survey  
 Est. Accuracy:  < 3 m,  3-5 m,  5-15 m,  > 15 m

**3 MARK WELL'S LOCATION WITH AN "X" IN SECTION BOX:**

N		
X		
NW		NE
W		E
SW		SE
S		

**4 DEPTH OF WELL** 41.68 ft.  
 WELL'S STATIC WATER LEVEL 34.35 ft.  
 WELL WAS USED AS:  
 Domestic  Public Water Supply  Dewatering  
 Irrigation  Oil Field Water Supply  Monitoring  
 Feedlot  Domestic (Lawn & Garden)  Injection Well  
 Industrial  Air Conditioning  Other \_\_\_\_\_  
 Was a chemical/bacteriological sample submitted to Department? Yes  No

**5 TYPE OF BLANK CASING USED:**

Steel  RMP (SR)  Wrought  Fiberglass  Other (Specify below) \_\_\_\_\_  
 PVC  ABS  Asbestos-Cement  Concrete Tile

Blank casing diameter 2 in. Was casing pulled? Yes  No  If yes, how much 3'  
 Casing height above or below land surface 30 in. BA

**6 GROUT PLUG MATERIAL:**  Neat cement  Cement grout  Bentonite  Other CONCRETE 0-0.5

Grout Plug Intervals: From 0.5 ft. to 41.68 ft., From \_\_\_\_\_ ft. to \_\_\_\_\_ ft., From \_\_\_\_\_ ft. to \_\_\_\_\_ ft.

What is the nearest source of possible contamination:  
 Septic tank  Seepage pit  Fuel storage  Other (specify below) \_\_\_\_\_  
 Sewer lines  Pit privy  Fertilizer storage \_\_\_\_\_  
 Watertight sewer lines  Sewage lagoon  Insecticide storage \_\_\_\_\_  
 Lateral lines  Feedyard  Abandoned water well Direction from well? EAST  
 Cess pool  Livestock pens  Oil well/Gas well How many feet? 25

FROM	TO	PLUGGING MATERIALS	FROM	TO	PLUGGING MATERIALS
0	0.5	CONCRETE			
0.5	41.68	BENTONITE			

**7 CONTRACTOR'S OR LANDOWNER'S CERTIFICATION:** This water well was plugged under my jurisdiction and was completed on (mo/day/year) 1/16/23 and this record is true to the best of my knowledge and belief. Kansas Water Well Contractor's License No. 585. This Water Well Record was completed on (mo/day/year) 1/19/23 under the business name of ASSOCIATED ENVIRONMENTAL INC. by (signature) [Signature]

Send one white copy to Kansas Department of Health & Environment, Geology Section, 1000 SW Jackson Street, Ste. 420, Topeka, KS 66612-1367. Send one copy to WATER WELL OWNER and retain one for your records.  
 Visit us at <http://www.kdheks.gov/waterwell/index.html> Telephone 785-296-5524.

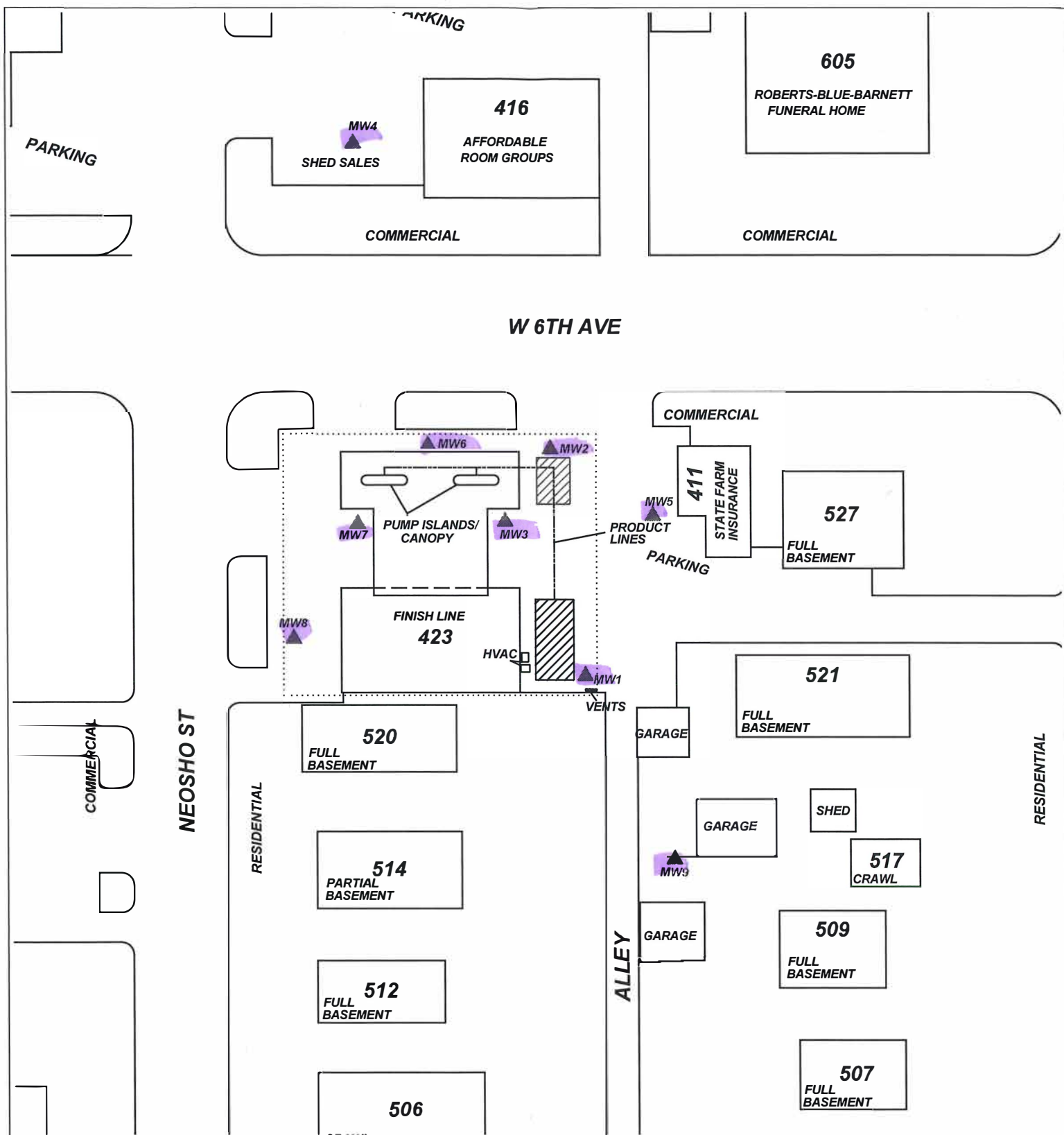

PROJECT: **Emporia Downtown Stop 2 Shop**

ADDRESS: **423 W. 6th**

LOCATION: **Emporia, KS**

DRAWN BY: **B. Scott** DATE: **02/28/13**

REVISED BY: **C. Roe** DATE: **02/05/15**

AEI JOB #: **TF455** KDHE JOB #: **U3-056-14486**

TITLE: **Figure 2.3 Site Map Close-Up**

**ASSOCIATED ENVIRONMENTAL INC.**

LEGEND:

- = Former USTs
- = (1) 10,000 g. & (2) 8,000 g. gasoline USTs
- = PLUGGED/DESTROYED WELL
- = Site Property Boundary

T. 19 R.11E Sec. 15  
Lyon County

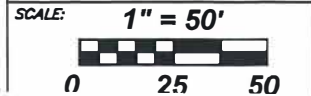

NOTES: