

WATER WELL PLUGGING RECORD Form WWC-5P

KSA 82a-1212 ID NO.

MW4

1 LOCATION OF WATER WELL: Fraction SE 1/4 SW 1/4 SW 1/4 1/4 Section Number 10 Township Number T 18 19 S 8A Range Number 11 E W
 County: LYON
 Street/Rural Address of Well Location; if unknown, distance & direction from nearest town or intersection: If at owner's address, check here 423 W. 6TH EMPORIA, KS 66801
Global Positioning Systems (GPS) information:
 Latitude: 38.40518 (in decimal degrees)
 Longitude: -96.18635 (in decimal degrees)
 Elevation: 1155.82
 Horizontal Datum: WGS84, NAD83, NAD27
 Collection Method:

2 WATER WELL OWNER: WENGER OIL, INC.
 RR#, St. Address, Box #: PO BOX 295
 City, State ZIP Code: NEWTON, KS 67114
 GPS unit (Make/Model: _____)
 Digital Map/Photo, Topographic Map, Land Survey
 Est. Accuracy: < 3 m, 3-5 m, 5-15 m, > 15 m

3 MARK WELL'S LOCATION WITH AN "X" IN SECTION BOX:

	N	
W	NW	NE
	SW	SE
	X	
	S	E

4 DEPTH OF WELL 44.51 ft.
 WELL'S STATIC WATER LEVEL 36.03 ft.
 WELL WAS USED AS:
 Domestic Public Water Supply Dewatering
 Irrigation Oil Field Water Supply Monitoring
 Feedlot Domestic (Lawn & Garden) Injection Well
 Industrial Air Conditioning Other _____
 Was a chemical/bacteriological sample submitted to Department? Yes No

5 TYPE OF BLANK CASING USED:
 Steel RMP (SR) Wrought Fiberglass Other (Specify below) _____
 PVC ABS Asbestos-Cement Concrete Tile
 Blank casing diameter 2 in. Was casing pulled? Yes No If yes, how much 3'
 Casing height above or below land surface 36 ft. in.

6 GROUT PLUG MATERIAL: Neat cement Cement grout Bentonite Other CONCRETE 0-0.5
 Grout Plug Intervals: From 0.5 ft. to 44.51 ft., From _____ ft. to _____ ft., From _____ ft. to _____ ft.
 What is the nearest source of possible contamination:
 Septic tank Seepage pit Fuel storage Other (specify below) _____
 Sewer lines Pit privy Fertilizer storage _____
 Watertight sewer lines Sewage lagoon Insecticide storage _____
 Lateral lines Feedyard Abandoned water well Oil well/Gas well
 Cess pool Livestock pens
 Direction from well? NORTH
 How many feet? 50

FROM	TO	PLUGGING MATERIALS	FROM	TO	PLUGGING MATERIALS
0	0.5	CONCRETE			
0.5	44.51	BENTONITE			

7 CONTRACTOR'S OR LANDOWNER'S CERTIFICATION: This water well was plugged under my jurisdiction and was completed on (mo/day/year) 1/16/23 and this record is true to the best of my knowledge and belief. Kansas Water Well Contractor's License No. 585. This Water Well Record was completed on (mo/day/year) 1/19/23 under the business name of ASSOCIATED ENVIRONMENTAL INC. by (signature) _____

Send one white copy to Kansas Department of Health & Environment, Geology Section, 1000 SW Jackson Street, Ste. 420, Topeka, KS 66612-1367. Send one copy to WATER WELL OWNER and retain one for your records.
 Visit us at <http://www.kdheks.gov/waterwell/index.html> Telephone 785-296-5524.

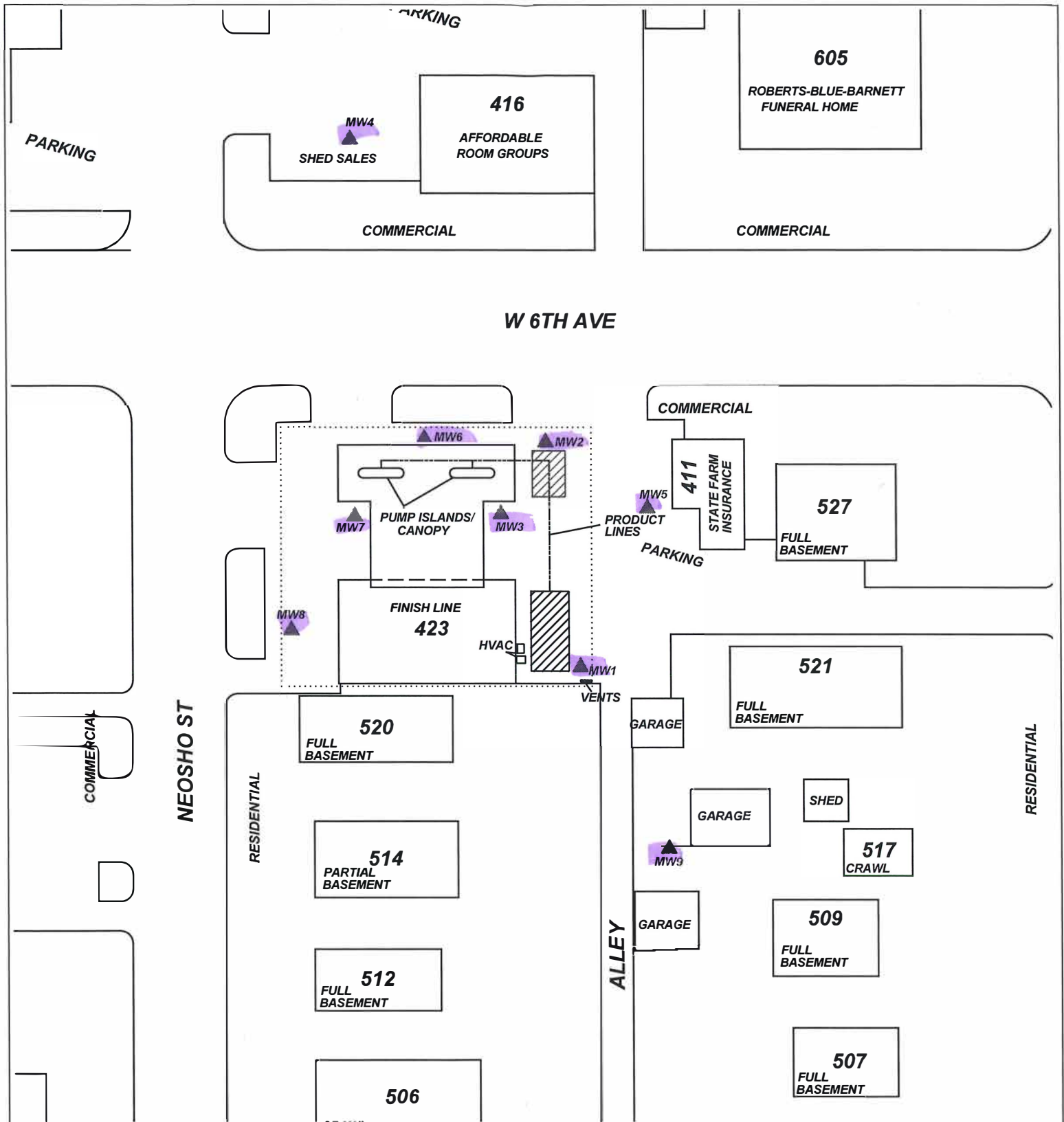

PROJECT: **Emporia Downtown Stop 2 Shop**

ADDRESS: **423 W. 6th**

LOCATION: **Emporia, KS**

DRAWN BY: **B. Scott** DATE: **02/28/13**

REVISED BY: **C. Roe** DATE: **02/05/15**

AEI JOB #: **TF455** KDHE JOB #: **U3-056-14486**

TITLE: **Figure 2.3
Site Map
Close-Up**

**ASSOCIATED
ENVIRONMENTAL
INC.**

LEGEND:

- = Former USTs
- = (1) 10,000 g. & (2) 8,000 g. gasoline USTs
- = PLUGGED/DESTROYED WELL
- = Site Property Boundary

T. 19 R.11E Sec. 10
Lyon County

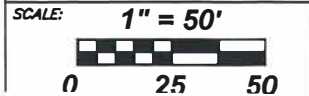

NOTES: