

**WATER WELL PLUGGING RECORD Form WWC-5P**

**KSA 82a-1212 ID NO.**

MW9

<b>1 LOCATION OF WATER WELL:</b> County: LYON	Fraction NE ¼ NW¼ NW ¼ ¼	Section Number 15	Township Number T 18 19 S 8 R	Range Number 11 <input checked="" type="checkbox"/> E <input type="checkbox"/> W
--	-----------------------------	----------------------	----------------------------------	---

Street/Rural Address of Well Location; if unknown, distance & direction from nearest town or intersection: If at owner's address, check here  423 W. 6TH  
EMPORIA, KS 66801

**Global Positioning Systems (GPS) information:**  
 Latitude: 38.40442 (in decimal degrees)  
 Longitude: -96.18586 (in decimal degrees)  
 Elevation: 1153.61  
 Horizontal Datum:  WGS84,  NAD83,  NAD27  
 Collection Method:

**2 WATER WELL OWNER: WENGER OIL, INC.**  
 RR#, St. Address, Box #: PO BOX 295  
 City, State ZIP Code: NEWTON, KS 67114

GPS unit (Make/Model: \_\_\_\_\_)  
 Digital Map/Photo,  Topographic Map,  Land Survey  
 Est. Accuracy:  < 3 m,  3-5 m,  5-15 m,  > 15 m

**3 MARK WELL'S LOCATION WITH AN "X" IN SECTION BOX:**

	N	
X		
NW		NE
SW		SE
	S	

**4 DEPTH OF WELL 43.85 ft.**  
 WELL'S STATIC WATER LEVEL 34.29 ft  
 WELL WAS USED AS:

<input type="checkbox"/> Domestic	<input type="checkbox"/> Public Water Supply	<input type="checkbox"/> Dewatering
<input type="checkbox"/> Irrigation	<input type="checkbox"/> Oil Field Water Supply	<input checked="" type="checkbox"/> Monitoring
<input type="checkbox"/> Feedlot	<input type="checkbox"/> Domestic (Lawn & Garden)	<input type="checkbox"/> Injection Well
<input type="checkbox"/> Industrial	<input type="checkbox"/> Air Conditioning	<input type="checkbox"/> Other _____

Was a chemical/bacteriological sample submitted to Department? Yes  No

**5 TYPE OF BLANK CASING USED:**

<input type="checkbox"/> Steel	<input type="checkbox"/> RMP (SR)	<input type="checkbox"/> Wrought	<input type="checkbox"/> Fiberglass	<input type="checkbox"/> Other (Specify below)
<input checked="" type="checkbox"/> PVC	<input type="checkbox"/> ABS	<input type="checkbox"/> Asbestos-Cement	<input type="checkbox"/> Concrete Tile	

Blank casing diameter 2 in. Was casing pulled? Yes  No  If yes, how much 3'  
 Casing height above or below land surface 36 in.

**6 GROUT PLUG MATERIAL:**  Neat cement  Cement grout  Bentonite  Other SOIL 0-0.5

Grout Plug Intervals: From 0.5 ft. to 43.85 ft., From \_\_\_\_\_ ft. to \_\_\_\_\_ ft., From \_\_\_\_\_ ft. to \_\_\_\_\_ ft.

What is the nearest source of possible contamination:

<input type="checkbox"/> Septic tank	<input type="checkbox"/> Seepage pit	<input checked="" type="checkbox"/> Fuel storage	<input type="checkbox"/> Other (specify below)
<input type="checkbox"/> Sewer lines	<input type="checkbox"/> Pit privy	<input type="checkbox"/> Fertilizer storage	
<input type="checkbox"/> Watertight sewer lines	<input type="checkbox"/> Sewage lagoon	<input type="checkbox"/> Insecticide storage	
<input type="checkbox"/> Lateral lines	<input type="checkbox"/> Feedyard	<input type="checkbox"/> Abandoned water well	Direction from well? <u>NORTH</u>
<input type="checkbox"/> Cess pool	<input type="checkbox"/> Livestock pens	<input type="checkbox"/> Oil well/Gas well	How many feet? <u>60</u>

FROM	TO	PLUGGING MATERIALS	FROM	TO	PLUGGING MATERIALS
0	0.5	SOIL			
0.5	43.85	BENTONITE			

**7 CONTRACTOR'S OR LANDOWNER'S CERTIFICATION:** This water well was plugged under my jurisdiction and was completed on (mo/day/year) 1/16/23 and this record is true to the best of my knowledge and belief. Kansas Water Well Contractor's License No. 585. This Water Well Record was completed on (mo/day/year) 1/19/23 under the business name of ASSOCIATED ENVIRONMENTAL INC. by (signature) \_\_\_\_\_

Send one white copy to Kansas Department of Health & Environment, Geology Section, 1000 SW Jackson Street, Ste. 420, Topeka, KS 66612-1367. Send one copy to WATER WELL OWNER and retain one for your records.  
 Visit us at <http://www.kdheks.gov/waterwell/index.html> Telephone 785-296-5524.

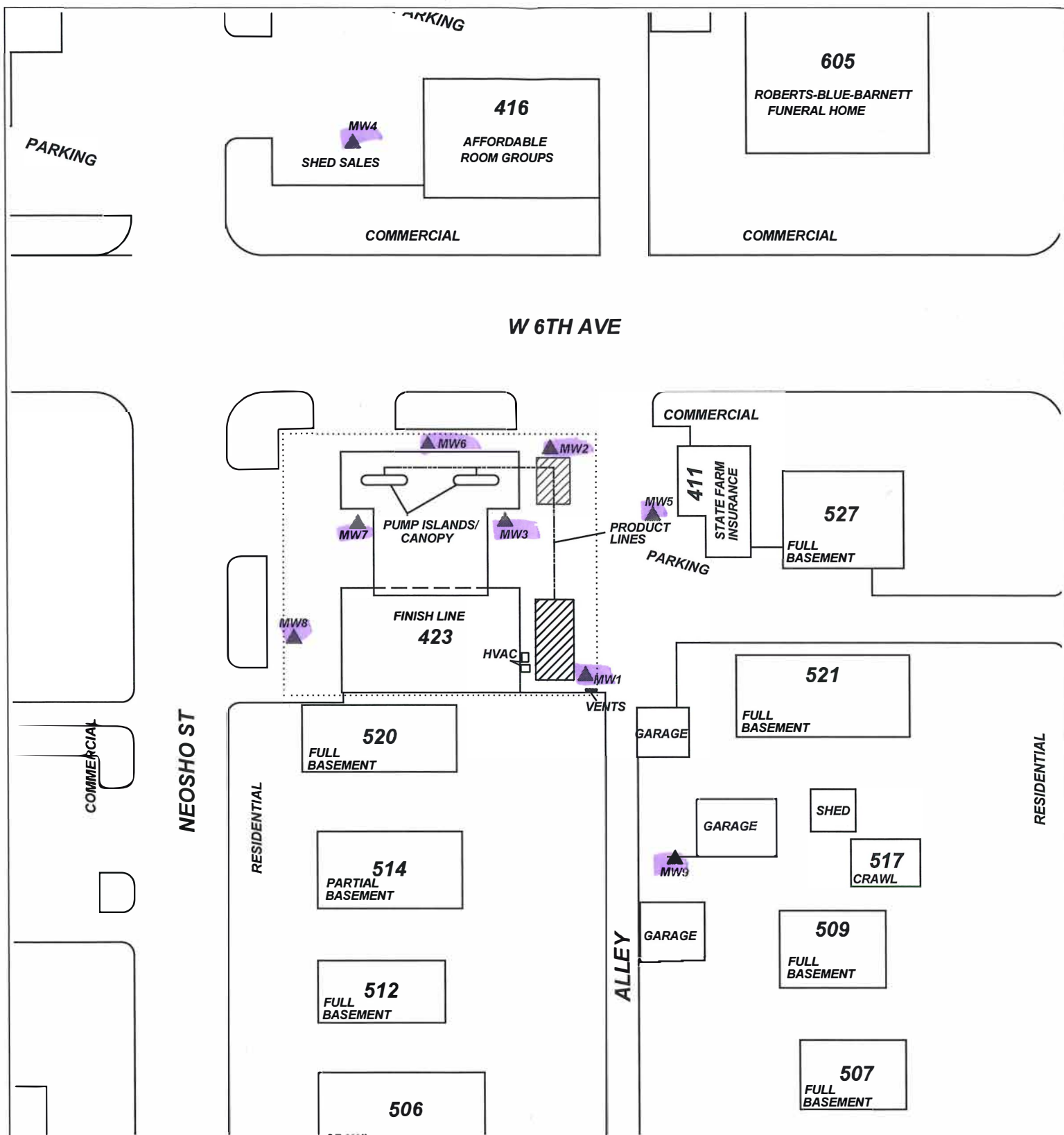

PROJECT: **Emporia Downtown Stop 2 Shop**

ADDRESS: **423 W. 6th**

LOCATION: **Emporia, KS**

DRAWN BY: **B. Scott** DATE: **02/28/13**

REVISED BY: **C. Roe** DATE: **02/05/15**

AEI JOB #: **TF455** KDHE JOB #: **U3-056-14486**

TITLE: **Figure 2.3 Site Map Close-Up**

**ASSOCIATED ENVIRONMENTAL INC.**

LEGEND:

- = Former USTs
- = (1) 10,000 g. & (2) 8,000 g. gasoline USTs
- = PLUGGED/DESTROYED WELL
- = Site Property Boundary

T. 19 R.11E Sec. 15  
Lyon County

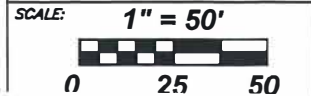

NOTES: