

WATER WELL RECORD

Form WWC-5

Division of Water Resources App. No.

[Empty box]

Well ID

MW17R

[X] Original Record [] Correction [] Change in Well Use

1 LOCATION OF WATER WELL: County Marion Fraction SW 1/4 SE 1/4 SW 1/4 SW 1/4 Section Number 34 Township Number T 19 S Range Number R 2 E W

2 WELL OWNER: Last Name: Wood First: Steve Business: Prime Time Stores of Kansas, Inc. Address: PO Box 1720 City: Forsyth State: MO ZIP: 67653 Street or Rural Address where well is located (if unknown, distance and direction from nearest town or intersection): 200 East D St., Hillsboro, KS

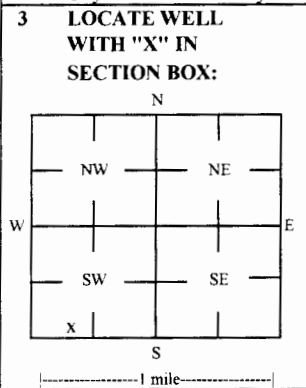

3 LOCATE WELL WITH 'X' IN SECTION BOX: 4 DEPTH OF COMPLETED WELL: 30 ft Depth(s) Groundwater Encountered: 1) 30 ft 2) ft 3) ft, or 4) [] Dry Well WELL'S STATIC WATER LEVEL: NA ft. [X] below land surface, measured on (mo-day-yr) NA [] above land surface, measured on (mo-day-yr) Pump test data: Well water was ft after hours pumping gpm Water well was ft after hours pumping gpm Estimated Yield: gpm Bore Hole Diameter: 7.25 in to ft, and in to ft

5 Latitude: 38.34817 (decimal degrees) Longitude: 97.20315 (decimal degrees) Horizontal Datum: [] WGS 84 [] NAD 83 [] NAD 27 Source for Latitude/Longitude: [] GPS (unit make/model:) (WAAS enabled? [] Yes [] No) [X] Land Survey [] Topographic Map [] Online Mapper

6 Elevation 1419.4 ft [] Ground Level [X] TOC Source [X] Land Survey [] GPS [] Topographic Map [] Other

7 WELL WATER TO BE USED AS: 1 Domestic: [] Household [] Lawn & Garden [] Livestock [] Irrigation [] Feedlot [] Industrial 2 [] Public Water Supply: well ID 3 [] Dewatering: how many wells? 4 [] Aquifer Recharge: well ID 5 [X] Monitoring: well ID MW17R 6 [] Environmental Remediation: well ID 7 [] Air Sparge [] Soil Vapor Extractor 8 [] Recovery [] Injection 9 [] Oil Field Water Supply: lease 10 [] Test Hole: well ID [] Cased [] Uncased [] Geotechnical 11 [] Geothermal: How many bores? a) Closed Loop [] Horizontal [] Vertical b) Open Loop [] Surface Discharge [] Inj. of Water [] Other (specify):

Was a chemical/bacteriological sample submitted to KDHE? [] Yes [X] No If yes, date sample was submitted: Water well disinfected? [] Yes [X] No

8 TYPE OF CASING USED: [] Steel [X] PVC [] Other CASING JOINTS: [] Glued [] Clamped [] Welded [X] Threaded Casing diameter 2 in. to 15 ft, Diameter in. to ft, Diameter in. to ft, Casing height above land surface -0.24 in. Weight lbs./ft. Well thickness or gauge No TYPE OF SCREEN OR PERFORATION MATERIAL: [] Steel [] Stainless Steel [] Fiberglass [X] PVC [] Brass [] Galvanized Steel [] Concrete tile [] None used (open hole) [] Other (Specify) SCREEN OR PERFORATION OPENINGS ARE: [] Continuous Slot [X] Mill Slot [] Gauze Wrapped [] Torch Cut [] Drilled Holes [] Other (Specify) [] Louvered Shutter [] Key Punched [] Wire Wrapped [] Saw Cut [] None (Open Hole) SCREEN-PERFORATED INTERVALS: From 15 ft. to 30 ft. From ft. to ft. From ft. to ft. GRAVEL PACK INTERVALS: From 13 ft. to 30 ft. From ft. to ft. From ft. to ft.

9 GROUT MATERIAL: [] Neat cement [] Cement grout [X] Bentonite [X] Other Concrete: 0-0.5' Grout intervals: From 0.5 ft. to 13.30 ft. From ft. to ft. From ft. to ft.

Nearest source of possible contamination: [] Septic Tank [] Lateral Lines [] Pit Privy [] Livestock Pens [] Insecticide Storage [] Sewer Lines [] Cess Pool [] Sewage Lagoon [X] Fuel Storage [] Abandoned Water Well [] Watertight Sewer Lines [] Seepage Pit [] Feedyard [] Fertilizer Storage [] Oil Well / Gas Well [] Other (Specify) Direction from well? N Distance from well? ~70 ft

Table with 6 columns: FROM, TO, LITHOLOGIC LOG, FROM, TO, LITHO. LOG (cont.) or PLUGGING INTERVALS. Rows show geological layers: Clay, Sandy clay, Sand, Silty clay, Clay, Weathered shale.

Target of monitoring well is shallow groundwater, <20' of grout was installed at the direction of KDHE.

11 CONTRACTOR'S OR LANDOWNER'S CERTIFICATION: This water well was [X] constructed, [] reconstructed, or [] plugged under my jurisdiction and was completed on (mo-day-year) 10/17/17 and this record is true to the best of my knowledge and belief. Kansas Water Well Contractor's License No 757 This Water Well Record was completed on (mo-day-year) 11/9/17 under the business name of Larsen & Associates, Inc. Signature

Mail 1 white copy along with a fee of \$5.00 for each constructed well to: Kansas Department of Health and Environment, Bureau of Water, GWTS Section, 1000 SW Jackson St., Suite 420, Topeka, Kansas 66612-1367. Mail one to Water Well Owner and retain one for your records. Telephone 785-296-5524.

SMH CONSULTANTS

November 2, 2017

Blackstone Environmental
Lindsay E. James, R.G.
9153 West 133rd Street
Overland Park, Kansas 66213
Email: ljames@blackstone-env.com

RE: Project No. 1709MN1276

Dear Lindsay:

The following is the information requested on a Monitoring Well Site, MB Foundation, 200 East D Street, Hillsboro, Marion County, Kansas.

Point	North Coord.	East Coord.	Distance SE Cor. North	From S.34 West	Elev. Top Of Rim or PK Nail	Elev. Top of PVC Pipe	Latitude North	Longitude West
SE Corner S.34-T19S-R02E	10000	10000						
MW4R	5098.66	678.50	98.66	4321.50	1420.61	1420.28	38.34827	97.20273
MW14R	5132.12	539.76	132.12	4460.24	1420.40	1420.18	38.34836	97.20322
MW17R	5064.13	558.25	64.13	4441.75	1419.64	1419.40	38.34817	97.20315
MW21R	5044.77	650.30	44.77	4349.70	1420.37	1420.14	38.34812	97.20283
MW22	5062.59	686.77	62.59	4313.23	1420.38	1420.11	38.34817	97.20270
MW23	5177.45	696.62	177.45	4303.38	1421.05	1420.67	38.34848	97.20267
Site BM	5044.23	552.76	44.23	4447.24				BM Elevation = 1420.04

BM Description: "□" Square cut on southwest corner of sign base at southwest corner of site.

MW4R, MW14R, MW17R, MW21R, MW22, MW23 are: SW $\frac{1}{4}$ SE $\frac{1}{4}$ SW $\frac{1}{4}$ S.34-T19S-R02E

If you have any questions please do not hesitate in giving us a call.

Sincerely,



Tim Sloan, L.S.
SMH CONSULTANTS

RECEIVED
NOV 27 2017
BUREAU OF WATER

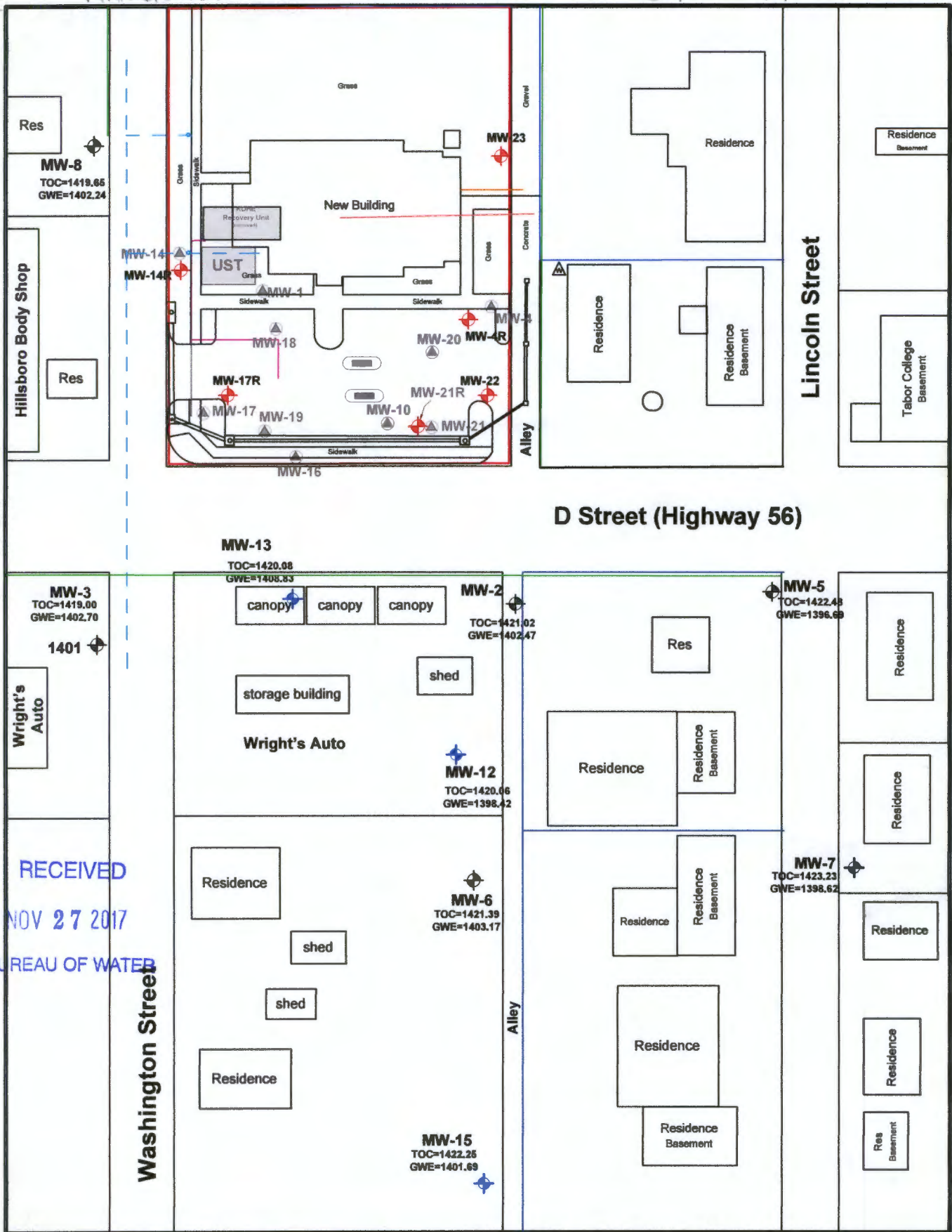

RECEIVED
NOV 27 2017
BUREAU OF WATER

Location of former product piping not available.

<ul style="list-style-type: none"> UST Basin - Removed Pump Islands - Removed Monitoring Well Gauge Only Well Plugged Monitoring Well Lawn & Garden Well (NOT IN SERVICE) 	<ul style="list-style-type: none"> Proposed Replacement Monitoring Well Property Boundary Recovery Line (REMOVED) Fence Line Water Line Overhead Power Lines Sanitary Sewer Line Underground Telephone Line 	<p>50 FEET</p> <p>Groundwater values and contours are expressed in AMSL (Above Mean Sea Level) Contour Interval = 3 feet</p>	<p>CLIENT: Prime Time # 124</p> <p>LOCATION: 200 East D Street, Hillsboro, KS</p> <p>KDHE Project Code No.: US-057-10450</p>	<p>Figure 1</p> <p>MB Foundation Property Map</p> <p>August 2017</p>
---	---	--	--	--