

WATER WELL RECORD

Form WWC-5

Division of Water Resources App. No.

Well ID

MW22

[X] Original Record [] Correction [] Change in Well Ust

1 LOCATION OF WATER WELL: County Marion Fraction SW 1/4 SE 1/4 SW 1/4 SW 1/4 Section Number 34 Township Number T 19 S Range Number R 2 E [X] W

2 WELL OWNER: Last Name: Wood First: Steve Street or Rural Address where well is located (if unknown, distance and direction from nearest town or intersection): 200 East D St., Hillsboro, KS

3 LOCATE WELL WITH "X" IN SECTION BOX: [Diagram showing a 3x3 grid with 'X' in the SW corner]

4 DEPTH OF COMPLETED WELL: 30 ft Depth(s) Groundwater Encountered: 1) _____ ft 2) _____ ft 3) _____ ft, or 4) [] Dry Well

5 Latitude: 38.34817 (decimal degrees) Longitude: 97.20270 (decimal degrees) Horizontal Datum: [] WGS 84 [] NAD 83 [] NAD 27

6 Elevation 1420.11 ft [] Ground Level [X] TOC Source [X] Land Survey [] GPS [] Topographic Map [] Other

7 WELL WATER TO BE USED AS: 1 Domestic: [] Household [] Lawn & Garden [] Livestock [] Irrigation [] Feedlot [] Industrial

Was a chemical/bacteriological sample submitted to KDHE? [] Yes [X] No If yes, date sample was submitted: _____

8 TYPE OF CASING USED: [] Steel [X] PVC [] Other CASING JOINTS: [] Glued [] Clamped [] Welded [X] Threaded

9 GROUT MATERIAL: [] Neat cement [] Cement grout [X] Bentonite [X] Other Concrete: 0-0.5'

Nearest source of possible contamination: [] Septic Tank [] Lateral Lines [] Pit Privy [] Livestock Pens [] Insecticide Storage

Table with columns: FROM, TO, LITHOLOGIC LOG, FROM, TO, LITHO. LOG (cont.) or PLUGGING INTERVALS. Rows show depth intervals and lithology (Clay, Shale).

11 CONTRACTOR'S OR LANDOWNER'S CERTIFICATION: This water well was [X] constructed, [] reconstructed or [] plugged under my jurisdiction and was completed on (mo-day-year) 10/17/17

SMH CONSULTANTS

November 2, 2017

Blackstone Environmental
Lindsay E. James, R.G.
9153 West 133rd Street
Overland Park, Kansas 66213
Email: ljames@blackstone-env.com

RE: Project No. 1709MN1276

Dear Lindsay:

The following is the information requested on a Monitoring Well Site, MB Foundation, 200 East D Street, Hillsboro, Marion County, Kansas.

Point	North Coord.	East Coord.	Distance SE Cor. North	From S.34 West	Elev. Top Of Rim or PK Nail	Elev. Top of PVC Pipe	Latitude North	Longitude West
SE Corner S.34-T19S-R02E	10000	10000						
MW4R	5098.66	678.50	98.66	4321.50	1420.61	1420.28	38.34827	97.20273
MW14R	5132.12	539.76	132.12	4460.24	1420.40	1420.18	38.34836	97.20322
MW17R	5064.13	558.25	64.13	4441.75	1419.64	1419.40	38.34817	97.20315
MW21R	5044.77	650.30	44.77	4349.70	1420.37	1420.14	38.34812	97.20283
MW22	5062.59	686.77	62.59	4313.23	1420.38	1420.11	38.34817	97.20270
MW23	5177.45	696.62	177.45	4303.38	1421.05	1420.67	38.34848	97.20267
Site BM	5044.23	552.76	44.23	4447.24				BM Elevation = 1420.04

BM Description: "□" Square cut on southwest corner of sign base at southwest corner of site.

MW4R, MW14R, MW17R, MW21R, MW22, MW23 are: SW $\frac{1}{4}$ SE $\frac{1}{4}$ SW $\frac{1}{4}$ S.34-T19S-R02E

If you have any questions please do not hesitate in giving us a call.

Sincerely,



Tim Sloan, L.S.
SMH CONSULTANTS

RECEIVED
NOV 27 2017
BUREAU OF WATER

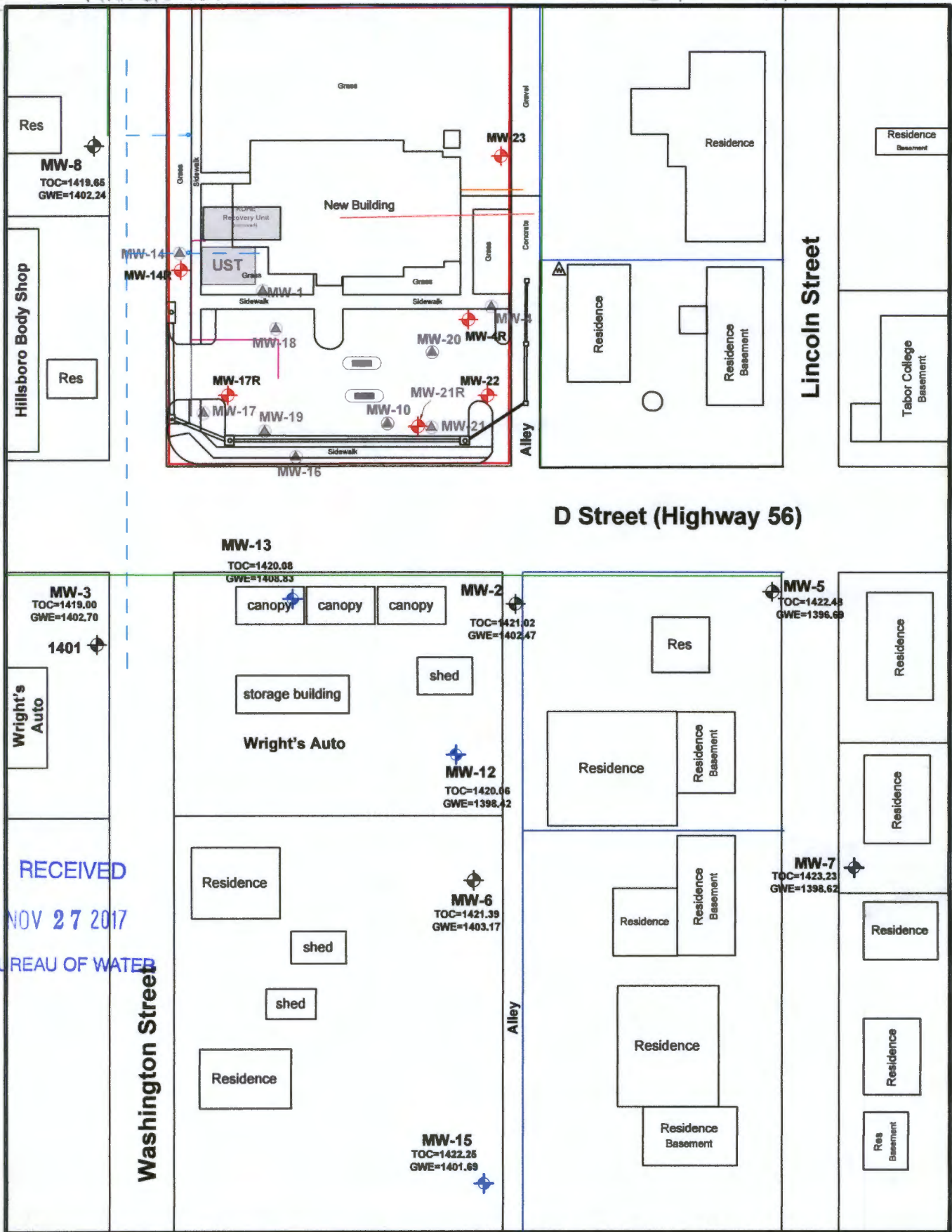

RECEIVED
NOV 27 2017
BUREAU OF WATER

Location of former product piping not available.

<ul style="list-style-type: none"> UST Basin - Removed Pump Islands - Removed Monitoring Well Gauge Only Well Plugged Monitoring Well Lawn & Garden Well (NOT IN SERVICE) 	<ul style="list-style-type: none"> Proposed Replacement Monitoring Well Property Boundary Recovery Line (REMOVED) Fence Line Water Line Overhead Power Lines Sanitary Sewer Line Underground Telephone Line 	<p>50 FEET</p> <p>Groundwater values and contours are expressed in AMSL (Above Mean Sea Level) Contour Interval = 3 feet</p>	<p>CLIENT: Prime Time # 124</p> <p>LOCATION: 200 East D Street, Hillsboro, KS</p> <p>KDHE Project Code No.: US-057-10450</p>	<p>Figure 1</p> <p>MB Foundation Property Map</p> <p>August 2017</p>
---	---	--	--	--