

1 LOCATION OF WATER WELL: County: Doniphan Fraction: SE 1/4 SE 1/4 NW 1/4 Section Number: 36 Township Number: T 1 S Range Number: R 19 E/W

Distance and direction from nearest town or city street address of well if located within city?  
Iowa Point Ks. 66094 Lot 10-18 Block 7

2 WATER WELL OWNER: Randy or SANDRA Nuzum Board of Agriculture, Division of Water Resources  
 RR#, St. Address, Box #: White Cloud, Ks. 66094 Application Number:

3 LOCATE WELL'S LOCATION WITH AN "X" IN SECTION BOX:

4 DEPTH OF COMPLETED WELL: 62 ft. ELEVATION:

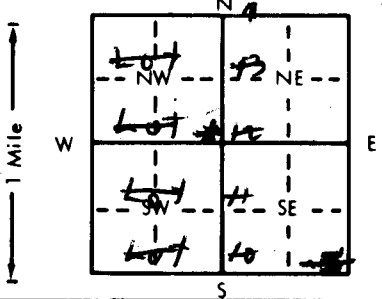

Depth(s) Groundwater Encountered 1. 14 ft. 2. \_\_\_\_\_ ft. 3. \_\_\_\_\_ ft.  
 WELL'S STATIC WATER LEVEL 3' ft. below land surface measured on mo/day/yr 4-19-83  
 Pump test data: Well water was \_\_\_\_\_ ft. after \_\_\_\_\_ hours pumping \_\_\_\_\_ gpm  
 Est. Yield 6 gpm: Well water was \_\_\_\_\_ ft. after \_\_\_\_\_ hours pumping \_\_\_\_\_ gpm  
 Bore Hole Diameter 8 in. to 20 ft., and 5 1/8 in. to 62' ft.  
 WELL WATER TO BE USED AS: 5 Public water supply 8 Air conditioning 11 Injection well  
 Domestic 3 Feedlot 6 Oil field water supply 9 Dewatering 12 Other (Specify below)  
 2 Irrigation 4 Industrial 7 Lawn and garden only 10 Observation well  
 Was a chemical/bacteriological sample submitted to Department? Yes \_\_\_\_\_ No X \_\_\_\_\_; If yes, mo/day/yr sample was submitted  
 Water Well Disinfected? Yes X No

5 TYPE OF BLANK CASING USED: 1 Steel 3 RMP (SR) 5 Wrought iron 8 Concrete tile CASING JOINTS: Glued X Clamped \_\_\_\_\_  
 PVC 4 ABS 6 Asbestos-Cement 9 Other (specify below) Welded \_\_\_\_\_  
 7 Fiberglass Threaded \_\_\_\_\_

Blank casing diameter 5 in. to 14 ft., Dia \_\_\_\_\_ in. to \_\_\_\_\_ ft., Dia \_\_\_\_\_ in. to \_\_\_\_\_ ft.  
 Casing height above land surface 3.0" in., weight 2.87 lbs./ft. Wall thickness or gauge No. 0.0265

TYPE OF SCREEN OR PERFORATION MATERIAL:  PVC 10 Asbestos-cement  
 1 Steel 3 Stainless steel 5 Fiberglass 8 RMP (SR) 11 Other (specify) \_\_\_\_\_  
 2 Brass 4 Galvanized steel 6 Concrete tile 9 ABS 12 None used (open hole)

SCREEN OR PERFORATION OPENINGS ARE: 5 Gauzed wrapped  Saw cut 11 None (open hole)  
 1 Continuous slot 3 Mill slot 6 Wire wrapped 9 Drilled holes  
 2 Louvered shutter 4 Key punched 7 Torch cut 10 Other (specify) \_\_\_\_\_

SCREEN-PERFORATED INTERVALS: From 14' ft. to 20 ft., From \_\_\_\_\_ ft. to \_\_\_\_\_ ft.  
 From \_\_\_\_\_ ft. to \_\_\_\_\_ ft., From \_\_\_\_\_ ft. to \_\_\_\_\_ ft.  
 GRAVEL PACK INTERVALS: From 1.3' ft. to 2.0 ft., From \_\_\_\_\_ ft. to \_\_\_\_\_ ft.  
 From \_\_\_\_\_ ft. to \_\_\_\_\_ ft., From \_\_\_\_\_ ft. to \_\_\_\_\_ ft.

6 GROUT MATERIAL:  Neat cement 2 Cement grout 3 Bentonite 4 Other \_\_\_\_\_  
 Grout Intervals: From 1.2 ft. to 0 ft., From \_\_\_\_\_ ft. to \_\_\_\_\_ ft., From \_\_\_\_\_ ft. to \_\_\_\_\_ ft.

What is the nearest source of possible contamination:  Livestock pens 14 Abandoned water well  
 1 Septic tank 4 Lateral lines 7 Pit privy 11 Fuel storage 15 Oil well/Gas well  
 2 Sewer lines 5 Cess pool 8 Sewage lagoon 12 Fertilizer storage 16 Other (specify below)  
 3 Watertight sewer lines 6 Seepage pit  Feedyard 13 Insecticide storage \_\_\_\_\_

Direction from well? How many feet? 200' South

FROM	TO	LITHOLOGIC LOG	FROM	TO	LITHOLOGIC LOG
0	5'	Topsoil	42.0	49.5	Shale med gray
5	6	clay Br.	49.5	51.4	LS Br.
6	7	clay gray	51.4	60.3	Shale greenish gray
7	12	SS gray	60.3	62	LS gray
12	13	shale dk gray			
13	14	shale med gray			
14	18.3	LS gray			
18.3	18.8	shale dk gray			
18.8	19.5	LS gray			
19.5	30.5	shale gray			
30.5	31.5	LS gray			
31.5	32	shale gray			
32	41.5	LS gray			
41.5	46.6	LS Br.			
46.6	47.0	shale dk gray			

7 CONTRACTOR'S OR LANDOWNER'S CERTIFICATION: This water well was  constructed, (2) reconstructed, or (3) plugged under my jurisdiction and was completed on (mo/day/year) 4-19-83 and this record is true to the best of my knowledge and belief. Kansas Water Well Contractor's License No. 308 This Water Well Record was completed on (mo/day/yr) 5-14-83 under the business name of Bieschick Drilling Co by (signature) Ray Bieschick

INSTRUCTIONS: Use typewriter or ball point pen, PLEASE PRESS FIRMLY and PRINT clearly. Please fill in blanks, underline or circle the correct answers. Send top three copies to Kansas Department of Health and Environment, Division of Environment, Environmental Geology Section, Topeka, KS 66620. Send one to WATER WELL OWNER and retain one for your records.