

**WATER WELL RECORD Form WWC-5**

Original Record  Correction  Change in Well Use

Division of Water Resources App. No.

Well ID

<b>1 LOCATION OF WATER WELL:</b> County: <u>WASHINGTON</u>	Fraction <u>1/4 SW 1/4 NW 1/4 SW 1/4</u>	Section Number <u>3</u>	Township Number <u>T 1 S</u>	Range Number <u>R 2 E</u> <input type="checkbox"/> W
---	---	----------------------------	---------------------------------	---

<b>2 WELL OWNER:</b> Last Name: <u>LET LAKE VIEW LLC</u> Business: <u>LET LAKE VIEW LLC</u> Address: <u>500 4TH STREET</u> City: <u>FAIRBURY</u> State: <u>NE</u> ZIP: <u>68352</u>	Street or Rural Address where well is located (if unknown, distance and direction from nearest town or intersection): If at owner's address, check here: <input type="checkbox"/> <u>8 EAST AND 1/4 NORTH OF MAHASKA KS</u>
--	--

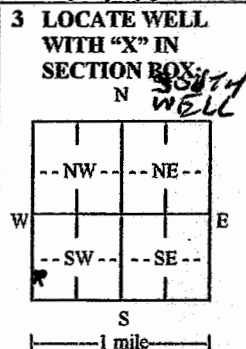

**4 DEPTH OF COMPLETED WELL:** 325 ft.

Depth(s) Groundwater Encountered: 1) ..... ft.  
2) ..... ft. 3) ..... ft., or 4)  Dry Well

WELL'S STATIC WATER LEVEL: ..... ft.  
 below land surface, measured on (mo-day-yr) 3/14/2017  
 above land surface, measured on (mo-day-yr) .....

Pump test data: Well water was ..... ft.  
after ..... hours pumping ..... gpm  
Well water was ..... ft.  
after ..... hours pumping ..... gpm

Estimated Yield: 30 gpm  
Bore Hole Diameter: 18 in. to 325 ft. and  
..... in. to ..... ft.

**5 Latitude:** 39° 59.362 N (decimal degrees)  
**Longitude:** 97° 12.043 W (decimal degrees)  
Horizontal Datum:  WGS 84  NAD 83  NAD 27  
Source for Latitude/Longitude: MAGELLAN  
 GPS (unit make/model: EXPLORIST GC)  
(WAAS enabled?  Yes  No)  
 Land Survey  Topographic Map  
 Online Mapper: .....

**6 Elevation:** ..... ft.  Ground Level  TOC  
Source:  Land Survey  GPS  Topographic Map  
 Other .....

**7 WELL WATER TO BE USED AS:**

1. Domestic: <input type="checkbox"/> Household <input type="checkbox"/> Lawn & Garden <input checked="" type="checkbox"/> Livestock 2. <input type="checkbox"/> Irrigation 3. <input type="checkbox"/> Feedlot 4. <input type="checkbox"/> Industrial	5. <input type="checkbox"/> Public Water Supply: well ID .....	10. <input type="checkbox"/> Oil Field Water Supply: lease .....
6. <input type="checkbox"/> Dewatering: how many wells? .....	7. <input type="checkbox"/> Aquifer Recharge: well ID .....	11. Test Hole: well ID .....
8. <input type="checkbox"/> Monitoring: well ID .....	9. Environmental Remediation: well ID .....	12. Geothermal: how many bores? .....
<input type="checkbox"/> Air Sparge <input type="checkbox"/> Soil Vapor Extraction <input type="checkbox"/> Recovery <input type="checkbox"/> Injection	13. <input type="checkbox"/> Other (specify): .....	a) Closed Loop <input type="checkbox"/> Horizontal <input type="checkbox"/> Vertical b) Open Loop <input type="checkbox"/> Surface Discharge <input type="checkbox"/> Inj. of Water

Was a chemical/bacteriological sample submitted to KDHE?  Yes  No If yes, date sample was submitted: .....

Water well disinfected?  Yes  No

**8 TYPE OF CASING USED:**  Steel  PVC  Other ..... CASING JOINTS:  Glued  Clamped  Welded  Threaded

Casing diameter 5 in. to 30.5 ft., Diameter ..... in. to ..... ft., Diameter ..... in. to ..... ft.  
Casing height above land surface 18 in. Weight 2.8 lbs./ft. Wall thickness or gauge No. 265

**TYPE OF SCREEN OR PERFORATION MATERIAL:**  
 Steel  Stainless Steel  Fiberglass  PVC  Other (Specify) .....

Brass  Galvanized Steel  Concrete tile  None used (open hole)

**SCREEN OR PERFORATION OPENINGS ARE:**  
 Continuous Slot  Mill Slot  Gauze Wrapped  Torch Cut  Drilled Holes  Other (Specify) .....

Louvered Shutter  Key Punched  Wire Wrapped  Saw Cut  None (Open Hole)

**SCREEN-PERFORATED INTERVALS:** From 30.5 ft. to 32.5 ft., From ..... ft. to ..... ft., From ..... ft. to ..... ft.  
**GRAVEL PACK INTERVALS:** From 25 ft. to 325 ft., From ..... ft. to ..... ft., From ..... ft. to ..... ft.

**9 GROUT MATERIAL:**  Neat cement  Cement grout  Bentonite  Other .....

Grout Intervals: From 5 ft. to 25 ft., From ..... ft. to ..... ft., From ..... ft. to ..... ft.

**Nearest source of possible contamination:**

<input type="checkbox"/> Septic Tank	<input type="checkbox"/> Lateral Lines	<input type="checkbox"/> Pit Privy	<input type="checkbox"/> Livestock Pens	<input type="checkbox"/> Insecticide Storage
<input type="checkbox"/> Sewer Lines	<input type="checkbox"/> Cess Pool	<input type="checkbox"/> Sewage Lagoon	<input type="checkbox"/> Fuel Storage	<input type="checkbox"/> Abandoned Water Well
<input type="checkbox"/> Watertight Sewer Lines	<input type="checkbox"/> Seepage Pit	<input type="checkbox"/> Feedyard	<input type="checkbox"/> Fertilizer Storage	<input type="checkbox"/> Oil Well/Gas Well
<input type="checkbox"/> Other (Specify) <u>NONE PRESENT</u>				

Direction from well? NONE PRESENT Distance from well? ..... ft.

10 FROM	TO	LITHOLOGIC LOG	FROM	TO	LITHO. LOG (cont.) or PLUGGING INTERVALS
0	3	TOPSOIL			
3	11	BROWN CLAY			
11	32	LIMESTONE & YELLOW SHALE			
32	95	GRAY SHALE			
95	168	SANDSTONE			
168	225	RED & WHITE CLAY			
225	325	SANDSTONE			
325	340	GRAY SHALE			

Notes:

**11 CONTRACTOR'S OR LANDOWNER'S CERTIFICATION:** This water well was  constructed,  reconstructed, or  plugged under my jurisdiction and was completed on (mo-day-year) 3/14/2017 and this record is true to the best of my knowledge and belief. Kansas Water Well Contractor's License No. 518. This Water Well Record was completed on (mo-day-year) 3/17/2017 under the business name of BLUE VALLEY DRILLING INC. Signature [Signature]