

**WATER WELL RECORD**

**Form WWC-5**

Division of Water Resources App. No.  

<b>1 LOCATION OF WATER WELL:</b> County: Linn	Fraction SE ¼ SE ¼ SE ¼ ¼	Section Number 36	Township No. T 20 S	Range Number R 22 <input checked="" type="checkbox"/> E <input type="checkbox"/> W
Street/Rural Address of Well Location; if unknown, distance & direction from nearest town or intersection: If at owner's address, check here <input type="checkbox"/> Illif Road Parker Kansas		<b>Global Positioning System (GPS) information:</b> Latitude: <u>.38.258792</u> ..... (in decimal degrees) Longitude: <u>94.918847</u> ..... (in decimal degrees) Elevation: ..... Datum: <input type="checkbox"/> WGS 84, <input type="checkbox"/> NAD 83, <input checked="" type="checkbox"/> NAD 27 Collection Method: <input type="checkbox"/> GPS unit (Make/Model: .....) <input type="checkbox"/> Digital Map/Photo, <input type="checkbox"/> Topographic Map, <input checked="" type="checkbox"/> Land Survey Est. Accuracy: <input type="checkbox"/> <3 m, <input type="checkbox"/> 3-5 m, <input type="checkbox"/> 5-15 m, <input type="checkbox"/> >15 m		
<b>2 WATER WELL OWNER:</b> Greg Garrelts/Linda Wilkerson RR#, Street Address, Box #: 9605 W. 103rd St. City, State, ZIP Code : Overland Park, KS 66212-5446				

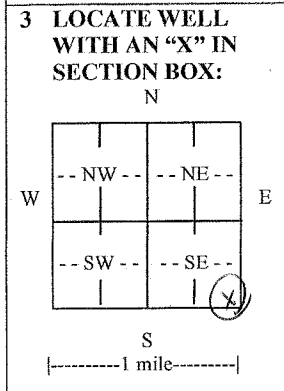

**4 DEPTH OF COMPLETED WELL** 210..... ft.  
Depth(s) Groundwater Encountered (1) 190..... ft. (2)..... ft. (3)..... ft.  
WELL'S STATIC WATER LEVEL 70.....ft. below land surface measured on mo/day/yr.....  
Pump test data: Well water was.....ft. after..... hours pumping..... gpm  
EST. YIELD. ±2 gpm. Well water was.....ft. after..... hours pumping..... gpm  
Bore Hole Diameter 10.....in. to 210.....ft., and .....in. to .....ft.  
WELL WATER TO BE USED AS:  Public water supply  Geothermal  Injection well  
 Domestic  Feedlot  Oil field water supply  Dewatering  Other (Specify below)  
 Irrigation  Industrial  Domestic-lawn & garden  Monitoring well .....  
Was a chemical/bacteriological sample submitted to Department?  Yes  No  
If yes, mo/day/yr sample was submitted.....  
Water well disinfected?  Yes  No

**5 TYPE OF CASING USED:**  Steel  PVC  Other .....  
CASING JOINTS:  Glued  Clamped  Welded  Threaded  
Casing diameter .658..... in. to 210..... ft., Diameter ..... in. to ..... ft., Diameter ..... in. to ..... ft.  
Casing height above land surface 18"..... in., Weight SCH 40.....lbs./ft., Wall thickness or gauge No. 220 PSI.....  
TYPE OF SCREEN OR PERFORATION MATERIAL:  
 Steel  Stainless Steel  PVC  Other (Specify) .....  
 Brass  Galvanized Steel  None used (open hole)  
SCREEN OR PERFORATION OPENINGS ARE:  
 Continuous slot  Mill slot  Gauze wrapped  Torch cut  Drilled holes  None (open hole)  
 Louvered shutter  Key punched  Wire wrapped  Saw cut  Other (specify) .....  
SCREEN-PERFORATED INTERVALS: From 160..... ft. to 200..... ft., From ..... ft. to ..... ft.  
From ..... ft. to ..... ft., From ..... ft. to ..... ft.  
GRAVEL PACK INTERVALS: From 25..... ft. to 210..... ft., From ..... ft. to ..... ft.  
From ..... ft. to ..... ft., From ..... ft. to ..... ft.

**6 GROUT MATERIAL:**  Neat cement  Cement grout  Bentonite  Other .....  
Grout Intervals: From 0..... ft. to 25..... ft., From ..... ft. to ..... ft., From ..... ft. to ..... ft.  
What is the nearest source of possible contamination:  
 Septic tank  Lateral lines  Pit privy  Livestock pens  Insecticide storage  Other (specify below)  
 Sewer lines  Cesspool  Sewage lagoon  Fuel storage  Abandoned water well  
 Watertight sewer lines  Seepage pit  Feedyard  Fertilizer storage  Oil well/gas well .....  
Direction from well West..... Distance from well 150'.....

FROM	TO	LITHOLOGIC LOG	FROM	TO	LITHO. LOG (cont.) or PLUGGING INTERVALS
0	3	Clay			
3	55	Shale			
55	57	Slate			
57	117	Shale			
117	119	Sandy Shale			
119	131	Limestone			
131	180	Shale			
180	190	Sandy Shale			
190	210	Sandstone			

**7 CONTRACTOR'S OR LANDOWNER'S CERTIFICATION:** This water well was  constructed,  reconstructed, or  plugged under my jurisdiction and was completed on (mo/day/year) 5/9/10..... and this record is true to the best of my knowledge and belief.  
Kansas Water Well Contractor's License No. 595..... This Water Well Record was completed on (mo/day/year) 9/10/10.....  
under the business name of Jesse Yoakum Well Drilling..... by (signature) Jesse Yoakum.....

**INSTRUCTIONS:** Use typewriter or ball point pen. PLEASE PRESS FIRMLY and PRINT clearly. Please fill in blanks and check the correct answers. Send three copies (white, blue, pink) to Kansas Department of Health and Environment, Bureau of Water, Geology Section, 1600 SW Jackson St., Suite 420, Topeka, Kansas 66612-1367. Telephone 785-296-5522. Send one copy to WATER WELL OWNER and retain one for your records. Include fee of \$5.00 for each constructed well. Visit us at <http://www.kdheks.gov/waterwell/index.html>.