

WATER WELL RECORD

Form WWC-5

Division of Water Resources App. No.

1 LOCATION OF WATER WELL: County: CHASE	Fraction <i>SW 1/4 NW 1/4 NE 1/4</i>	Section Number <i>3</i>	Township No. T <i>20</i> S	Range Number R <i>7</i> <input checked="" type="checkbox"/> E <input type="checkbox"/> W
Street/Rural Address of Well Location; if unknown, distance & direction from nearest town or intersection: If at owner's address, check here <input checked="" type="checkbox"/> .		Global Positioning System (GPS) information: Latitude: <i>.38,347044</i> (in decimal degrees) Longitude: <i>-96.652321</i> (in decimal degrees) Elevation: _____ Datum: <input type="checkbox"/> WGS 84, <input type="checkbox"/> NAD 83, <input type="checkbox"/> NAD 27 Collection Method: <input type="checkbox"/> GPS unit (Make/Model: _____) <input checked="" type="checkbox"/> Digital Map/Photo, <input type="checkbox"/> Topographic Map, <input type="checkbox"/> Land Survey Est. Accuracy: <input type="checkbox"/> <3 m, <input type="checkbox"/> 3-5 m, <input type="checkbox"/> 5-15 m, <input type="checkbox"/> >15 m		

2 WATER WELL OWNER: CAMP WOOD YMCA RR#, Street Address, Box #: 1101 CAMP WOOD RD City, State, ZIP Code : ELMDALE, KS 66850	
--	--

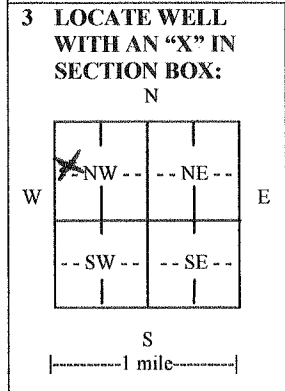

4 DEPTH OF COMPLETED WELL *Plugged* *3-200' Bores* ft.

Depth(s) Groundwater Encountered (1) *NONE* ft. (2) ft. (3) ft.

WELL'S STATIC WATER LEVEL ft. below land surface measured on mo/day/yr.

Pump test data: Well water was ft. after hours pumping gpm

EST. YIELD *0* gpm. Well water was ft. after hours pumping gpm

Bore Hole Diameter *5.5/8* in. to *200* ft., and in. to ft.

WELL WATER TO BE USED AS: Public water supply Geothermal Injection well
 Domestic Feedlot Oil field water supply Dewatering Other (Specify below)
 Irrigation Industrial Domestic-lawn & garden Monitoring well **CLOSED LOOP**

Was a chemical/bacteriological sample submitted to Department? Yes No

If yes, mo/day/yr sample was submitted.

Water well disinfected? Yes No

5 TYPE OF CASING USED: Steel PVC Other *HD POLYETHYLENE*

CASING JOINTS: Glued Clamped Welded Threaded *Fusion*

Casing diameter *3/4* in. to *200* ft., Diameter in. to ft., Diameter in. to ft.

Casing height above land surface *36* in., Weight *SDR11* lbs./ft., Wall thickness or gauge No. *160 PSI*

TYPE OF SCREEN OR PERFORATION MATERIAL: *None*

Steel Stainless Steel PVC Other (Specify)

Brass Galvanized Steel None used (open hole)

SCREEN OR PERFORATION OPENINGS ARE: *None*

Continuous slot Mill slot Gauze wrapped Torch cut Drilled holes None (open hole)
 Louvered shutter Key punched Wire wrapped Saw cut Other (specify)

SCREEN-PERFORATED INTERVALS: From ft. to ft., From ft. to ft.
From ft. to ft., From ft. to ft.

GRAVEL PACK INTERVALS: From ft. to ft., From ft. to ft.
From ft. to ft., From ft. to ft.

6 GROUT MATERIAL: Neat cement Cement grout Bentonite Other

Grout Intervals: From *200* ft. to *3* ft., From ft. to ft., From ft. to ft.

What is the nearest source of possible contamination:

Septic tank Lateral lines Pit privy Livestock pens Insecticide storage Other (specify below)
 Sewer lines Cesspool Sewage lagoon Fuel storage Abandoned water well
 Watertight sewer lines Seepage pit Feedyard Fertilizer storage Oil well/gas well

Direction from well Distance from well

FROM	TO	LITHOLOGIC LOG	FROM	TO	LITHO. LOG (cont.) or PLUGGING INTERVALS
0	1	SOIL/CLAY			
		107-122 SANDSTONE			
1	7	LIME			
		122-137 SHALE			
7	14	CLAY			
		137-138 LIME			
14	18	SHALE			
		138-200 SHALE			
18	42	LIME	200	3	3-200' BORES PLUGGED WITH
					HIGH SOLID BENTONITE
42	68	SHALE			
68	76	SANDSTONE			
76	85	SHALE			
85	91	LIME			
91	107	SHALE			

7 CONTRACTOR'S OR LANDOWNER'S CERTIFICATION: This water well was constructed, reconstructed, or plugged under my jurisdiction and was completed on (mo/day/year) *12/09/2014* and this record is true to the best of my knowledge and belief. Kansas Water Well Contractor's License No. *561* This Water Well Record was completed on (mo/day/year) *12/10/2014* under the business name of *EVANS ENERGY DEVELOPMENT, INC.* by (signature) *[Signature]*

INSTRUCTIONS: Use typewriter or ball point pen. PLEASE PRESS FIRMLY and PRINT clearly. Please fill in blanks and check the correct answers. Send one copy to Kansas Department of Health and Environment, Bureau of Water, Geology Section, 1000 SW Jackson St., Suite 420, Topeka, Kansas 66612-1367. Telephone 785-296-5524. Send one copy to WATER WELL OWNER and retain one for your records. Include fee of \$5.00 for each constructed well. Visit us at <http://www.kdheks.gov/waterwell/index.html>