

~~ACE~~ - MARTY'S WELL

1	LOCATION OF WATER WELL:	Fraction	Section Number	Township Number	Range Number
	County: LYON	NW 1/4 NW 1/4 SE 1/4	34	21	12E

Distance and direction from nearest town or city street address of well if located within city?
 S of HARTFORD

2 WATER WELL OWNER: DEAN WILSON
 RR#, St. Address, Box #: 190 16TH 56 NW
 City, State, ZIP Code: HARTFORD KS 66850
 Board of Agriculture, Division of Water Resources
 Application Number:

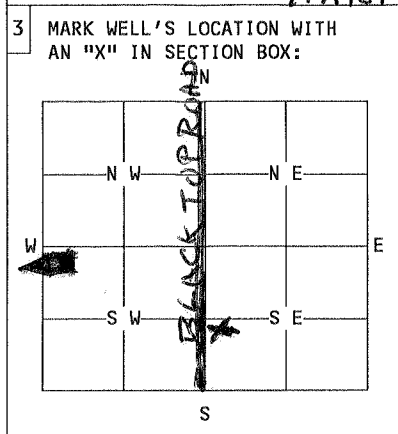

4 DEPTH OF WELL..... 27.....ft.
 WELL'S STATIC WATER LEVEL.... 8.5.....ft.
 WELL WAS USED AS: TO BE USED FOR

<u>1</u> Domestic	5 Public Water Supply	9 Dewatering
2 Irrigation	6 Oil Field Water Supply	10 Monitoring Well
3 Feedlot	7 Lawn and Garden Only	11 Injection Well
4 Industrial	8 Air Conditioning	12 Other.....

Was a chemical/bacteriological sample submitted to Department? Yes....No
 If yes, mo/day/yr sample was submitted.....
 Water Well Disinfected: Yes No.....

5 TYPE OF BLANK CASING USED:

1 Steel	3 RMP (SR)	5 Wrought	7 Fiberglass	9 Other (specify below)
<u>2</u> PVC	4 ABS	6 Asbestos-Cement	8 Concrete Tile

Blank casing diameter... 4.5...in. Was casing pulled? Yes..... No . If yes, how much.....
 Casing height above or below land surface..... 38.....in.

6 GROUT PLUG MATERIAL: 1 Neat cement 2 Cement grout 3 Bentonite 4 Other.....
 Grout Plug Intervals: From 3..ft. to 9..ft., From.....ft. toft., From..... to.....ft.
 What is the nearest source of possible contamination:

1 Septic tank	6 Seepage pit	11 Fuel storage	16 Other (specify below)
2 Sewer lines	7 Pit privy	12 Fertilizer storage
3 Watertight sewer lines	8 Sewage lagoon	13 Insecticide storage
4 Lateral lines	9 Feedyard	14 Abandoned water well
5 Cess Pool	10 Livestock pens	15 Oil well/Gas well

Direction from well? How many feet?

FROM	TO	PLUGGING MATERIALS
3	9	BENTONITE
9	27	SAND + GRAVEL

SILT - 0 - 8
 CLAY - 8 - 14
 LIME - 14 - 17
 SHALE 17 - 27
 WATER - 12 - 13
 BAIL TEST 60 GPM

7 CONTRACTOR'S OR LANDOWNER'S CERTIFICATION: This water well was plugged under my jurisdiction and was completed on (mo/day/year)... 05-27-98... and this record is true to the best of my knowledge and belief. Kansas Water Well Contractor's License No. 477..... This Water Well Record was completed on (mo/day/year) 09-01-98..... under the business name of EBBERTS DRILLING
 by (signature) [Signature].....

INSTRUCTIONS: Use typewriter or ball point pen. Please press firmly and print clearly. Please fill in blanks, underline or circle the correct answers. Send top three copies to Kansas Department of Health and Environment, Bureau of Water, Topeka, Kansas 66620-0001. Telephone: 913/296-3565. Send one to Water Well Owner and retain one for your records.