

WATER WELL RECORD

Form WWC-5

Division of Water Resources App. No.

1 LOCATION OF WATER WELL: County: Marion Fraction Ne 1/4 Nw 1/4 Se 1/4 1/4 Section Number 19 Township No. T 21 S Range Number R 3 NE EW

Street/Rural Address of Well Location; if unknown, distance & direction from nearest town or intersection: If at owner's address, check here [] 3 N 1 1/2 W Peabody

2 WATER WELL OWNER: American Energies RR#, Street Address, Box #: 155 N. Market City, State, ZIP Code : Wichita, KS 67202-1821

Global Positioning System (GPS) information: Latitude: Longitude: Elevation: Datum: Collection Method: Est. Accuracy:

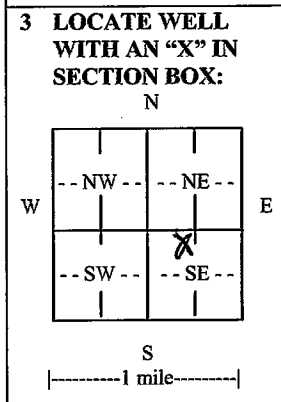

3 LOCATE WELL WITH AN 'X' IN SECTION BOX: 4 DEPTH OF COMPLETED WELL 90 ft. Depth(s) Groundwater Encountered (1) 42 ft. (2) WELL'S STATIC WATER LEVEL 12-29-10 Pump test data: EST. YIELD 30 gpm Bore Hole Diameter 9 in. to 2.8 ft. and 7.5 in. to 90 ft. WELL WATER TO BE USED AS: Oil field water supply

5 TYPE OF CASING USED: PVC CASING JOINTS: Glued Casing diameter 5 in. to 9.0 ft. Diameter 1.2 in. Weight SDR 26 lbs./ft. Wall thickness or gauge No. 2.14 TYPE OF SCREEN OR PERFORATION MATERIAL: PVC SCREEN OR PERFORATION OPENINGS ARE: Mill slot SCREEN-PERFORATED INTERVALS: From 20 ft. to 40 ft. GRAVEL PACK INTERVALS: From 20 ft. to 90 ft.

6 GROUT MATERIAL: Bentonite Grout Intervals: From 0 ft. to 20 ft. What is the nearest source of possible contamination: Direction from well Distance from well None within 1/4 mile

Table with 6 columns: FROM, TO, LITHOLOGIC LOG, FROM, TO, LITHO. LOG (cont.) or PLUGGING INTERVALS. Rows include: 0-20 Clay, 20-40 Blue Shale, 40-42 Crumbled Shale + Water, 42-90 Blue + Gray Shale.

7 CONTRACTOR'S OR LANDOWNER'S CERTIFICATION: This water well was constructed, reconstructed, or plugged under my jurisdiction and was completed on (mo/day/year) 12-29-10 and this record is true to the best of my knowledge and belief. Kansas Water Well Contractor's License No. 188 This Water Well Record was completed on (mo/day/year) 1-4-11 under the business name of Backhaus Drilling by (signature) Paul H. Backhaus

INSTRUCTIONS: Use typewriter or ball point pen. PLEASE PRESS FIRMLY and PRINT clearly. Please fill in blanks and check the correct answers. Send three copies (white, blue, pink) to Kansas Department of Health and Environment, Bureau of Water, Geology Section, 1000 SW Jackson St., Suite 420, Topeka, Kansas 66612-1367. Telephone 785-296-5522. Send one copy to WATER WELL OWNER and retain one for your records. Include fee of \$5.00 for each constructed well. Visit us at http://www.kdheks.gov/waterwell/index.html.