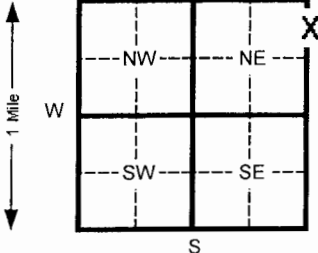

1 LOCATION OF WATER WELL: Fraction **NE 1/4 NE 1/4 NE 1/4** Section Number **20** Township Number **T 23 S** Range Number **R 1 E/W**
 County: **Harvey**
 Distance and direction from nearest town or city street address of well if located within city? **MW-10R**
Approximately 175 feet south and 20 feet west of the center of the intersection of E. 1st Ave. and Kansas Ave., Newton, KS
Longitude: W 97° 20.201', Longitude: W 97° 20.201'

2 WATER WELL OWNER: **ATOFINA Petrochemicals, Inc.**
 RR#, St. Address, Box # : **P.O. Box 674411** Board of Agriculture, Division of Water Resources
 City, State, ZIP Code : **Houston, Texas 77267-4411** Application Number:

3 LOCATE WELL'S LOCATION WITH AN "X" IN SECTION BOX:

 4 DEPTH OF COMPLETED WELL **13.4** ft. ELEVATION: **Unknown**
 Depth(s) Groundwater Encountered 1 **Unknown** ft. 2 _____ ft. 3 _____ ft.
 WELL'S STATIC WATER LEVEL **Unknown** ft. below land surface measured on mo/day/yr
 Pump test data: Well water was _____ ft. after _____ hours pumping _____ gpm
 Est. Yield **< 50** gpm: Well water was _____ ft. after _____ hours pumping _____ gpm
 Bore Hole Diameter **8** in. to **13.4** ft. and _____ in. to _____ ft.
 WELL WATER TO BE USED AS: 5 Public water supply 8 Air conditioning 11 Injection well
 1 Domestic 3 Feed lot 6 Oil field water supply 9 Dewatering 12 Other (Specify below)
 2 Irrigation 4 Industrial 7 Lawn and garden (domestic) 10 **Monitoring well**
 Was a chemical/bacteriological sample submitted to Department? Yes _____ No **X** If yes, mo/day/yr sample was submitted _____
 Water Well Disinfected? Yes _____ No **X**

5 TYPE OF BLANK CASING USED: 5 Wrought Iron 8 Concrete tile CASING JOINTS: Glued _____ Clamped _____
 1 Steel 3 RMP (SR) 6 Asbestos-Cement 9 Other (specify below) Welded _____
 2 **PVC** 4 ABS 7 Fiberglass _____ Threaded **X**
 Blank casing diameter _____ in. to **3.4** ft. Dia _____ in. to _____ ft. Dia _____ in. to _____ ft.
 Casing height above land surface **-6.0** in., weight **0.682** lbs./ft. Wall thickness or gauge No. **0.154 in.**
 TYPE OF SCREEN OR PERFORATION MATERIAL: 7 **PVC** 10 Asbestos-cement
 1 Steel 3 Stainless steel 5 Fiberglass 8 RMP (SR) 11 Other (specify) _____
 2 Brass 4 Galvanized steel 6 Concrete tile 9 ABS 12 None used (open hole)
 SCREEN OR PERFORATION OPENINGS ARE: 5 Gauzed wrapped 8 Saw cut 11 None (open hole)
 1 Continuous slot 3 **Mill slot** 6 Wire wrapped 9 Drilled holes
 2 Louvered shutter 4 Key punched 7 Torch cut 10 Other (specify) _____
 SCREEN-PERFORATED INTERVALS: From **3.4** ft. to **13.4** ft. From _____ ft. to _____ ft.
 GRAVEL PACK INTERVALS: From **2** ft. to **13.4** ft. From _____ ft. to _____ ft.

6 GROUT MATERIAL: 1 Neat cement 2 Cement grout **3 Bentonite** 4 Other _____
 Grout Intervals From **1** ft. to **2** ft. From _____ ft. to _____ ft. From _____ ft. to _____ ft.
 What is the nearest source of possible contamination:
 1 Septic tank 4 Lateral lines 7 Pit privy 10 Livestock pens 14 Abandoned water well
 2 Sewer lines 5 Cess pool 8 Sewage lagoon 11 **Fuel storage** 15 Oil well/ Gas well
 3 Watertight sewer lines 6 Seepage pit 9 Feedyard 12 Fertilizer storage 16 Other (specify below)
 13 Insecticide storage
 Direction from well? **Northwest** How many feet? **Approximately 75 feet**

FROM	TO	CODE	LITHOLOGIC LOG	FROM	TO	PLUGGING INTERVALS
0	4	03	Brown, silty, lean clay w/ some sand			
4	5	03	Gray to green, silty fat clay w/ sand and gravel fragments			
5	12	19	Green to gray shale, friable, rust colored mottling, interbedded with quartz sand and gravel lenses			
12	13.4	19	Dark gray shale, friable with secondary crystallization of quartz and calcite			

7 CONTRACTOR'S OR LANDOWNER'S CERTIFICATION: This water well was (1) **constructed**, (2) reconstructed, or (3) plugged under my jurisdiction and was completed on (mo/day/yr) **6/29/04** and this record is true to the best of my knowledge and belief. Kansas Water Well Contractor's License No. **616** This Water Well Record was completed on (mo/day/yr) **7/13/04** under the business name of **Thiele Geotech, Inc.** by (signature) *D. J. [Signature]*

INSTRUCTIONS: Please fill in blanks and circle the correct answers. Send three copies to Kansas Department of Health and Environment, Bureau of Water, Topeka, Kansas 66620-0001. Telephone: 913-296-5545. Send one to WATER WELL OWNER and retain one for your records.

OFFICE USE ONLY

T

R

SEC

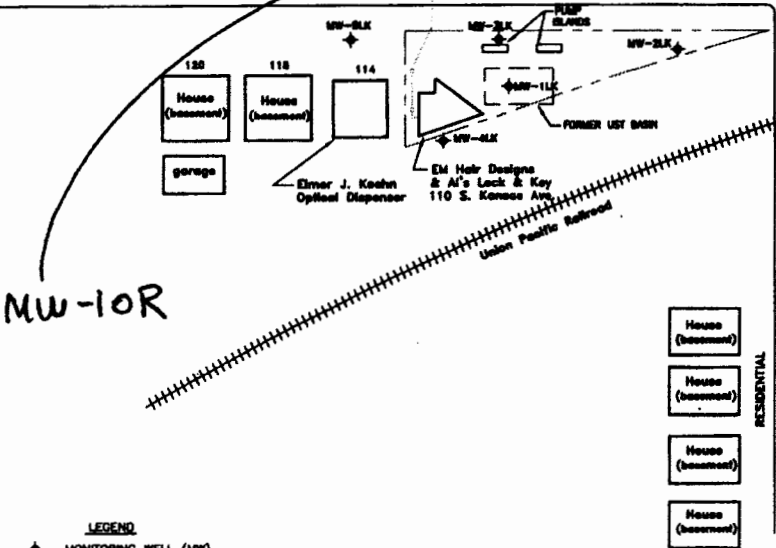
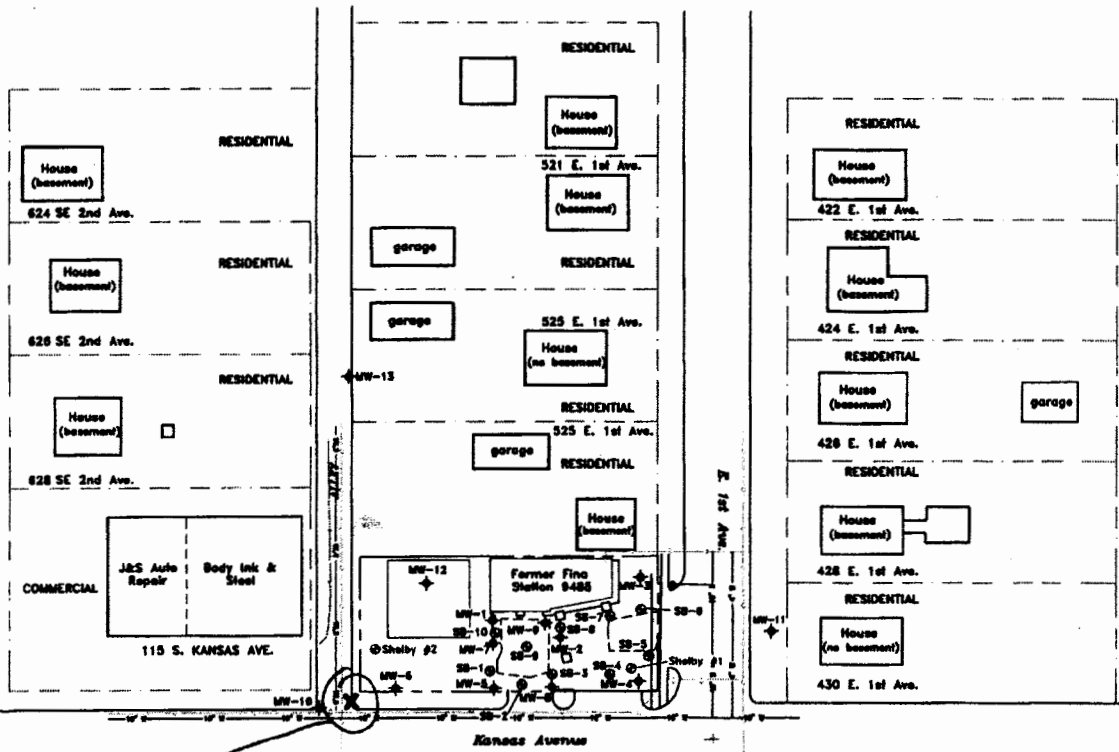

MW-10R

- LEGEND**
- ◆ MONITORING WELL (MW)
 - ◆ LOWELL KEMP PROPERTY MONITORING WELL (LK)
 - FORMER UNDERGROUND STORAGE TANK LOCATION
 - GEOPROBE LOCATION
 - Soil Boring (for unsaturated zone testing)
 - APPROXIMATE LOCATION OF BURIED TELEPHONE LINE
 - SS- APPROXIMATE LOCATION OF MAIN SEWER LINE (4-6 FT BGS)
 - ... APPROXIMATE LOCATION OF WATER LINE (2-3 FT BGS)

NOTE: Drawing based on base map provided by the IT Group and aerial photographs

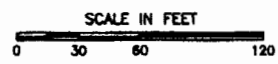

RECEIVED
JUL 16 2004
BUREAU OF WATER

CHECK BY	DSS
DRAWN BY	KEB
DATE	10/18/02
SCALE	AS SHOWN
CAD NO.	---
PRJ NO.	90-01044.01

Site Map
KRBCA Report
Former Fina Facility #9485
535 East 1st Street
Newton, Kansas

Clayton
GROUP SERVICES
185 S. Union Blvd, Suite 310, Lakewood, CO 80228
FIGURE 2-1