

WATER WELL PLUGGING RECORD

Form WWC-5P

KSA 82a-1212

ID NO.

MW6

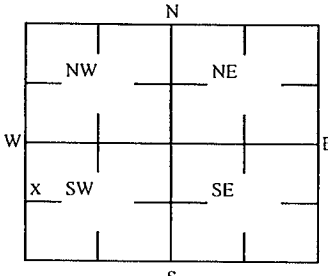
1 LOCATION OF WATER WELL: County: Harvey		Fraction SE ¼ SW ¼ NW ¼ SW ¼		Section Number 18		Township Number T 23 S		Range Number 1 <input checked="" type="checkbox"/> E <input type="checkbox"/> W																																																							
Street/Rural Address of Well Location; if unknown, distance & direction from nearest town or intersection: If at owner's address, check here <input type="checkbox"/> 1800 W 4th St, Newton, KS 67114				Global Positioning Systems (GPS) information: Latitude: NA (in decimal degrees) Longitude: NA (in decimal degrees) Elevation: NA Horizontal Datum <input type="checkbox"/> WGS84, <input type="checkbox"/> NAD83, <input type="checkbox"/> NAD27 Collection Method: <input type="checkbox"/> GPS unit (Make/model: _____) <input type="checkbox"/> Digital Map/Photo, <input type="checkbox"/> Topographic Map <input type="checkbox"/> Land Survey Est. Accuracy: <input type="checkbox"/> <3 m, <input type="checkbox"/> 3-5 m, <input type="checkbox"/> 5-15 m, <input type="checkbox"/> >15 m																																																											
2 WATER WELL OWNER: RR#, St. Address, Box #: PO Box 9000 City, State ZIP Code: Amarillo, TX 79105																																																															
3 MARK WELL'S LOCATION WITH AN "X" IN SECTION BOX: 				4 DEPTH OF WELL 24.8 ft. WELL'S STATIC WATER LEVEL NA ft. WELL WAS USED AS: <input type="checkbox"/> Domestic <input type="checkbox"/> Public Water Supply <input type="checkbox"/> Dewatering <input type="checkbox"/> Irrigation <input type="checkbox"/> Oil Field Water Supply <input checked="" type="checkbox"/> Monitoring <input type="checkbox"/> Feedlot <input type="checkbox"/> Domestic (Lawn & Garden) <input type="checkbox"/> Injection Well <input type="checkbox"/> Industrial <input type="checkbox"/> Air Conditioning <input type="checkbox"/> Other _____ Was a chemical/bacteriological sample submitted to Department? Yes <input type="checkbox"/> No <input checked="" type="checkbox"/>																																																											
5 TYPE OF BLANK CASING USED: <input type="checkbox"/> Steel <input type="checkbox"/> RMP (SR) <input type="checkbox"/> Wrought <input type="checkbox"/> Fiberglass <input type="checkbox"/> Other (Specific below) <input checked="" type="checkbox"/> PVC <input type="checkbox"/> ABS <input type="checkbox"/> Asbestos-Cement <input type="checkbox"/> Concrete Tile Blank casing diameter 2 in. Was casing pulled? Yes <input checked="" type="checkbox"/> No <input type="checkbox"/> If yes, how much 3' Casing height above or below land surface NA in.																																																															
6 GROUT PLUG MATERIAL: <input type="checkbox"/> Neat cement <input type="checkbox"/> Cement grout <input checked="" type="checkbox"/> Bentonite <input checked="" type="checkbox"/> Other Concrete: 0-0.7'; Soil: 0.7-3' Grout Plug Intervals: From 3 ft to 24.8 ft, From _____ ft to _____ ft, From _____ ft to _____ ft. What is the nearest source of possible contamination: <input type="checkbox"/> Septic tank <input type="checkbox"/> Seepage pit <input type="checkbox"/> Fuel storage <input type="checkbox"/> Other (specify below) _____ <input type="checkbox"/> Sewer lines <input type="checkbox"/> Pit privy <input type="checkbox"/> Fertilizer storage _____ <input type="checkbox"/> Watertight sewer lines <input type="checkbox"/> Sewage lagoon <input type="checkbox"/> Insecticide storage _____ <input type="checkbox"/> Lateral lines <input type="checkbox"/> Feed yard <input type="checkbox"/> Abandoned water well _____ <input type="checkbox"/> Cess pool <input type="checkbox"/> Livestock pens <input type="checkbox"/> Oil well/Gas well _____ Direction from well? _____ How many feet? _____																																																															
<table border="1" style="width:100%; border-collapse: collapse;"> <thead> <tr> <th>FROM</th> <th>TO</th> <th>PLUGGING MATERIALS</th> <th>FROM</th> <th>TO</th> <th>PLUGGING MATERIALS</th> </tr> </thead> <tbody> <tr> <td>0</td> <td>0.7</td> <td>Concrete</td> <td></td> <td></td> <td></td> </tr> <tr> <td>0.7</td> <td>3</td> <td>Soil</td> <td></td> <td></td> <td></td> </tr> <tr> <td>3</td> <td>24.8</td> <td>Bentonite</td> <td></td> <td></td> <td></td> </tr> <tr> <td></td> <td></td> <td></td> <td></td> <td></td> <td></td> </tr> <tr> <td></td> <td></td> <td></td> <td></td> <td></td> <td></td> </tr> <tr> <td></td> <td></td> <td></td> <td></td> <td></td> <td></td> </tr> <tr> <td></td> <td></td> <td></td> <td></td> <td></td> <td></td> </tr> <tr> <td></td> <td></td> <td></td> <td></td> <td></td> <td></td> </tr> </tbody> </table>										FROM	TO	PLUGGING MATERIALS	FROM	TO	PLUGGING MATERIALS	0	0.7	Concrete				0.7	3	Soil				3	24.8	Bentonite																																	
FROM	TO	PLUGGING MATERIALS	FROM	TO	PLUGGING MATERIALS																																																										
0	0.7	Concrete																																																													
0.7	3	Soil																																																													
3	24.8	Bentonite																																																													
7 CONTRACTOR'S OR LANDOWNER'S CERTIFICATION: This water well was plugged under my jurisdiction and was completed on (mo/day/year) 2/26/2020 and this record is true to the best of my knowledge and belief. Kansas Water Contractor's License No. 757. This Water Well Record was completed on (mo/day/year) 3/2/2020 under the business name of Larsen & Associates, Inc. By (signature) _____																																																															
Send one white copy to Kansas Department of Health & Environment, Geology Section, 1800 SW Jackson Street, Ste. 420, Topeka, KS 66612-1367. Send one copy to WATER WELL OWNER and retain one for your records Visit us at http://www.kdheks.gov/waterwell/index.html Telephone 785-296-5524.																																																															

KSA82a-1212

Revised 1/20/2015

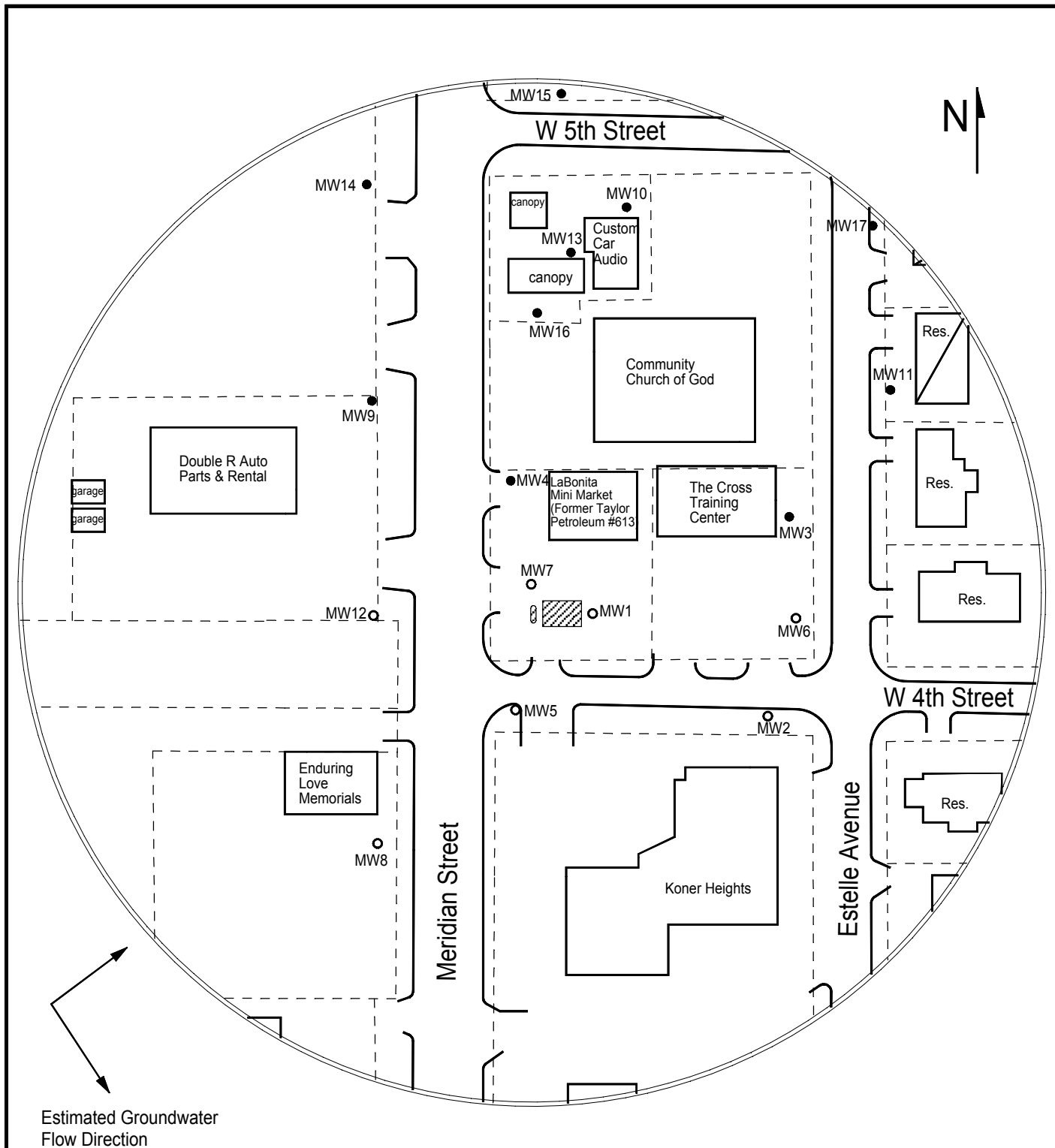

FIGURE 1 - SITE BASE MAP



PROJECT:

Taylor Petroleum #613
1804 W. 4th
Newton, KS
KDHE ID: U2-040-13913
Date: 2/26/20

1311 E 25th St. Suite B
Lawrence, KS 66046

785-841-8707 office
785-865-4282 fax

0 100 ft

LEGEND:

- Approximate Location of Former UST Basin & Pump Island
- Approximate Location of Property Line
- Building with Basement
- Existing Monitoring Well
- Plugged Monitoring Well

NOTE: Approximate location of product lines is unknown.