

## WATER WELL PLUGGING RECORD

Form WWC-5P

KSA 82a-1212

ID NO.

MW8

## 1 LOCATION OF WATER WELL:

County: Harvey

Fraction

NE ¼ NE ¼ SE ¼ SE ¼

Section Number

13

Township Number

T 23 S

Range Number

1 ☒ E ☐ W

Street/Rural Address of Well Location; if unknown, distance & direction from nearest town or intersection: If at owner's address, check here ☐

325 N Meridian Rd, Newton, KS 67114

## Global Positioning Systems (GPS) information:

Latitude: 38.04632 (in decimal degrees)

Longitude: 97.37212 (in decimal degrees)

Elevation: NA

Horizontal Datum ☒ WGS84, ☐ NAD83, ☐ NAD27

Collection Method:

☐ GPS unit (Make/model: \_\_\_\_\_)☐ Digital Map/Photo, ☐ Topographic Map ☐ Land SurveyEst. Accuracy: ☐ <3 m, ☐ 3-5 m, ☐ 5-15 m, ☐ >15 m

## 2 WATER WELL OWNER:

KDHE

RR#, St. Address, Box #:

1000 SW Jackson

City, State ZIP Code:

Topeka KS 66612

## 3 MARK WELL'S LOCATION WITH AN "X" IN SECTION BOX:

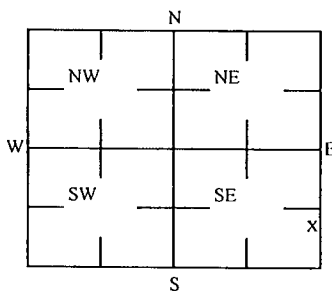

## 4 DEPTH OF WELL 20 ft.

WELL'S STATIC WATER LEVEL NA ft

WELL WAS USED AS:

☐ Domestic  
☐ Irrigation  
☐ Feedlot  
☐ Industrial

☐ Public Water Supply  
☐ Oil Field Water Supply  
☐ Domestic (Lawn & Garden)  
☐ Air Conditioning

☐ Dewatering  
☒ Monitoring  
☐ Injection Well  
☐ Other \_\_\_\_\_

Was a chemical/bacteriological sample submitted to Department?

Yes ☐ No ☒

## 5 TYPE OF BLANK CASING USED:

☐ Steel  
☒ PVC

☐ RMP (SR)  
☐ ABS

☐ Wrought  
☐ Asbestos-Cement

☐ Fiberglass  
☐ Concrete Tile
☐ Other (Specific below) \_\_\_\_\_

Blank casing diameter 2 in.

Was casing pulled? Yes ☒ No ☐

If yes, how much 3'

Casing height above or below land surface NA in.

## 6 GROUT PLUG MATERIAL:

☐ Neat cement☐ Cement grout☒ Bentonite☒ Other Soil: 0-3'

Grout Plug Intervals: From 3 ft to 20 ft, From \_\_\_\_\_ ft to \_\_\_\_\_ ft, From \_\_\_\_\_ ft to \_\_\_\_\_ ft,

What is the nearest source of possible contamination:

☐ Septic tank  
☐ Sewer lines  
☐ Watertight sewer lines  
☐ Lateral lines  
☐ Cess pool

☐ Seepage pit  
☐ Pit privy  
☐ Sewage lagoon  
☐ Feed yard  
☐ Livestock pens

☐ Fuel storage  
☐ Fertilizer storage  
☐ Insecticide storage  
☐ Abandoned water well  
☐ Oil well/Gas well
☐ Other (specify below) \_\_\_\_\_

Direction from well? \_\_\_\_\_

How many feet? \_\_\_\_\_

FROM	TO	PLUGGING MATERIALS	FROM	TO	PLUGGING MATERIALS
0	3	Soil			
3	20	Bentonite			

KDHE ID: Taylor Petroleum #613; U2-040-13913

## 7 CONTRACTOR'S OR LANDOWNER'S CERTIFICATION:

This water well was plugged under my jurisdiction and was completed on (mo/day/year) 2/26/2020 and this record is true to the best of my knowledge and belief. Kansas Water

Contractor's License No. 757. This Water Well Record was completed on (mo/day/year) 2/26/2020 under the

business name of Larsen & Associates, Inc. By (signature) \_\_\_\_\_

Send one white copy to Kansas Department of Health & Environment, Geology Section, 1000 SW Jackson Street, Ste. 420, Topeka, KS 66612-1367. Send one copy to WATER WELL OWNER and retain one for your records

Visit us at <http://www.kdheks.gov/waterwell/index.html> Telephone 785-296-5524.

KSA82a-1212

Revised 1/20/2015

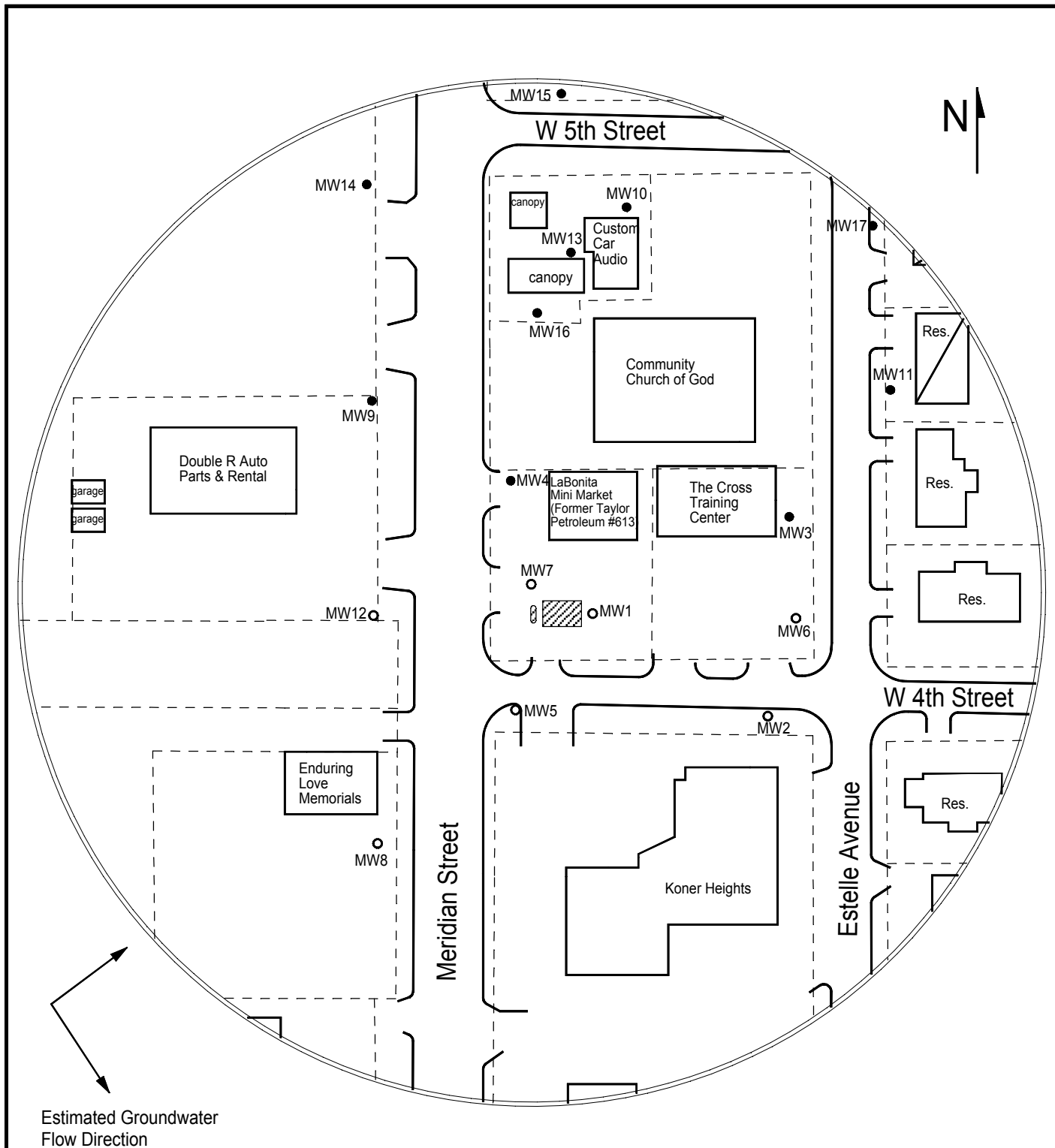

FIGURE 1 - SITE BASE MAP



**PROJECT:**

Taylor Petroleum #613  
1804 W. 4th  
Newton, KS  
KDHE ID: U2-040-13913  
Date: 2/26/20

1311 E 25th St. Suite B  
Lawrence, KS 66046

785-841-8707 office  
785-865-4282 fax

0 100 ft

**LEGEND:**

- Approximate Location of Former UST Basin & Pump Island
- Approximate Location of Property Line
- Building with Basement
- Existing Monitoring Well
- Plugged Monitoring Well

NOTE: Approximate location of product lines is unknown.