

WATER WELL RECORD Form WWC-5

Original Record Correction Change in Well Use

Division of Water Resources App. No.

Well ID

MW2

1 LOCATION OF WATER WELL: County: HARVEY Fraction SE 1/4 SW 1/4 NW 1/4 SW 1/4 Section Number 18 Township Number T 23 S Range Number R 01 E W

2 WELL OWNER: Last Name: Business: SOUTHWEST WHEELS Address: 420 N. MERIDIAN City: NEWTON State: KS ZIP: 67114 Street or Rural Address where well is located

3 LOCATE WELL WITH 'X' IN SECTION BOX: N W E S 1 mile. 4 DEPTH OF COMPLETED WELL: 25 ft. 5 Latitude: 38.04756 Longitude: 97.37164

7 WELL WATER TO BE USED AS: 1. Domestic 2. Irrigation 3. Feedlot 4. Industrial 5. Public Water Supply 6. Dewatering 7. Aquifer Recharge 8. Monitoring 9. Environmental Remediation 10. Oil Field Water Supply 11. Test Hole 12. Geothermal 13. Other

Was a chemical/bacteriological sample submitted to KDHE? Water well disinfected?

8 TYPE OF CASING USED: Steel PVC Other CASING JOINTS: Glued Clamped Welded Threaded Casing diameter 2 in. to 25 ft. Diameter in. to ft. Casing height above land surface in. Weight lbs./ft. Wall thickness or gauge No. Sch. 40

9 GROUT MATERIAL: Neat cement Cement grout Bentonite Other Concrete Surface Completion 0 - 1 Grout Intervals: From 1 ft. to 13 ft.

Nearest source of possible contamination: Septic Tank Lateral Lines Pit Privy Livestock Pens Insecticide Storage Sewer Lines Cess Pool Sewage Lagoon Fuel Storage Abandoned Water Well Watertight Sewer Lines Seepage Pit Feedyard Fertilizer Storage Oil Well/Gas Well

Table with columns: FROM, TO, LITHOLOGIC LOG, FROM, TO, LITHO. LOG (cont.) or PLUGGING INTERVALS. Rows: 0 to .5 CONCRETE, .5 to 22 Silty Clay (CL), 22 to 25 SANDY CLAY(SC). Notes: U2-040-15039

11 CONTRACTOR'S OR LANDOWNER'S CERTIFICATION: This water well was constructed, reconstructed, or plugged under my jurisdiction and was completed on (mo-day-year) 3/29/21 and this record is true to the best of my knowledge and belief.



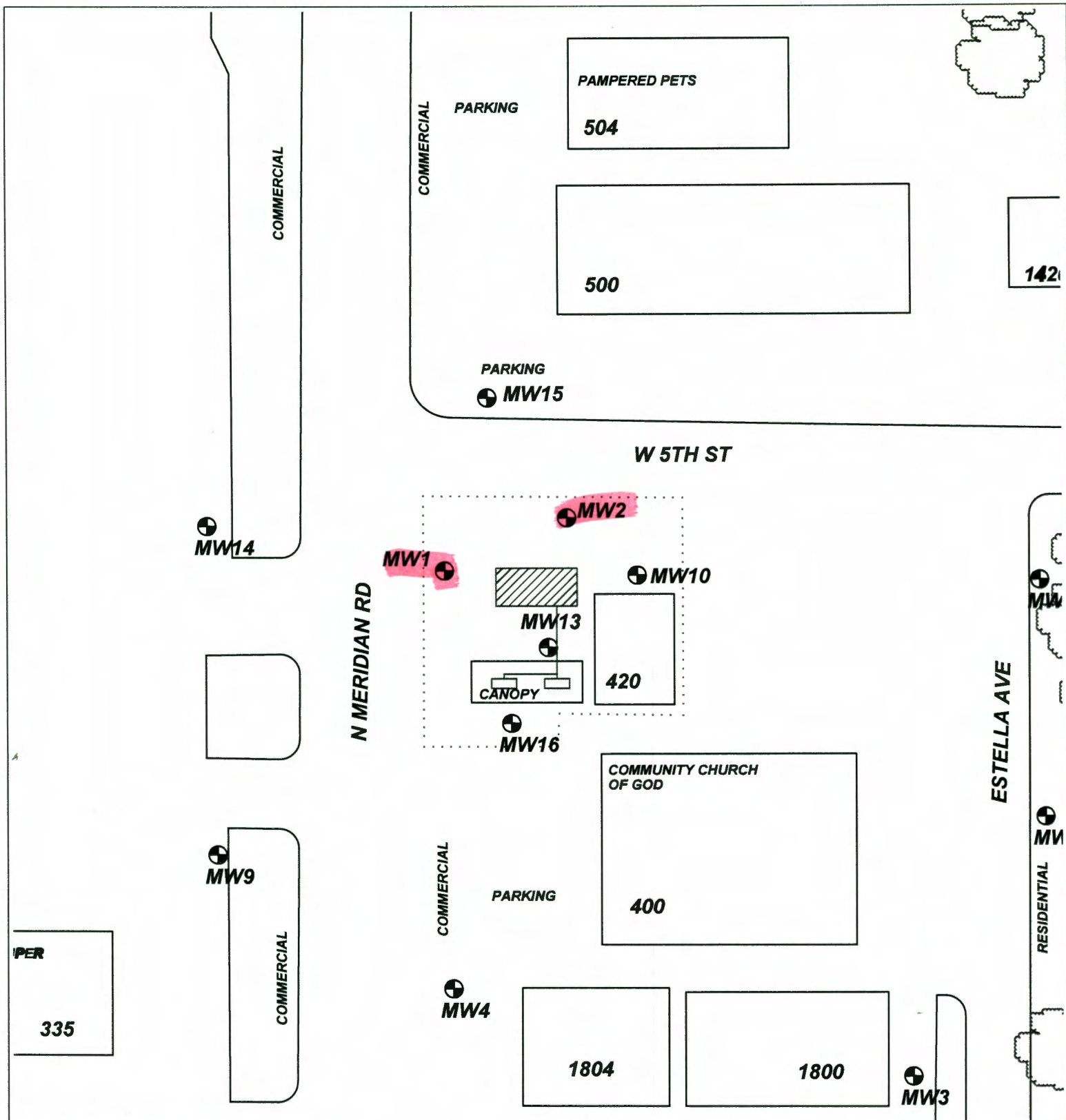

<b>PROJECT:</b> <b>SOUTHWEST WHEELS</b>		<b>TITLE:</b>	<b>LEGEND:</b> = FORMER UST BASIN/EXCAVATION = PUMP ISLANDS = MONITORING WELL  ..... = SUBJECT PROPERTY
<b>ADDRESS:</b> <b>420 N. MERIDIAN</b>			
<b>LOCATION:</b> <b>NEWTON, KS</b>			
<b>DRAWN BY:</b> <b>B. STALNAKER</b>	<b>DATE:</b> <b>2/8/21</b>	<b>ASSOCIATED ENVIRONMENTAL INC.</b>	
<b>REVISED BY:</b> <b>B. STALNAKER</b>	<b>DATE:</b> <b>4/21/21</b>		
<b>AEI JOB #:</b> <b>TF532</b>	<b>KDHE JOB #:</b> <b>U2-040-15039</b>		
<b>SCALE:</b> 1" = 50'	<b>NOTES:</b>		