

WATER WELL RECORD Form WWC-5

Original Record Correction Change in Well Use

Division of Water Resources App. No.

Well ID

1 LOCATION OF WATER WELL: Fraction 1/4 Sec 1/4 Ne 1/4 Section Number 16 Township Number T 23 S Range Number R 5 E

County: Butler

2 WELL OWNER: Last Name: League First: Evelyn Street or Rural Address where well is located (if unknown, distance and direction from nearest town or intersection): If at owner's address, check here:

Business Address: 1901 A.F. Old Hwy 40

Address: Salina State: KS ZIP: 67401 7 1/2 S Burns

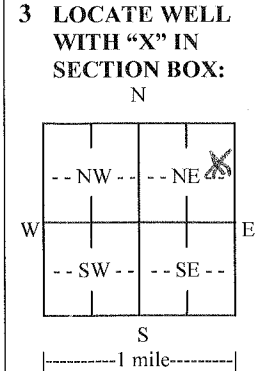

4 DEPTH OF COMPLETED WELL: 70 ft.

Depth(s) Groundwater Encountered: 1) 60 ft.

2) ft. 3) ft., or 4) Dry Well

WELL'S STATIC WATER LEVEL: 20 ft.

below land surface, measured on (mo-day-yr)

above land surface, measured on (mo-day-yr) 12-18-13

Pump test data: Well water was ft. after hours pumping gpm

Well water was ft. after hours pumping gpm

Estimated Yield: 3-5 gpm

Bore Hole Diameter: 5/8 in. to 70 ft. and in. to ft.

5 Latitude: (decimal degrees)

Longitude: (decimal degrees)

Datum: WGS 84 NAD 83 NAD 27

Source for Latitude/Longitude:

GPS (unit make/model:) (WAAS enabled? Yes No)

Land Survey Topographic Map

Online Mapper:

6 Elevation: ft. Ground Level TOC

Source: Land Survey GPS Topographic Map

Other

7 WELL WATER TO BE USED AS:

1. Domestic: Household Lawn & Garden Livestock

2. Irrigation

3. Feedlot

4. Industrial

5. Public Water Supply: well ID

6. Dewatering: how many wells?

7. Aquifer Recharge: well ID

8. Monitoring: well ID

9. Environmental Remediation: well ID

Air Sparge Soil Vapor Extraction

Recovery Injection

10. Oil Field Water Supply: lease

11. Test Hole: well ID

Cased Uncased Geotechnical

12. Geothermal: how many bores?

a) Closed Loop Horizontal Vertical

b) Open Loop Surface Discharge Inj. of Water

13. Other (specify):

Was a chemical/bacteriological sample submitted to KDHE? Yes No If yes, date sample was submitted:

Water well disinfected? Yes No

8 TYPE OF CASING USED: Steel PVC Other CASING JOINTS: Glued Clamped Welded Threaded

Casing diameter 5 in. to 18 ft., Diameter in. to ft., Diameter in. to ft.

Casing height above land surface 18 in. Weight SDR 26 lbs./ft. Wall thickness or gauge No. 1214

TYPE OF SCREEN OR PERFORATION MATERIAL:

Steel Stainless Steel Fiberglass PVC Other (Specify)

Brass Galvanized Steel Concrete tile None used (open hole)

SCREEN OR PERFORATION OPENINGS ARE:

Continuous Slot Mill Slot Gauze Wrapped Torch Cut Drilled Holes Other (Specify)

Louvered Shutter Key Punched Wire Wrapped Saw Cut None (Open Hole)

SCREEN-PERFORATED INTERVALS: From 35 ft. to 70 ft., From ft. to ft., From ft. to ft.

GRAVEL PACK INTERVALS: From 20 ft. to 70 ft., From ft. to ft., From ft. to ft.

9 GROUT MATERIAL: Neat cement Cement grout Bentonite Other

Grout Intervals: From 0 ft. to 20 ft., From ft. to ft., From ft. to ft.

Nearest source of possible contamination:

Septic Tank Lateral Lines Pit Privy Livestock Pens Insecticide Storage

Sewer Lines Cess Pool Sewage Lagoon Fuel Storage Abandoned Water Well

Watertight Sewer Lines Seepage Pit Feedyard Fertilizer Storage Oil Well/Gas Well

Other (Specify)

Direction from well? None within 1/2 mi Distance from well? ft.

10 FROM	TO	LITHOLOGIC LOG	FROM	TO	LITHO. LOG (cont.) or PLUGGING INTERVALS
0	15	Clay			
15	60	Rock Hard Lime			
60	61	Water			
61	70	Gray Hard Shale			
Notes:					

11 CONTRACTOR'S OR LANDOWNER'S CERTIFICATION: This water well was constructed, reconstructed, or plugged under my jurisdiction and was completed on (mo-day-year) 12-18-13 and this record is true to the best of my knowledge and belief. Kansas Water Well Contractor's License No. 180 This Water Well Record was completed on (mo-day-year) 12-20-13 under the business name of Back to Back Drilling