

USE TYPEWRITER OR BALL POINT PEN-PRESS FIRMLY, PRINT CLEARLY.

WATER WELL RECORD  
KSA 82a-1201-1215

Kansas Department of Health and Environment-Division of Environment  
(Water well Contractors)  
Topeka, Kansas 66620

1. Location of well: County **BUTLER** Fraction **SE NE 1/4 S 2 1/2 NE 1/4** Section number **10** Township number **T 24 S R 4** Range number **EW**

2. Distance and direction from nearest town or city: **3 MI 1/2 N on OIL VALLEY Rd - 3 MI EAST on BLACKTOP**  
3. Owner of well: **Mrs. T. E. Frenking**  
R.R. or street: **POTWIN, KANSAS**  
City, state, zip code: **POTWIN, KANSAS**

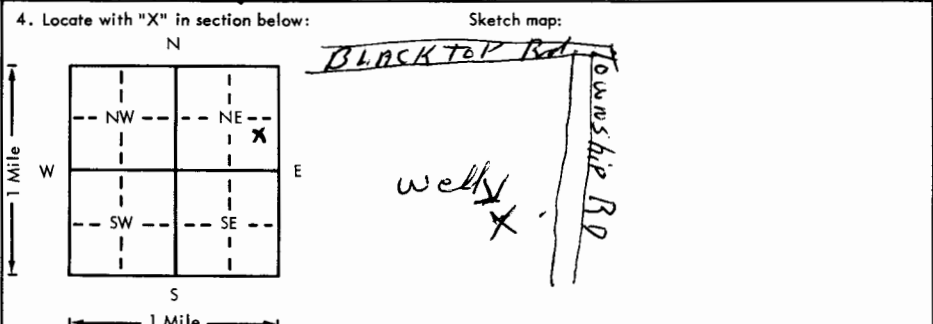

6. Bore hole dia. **10** in. Completion date **12-23-78**  
Well depth **98** ft.  
7.  Cable tool  Rotary  Driven  Dug  
 Hollow rod  Jetted  Bored  Reverse rotary  
8. Use:  Domestic  Public supply  Industry  
 Irrigation  Air conditioning  Stock  
 Lawn  Oil field water  Other  
9. Casing: Material \_\_\_\_\_ Height:  Above or below  
Threaded \_\_\_\_\_ Welded \_\_\_\_\_ Surface **24"** in.  
RMP \_\_\_\_\_ PVC  Weight \_\_\_\_\_ lbs./ft.  
Dia. **5** in. to **98** ft. depth! Wall Thickness: inches or  
Dia. **5** in. to **98** ft. depth! gage No. **258**

5. Type and color of material

	From	To
TOP SOIL	0	3
Red CLAY	3	12
yellow CLAY + GRAVEL	12	40
CLAY grayish	40	50
CLAY grayish	50	55
CLAY Reddish	55	80
SHALE - Gray	80	98

10. Screen: Manufacturer's name **HSTM**  
Type **Sec # 1** Dia. **5"**  
Slot/gauze **.025** Length **10'**  
Set between **98** ft. and **88** ft.  
Gravel pack?  Size range of material **8/30 #**  
11. Static water level: \_\_\_\_\_ mo./day/yr.  
**32** ft. below land surface Date **12-23-78**  
12. Pumping level below land surfaces:  
\_\_\_\_\_ ft. after \_\_\_\_\_ hrs. pumping \_\_\_\_\_ g.p.m.  
\_\_\_\_\_ ft. after **110** hrs. pumping \_\_\_\_\_ g.p.m.  
Estimated maximum yield \_\_\_\_\_ g.p.m.  
13. Water sample submitted: \_\_\_\_\_ mo./day/yr.  
Yes  No  Date \_\_\_\_\_  
14. Well head completion:  
 Pipe adapter **24"** inches above grade  
15. Well grouted?   
With:  Neat cement  Bentonite  Concrete  
Depth: From **0** ft. to **10** ft.  
16. Nearest source of possible contamination:  
ft. **None** Direction **North** Type **House**  
Well disinfected upon completion?  Yes  No  
17. Pump:  Not installed  
Manufacturer's name \_\_\_\_\_  
Model number \_\_\_\_\_ HP \_\_\_\_\_ Volts \_\_\_\_\_  
Length of drop pipe \_\_\_\_\_ ft. capacity \_\_\_\_\_ g.p.m.  
Type:  
 Submersible  Turbine  
 Jet  Reciprocating  
 Centrifugal  Other

18. Elevation: \_\_\_\_\_  
Topography: \_\_\_\_\_  
 Hill  
 Slope  
 Upland  
 Valley  
19. Remarks:  
**this well is for stock water but was finish so it could be used for domestic in the future**

20. Water well contractor's certification:  
This well was drilled under my jurisdiction and this report is true to the best of my knowledge and belief.  
**B+S Well Drilling 335**  
Business name \_\_\_\_\_ License No. \_\_\_\_\_  
Address **B#1 of Donado, Kansas**  
Signed **Burt Heblom** Date **1-10-79**  
Authorized representative

24 - 40 - 10  
 Sec  
 1/4  
 NE