

## WATER WELL PLUGGING RECORD

Form WWC-5P

KSA 82a-1212

ID NO.

MW-1

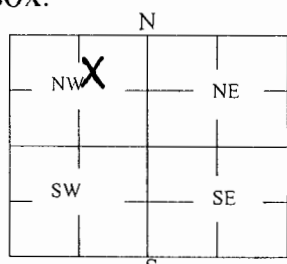
<b>1 LOCATION OF WATER WELL:</b> County: Bourbon Street/Rural Address of Well Location: if unknown, distance & direction from nearest town or intersection: If at owner's address, check here <input type="checkbox"/> ~500 feet north and ~100 feet west of N. National Ave. and Elm Street; Fort Scott, KS	Fraction SE ¼ NW ¼ NE ¼ NW ¼	Section Number 30	Township Number T 25 S	Range Number 25 <input checked="" type="checkbox"/> E <input type="checkbox"/> W																																																						
<b>2 WATER WELL OWNER:</b> Union Pacific Railroad RR#, St. Address, Box #: 1400 Douglas St.; Stop 1030 City, State ZIP Code: Omaha, NE 68179		<b>Global Positioning Systems (GPS) information:</b> Latitude: 37.845952 (in decimal degrees) Longitude: -94.707453 (in decimal degrees) Elevation: 850 Horizontal Datum: <input checked="" type="checkbox"/> WGS84, <input type="checkbox"/> NAD83, <input type="checkbox"/> NAD27 Collection Method: <input checked="" type="checkbox"/> GPS unit (Make/Model: Garmin etrek 10) <input type="checkbox"/> Digital Map/Photo, <input type="checkbox"/> Topographic Map, <input type="checkbox"/> Land Survey Est. Accuracy: <input type="checkbox"/> < 3 m, <input checked="" type="checkbox"/> 3-5 m, <input type="checkbox"/> 5-15 m, <input type="checkbox"/> > 15 m																																																								
<b>3 MARK WELL'S LOCATION WITH AN "X" IN SECTION BOX:</b> <div style="text-align: center;">  </div>	<b>4 DEPTH OF WELL</b> 52.86 ft. WELL'S STATIC WATER LEVEL _____ ft. WELL WAS USED AS: <div style="display: flex; justify-content: space-between;"> <div style="width: 30%;"> <input type="checkbox"/> Domestic  <input type="checkbox"/> Irrigation  <input type="checkbox"/> Feedlot  <input type="checkbox"/> Industrial         </div> <div style="width: 30%;"> <input type="checkbox"/> Public Water Supply  <input type="checkbox"/> Oil Field Water Supply  <input type="checkbox"/> Domestic (Lawn &amp; Garden)  <input type="checkbox"/> Air Conditioning         </div> <div style="width: 30%;"> <input checked="" type="checkbox"/> Dewatering  <input type="checkbox"/> Monitoring  <input type="checkbox"/> Injection Well  <input type="checkbox"/> Other _____         </div> </div> Was a chemical/bacteriological sample submitted to Department? Yes <input type="checkbox"/> No <input checked="" type="checkbox"/>																																																									
<b>5 TYPE OF BLANK CASING USED:</b> <div style="display: flex; justify-content: space-between;"> <div style="width: 20%;"> <input checked="" type="checkbox"/> Steel  <input checked="" type="checkbox"/> PVC         </div> <div style="width: 20%;"> <input type="checkbox"/> RMP (SR)  <input type="checkbox"/> ABS         </div> <div style="width: 20%;"> <input type="checkbox"/> Wrought  <input type="checkbox"/> Asbestos-Cement         </div> <div style="width: 20%;"> <input type="checkbox"/> Fiberglass  <input type="checkbox"/> Concrete Tile         </div> <div style="width: 20%;"> <input type="checkbox"/> Other (Specify below) _____         </div> </div> Blank casing diameter 2 in. Was casing pulled? Yes <input checked="" type="checkbox"/> No <input type="checkbox"/> If yes, how much au Casing height above or below land surface 30 in.																																																										
<b>6 GROUT PLUG MATERIAL:</b> <input type="checkbox"/> Neat cement <input type="checkbox"/> Cement grout <input checked="" type="checkbox"/> Bentonite <input checked="" type="checkbox"/> Other Top Soil Grout Plug Intervals: From 0 ft. to 3 ft., From 3 ft. to 52.86 ft., From _____ ft. to _____ ft. What is the nearest source of possible contamination: <div style="display: flex; justify-content: space-between;"> <div style="width: 30%;"> <input type="checkbox"/> Septic tank  <input type="checkbox"/> Sewer lines  <input type="checkbox"/> Watertight sewer lines  <input type="checkbox"/> Lateral lines  <input type="checkbox"/> Cess pool         </div> <div style="width: 30%;"> <input type="checkbox"/> Seepage pit  <input type="checkbox"/> Pit privy  <input type="checkbox"/> Sewage lagoon  <input type="checkbox"/> Feedyard  <input type="checkbox"/> Livestock pens         </div> <div style="width: 30%;"> <input type="checkbox"/> Fuel storage  <input type="checkbox"/> Fertilizer storage  <input type="checkbox"/> Insecticide storage  <input type="checkbox"/> Abandoned water well  <input type="checkbox"/> Oil well/Gas well         </div> </div> <input checked="" type="checkbox"/> Other (specify below) unknown Direction from well? unknown How many feet? unknown																																																										
<table border="1" style="width:100%; border-collapse: collapse;"> <thead> <tr> <th style="width:10%;">FROM</th> <th style="width:10%;">TO</th> <th style="width:40%;">PLUGGING MATERIALS</th> <th style="width:10%;">FROM</th> <th style="width:10%;">TO</th> <th style="width:40%;">PLUGGING MATERIALS</th> </tr> </thead> <tbody> <tr> <td>0</td> <td>3</td> <td>Top Soil</td> <td></td> <td></td> <td></td> </tr> <tr> <td>3</td> <td>52.86</td> <td>Bentonite</td> <td></td> <td></td> <td></td> </tr> <tr><td> </td><td> </td><td> </td><td> </td><td> </td><td> </td></tr> <tr><td> </td><td> </td><td> </td><td> </td><td> </td><td> </td></tr> <tr><td> </td><td> </td><td> </td><td> </td><td> </td><td> </td></tr> <tr><td> </td><td> </td><td> </td><td> </td><td> </td><td> </td></tr> <tr><td> </td><td> </td><td> </td><td> </td><td> </td><td> </td></tr> <tr><td> </td><td> </td><td> </td><td> </td><td> </td><td> </td></tr> </tbody> </table>					FROM	TO	PLUGGING MATERIALS	FROM	TO	PLUGGING MATERIALS	0	3	Top Soil				3	52.86	Bentonite																																							
FROM	TO	PLUGGING MATERIALS	FROM	TO	PLUGGING MATERIALS																																																					
0	3	Top Soil																																																								
3	52.86	Bentonite																																																								
<b>7 CONTRACTOR'S OR LANDOWNER'S CERTIFICATION:</b> This water well was plugged under my jurisdiction and was completed on (mo/day/year) 08/30/2018 and this record is true to the best of my knowledge and belief. Kansas Water Well Contractor's License No. 710. This Water Well Record was completed on (mo/day/year) 8/31/2018 under the business name of Below Ground Surface, Inc. by (signature) <i>Craig R. Hewitt</i>																																																										
Send one white copy to Kansas Department of Health & Environment, Geology Section, 1000 SW Jackson Street, Ste. 420, Topeka, KS 66612-1367. Send one copy to WATER WELL OWNER and retain one for your records. Visit us at <a href="http://www.kdheks.gov/waterwell/index.html">http://www.kdheks.gov/waterwell/index.html</a> Telephone 785-296-5524.																																																										

BOYDTON NW 30 - 25 - 25E

UPRAILROAD

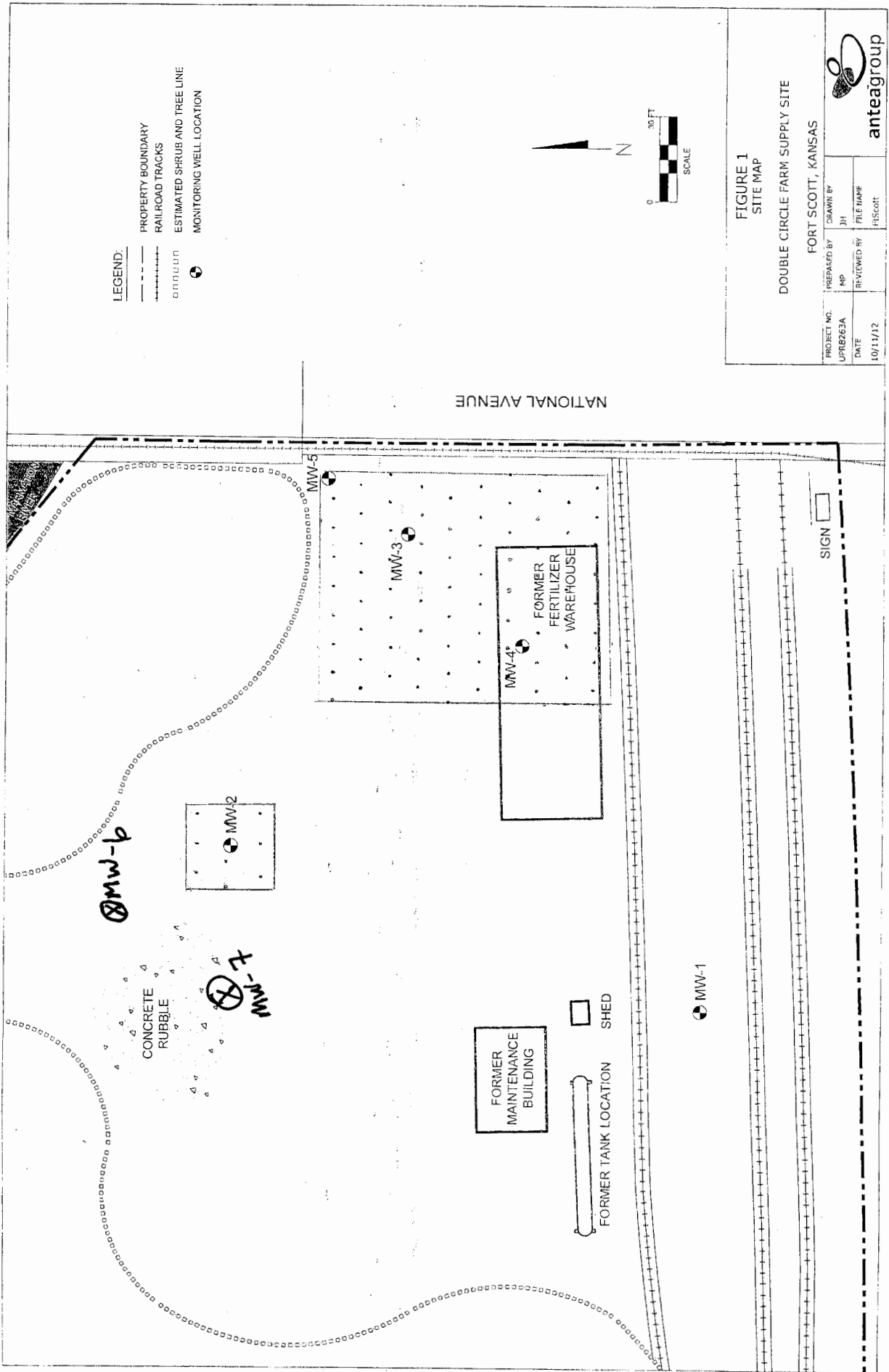

Elm St.