

WATER WELL PLUGGING RECORD Form WWC-5P

KSA 82a-1212 ID NO.

MW-2

1 LOCATION OF WATER WELL: County: Bourbon	Fraction SE ¼ NW ¼ NE ¼ NW ¼	Section Number 30	Township Number T 25 S	Range Number 25 <input checked="" type="checkbox"/> E <input type="checkbox"/> W																																																
Street/Rural Address of Well Location: if unknown, distance & direction from nearest town or intersection: If at owner's address, check here <input type="checkbox"/> ~500 feet north and ~100 feet west of N. National Ave. and Elm Street; Fort Scott, KS		Global Positioning Systems (GPS) information: Latitude: 37. <u>845886</u> (in decimal degrees) Longitude: -94. <u>707463</u> (in decimal degrees) Elevation: 850 Horizontal Datum: <input checked="" type="checkbox"/> WGS84, <input type="checkbox"/> NAD83, <input type="checkbox"/> NAD27 Collection Method: <input checked="" type="checkbox"/> GPS unit (Make/Model: <u>Garmin etrek 10</u>) <input type="checkbox"/> Digital Map/Photo, <input type="checkbox"/> Topographic Map, <input type="checkbox"/> Land Survey Est. Accuracy: <input type="checkbox"/> < 3 m, <input checked="" type="checkbox"/> 3-5 m, <input type="checkbox"/> 5-15 m, <input type="checkbox"/> > 15 m																																																		
2 WATER WELL OWNER: Union Pacific Railroad RR#, St. Address, Box #: 1400 Douglas St.; Stop 1030 City, State ZIP Code: Omaha, NE 68179																																																				
3 MARK WELL'S LOCATION WITH AN "X" IN SECTION BOX: <div style="text-align: center;"> </div>	4 DEPTH OF WELL <u>53</u> ft. WELL'S STATIC WATER LEVEL _____ ft. WELL WAS USED AS: <div style="display: flex; justify-content: space-between;"> <div style="width: 30%;"> <input type="checkbox"/> Domestic <input type="checkbox"/> Irrigation <input type="checkbox"/> Feedlot <input type="checkbox"/> Industrial </div> <div style="width: 30%;"> <input type="checkbox"/> Public Water Supply <input type="checkbox"/> Oil Field Water Supply <input type="checkbox"/> Domestic (Lawn & Garden) <input type="checkbox"/> Air Conditioning </div> <div style="width: 30%;"> <input checked="" type="checkbox"/> Dewatering <input checked="" type="checkbox"/> Monitoring MW-2 <input type="checkbox"/> Injection Well <input type="checkbox"/> Other _____ </div> </div> Was a chemical/bacteriological sample submitted to Department? Yes <input type="checkbox"/> No <input checked="" type="checkbox"/>																																																			
5 TYPE OF BLANK CASING USED: <div style="display: flex; justify-content: space-between;"> <div style="width: 20%;"> <input type="checkbox"/> Steel <input checked="" type="checkbox"/> PVC </div> <div style="width: 20%;"> <input type="checkbox"/> RMP (SR) <input type="checkbox"/> ABS </div> <div style="width: 20%;"> <input type="checkbox"/> Wrought <input type="checkbox"/> Asbestos-Cement </div> <div style="width: 20%;"> <input type="checkbox"/> Fiberglass <input type="checkbox"/> Concrete Tile </div> <div style="width: 20%;"> <input type="checkbox"/> Other (Specify below) _____ </div> </div> Blank casing diameter <u>2</u> in. Was casing pulled? Yes <input checked="" type="checkbox"/> No <input type="checkbox"/> If yes, how much <u>au</u> Casing height above or below land surface <u>30</u> in.																																																				
6 GROUT PLUG MATERIAL: <input type="checkbox"/> Neat cement <input type="checkbox"/> Cement grout <input checked="" type="checkbox"/> Bentonite <input checked="" type="checkbox"/> Other <u>Top Soil</u> Grout Plug Intervals: From <u>0</u> ft. to <u>3</u> ft., From <u>3</u> ft. to <u>53</u> ft., From <u>—</u> ft. to <u>—</u> ft. What is the nearest source of possible contamination: <div style="display: flex; justify-content: space-between;"> <div style="width: 30%;"> <input type="checkbox"/> Septic tank <input type="checkbox"/> Sewer lines <input type="checkbox"/> Watertight sewer lines <input type="checkbox"/> Lateral lines <input type="checkbox"/> Cess pool </div> <div style="width: 30%;"> <input type="checkbox"/> Seepage pit <input type="checkbox"/> Pit privy <input type="checkbox"/> Sewage lagoon <input type="checkbox"/> Feedyard <input type="checkbox"/> Livestock pens </div> <div style="width: 30%;"> <input type="checkbox"/> Fuel storage <input type="checkbox"/> Fertilizer storage <input type="checkbox"/> Insecticide storage <input type="checkbox"/> Abandoned water well <input type="checkbox"/> Oil well/Gas well </div> <div style="width: 30%;"> <input checked="" type="checkbox"/> Other (specify below) <u>unknown</u> Direction from well? <u>unknown</u> How many feet? <u>unknown</u> </div> </div> <table border="1" style="width:100%; border-collapse: collapse; margin-top: 10px;"> <thead> <tr> <th>FROM</th> <th>TO</th> <th>PLUGGING MATERIALS</th> <th>FROM</th> <th>TO</th> <th>PLUGGING MATERIALS</th> </tr> </thead> <tbody> <tr> <td><u>0</u></td> <td><u>3</u></td> <td><u>Top Soil</u></td> <td></td> <td></td> <td></td> </tr> <tr> <td><u>3</u></td> <td><u>53</u></td> <td><u>Bentonite</u></td> <td></td> <td></td> <td></td> </tr> <tr><td> </td><td> </td><td> </td><td> </td><td> </td><td> </td></tr> <tr><td> </td><td> </td><td> </td><td> </td><td> </td><td> </td></tr> <tr><td> </td><td> </td><td> </td><td> </td><td> </td><td> </td></tr> <tr><td> </td><td> </td><td> </td><td> </td><td> </td><td> </td></tr> <tr><td> </td><td> </td><td> </td><td> </td><td> </td><td> </td></tr> </tbody> </table>					FROM	TO	PLUGGING MATERIALS	FROM	TO	PLUGGING MATERIALS	<u>0</u>	<u>3</u>	<u>Top Soil</u>				<u>3</u>	<u>53</u>	<u>Bentonite</u>																																	
FROM	TO	PLUGGING MATERIALS	FROM	TO	PLUGGING MATERIALS																																															
<u>0</u>	<u>3</u>	<u>Top Soil</u>																																																		
<u>3</u>	<u>53</u>	<u>Bentonite</u>																																																		
7 CONTRACTOR'S OR LANDOWNER'S CERTIFICATION: This water well was plugged under my jurisdiction and was completed on (mo/day/year) <u>08/30/2018</u> and this record is true to the best of my knowledge and belief. Kansas Water Well Contractor's License No. <u>710</u> . This Water Well Record was completed on (mo/day/year) <u>8/31/2018</u> under the business name of <u>Below Ground Surface, Inc.</u> by (signature) <u>Craig R. Hewitt</u>																																																				

Send one white copy to Kansas Department of Health & Environment, Geology Section, 1000 SW Jackson Street, Ste. 420, Topeka, KS 66612-1367. Send one copy to WATER WELL OWNER and retain one for your records.

Visit us at <http://www.kdheks.gov/waterwell/index.html> Telephone 785-296-5524.

KSA82a-1212

Revised 1/20/2015

BOYDTON NW 30 - 25 - 25E

UPRAILROAD

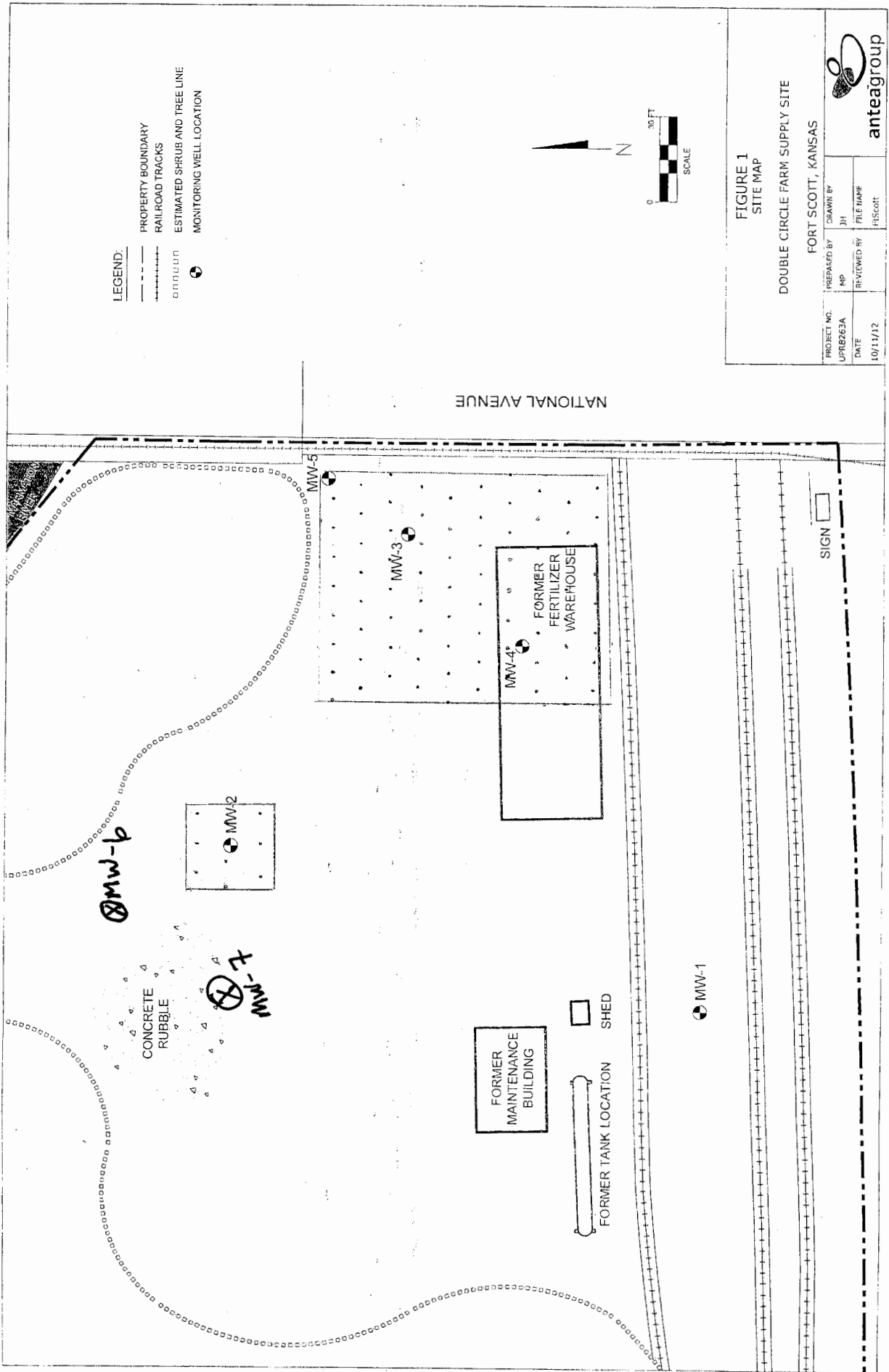

Elm St.