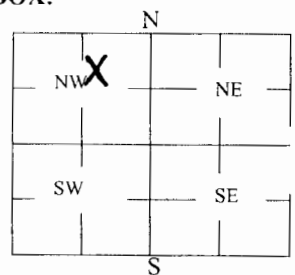

WATER WELL PLUGGING RECORD Form WWC-5P

KSA 82a-1212

ID NO.

MW-5

1 LOCATION OF WATER WELL: County: Bourbon Fraction SE ¼ NW ¼ NE ¼ NW ¼ Section Number 30 Township Number T 25 S Range Number 25 <input checked="" type="checkbox"/> E <input type="checkbox"/> W	Global Positioning Systems (GPS) information: Latitude: 37. 845640 (in decimal degrees) Longitude: -94. 708190 (in decimal degrees) Elevation: 850 Horizontal Datum: <input checked="" type="checkbox"/> WGS84, <input type="checkbox"/> NAD83, <input type="checkbox"/> NAD27 Collection Method: <input checked="" type="checkbox"/> GPS unit (Make/Model: Garmin etrek 10) <input type="checkbox"/> Digital Map/Photo, <input type="checkbox"/> Topographic Map, <input type="checkbox"/> Land Survey Est. Accuracy: <input type="checkbox"/> < 3 m, <input checked="" type="checkbox"/> 3-5 m, <input type="checkbox"/> 5-15 m, <input type="checkbox"/> > 15 m																																																						
2 WATER WELL OWNER: Union Pacific Railroad RR#, St. Address, Box #: 1400 Douglas St.; Stop 1030 City, State ZIP Code: Omaha, NE 68179	3 MARK WELL'S LOCATION WITH AN "X" IN SECTION BOX: <div style="text-align: center;">  </div>																																																						
4 DEPTH OF WELL 53 ft. WELL'S STATIC WATER LEVEL _____ ft. WELL WAS USED AS: <div style="display: flex; justify-content: space-around;"> <div style="text-align: center;"> <input type="checkbox"/> Domestic <input type="checkbox"/> Irrigation <input type="checkbox"/> Feedlot <input type="checkbox"/> Industrial </div> <div style="text-align: center;"> <input type="checkbox"/> Public Water Supply <input type="checkbox"/> Oil Field Water Supply <input type="checkbox"/> Domestic (Lawn & Garden) <input type="checkbox"/> Air Conditioning </div> <div style="text-align: center;"> <input checked="" type="checkbox"/> Dewatering <input type="checkbox"/> Monitoring <input type="checkbox"/> Injection Well <input type="checkbox"/> Other </div> </div> Was a chemical/bacteriological sample submitted to Department? Yes <input type="checkbox"/> No <input checked="" type="checkbox"/>																																																							
5 TYPE OF BLANK CASING USED: <input checked="" type="checkbox"/> Steel <input type="checkbox"/> PVC <input type="checkbox"/> RMP (SR) <input type="checkbox"/> ABS <input type="checkbox"/> Wrought <input type="checkbox"/> Asbestos-Cement <input type="checkbox"/> Fiberglass <input type="checkbox"/> Concrete Tile <input type="checkbox"/> Other (Specify below) _____ Blank casing diameter 2 in. Was casing pulled? Yes <input checked="" type="checkbox"/> No <input type="checkbox"/> If yes, how much au Casing height above or below land surface 30 in.																																																							
6 GROUT PLUG MATERIAL: <input type="checkbox"/> Neat cement <input type="checkbox"/> Cement grout <input checked="" type="checkbox"/> Bentonite <input checked="" type="checkbox"/> Other Top Soil Grout Plug Intervals: From 0 ft. to 3 ft., From 3 ft. to 53 ft., From _____ ft. to _____ ft. What is the nearest source of possible contamination: <div style="display: flex; justify-content: space-between;"> <div style="width: 30%;"> <input type="checkbox"/> Septic tank <input type="checkbox"/> Sewer lines <input type="checkbox"/> Watertight sewer lines <input type="checkbox"/> Lateral lines <input type="checkbox"/> Cess pool </div> <div style="width: 30%;"> <input type="checkbox"/> Seepage pit <input type="checkbox"/> Pit privy <input type="checkbox"/> Sewage lagoon <input type="checkbox"/> Feedyard <input type="checkbox"/> Livestock pens </div> <div style="width: 30%;"> <input type="checkbox"/> Fuel storage <input type="checkbox"/> Fertilizer storage <input type="checkbox"/> Insecticide storage <input type="checkbox"/> Abandoned water well <input type="checkbox"/> Oil well/Gas well </div> </div> <input checked="" type="checkbox"/> Other (specify below) unknown Direction from well? unknown How many feet? unknown																																																							
<table border="1" style="width:100%; border-collapse: collapse;"> <thead> <tr> <th>FROM</th> <th>TO</th> <th>PLUGGING MATERIALS</th> <th>FROM</th> <th>TO</th> <th>PLUGGING MATERIALS</th> </tr> </thead> <tbody> <tr> <td>0</td> <td>3</td> <td>Top Soil</td> <td></td> <td></td> <td></td> </tr> <tr> <td>3</td> <td>53</td> <td>Bentonite</td> <td></td> <td></td> <td></td> </tr> <tr><td> </td><td> </td><td> </td><td> </td><td> </td><td> </td></tr> <tr><td> </td><td> </td><td> </td><td> </td><td> </td><td> </td></tr> <tr><td> </td><td> </td><td> </td><td> </td><td> </td><td> </td></tr> <tr><td> </td><td> </td><td> </td><td> </td><td> </td><td> </td></tr> <tr><td> </td><td> </td><td> </td><td> </td><td> </td><td> </td></tr> <tr><td> </td><td> </td><td> </td><td> </td><td> </td><td> </td></tr> </tbody> </table>		FROM	TO	PLUGGING MATERIALS	FROM	TO	PLUGGING MATERIALS	0	3	Top Soil				3	53	Bentonite																																							
FROM	TO	PLUGGING MATERIALS	FROM	TO	PLUGGING MATERIALS																																																		
0	3	Top Soil																																																					
3	53	Bentonite																																																					
7 CONTRACTOR'S OR LANDOWNER'S CERTIFICATION: This water well was plugged under my jurisdiction and was completed on (mo/day/year) 08/30/2018 and this record is true to the best of my knowledge and belief. Kansas Water Well Contractor's License No. 710. This Water Well Record was completed on (mo/day/year) 8/31/2018 under the business name of Below Ground Surface, Inc. by (signature) Craig R. Hester																																																							

Send one white copy to Kansas Department of Health & Environment, Geology Section, 1000 SW Jackson Street, Ste. 420, Topeka, KS 66612-1367. Send one copy to WATER WELL OWNER and retain one for your records.

Visit us at <http://www.kdheks.gov/waterwell/index.html> Telephone 785-296-5524.

BOYDTON NW 30 - 25 - 25E

UPRAILROAD

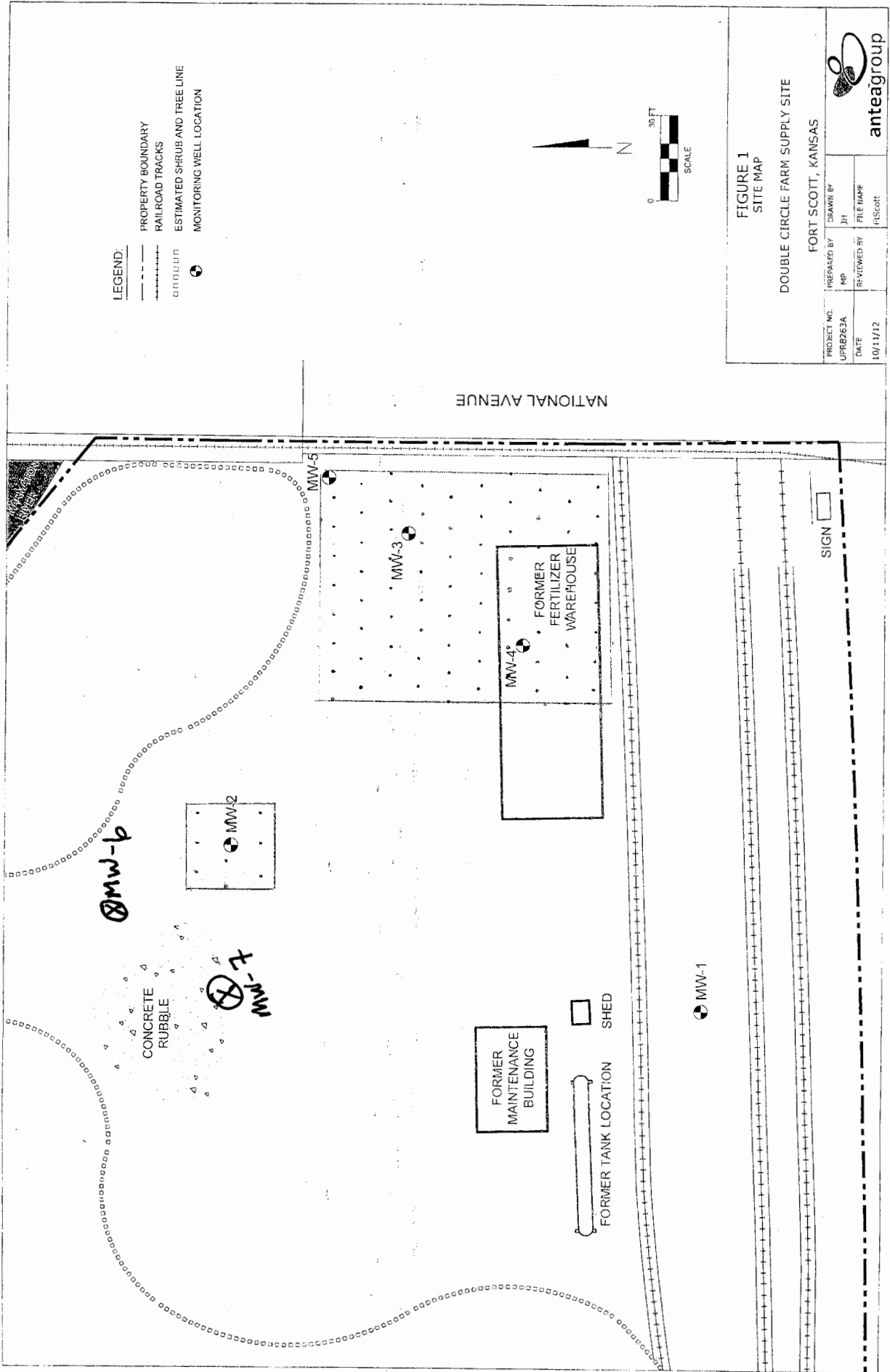

Elm St.