

## WATER WELL PLUGGING RECORD Form WWC-5P

KSA 82a-1212 ID NO.

MW-7

<b>1 LOCATION OF WATER WELL:</b> County: Bourbon	Fraction SE ¼ NW ¼ NE ¼ NW ¼	Section Number 30	Township Number T 25 S	Range Number 25 <del>N</del> E <input type="checkbox"/> W
Street/Rural Address of Well Location; if unknown, distance & direction from nearest town or intersection: If at owner's address, check here <input type="checkbox"/> ~500 feet north and ~100 feet west of N. National Ave. and Elm Street; Fort Scott, KS		<b>Global Positioning Systems (GPS) information:</b> Latitude: 37. <u>84605</u> (in decimal degrees) Longitude: -94. <u>70800</u> (in decimal degrees) Elevation: 850 Horizontal Datum: <input checked="" type="checkbox"/> WGS84, <input type="checkbox"/> NAD83, <input type="checkbox"/> NAD27 Collection Method: <input checked="" type="checkbox"/> GPS unit (Make/Model: Garmin etrek 10) <input type="checkbox"/> Digital Map/Photo, <input type="checkbox"/> Topographic Map, <input type="checkbox"/> Land Survey Est. Accuracy: <input type="checkbox"/> < 3 m, <input checked="" type="checkbox"/> 3-5 m, <input type="checkbox"/> 5-15 m, <input type="checkbox"/> > 15 m		
<b>2 WATER WELL OWNER:</b> Union Pacific Railroad RR#, St. Address, Box #: 1400 Douglas St.; Stop 1030 City, State ZIP Code: Omaha, NE 68179				

<b>3 MARK WELL'S LOCATION WITH AN "X" IN SECTION BOX:</b>	<b>4 DEPTH OF WELL</b> <u>50</u> ft.
	WELL'S STATIC WATER LEVEL _____ ft. WELL WAS USED AS: <input type="checkbox"/> Domestic <input type="checkbox"/> Public Water Supply <input checked="" type="checkbox"/> Dewatering <b>MW-7</b> <input type="checkbox"/> Irrigation <input type="checkbox"/> Oil Field Water Supply <input type="checkbox"/> Monitoring <input type="checkbox"/> Feedlot <input type="checkbox"/> Domestic (Lawn & Garden) <input type="checkbox"/> Injection Well <input type="checkbox"/> Industrial <input type="checkbox"/> Air Conditioning <input type="checkbox"/> Other _____ Was a chemical/bacteriological sample submitted to Department? Yes <input type="checkbox"/> No <input checked="" type="checkbox"/>

**5 TYPE OF BLANK CASING USED:**

☒ Steel ☐ RMP (SR) ☐ Wrought ☐ Fiberglass ☐ Other (Specify below)  
☒ PVC ☐ ABS ☐ Asbestos-Cement ☐ Concrete Tile

Blank casing diameter 2 in. Was casing pulled? Yes ☒ No ☐ If yes, how much \_\_\_\_\_

Casing height above or below land surface 30 in.

**6 GROUT PLUG MATERIAL:** ☐ Neat cement ☐ Cement grout ☒ Bentonite ☒ Other Top Soil

Grout Plug Intervals: From 0 ft. to 3 ft., From 3 ft. to 50 ft., From — ft. to — ft.

What is the nearest source of possible contamination:

<input type="checkbox"/> Septic tank	<input type="checkbox"/> Seepage pit	<input type="checkbox"/> Fuel storage	<input checked="" type="checkbox"/> Other (specify below) <u>unknown</u>
<input type="checkbox"/> Sewer lines	<input type="checkbox"/> Pit privy	<input type="checkbox"/> Fertilizer storage	
<input type="checkbox"/> Watertight sewer lines	<input type="checkbox"/> Sewage lagoon	<input type="checkbox"/> Insecticide storage	
<input type="checkbox"/> Lateral lines	<input type="checkbox"/> Feedyard	<input type="checkbox"/> Abandoned water well	
<input type="checkbox"/> Cess pool	<input type="checkbox"/> Livestock pens	<input type="checkbox"/> Oil well/Gas well	

Direction from well? unknown  
How many feet? unknown

FROM	TO	PLUGGING MATERIALS	FROM	TO	PLUGGING MATERIALS
<u>0</u>	<u>3</u>	<u>Top Soil</u>			
<u>3</u>	<u>50</u>	<u>Bentonite</u>			

**7 CONTRACTOR'S OR LANDOWNER'S CERTIFICATION:** This water well was plugged under my jurisdiction and was completed on (mo/day/year) 08/30/2018 and this record is true to the best of my knowledge and belief. Kansas Water Well Contractor's License No. 710. This Water Well Record was completed on (mo/day/year) 8/31/2018 under the business name of Below Ground Surface, Inc. by (signature) Craig R. Hewitt

Send one white copy to Kansas Department of Health & Environment, Geology Section, 1000 SW Jackson Street, Ste. 420, Topeka, KS 66612-1367. Send one copy to WATER WELL OWNER and retain one for your records.  
Visit us at <http://www.kdheks.gov/waterwell/index.html> Telephone 785-296-5524.

BOYDTON NW 30 - 25 - 25E

UPRAILROAD

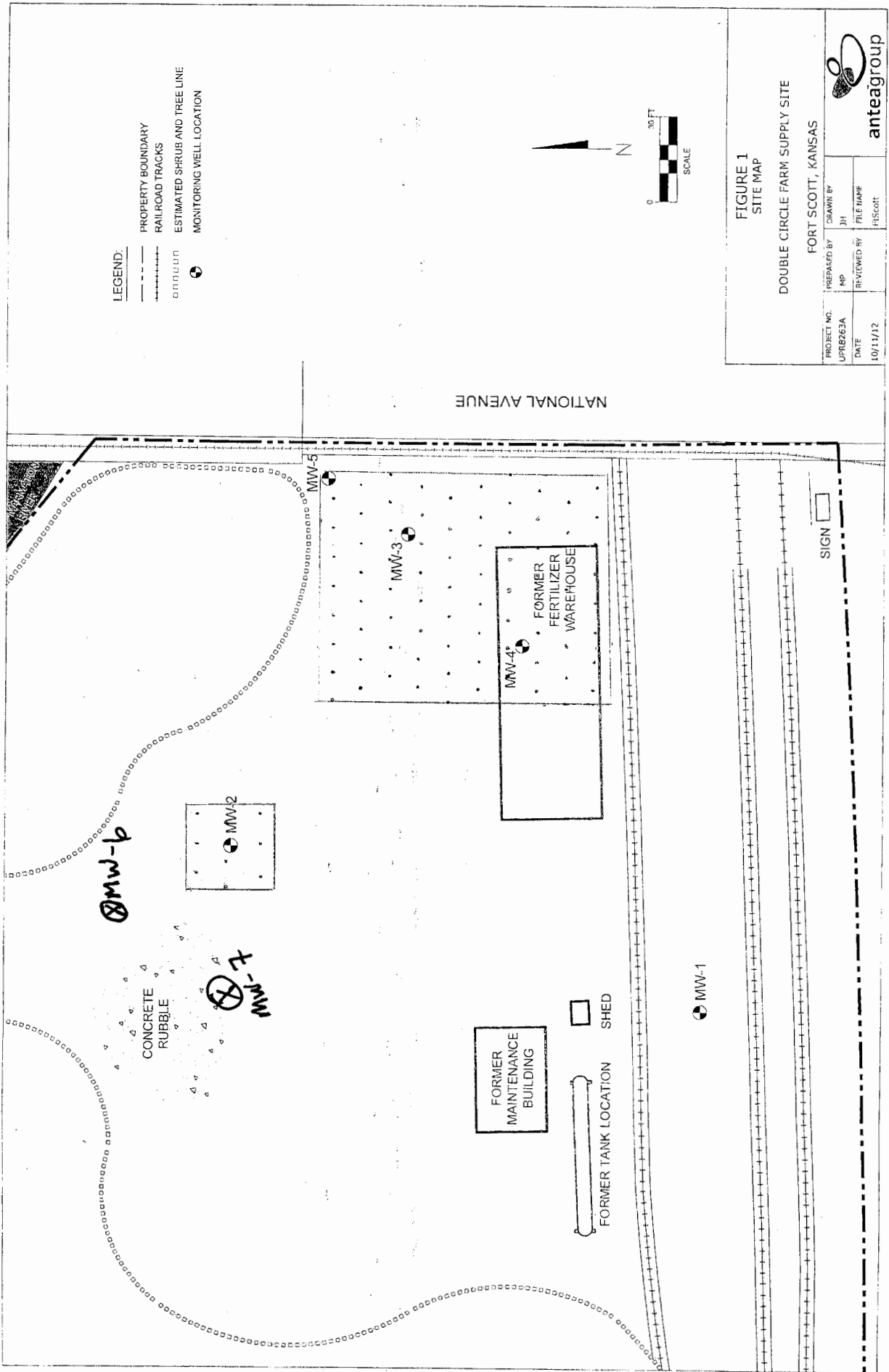

Elm St.