

# Associated Environmental Industries

3205 Bart Conner Dr. | Norman, OK 73072

P.O. Box 5300 | Norman, OK 73070

Phone (405)360-1434 | Fax (405)360-1480

[www.aei-corp.com](http://www.aei-corp.com)

---

January 25, 2016

Deb Biester  
Water Well & Technical Support Unit  
Geology & Well Technology Section/Bureau of Water  
Kansas Department of Health and Environment  
1000 SW Jackson, Suite 420  
Topeka, KS 66612-1367

Deb:

Attached please find 4 Water Well Records and a site map for a variance request at the El Paso Merchant Energy-Benton, KS, along with a check for filing fees in the amount of \$20.00. I spoke with Pamela Chaffee last week and she gave me your name as the person to send these to for filing.

Please let me know if there is anything else that I need to do in this matter.

Sincerely,

Jenny Gowens  
Associated Environmental Industries

RECEIVED  
JAN 29 2016  
BUREAU OF WATER

**WATER WELL RECORD Form WWC-5**

Division of Water Resources App. No.

Well ID RW 35

Original Record  Correction  Change in Well Use

<b>1 LOCATION OF WATER WELL:</b> County: <b>Butler</b>	Fraction SE ¼ SW ¼ SE ¼ SW ¼	Section Number <b>32</b>	Township Number <b>T 25 S</b>	Range Number <b>R 3</b> <input checked="" type="checkbox"/> E <input type="checkbox"/> W
---	---------------------------------	-----------------------------	----------------------------------	---

<b>2 WELL OWNER:</b> Last Name: _____ First: _____ Business: <b>El Paso Merchant Energy-Petroleum Co.</b> Address: <b>2 N. Nevada Ave</b> Address: _____ City: <b>Colorado Springs</b> State: <b>CO</b> ZIP: <b>80903</b>	Street or Rural Address where well is located (if unknown, distance and direction from nearest town or intersection): If at owner's address, check here: <input type="checkbox"/> <b>15508 Northwest Parallel Road, Benton, KS 67017</b>
---	---

<b>3 LOCATE WELL WITH "X" IN SECTION BOX:</b> N W E S -----1 mile-----	<b>4 DEPTH OF COMPLETED WELL:</b> ..... <b>28.4</b> ..... ft. Depth(s) Groundwater Encountered: 1) ..... <b>13.6</b> ..... ft. 2) ..... ft. 3) ..... ft., or 4) <input type="checkbox"/> Dry Well WELL'S STATIC WATER LEVEL: ..... <b>12.69</b> ..... ft. <input checked="" type="checkbox"/> below land surface, measured on (mo-day-yr) <b>10/22/2015</b> <input type="checkbox"/> above land surface, measured on (mo-day-yr)..... Pump test data: Well water was ..... ft. after ..... hours pumping ..... gpm Well water was ..... ft. after ..... hours pumping ..... gpm Estimated Yield: ..... <b>0</b> ..... gpm Bore Hole Diameter: ..... <b>10</b> ..... in. to ..... <b>28.4</b> ..... ft. and ..... in. to ..... ft.	<b>5 Latitude:</b> ..... <b>37.825353</b> ..... (decimal degrees) <b>Longitude:</b> ..... <b>97.127275</b> ..... (decimal degrees) Datum: <input checked="" type="checkbox"/> WGS 84 <input type="checkbox"/> NAD 83 <input type="checkbox"/> NAD 27 Source for Latitude/Longitude: <input type="checkbox"/> GPS (unit make/model: .....) (WAAS enabled? <input type="checkbox"/> Yes <input type="checkbox"/> No) <input type="checkbox"/> Land Survey <input type="checkbox"/> Topographic Map <input type="checkbox"/> Online Mapper: .....
--	---	---

**7 WELL WATER TO BE USED AS:**

1. Domestic: <input type="checkbox"/> Household <input type="checkbox"/> Lawn & Garden <input type="checkbox"/> Livestock	5. <input type="checkbox"/> Public Water Supply: well ID .....	10. <input type="checkbox"/> Oil Field Water Supply: lease .....
2. <input type="checkbox"/> Irrigation	6. <input type="checkbox"/> Dewatering: how many wells? .....	11. Test Hole: well ID .....
3. <input type="checkbox"/> Feedlot	7. <input type="checkbox"/> Aquifer Recharge: well ID .....	<input type="checkbox"/> Cased <input type="checkbox"/> Uncased <input type="checkbox"/> Geotechnical
4. <input type="checkbox"/> Industrial	8. <input type="checkbox"/> Monitoring: well ID .....	12. Geothermal: how many bores? .....
	9. Environmental Remediation: well ID <b>RW 35</b> .....	a) Closed Loop <input type="checkbox"/> Horizontal <input type="checkbox"/> Vertical
	<input type="checkbox"/> Air Sparge <input type="checkbox"/> Soil Vapor Extraction	b) Open Loop <input type="checkbox"/> Surface Discharge <input type="checkbox"/> Inj. of Water
	<input checked="" type="checkbox"/> Recovery <input type="checkbox"/> Injection	13. <input type="checkbox"/> Other (specify): .....

Was a chemical/bacteriological sample submitted to KDHE?  Yes  No If yes, date sample was submitted: .....

Water well disinfected?  Yes  No

**8 TYPE OF CASING USED:**  Steel  PVC  Other ..... CASING JOINTS:  Glued  Clamped  Welded  Threaded

Casing diameter ..... **6** ..... in. to ..... **16.4** ..... ft., Diameter ..... **6** ..... in. to ..... **26.6** ..... ft., Diameter ..... in. to ..... ft.  
Casing height above land surface ..... **0** ..... in. Weight ..... lbs./ft. Wall thickness or gauge No. **SCH40**

TYPE OF SCREEN OR PERFORATION MATERIAL:  
 Steel  Stainless Steel  Fiberglass  PVC  Other (Specify) .....

Brass  Galvanized Steel  Concrete tile  None used (open hole)

SCREEN OR PERFORATION OPENINGS ARE:  
 Continuous Slot  Mill Slot  Gauze Wrapped  Torch Cut  Drilled Holes  Other (Specify) .....

Louvered Shutter  Key Punched  Wire Wrapped  Saw Cut  None (Open Hole)

SCREEN-PERFORATED INTERVALS: From ..... **16.4** ..... ft. to ..... **21.4** ..... ft., From ..... ft. to ..... ft., From ..... ft. to ..... ft.  
GRAVEL PACK INTERVALS: From ..... **20.4** ..... ft. to ..... **21.4** ..... ft., From ..... ft. to ..... ft., From ..... ft. to ..... ft.

**9 GROUT MATERIAL:**  Neat cement  Cement grout  Bentonite  Other .....

Grout Intervals: From ..... **22.4** ..... ft. to ..... **28.4** ..... ft., From ..... ft. to ..... ft., From ..... ft. to ..... ft.

Nearest source of possible contamination:  
 Septic Tank  Lateral Lines  Pit Privy  Livestock Pens  Insecticide Storage  
 Sewer Lines  Cess Pool  Sewage Lagoon  Fuel Storage  Abandoned Water Well  
 Watertight Sewer Lines  Seepage Pit  Feedyard  Fertilizer Storage  Oil Well/Gas Well  
 Other (Specify) .....

Direction from well? ..... Distance from well? ..... ft.

10 FROM	TO	LITHOLOGIC LOG	FROM	TO	LITHO. LOG (cont.) or PLUGGING INTERVALS
0	20.4	Conductor Casing			
20.4	28.4	Shale			

**Notes:**  
Flush mount completion in below ground vault approved by KDHE - Pamela Chaffee, 12-07-15

**11 CONTRACTOR'S OR LANDOWNER'S CERTIFICATION:** This water well was  constructed,  reconstructed, or  plugged under my jurisdiction and was completed on (mo-day-year) **10/8/2015** ..... and this record is true to the best of my knowledge and belief. Kansas Water Well Contractor's License No. **551** ..... This Water Well Record was completed on (mo-day-year) **10/21/2015** ..... under the business name of **Associated Environmental Industries Corp.**

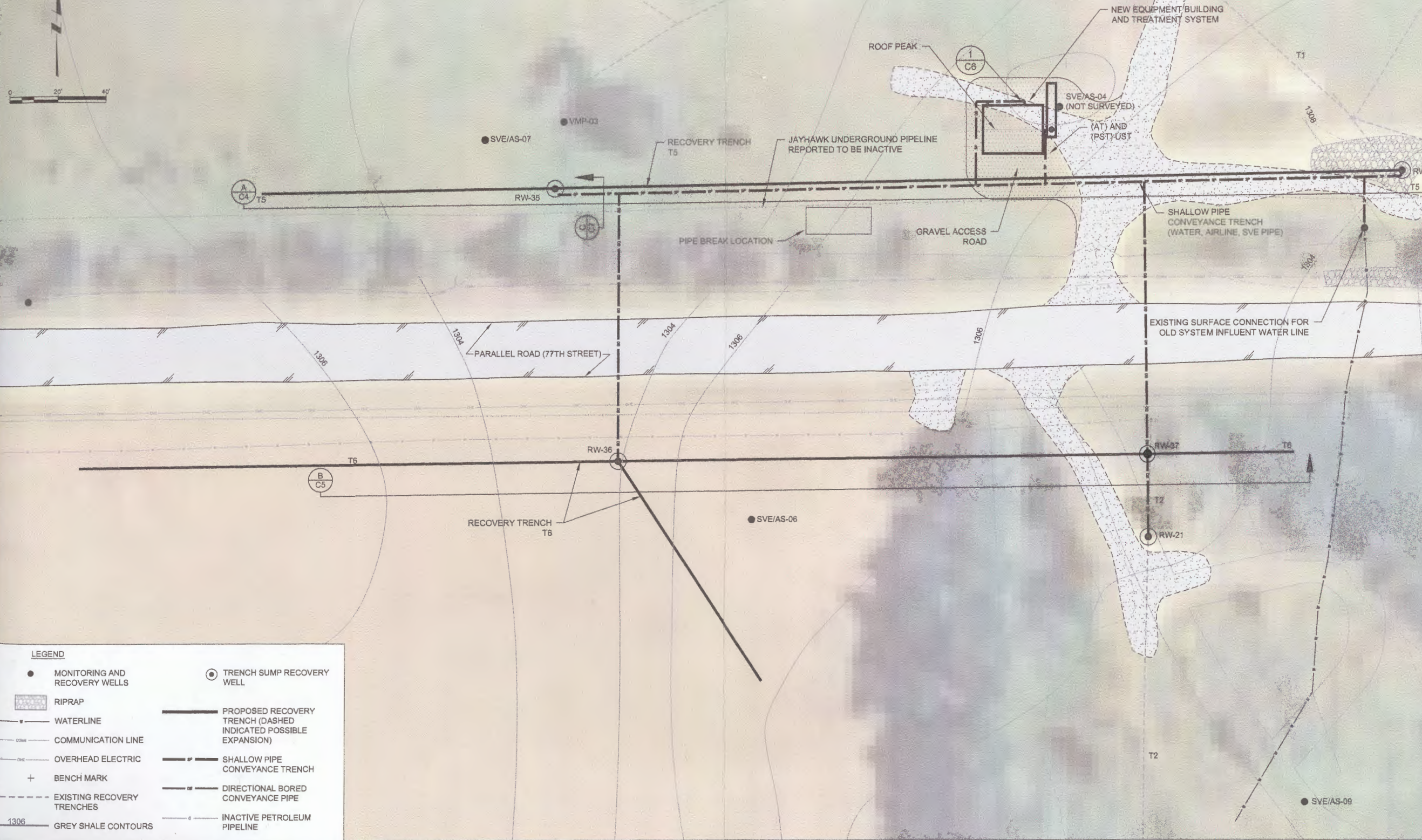

LEGEND	
●	MONITORING AND RECOVERY WELLS
○	TRENCH SUMP RECOVERY WELL
▨	RIPRAP
—	WATERLINE
—	COMMUNICATION LINE
—	OVERHEAD ELECTRIC
+	BENCH MARK
- - -	EXISTING RECOVERY TRENCHES
1306	GREY SHALE CONTOURS
- - -	PROPOSED RECOVERY TRENCH (DASHED INDICATED POSSIBLE EXPANSION)
—	SHALLOW PIPE CONVEYANCE TRENCH
—	DIRECTIONAL BORED CONVEYANCE PIPE
—	INACTIVE PETROLEUM PIPELINE