

1 LOCATION OF WATER WELL: County: Butler	Fraction NE ¼ NE ¼ SW ¼	Section Number 27	Township Number 25S	Range Number 5 E
---	-----------------------------------	-----------------------------	-------------------------------	----------------------------

Distance and direction from nearest town or city street address of well if located within city?
1835 N. Topeka Rd. – El Dorado

2 WATER WELL OWNER: TOTAL Petrochemicals USA, Inc. RR#, St. Address, Box #: 1201 Louisiana St., Ste. 1800 City, State, ZIP Code: Houston, TX 77002	Global Positioning System (decimal degrees, min. of 4 digits) Latitude: _____ Longitude: _____ Elevation: _____ Datum: _____ Data Collection Method: _____
---	--

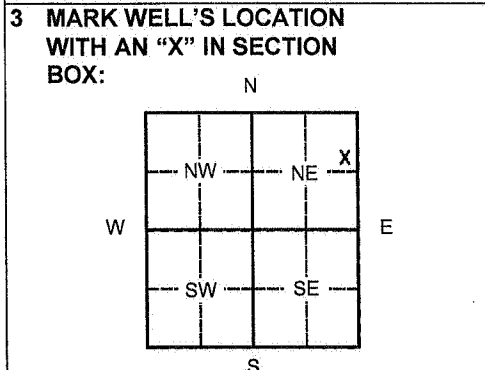

4 DEPTH OF WELL 19.56 ft.

WELL'S STATIC WATER LEVEL NM ft

WELL WAS USED AS:

1 Domestic	5 Public Water Supply	9 Dewatering
2 Irrigation	6 Oil Field Water Supply	10 <u>Monitoring</u>
3 Feedlot	7 Domestic (Lawn & Garden)	11 Injection Well
4 Industrial	8 Air Conditioning	12 Other _____

Was a chemical/bacteriological sample submitted to Department? Yes ___ No X

5 TYPE OF BLANK CASING USED:

1 Steel	3 RMP (SR)	5 Wrought	7 Fiberglass	9 Other (Specify below)
2 <u>PVC</u>	4 ABS	6 Asbestos-Cement	8 Concrete Tile	

Blank casing diameter 2 in. Was casing pulled? Yes X No ___ If yes, how much 3 ft.

Casing height above or below land surface 36 in.

6 GROUT PLUG MATERIAL: 1 Neat cement 2 Cement grout 3 Bentonite 4 Other _____

Grout Plug Intervals: From 3 ft. to 19.56 ft., From _____ ft. to _____ ft., From _____ to _____ ft.

What is the nearest source of possible contamination:

1 Septic tank	6 Seepage pit	11 Fuel Storage	16 Other (specify below)
2 Sewer lines	7 Pit privy	12 Fertilizer storage	
3 Watertight sewer lines	8 Sewage lagoon	13 Insecticide storage	
4 Lateral lines	9 Feedyard	14 Abandoned water well	Direction from well?
5 Cess pool	10 Livestock pens	15 Oil well/Gas well	How many feet?

FROM	TO	PLUGGING MATERIALS	FROM	TO	PLUGGING MATERIALS
0	3	Native Soil			
3	19.56	Bentonite Chips			

7 CONTRACTOR'S OR LANDOWNER'S CERTIFICATION: This water well was plugged under my jurisdiction and was completed on (mo/day/year) 04/23/13 and this record is true to the best of my knowledge and belief. Kansas Water Well Contractor's License No. 531. This Water Well Record was completed on (mo/day/year) 05/21/13 under the business name of GSI Engineering, LLC by (signature) _____.

INSTRUCTIONS: Please fill in blanks or circle the correct answers. Send top three copies to Kansas Department of Health and Environment, Bureau of Water, Geology Section, 1000 SW Jackson St., Ste. 420, Topeka, Kansas 66612-1367. Telephone: 785/296-5522. Send one to Water Well Owner and retain one for your records. Visit us at <http://www.kdheks.gov/waterwell>.