

County: Woodson Fraction: NE SW NW Sec. 36 T. 26 S R. 13 E

**CORRECTION(S) to WATER WELL COMPLETION RECORD Form WWC-5 (to rectify lacking or incorrect information)**

Owner: El Dorado Correctional Facility MW - 3

**If location corrected, was listed as:**

Section-Township-Range: S26-T26-R13E

Fraction (1/4 calls): SE SW SE

**Location changed to:**

S36-T26-R13E

NE SW NW

**Other changes:** Initial statements: Lat./Long coordinates provided were incorrect. Casing height after plugging incorrectly reported as 0 ft.

Changed to: WGS 84 (37.743855, -95.939735)

Casing height after plugging is now 3 ft below land surface.

Comments: \_\_\_\_\_

Verification method: Confirmed location using site map provided, LeoWeb, and Google Earth.

Submitted by: \_\_\_\_\_ Initials: BA Date: 4/22/2024

- Submitted by:  Kansas Geological Survey, Data Resources Library, 1930 Constant Ave., Lawrence, KS 66047-3724  
 Kansas Dept. of Health & Environment, Bureau of Water, 1000 SW Jackson, Suite 420, Topeka, KS 66612-1367

**WATER WELL PLUGGING RECORD Form WWC-5P**

KSA 82a-1212

ID NO.

MW-3

<b>1 LOCATION OF WATER WELL:</b> County: WOODSON	Fraction SW ¼ SE ¼ SW ¼ SE ¼	Section Number 26	Township Number T 26 S	Range Number 13 <input checked="" type="checkbox"/> E <input type="checkbox"/> W
---	---------------------------------	----------------------	---------------------------	---

Street/Rural Address of Well Location; if unknown, distance & direction from nearest town or intersection: If at owner's address, check here

**Global Positioning Systems (GPS) information:**  
 Latitude: 37.75031 (in decimal degrees)  
 Longitude: -95.94819 (in decimal degrees)  
 Elevation: 974.17  
 Horizontal Datum:  WGS84,  NAD83,  NAD27  
 Collection Method:

**2 WATER WELL OWNER:** EL DORADO CORR. FACILIT  
 RR#, St. Address, Box #: 172 HWY 105  
 City, State ZIP Code: TORONTO, KS 66777

GPS unit (Make/Model: \_\_\_\_\_)  
 Digital Map/Photo,  Topographic Map,  Land Survey  
 Est. Accuracy:  < 3 m,  3-5 m,  5-15 m,  > 15 m

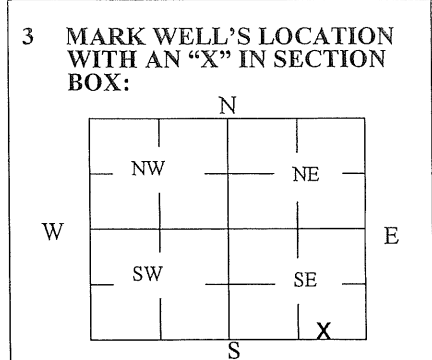

**4 DEPTH OF WELL** 43.15 ft.  
 WELL'S STATIC WATER LEVEL 19.68 ft  
 WELL WAS USED AS:

<input type="checkbox"/> Domestic	<input type="checkbox"/> Public Water Supply	<input type="checkbox"/> Dewatering
<input type="checkbox"/> Irrigation	<input type="checkbox"/> Oil Field Water Supply	<input checked="" type="checkbox"/> Monitoring
<input type="checkbox"/> Feedlot	<input type="checkbox"/> Domestic (Lawn & Garden)	<input type="checkbox"/> Injection Well
<input type="checkbox"/> Industrial	<input type="checkbox"/> Air Conditioning	<input type="checkbox"/> Other _____

Was a chemical/bacteriological sample submitted to Department? Yes  No

**5 TYPE OF BLANK CASING USED:**

Steel  RMP (SR)  Wrought  Fiberglass  Other (Specify below) \_\_\_\_\_  
 PVC  ABS  Asbestos-Cement  Concrete Tile \_\_\_\_\_

Blank casing diameter 2 in. Was casing pulled? Yes  No  If yes, how much 3'  
 Casing height above or below land surface 36 in.

**6 GROUT PLUG MATERIAL:**  Neat cement  Cement grout  Bentonite  Other TOPSOIL-0.5

Grout Plug Intervals: From 0.5 ft. to 43.15 ft., From \_\_\_\_\_ ft. to \_\_\_\_\_ ft., From \_\_\_\_\_ ft. to \_\_\_\_\_ ft.

What is the nearest source of possible contamination:

<input type="checkbox"/> Septic tank	<input type="checkbox"/> Seepage pit	<input checked="" type="checkbox"/> Fuel storage	<input type="checkbox"/> Other (specify below) _____
<input type="checkbox"/> Sewer lines	<input type="checkbox"/> Pit privy	<input type="checkbox"/> Fertilizer storage	
<input type="checkbox"/> Watertight sewer lines	<input type="checkbox"/> Sewage lagoon	<input type="checkbox"/> Insecticide storage	
<input type="checkbox"/> Lateral lines	<input type="checkbox"/> Feedyard	<input type="checkbox"/> Abandoned water well	Direction from well? _____
<input type="checkbox"/> Cess pool	<input type="checkbox"/> Livestock pens	<input type="checkbox"/> Oil well/Gas well	How many feet? _____

FROM	TO	PLUGGING MATERIALS	FROM	TO	PLUGGING MATERIALS
0	0.5	TOPSOIL			
0.5	43.15	BENTONITE			

**7 CONTRACTOR'S OR LANDOWNER'S CERTIFICATION:** This water well was plugged under my jurisdiction and was completed on (mo/day/year) 3/13/23 and this record is true to the best of my knowledge and belief. Kansas Water Well Contractor's License No. 585. This Water Well Record was completed on (mo/day/year) 3/29/23 under the business name of ASSOCIATED ENVIRONMENTAL INC. by (signature) \_\_\_\_\_

Send one white copy to Kansas Department of Health & Environment, Geology Section, 1000 SW Jackson Street, Ste. 420, Topeka, KS 66612-1367. Send one copy to WATER WELL OWNER and retain one for your records.  
 Visit us at <http://www.kdheks.gov/waterwell/index.html> Telephone 785-296-5524.

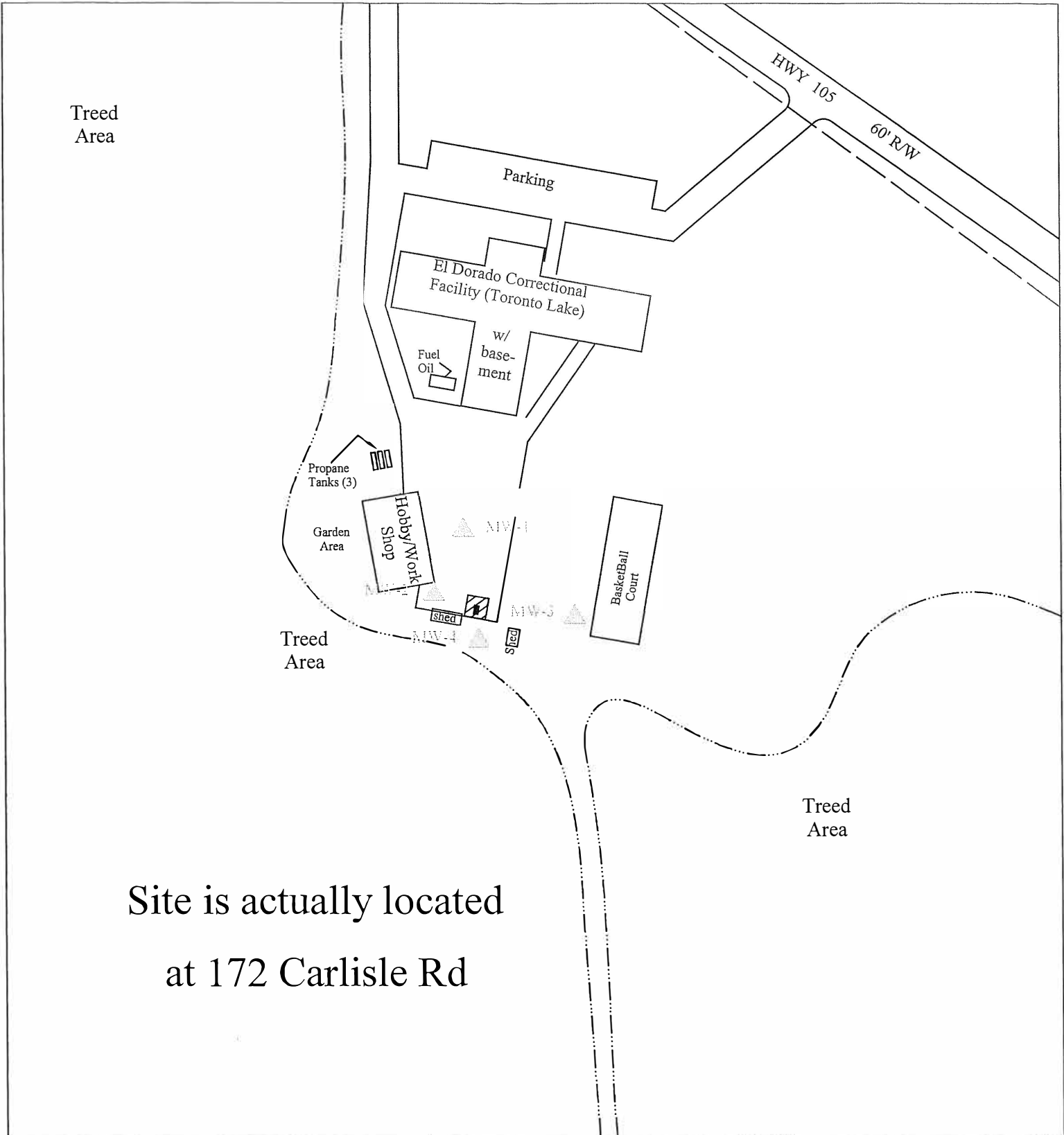

Site is actually located  
at 172 Carlisle Rd

**PROJECT:** El Dorado Correctional Facility

**ADDRESS:** 172 HWY 105

**LOCATION:** Toronto, Kansas

**DRAWN BY:** MD **DATE:** 03/16/04

**REVISED BY:** B. STALNAKER **DATE:** 3/29/23

**AEI JOB #:** TF360 **KDHE JOB #:** U3-104-13290

**SCALE:** 1" = 100'  
0 50 100

**NOTES:** Sample Date: 5/4/21  
The former pump island and product line locations are unknown

**TITLE:**

**ASSOCIATED ENVIRONMENTAL INC.**

**LEGEND:**

- = Former UST basin; 2-500 gallon gasoline USTs
- = Current 500 gal gas AST
- = Boundary of treed area
- = Monitor Well location
- = Site Boundary

