

# WATER WELL PLUGGING RECORD Form WWC-5P KSA 82a-1212 ID NO. 1 of 2

<b>1 LOCATION OF WATER WELL:</b> County: <b>SEDGWICK</b>	Fraction SW ¼ SE ¼ NW ¼ ¼	Section Number <b>10</b>	Township Number T <b>26</b> S	Range Number <b>2</b> <input checked="" type="checkbox"/> E <input type="checkbox"/> W
---	------------------------------	-----------------------------	----------------------------------	---

Street/Rural Address of Well Location; if unknown, distance & direction from nearest town or intersection: If at owner's address, check here

**DRILLED 2@310'**

**2 WATER WELL OWNER: JOY DARRAH**  
RR#, St. Address, Box #: **6620 N. GREENWICH**  
City, State ZIP Code: **WICHITA, KS 67226**

**Global Positioning Systems (GPS) information:**  
Latitude: 37.804166 (in decimal degrees)  
Longitude: -97.201337 (in decimal degrees)  
Elevation: \_\_\_\_\_  
Datum:  WGS84,  NAD83,  NAD27  
Collection Method:  
 GPS unit (Make/Model: MAGELLEN)  
 Digital Map/Photo,  Topographic Map,  Land Survey  
Est. Accuracy:  < 3 m,  3-5 m,  5-15 m,  > 15 m

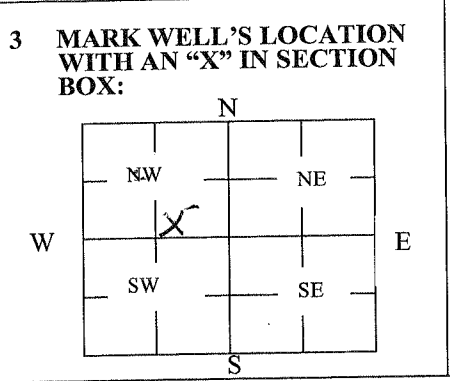

**4 DEPTH OF WELL** 310 ft.  
WELL'S STATIC WATER LEVEL N/A ft.  
WELL WAS USED AS:  
 Domestic       Public Water Supply       Dewatering  
 Irrigation       Oil Field Water Supply       Monitoring  
 Feedlot       Domestic (Lawn & Garden)       Injection Well  
 Industrial       Air Conditioning       Other Geothermal

Was a chemical/bacteriological sample submitted to Department? Yes  No

**5 TYPE OF BLANK CASING USED:**

Steel       RMP (SR)       Wrought       Fiberglass       Other (Specify below)  
 PVC       ABS       Asbestos-Cement       Concrete Tile      N/A

Blank casing diameter \_\_\_\_\_ in. Was casing pulled? Yes  No  If yes, how much \_\_\_\_\_  
 Casing height above or below land surface \_\_\_\_\_ in.

**6 GROUT PLUG MATERIAL:**  Neat cement       Cement grout       Bentonite       Other \_\_\_\_\_

Grout Plug Intervals: From 0 ft. to 310 ft., From \_\_\_\_\_ ft. to \_\_\_\_\_ ft., From \_\_\_\_\_ to \_\_\_\_\_ ft.

What is the nearest source of possible contamination:  
 Septic tank       Seepage pit       Fuel Storage       Other (specify below)  
 Sewer lines       Pit privy       Fertilizer storage      HOUSE  
 Watertight sewer lines       Sewage lagoon       Insecticide storage  
 Lateral lines       Feedyard       Abandoned water well      Direction from well? SOUTH  
 Cess pool       Livestock pens       Oil well/Gas well      How many feet? 90

FROM	TO	PLUGGING MATERIALS	FROM	TO	PLUGGING MATERIALS
0	10	BROWN CLAY	10	40	YELLOW CLAY
40	58	GRAY SHALE	58	70	BLUE SHALE
70	95	WHITE ROCK	95	115	LIMESTONE
115	190	GRAY CLAY	190	210	GRAY SHALE
210	225	GRAY CLAY	225	235	WHITE ROCK
235	265	BROWN CLAY	265	280	RED SHALE
280	290	BLACK ROCK	290	300	RED SHALE

**7 CONTRACTOR'S OR LANDOWNER'S CERTIFICATION:** This water well was plugged under my jurisdiction and was completed on (mo/day/year) 2/03/12 and this record is true to the best of my knowledge and belief. Kansas Water Well Contractor's License No. 812. This Water Well Record was completed on (mo/day/year) 3/07/12 under the business name of Environmental Loop Service, Inc by (signature) Richard Moore

**INSTRUCTIONS:** Use typewriter or ballpoint pen. Please press firmly and print clearly. Please fill in blanks, underline or circle the correct answers. Send top three copies to Kansas Department of Health and Environment, Bureau of Water, Geology Section, 1000 SW Jackson St., Ste. 420, Topeka, Kansas 66612-1367. Telephone: 785/296-5524. Send one to Water Well Owner and retain one for your records. Visit us at <http://www.kdheks.gov/waterwell/index.html>.

Check one:  White Copy       Blue Copy       Pink Copy

# WATER WELL PLUGGING RECORD Form WWC-5P

dot  
KSA 82a-1212 ID NO.

<b>1 LOCATION OF WATER WELL:</b> County: <b>SEDGWICK</b>	Fraction SW 1/4 SE 1/4 NW 1/4 1/4	Section Number <b>10</b>	Township Number T <b>26 S</b>	Range Number <b>2</b> <input checked="" type="checkbox"/> E <input type="checkbox"/> W
---	--------------------------------------	-----------------------------	----------------------------------	---

Street/Rural Address of Well Location; if unknown, distance & direction from nearest town or intersection: If at owner's address, check here

**Global Positioning Systems (GPS) information:**

Latitude: 37.804166 (in decimal degrees)  
 Longitude: -97.201337 (in decimal degrees)  
 Elevation: \_\_\_\_\_  
 Datum:  WGS84,  NAD83,  NAD27  
 Collection Method:  
 GPS unit (Make/Model: MAGELLEN)  
 Digital Map/Photo,  Topographic Map,  Land Survey  
 Est. Accuracy:  < 3 m,  3-5 m,  5-15 m,  > 15 m

**DRILLED 2@310'**

**2 WATER WELL OWNER:** **JOY DARRAH**  
 RR#, St. Address, Box #: **6620 N. GREENWICH**  
 City, State ZIP Code: **WICHITA, KS 67226**

**3 MARK WELL'S LOCATION WITH AN "X" IN SECTION BOX:**

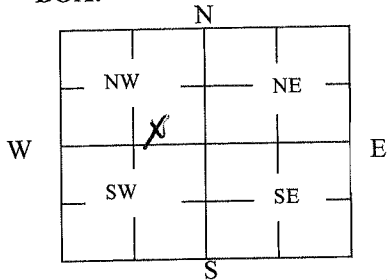

**4 DEPTH OF WELL** 310 ft.

WELL'S STATIC WATER LEVEL N/A ft

WELL WAS USED AS:

- |                                     |   |   |
|-------------------------------------|---|---|
| <input type="checkbox"/> Domestic   | <input type="checkbox"/> Public Water Supply      | <input type="checkbox"/> Dewatering                         |
| <input type="checkbox"/> Irrigation | <input type="checkbox"/> Oil Field Water Supply   | <input type="checkbox"/> Monitoring                         |
| <input type="checkbox"/> Feedlot    | <input type="checkbox"/> Domestic (Lawn & Garden) | <input type="checkbox"/> Injection Well                     |
| <input type="checkbox"/> Industrial | <input type="checkbox"/> Air Conditioning         | <input checked="" type="checkbox"/> Other <u>Geothermal</u> |

Was a chemical/bacteriological sample submitted to Department? Yes  No

**5 TYPE OF BLANK CASING USED:**

- |                                |                                   |  |  |   |
|--------------------------------|-----------------------------------|--|--|---|
| <input type="checkbox"/> Steel | <input type="checkbox"/> RMP (SR) | <input type="checkbox"/> Wrought         | <input type="checkbox"/> Fiberglass    | <input checked="" type="checkbox"/> Other (Specify below) |
| <input type="checkbox"/> PVC   | <input type="checkbox"/> ABS      | <input type="checkbox"/> Asbestos-Cement | <input type="checkbox"/> Concrete Tile | <u>N/A</u>  |

Blank casing diameter \_\_\_\_\_ in. Was casing pulled? Yes  No  If yes, how much \_\_\_\_\_ in.  
 Casing height above or below land surface \_\_\_\_\_ in.

**6 GROUT PLUG MATERIAL:**

- Neat cement  Cement grout  Bentonite  Other \_\_\_\_\_
- Grout Plug Intervals: From 0 ft. to 310 ft., From \_\_\_\_\_ ft. to \_\_\_\_\_ ft., From \_\_\_\_\_ to \_\_\_\_\_ ft.

What is the nearest source of possible contamination:

- |   |   |   |   |
|---|---|---|---|
| <input type="checkbox"/> Septic tank            | <input type="checkbox"/> Seepage pit    | <input type="checkbox"/> Fuel Storage         | <input checked="" type="checkbox"/> Other (specify below) |
| <input type="checkbox"/> Sewer lines            | <input type="checkbox"/> Pit privy      | <input type="checkbox"/> Fertilizer storage   | <u>HOUSE</u>  |
| <input type="checkbox"/> Watertight sewer lines | <input type="checkbox"/> Sewage lagoon  | <input type="checkbox"/> Insecticide storage  |   |
| <input type="checkbox"/> Lateral lines          | <input type="checkbox"/> Feedyard       | <input type="checkbox"/> Abandoned water well | Direction from well? <u>SOUTH</u>                         |
| <input type="checkbox"/> Cess pool              | <input type="checkbox"/> Livestock pens | <input type="checkbox"/> Oil well/Gas well    | How many feet? <u>90</u>                                  |

FROM	TO	PLUGGING MATERIALS	FROM	TO	PLUGGING MATERIALS
300	310	GRAY CLAY			

**7 CONTRACTOR'S OR LANDOWNER'S CERTIFICATION:** This water well was plugged under my jurisdiction and was completed on (mo/day/year) 02/03/2012 and this record is true to the best of my knowledge and belief. Kansas Water Well Contractor's License No. 812. This Water Well Record was completed on (mo/day/year) 13/07/12 under the business name of Environmental Loop Service, Inc by (signature) Richard Moore

**INSTRUCTIONS:** Use typewriter or ballpoint pen. Please press firmly and print clearly. Please fill in blanks, underline or circle the correct answers. Send top three copies to Kansas Department of Health and Environment, Bureau of Water, Geology Section, 1000 SW Jackson St., Ste. 420, Topeka, Kansas 66612-1367. Telephone: 785/296-5524. Send one to Water Well Owner and retain one for your records. Visit us at <http://www.kdheks.gov/waterwell/index.html>.

Check one:  White Copy  Blue Copy  Pink Copy