

WATER WELL RECORD Form WWC-5

Original Record Correction Change in Well Use

Division of Water Resources App. No.

[]

Well ID

RW 37

1 LOCATION OF WATER WELL: County: Butler Fraction NW 1/4 NW 1/4 NW 1/4 NE 1/4 Section Number 5 Township Number T 26 S Range Number R 3 [X] E [] W

2 WELL OWNER: Last Name: First: Business: El Paso Merchant Energy-Petroleum Co. Address: 2 N. Nevada Ave City: Colorado Springs State: CO ZIP: 80903 Street or Rural Address where well is located: 15485 Northwest Parallel Road, Benton, KS 67017

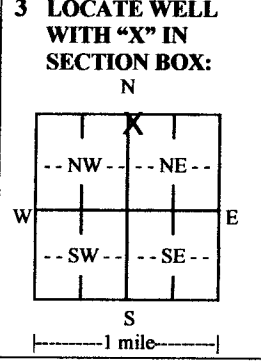

4 DEPTH OF COMPLETED WELL: 27 ft. Depth(s) Groundwater Encountered: 1) 9.17 ft. 2) ... ft. 3) ... ft. or 4) [] Dry Well WELL'S STATIC WATER LEVEL: 8.81 ft. [X] below land surface, measured on (mo-day-yr) 10/22/2015 [] above land surface, measured on (mo-day-yr) Pump test data: Well water was ... ft. after ... hours pumping ... gpm Well water was ... ft. after ... hours pumping ... gpm Estimated Yield: 0 gpm Bore Hole Diameter: 10 in. to 27 ft. and ... in. to ... ft.

5 Latitude: 37.825061 (decimal degrees) Longitude: 97.126325 (decimal degrees) Datum: [X] WGS 84 [] NAD 83 [] NAD 27 Source for Latitude/Longitude: [] GPS (unit make/model: ...) (WAAS enabled? [] Yes [] No) [] Land Survey [] Topographic Map [] Online Mapper: ... 6 Elevation: 1307 ft. [X] Ground Level [] TOC Source: [] Land Survey [] GPS [] Topographic Map [X] Other KOLAR

7 WELL WATER TO BE USED AS: 1. Domestic: [] Household [] Lawn & Garden [] Livestock 2. [] Irrigation 3. [] Feedlot 4. [] Industrial 5. [] Public Water Supply: well ID ... 6. [] Dewatering: how many wells? ... 7. [] Aquifer Recharge: well ID ... 8. [] Monitoring: well ID ... 9. Environmental Remediation: well ID RW.37 [] Air Sparge [] Soil Vapor Extraction [X] Recovery [] Injection 10. [] Oil Field Water Supply: lease ... 11. Test Hole: well ID ... [] Cased [] Uncased [] Geotechnical 12. Geothermal: how many bores? ... a) Closed Loop [] Horizontal [] Vertical b) Open Loop [] Surface Discharge [] Inj. of Water 13. [] Other (specify): ...

Was a chemical/bacteriological sample submitted to KDHE? [] Yes [X] No If yes, date sample was submitted: ... Water well disinfected? [] Yes [X] No

8 TYPE OF CASING USED: [] Steel [X] PVC [] Other CASING JOINTS: [] Glued [] Clamped [] Welded [X] Threaded Casing diameter 6 in. to 16 ft., Diameter 6 in. to 26.5 ft., Diameter ... in. to ... ft. Casing height above land surface 0 in. Weight ... lbs./ft. Wall thickness or gauge No. SCH40 TYPE OF SCREEN OR PERFORATION MATERIAL: [] Steel [] Stainless Steel [] Fiberglass [X] PVC [] Brass [] Galvanized Steel [] Concrete tile [] None used (open hole) [] Other (Specify) ... SCREEN OR PERFORATION OPENINGS ARE: [] Continuous Slot [X] Mill Slot [] Gauze Wrapped [] Torch Cut [] Drilled Holes [] Other (Specify) ... [] Louvered Shutter [] Key Punched [] Wire Wrapped [] Saw Cut [] None (Open Hole) SCREEN-PERFORATED INTERVALS: From 16 ft. to 21 ft., From ... ft. to ... ft., From ... ft. to ... ft. GRAVEL PACK INTERVALS: From 20 ft. to 21 ft., From ... ft. to ... ft., From ... ft. to ... ft.

9 GROUT MATERIAL: [] Neat cement [] Cement grout [X] Bentonite [] Other GROUT INTERVALS: From 22 ft. to 27 ft., From ... ft. to ... ft., From ... ft. to ... ft. Nearest source of possible contamination: [] Septic Tank [] Lateral Lines [] Pit Privy [] Livestock Pens [] Insecticide Storage [] Sewer Lines [] Cess Pool [] Sewage Lagoon [] Fuel Storage [] Abandoned Water Well [] Watertight Sewer Lines [] Seepage Pit [] Feedyard [] Fertilizer Storage [] Oil Well/Gas Well [] Other (Specify) ... Direction from well? ... Distance from well? ... ft.

10 FROM	TO	LITHOLOGIC LOG	FROM	TO	LITHO. LOG (cont.) or PLUGGING INTERVALS
0	20	Conductor Casing			
20	27	Shale			

Notes: Flush mount completion in below ground vault approved by KDHE - Pamela Chaffee, 12-07-15

11 CONTRACTOR'S OR LANDOWNER'S CERTIFICATION: This water well was [X] constructed, [] reconstructed, or [] plugged under my jurisdiction and was completed on (mo-day-year) 10/6/2015 and this record is true to the best of my knowledge and belief. Kansas Water Well Contractor's License No. 551 This Water Well Record was completed on (mo-day-year) 10/21/2015 under the business name of Associated Environmental Industries, Corp.

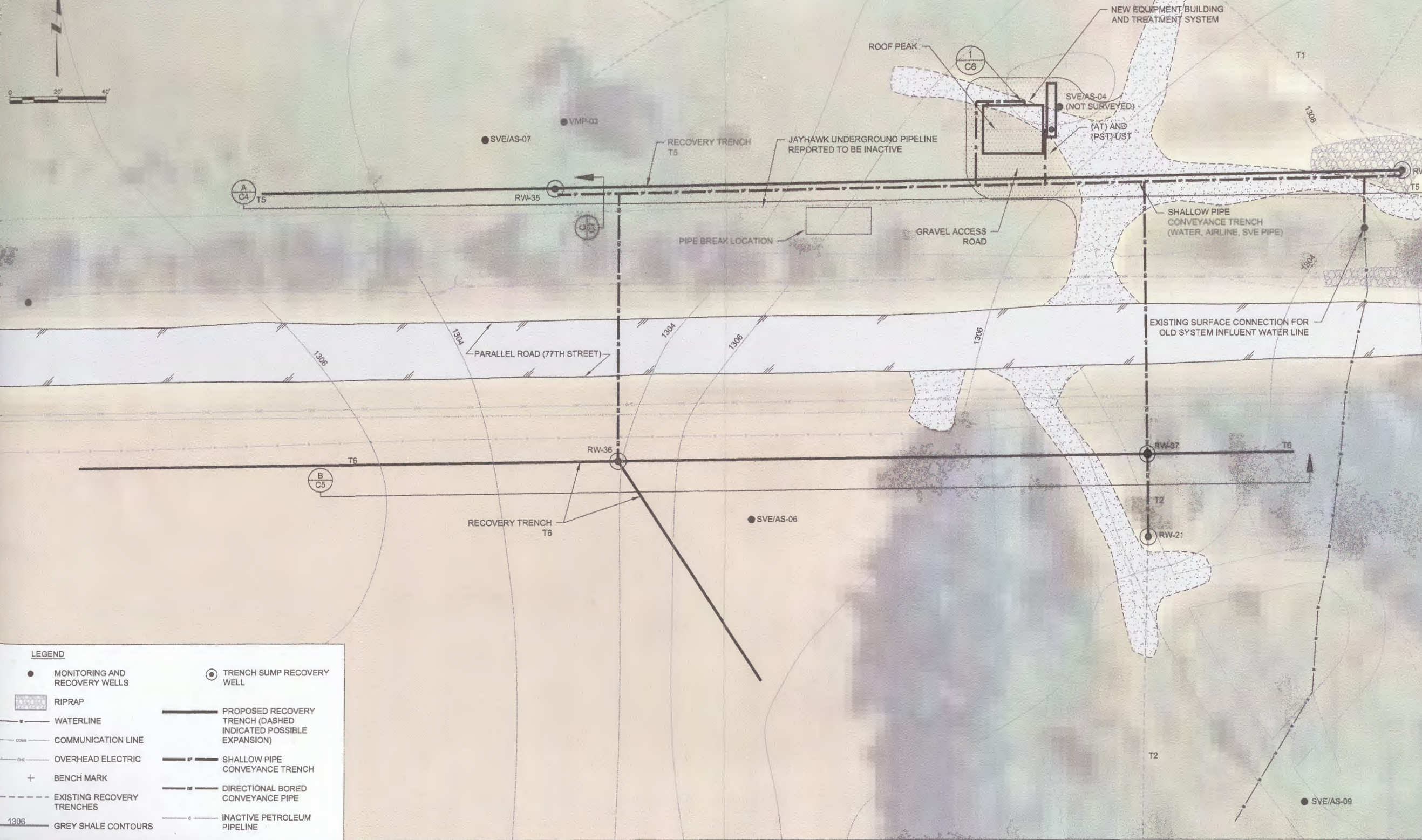

LEGEND	
●	MONITORING AND RECOVERY WELLS
○	TRENCH SUMP RECOVERY WELL
▨	RIPRAP
—	WATERLINE
—	COMMUNICATION LINE
—	OVERHEAD ELECTRIC
+	BENCH MARK
- - -	EXISTING RECOVERY TRENCHES
1306	GREY SHALE CONTOURS
- - -	PROPOSED RECOVERY TRENCH (DASHED INDICATED POSSIBLE EXPANSION)
—	SHALLOW PIPE CONVEYANCE TRENCH
—	DIRECTIONAL BORED CONVEYANCE PIPE
—	INACTIVE PETROLEUM PIPELINE