

# WATER WELL RECORD Form WWC-5

Division of Water  
Resources App. No.

RW 36

☒ Original Record ☐ Correction ☐ Change in Well Use

Well ID

<b>1 LOCATION OF WATER WELL:</b> County: <b>Butler</b>	Fraction NE ¼ NE ¼ NE ¼ NW ¼	Section Number <b>5</b>	Township Number <b>T 26 S</b>	Range Number <b>R 3 E W</b>
---	---------------------------------	----------------------------	----------------------------------	--------------------------------

<b>2 WELL OWNER:</b> Last Name: <b>El Paso Merchant Energy-Petroleum Co.</b> Business: <b>2 N. Nevada Ave</b> Address: City: <b>Colorado Springs</b> State: <b>CO</b> ZIP: <b>80903</b>	Street or Rural Address where well is located (if unknown, distance and direction from nearest town or intersection): If at owner's address, check here: <input type="checkbox"/> <b>15535 Northwest Parallel Road, Benton, KS 67017</b>
--	---

<b>3 LOCATE WELL WITH "X" IN SECTION BOX:</b> N W E S 1 mile	<b>4 DEPTH OF COMPLETED WELL:</b> ..... <b>33</b> ..... ft. Depth(s) Groundwater Encountered: 1) ..... <b>14</b> ..... ft. 2) ..... ft. 3) ..... ft., or 4) <input type="checkbox"/> Dry Well WELL'S STATIC WATER LEVEL: ..... <b>12.63</b> ..... ft. <input checked="" type="checkbox"/> below land surface, measured on (mo-day-yr) <b>10/22/2015</b> <input type="checkbox"/> above land surface, measured on (mo-day-yr) ..... Pump test data: Well water was ..... ft. after ..... hours pumping ..... gpm Well water was ..... ft. after ..... hours pumping ..... gpm Estimated Yield: ..... <b>0</b> ..... gpm Bore Hole Diameter: ..... <b>10</b> ..... in. to ..... <b>33</b> ..... ft. and ..... in. to ..... ft.	<b>5 Latitude:</b> ..... <b>37.825033</b> ..... (decimal degrees) <b>Longitude:</b> ..... <b>97.127067</b> ..... (decimal degrees) Datum: <input checked="" type="checkbox"/> WGS 84 <input type="checkbox"/> NAD 83 <input type="checkbox"/> NAD 27 Source for Latitude/Longitude: <input type="checkbox"/> GPS (unit make/model: .....) (WAAS enabled? <input type="checkbox"/> Yes <input type="checkbox"/> No) <input type="checkbox"/> Land Survey <input type="checkbox"/> Topographic Map <input type="checkbox"/> Online Mapper: .....
<b>6 Elevation:</b> <b>1316</b> ..... ft. <input checked="" type="checkbox"/> Ground Level <input type="checkbox"/> TOC Source: <input type="checkbox"/> Land Survey <input type="checkbox"/> GPS <input type="checkbox"/> Topographic Map <input checked="" type="checkbox"/> Other <b>KOLAR</b>		

**7 WELL WATER TO BE USED AS:**

1. Domestic: <input type="checkbox"/> Household <input type="checkbox"/> Lawn & Garden <input type="checkbox"/> Livestock	2. Irrigation	3. Feedlot	4. Industrial	5. <input type="checkbox"/> Public Water Supply: well ID .....	6. <input type="checkbox"/> Dewatering: how many wells? .....	7. <input type="checkbox"/> Aquifer Recharge: well ID .....	8. <input type="checkbox"/> Monitoring: well ID .....	9. Environmental Remediation: well ID <b>RW 36</b> <input type="checkbox"/> Air Sparge <input type="checkbox"/> Soil Vapor Extraction <input checked="" type="checkbox"/> Recovery <input type="checkbox"/> Injection	10. <input type="checkbox"/> Oil Field Water Supply: lease .....	11. Test Hole: well ID ..... <input type="checkbox"/> Cased <input type="checkbox"/> Uncased <input type="checkbox"/> Geotechnical	12. Geothermal: how many bores? ..... a) Closed Loop <input type="checkbox"/> Horizontal <input type="checkbox"/> Vertical b) Open Loop <input type="checkbox"/> Surface Discharge <input type="checkbox"/> Inj. of Water	13. <input type="checkbox"/> Other (specify): .....
--	---------------	------------	---------------	--	---	---	---	---	--	---	---	---

Was a chemical/bacteriological sample submitted to KDHE? ☐ Yes ☒ No If yes, date sample was submitted: .....

Water well disinfected? ☐ Yes ☒ No

**8 TYPE OF CASING USED:** ☐ Steel ☒ PVC ☐ Other ..... CASING JOINTS: ☐ Glued ☐ Clamped ☐ Welded ☒ Threaded  
Casing diameter ..... **6** ..... in. to ..... **17** ..... ft., Diameter ..... **22** ..... in. to ..... **30.7** ..... ft., Diameter ..... in. to ..... ft.  
Casing height above land surface ..... **0** ..... in. Weight ..... lbs./ft. Wall thickness or gauge No. **SCH40**

**TYPE OF SCREEN OR PERFORATION MATERIAL:**  
☐ Steel ☐ Stainless Steel ☐ Fiberglass ☒ PVC ☐ Other (Specify) .....  
☐ Brass ☐ Galvanized Steel ☐ Concrete tile ☐ None used (open hole)

**SCREEN OR PERFORATION OPENINGS ARE:**  
☐ Continuous Slot ☒ Mill Slot ☐ Gauze Wrapped ☐ Torch Cut ☐ Drilled Holes ☐ Other (Specify) .....  
☐ Louvered Shutter ☐ Key Punched ☐ Wire Wrapped ☐ Saw Cut ☐ None (Open Hole)

**SCREEN-PERFORATED INTERVALS:** From ..... **17** ..... ft. to ..... **22** ..... ft., From ..... ft. to ..... ft., From ..... ft. to ..... ft.  
**GRAVEL PACK INTERVALS:** From ..... **21** ..... ft. to ..... **22** ..... ft., From ..... ft. to ..... ft., From ..... ft. to ..... ft.

**9 GROUT MATERIAL:** ☐ Neat cement ☐ Cement grout ☒ Bentonite ☐ Other .....  
Grout Intervals: From ..... **23** ..... ft. to ..... **33** ..... ft., From ..... ft. to ..... ft., From ..... ft. to ..... ft.

**Nearest source of possible contamination:**  
☐ Septic Tank ☐ Lateral Lines ☐ Pit Privy ☐ Livestock Pens ☐ Insecticide Storage  
☐ Sewer Lines ☐ Cess Pool ☐ Sewage Lagoon ☐ Fuel Storage ☐ Abandoned Water Well  
☐ Watertight Sewer Lines ☐ Seepage Pit ☐ Feedyard ☐ Fertilizer Storage ☐ Oil Well/Gas Well  
☐ Other (Specify) .....

Direction from well? ..... Distance from well? ..... ft.

10 FROM	TO	LITHOLOGIC LOG	FROM	TO	LITHO. LOG (cont.) or PLUGGING INTERVALS
0	21	Conductor Casing			
21	33	Shale			

**Notes:**  
Flush mount completion in below ground vault approved by KDHE - Pamela Chafee, 12-07-15

**11 CONTRACTOR'S OR LANDOWNER'S CERTIFICATION:** This water well was ☒ constructed, ☐ reconstructed, or ☐ plugged under my jurisdiction and was completed on (mo-day-year) **10/9/2015** and this record is true to the best of my knowledge and belief. Kansas Water Well Contractor's License No. **551** This Water Well Record was completed on (mo-day-year) **10/21/2015** under the business name of **Associated Environmental Industries Corp.**



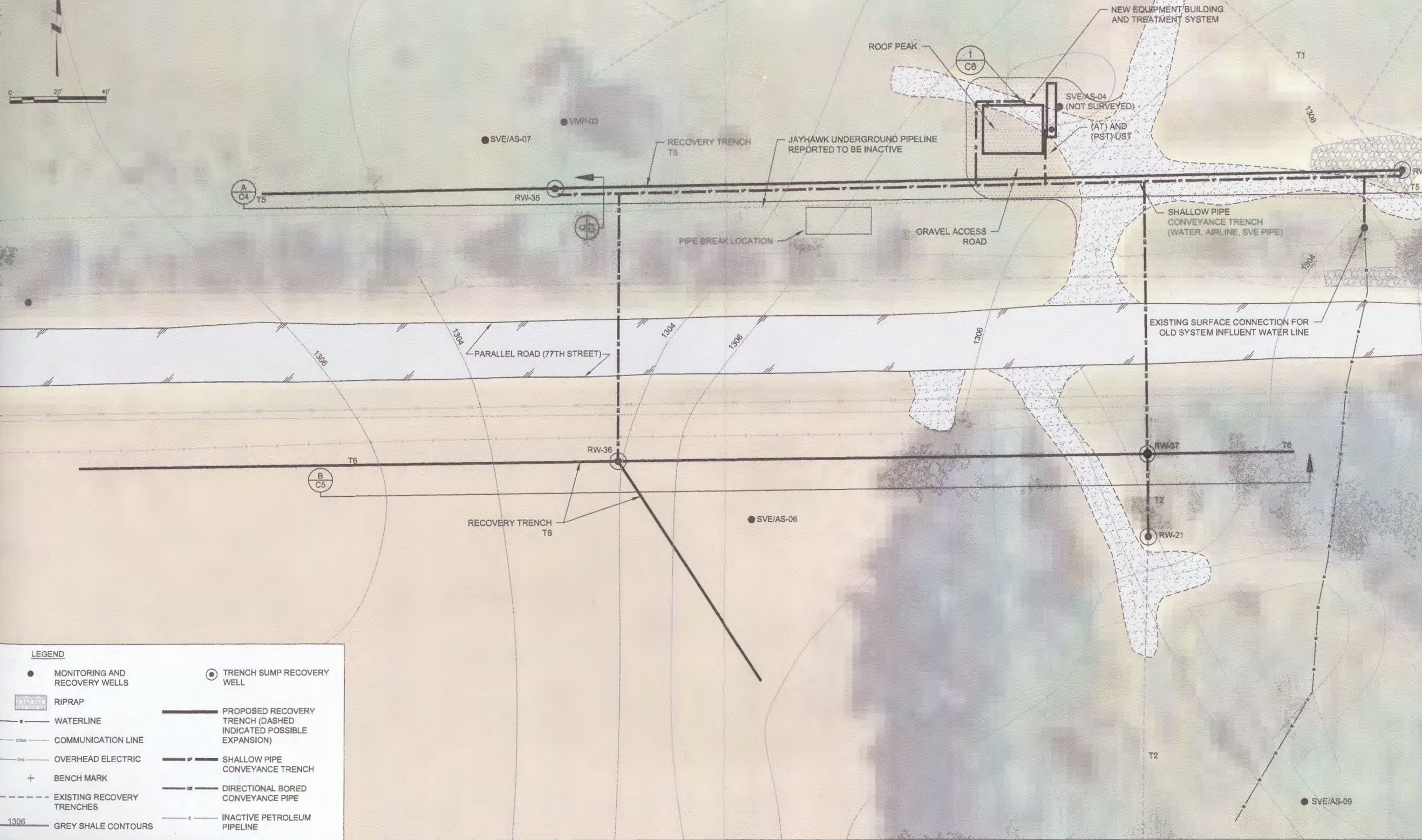

**LEGEND**

● MONITORING AND RECOVERY WELLS

▨ RIPRAP

— WATERLINE

— COMMUNICATION LINE

— OVERHEAD ELECTRIC

+ BENCH MARK

--- EXISTING RECOVERY TRENCHES

1306 GREY SHALE CONTOURS

● TRENCH SUMP RECOVERY WELL

--- PROPOSED RECOVERY TRENCH (DASHED INDICATED POSSIBLE EXPANSION)

--- SHALLOW PIPE CONVEYANCE TRENCH

--- DIRECTIONAL BORED CONVEYANCE PIPE

--- INACTIVE PETROLEUM PIPELINE