

MW13R

☒ Original Record ☐ Correction ☐ Change in Well Use

Well ID

[illegible]

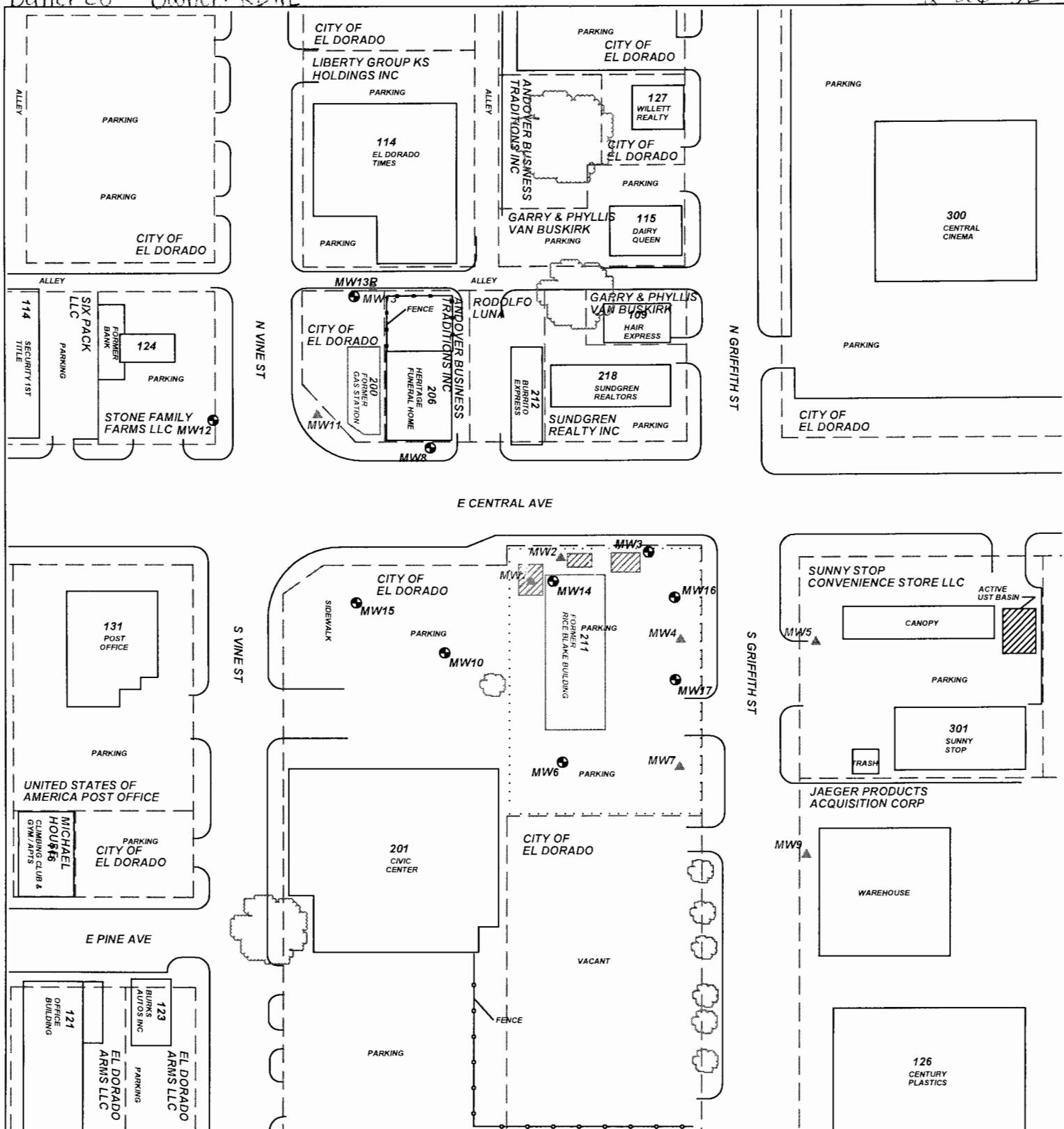

PROJECT: **RICE/BLAKE BUILDING**

ADDRESS: **211 E. CENTRAL**

LOCATION: **EL DORADO, KS**

DRAWN BY: **C. ROE** DATE: **5/8/18**

REVISED BY: **C. ROE** DATE: **6/15/18**

AEI JOB #: **TF272** KDHE JOB #: **U2-008-00187**

SCALE: **1" = 100'**

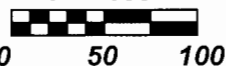

NOTES:
No basements observed within 500'.

TITLE:

**FIGURE 2.2
AREA BASE MAP
350' RADIUS**



**ASSOCIATED
ENVIRONMENTAL
INC.**

LEGEND:

- = FORMER UST LOCATIONS
- = MONITORING WELL
- = SUBJECT PROPERTY
- = PARCEL BOUNDARY

