

# WATER WELL RECORD Form WWC-5

Division of Water  
Resources App. No.

MW16

☒ Original Record ☐ Correction ☐ Change in Well Use

Well ID

## 1 LOCATION OF WATER WELL:

County: Butler

Fraction

NW ¼ NW ¼ NE ¼ SE ¼

Section Number

2

Township Number

T 26 S

Range Number

R 5 ☒ E ☐ W

## 2 WELL OWNER: Last Name:

First:

Street or Rural Address where well is located (if unknown, distance and direction from nearest town or intersection): If at owner's address, check here: ☐

Business: KDHE

Address: 1000 SW Jackson, Suite 410

Address:

211 E. Central

City: Topeka

State: KS

ZIP: 66612

El Dorado, KS 67042

## 3 LOCATE WELL WITH "X" IN SECTION BOX:

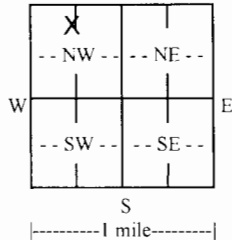

## 4 DEPTH OF COMPLETED WELL:

Depth(s) Groundwater Encountered: 1) 15 ft.

2) ft. 3) ft. or 4) ☐ Dry Well

WELL'S STATIC WATER LEVEL: 11.81 ft.

☒ below land surface, measured on (mo-day-yr) 12/12/18

☐ above land surface, measured on (mo-day-yr)

Pump test data: Well water was ft.

after hours pumping gpm

Well water was ft.

after hours pumping gpm

Estimated Yield: gpm

Bore Hole Diameter: 8.5 in. to 20 ft. and

in. to ft.

5 Latitude: 37.81717 (decimal degrees)

Longitude: 96.84728 (decimal degrees)

Horizontal Datum: ☒ WGS 84 ☐ NAD 83 ☐ NAD 27

Source for Latitude/Longitude:

☐ GPS (unit make/model: )

(WAAS enabled? ☐ Yes ☐ No)

☒ Land Survey ☐ Topographic Map

☐ Online Mapper:

6 Elevation: 1284.49 ft. ☐ Ground Level ☒ TOC

Source: ☒ Land Survey ☐ GPS ☐ Topographic Map

☐ Other

## 7 WELL WATER TO BE USED AS:

1. Domestic:

☐ Household

☐ Lawn & Garden

☐ Livestock

2. ☐ Irrigation

3. ☐ Feedlot

4. ☐ Industrial

5. ☐ Public Water Supply: well ID

6. ☐ Dewatering: how many wells?

7. ☐ Aquifer Recharge: well ID

8. ☒ Monitoring: well ID MW16

9. Environmental Remediation: well ID

☐ Air Sparge ☐ Soil Vapor Extraction

☐ Recovery ☐ Injection

10. ☐ Oil Field Water Supply: lease

11. Test Hole: well ID

☐ Cased ☐ Uncased ☐ Geotechnical

12. Geothermal: how many bores?

a) Closed Loop ☐ Horizontal ☐ Vertical

b) Open Loop ☐ Surface Discharge ☐ Inj. of Water

13. ☐ Other (specify):

Was a chemical/bacteriological sample submitted to KDHE? ☐ Yes ☒ No If yes, date sample was submitted:

Water well disinfected? ☐ Yes ☒ No

8 TYPE OF CASING USED: ☐ Steel ☒ PVC ☐ Other CASING JOINTS: ☐ Glued ☐ Clamped ☐ Welded ☒ Threaded

Casing diameter 2 in. to 20 ft. Diameter in. to ft. Diameter in. to ft.

Casing height above land surface in. Weight lbs./ft. Wall thickness or gauge No. 40

TYPE OF SCREEN OR PERFORATION MATERIAL:

☐ Steel ☐ Stainless Steel ☐ Fiberglass ☒ PVC

☐ Brass ☐ Galvanized Steel ☐ Concrete tile ☐ None used (open hole)

☐ Other (Specify)

SCREEN OR PERFORATION OPENINGS ARE:

☐ Continuous Slot ☒ Mill Slot ☐ Gauze Wrapped ☐ Torch Cut ☐ Drilled Holes ☐ Other (Specify)

☐ Louvered Shutter ☐ Key Punched ☐ Wire Wrapped ☐ Saw Cut ☐ None (Open Hole)

SCREEN-PERFORATED INTERVALS: From 10 ft. to 20 ft. From ft. to ft. From ft. to ft.

GRAVEL PACK INTERVALS: From 8 ft. to 20 ft. From ft. to ft. From ft. to ft.

## 9 GROUT MATERIAL:

☐ Neat cement ☐ Cement grout ☒ Bentonite ☐ Other

Grout Intervals: From 1 ft. to 8 ft. From ft. to ft. From ft. to ft.

Nearest source of possible contamination:

☐ Septic Tank ☐ Lateral Lines ☐ Pit Privy ☐ Livestock Pens ☐ Insecticide Storage

☐ Sewer Lines ☐ Cess Pool ☐ Sewage Lagoon ☒ Fuel Storage ☐ Abandoned Water Well

☐ Watertight Sewer Lines ☐ Seepage Pit ☐ Feedyard ☐ Fertilizer Storage ☐ Oil Well/Gas Well

☐ Other (Specify)

Direction from well? West Distance from well? 260 ft.

10 FROM TO LITHOLOGIC LOG FROM TO LITHO. LOG (cont.) or PLUGGING INTERVALS

0 0.5 Concrete

0.5 4 Silty Clay (CL). brown to grey brown

4 20 Silty Clay (CL). grey

Notes:

11 CONTRACTOR'S OR LANDOWNER'S CERTIFICATION: This water well was ☒ constructed, ☐ reconstructed, or ☐ plugged under my jurisdiction and was completed on (mo-day-year) 11/28/18 and this record is true to the best of my knowledge and belief.

Kansas Water Well Contractor's License No. 585 This Water Well Record was completed on (mo-day-year) 12/21/18

under the business name of Associated Environmental, Inc. Signature

Mail 1 white copy along with a fee of \$5.00 for each constructed well to: Kansas Department of Health and Environment, Bureau of Water, GWTS Section,

1000 SW Jackson St., Suite 420, Topeka, Kansas 66612-1367. Mail one to Water Well Owner and retain one for your records. Telephone 785-296-5524.

Visit us at <http://www.kdheks.gov/waterwell/index.html>

KSA 82a-1212

Revised 7/10/2015

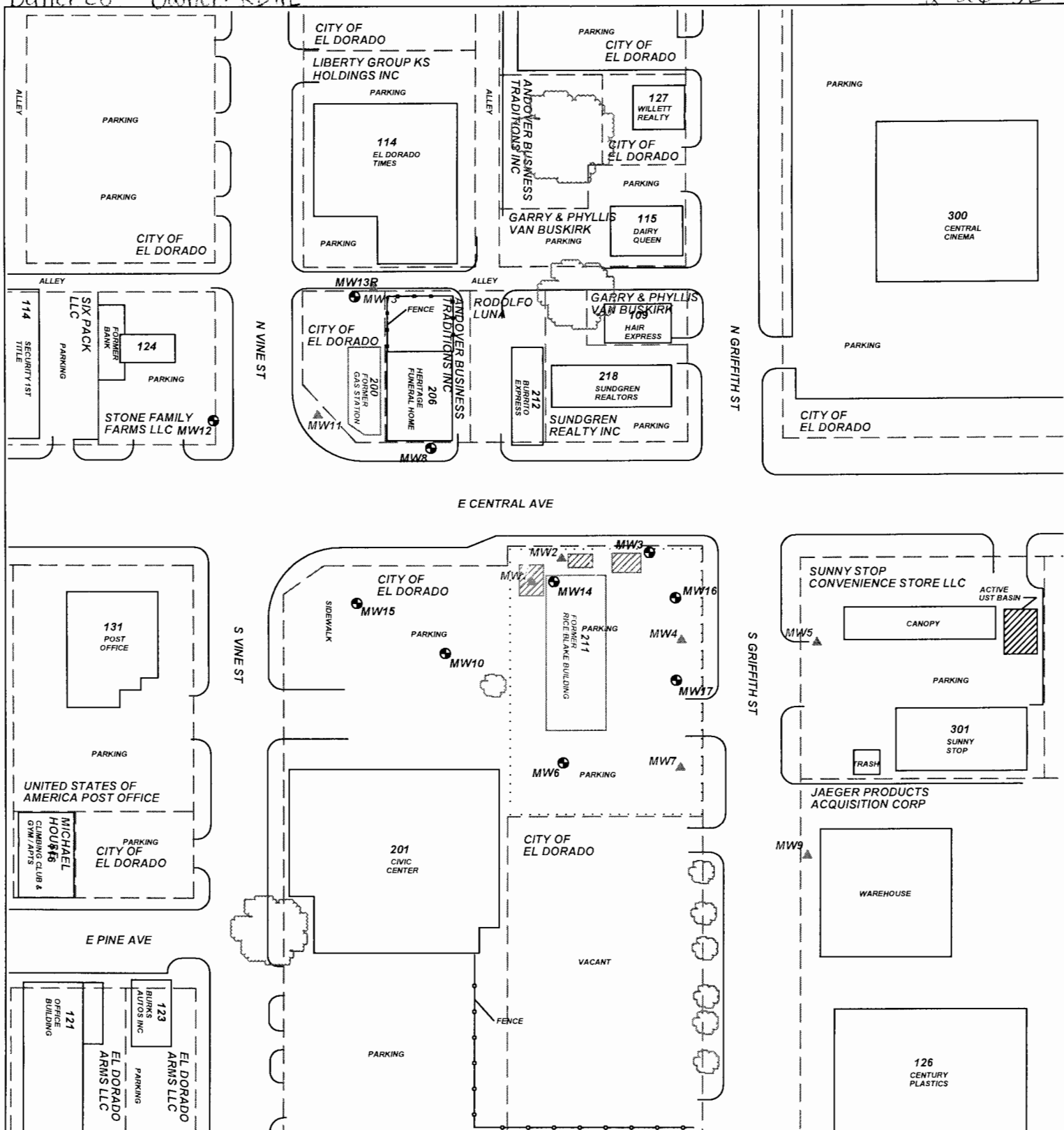

PROJECT: **RICE/BLAKE BUILDING**

ADDRESS: **211 E. CENTRAL**

LOCATION: **EL DORADO, KS**

DRAWN BY: **C. ROE** DATE: **5/8/18**

REVISED BY: **C. ROE** DATE: **6/15/18**

AEI JOB #: **TF272** KDHE JOB #: **U2-008-00187**

SCALE: **1" = 100'**

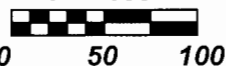

NOTES:  
No basements observed within 500'.

TITLE:

**FIGURE 2.2  
AREA BASE MAP  
350' RADIUS**



**ASSOCIATED  
ENVIRONMENTAL  
INC.**

LEGEND:

- = FORMER UST LOCATIONS
- = MONITORING WELL
- = SUBJECT PROPERTY
- = PARCEL BOUNDARY

