

WATER WELL RECORD

Form WWC-5

Division of Water Resources App. No. MW-19

1 LOCATION OF WATER WELL: County: Sedgewick	Fraction NW ¼ NW ¼ NW ¼ SW ¼	Section Number 24	Township No. T 27 S	Range Number R 1 <input checked="" type="checkbox"/> E <input type="checkbox"/> W
Street/Rural Address of Well Location; if unknown, distance & direction from nearest town or intersection: If at owner's address, check here <input type="checkbox"/> 4724 E. Douglas Ave.; Wichita, KS; see attached map		Global Positioning System (GPS) information: Latitude: .37... <u>686442</u> (in decimal degrees) Longitude: 97... <u>281680</u> (in decimal degrees) Elevation: 1350 Datum: <input type="checkbox"/> WGS 84, <input checked="" type="checkbox"/> NAD 83, <input type="checkbox"/> NAD 27 Collection Method: <input checked="" type="checkbox"/> GPS unit (Make/Model: <u>Garmin etrek 10</u>) <input type="checkbox"/> Digital Map/Photo, <input type="checkbox"/> Topographic Map, <input type="checkbox"/> Land Survey Est. Accuracy: <input type="checkbox"/> <3 m, <input checked="" type="checkbox"/> 3-5 m, <input type="checkbox"/> 5-15 m, <input type="checkbox"/> >15 m		
2 WATER WELL OWNER: <u>Conoco Phillips</u> RR#, Street Address, Box #: <u>1614-02 Phillips Bldg.</u> City, State, ZIP Code: <u>Bartlesville OK 74004</u>				

<p>3 LOCATE WELL WITH AN "X" IN SECTION BOX: N</p> <table border="1" style="width: 100%; text-align: center; border-collapse: collapse;"> <tr> <td style="width: 25%;">NW</td> <td style="width: 25%;">NE</td> </tr> <tr> <td style="width: 25%;">SW</td> <td style="width: 25%;">SE</td> </tr> </table> <p style="text-align: center;">S -----1 mile-----</p>	NW	NE	SW	SE	<p>4 DEPTH OF COMPLETED WELL <u>17</u> ft.</p> <p>Depth(s) Groundwater Encountered (1)..... ft. (2)..... ft. (3)..... ft.</p> <p>WELL'S STATIC WATER LEVEL..... ft. below land surface measured on mo/day/yr.....</p> <p>Pump test data: Well water was..... ft. after..... hours pumping..... gpm</p> <p>EST. YIELD..... gpm. Well water was..... ft. after..... hours pumping..... gpm</p> <p>Bore Hole Diameter <u>8.5</u>..... in. to <u>17</u>..... ft., and in. to ft.</p> <p>WELL WATER TO BE USED AS: <input type="checkbox"/> Public water supply <input type="checkbox"/> Geothermal <input type="checkbox"/> Injection well <input type="checkbox"/> Domestic <input type="checkbox"/> Feedlot <input type="checkbox"/> Oil field water supply <input type="checkbox"/> Dewatering <input type="checkbox"/> Other (Specify below) <input type="checkbox"/> Irrigation <input type="checkbox"/> Industrial <input type="checkbox"/> Domestic-lawn & garden <input checked="" type="checkbox"/> Monitoring well</p> <p>Was a chemical/bacteriological sample submitted to Department? <input type="checkbox"/> Yes <input checked="" type="checkbox"/> No</p> <p>If yes, mo/day/yr sample was submitted.....</p> <p>Water well disinfected? <input type="checkbox"/> Yes <input checked="" type="checkbox"/> No</p>
NW	NE				
SW	SE				

5 TYPE OF CASING USED: Steel PVC Other

CASING JOINTS: Glued Clamped Welded Threaded

Casing diameter 2..... in. to 5..... ft., Diameter in. to ft., Diameter in. to ft.

Casing height above land surface: 6..... in., Weight lbs./ft., Wall thickness or gauge No. Sch 40

TYPE OF SCREEN OR PERFORATION MATERIAL:
 Steel Stainless Steel PVC Other (Specify)
 Brass Galvanized Steel None used (open hole)

SCREEN OR PERFORATION OPENINGS ARE:
 Continuous slot Mill slot Gauze wrapped Torch cut Drilled holes None (open hole)
 Louvered shutter Key punched Wire wrapped Saw cut Other (specify)

SCREEN-PERFORATED INTERVALS: From 5..... ft. to 17..... ft., From ft. to ft.
 From ft. to ft., From ft. to ft.

GRAVEL PACK INTERVALS: From 4..... ft. to 17..... ft., From ft. to ft.
 From ft. to ft., From ft. to ft.

6 GROUT MATERIAL: Neat cement Cement grout Bentonite Other

Grout Intervals: From 2..... ft. to 4..... ft., From ft. to ft., From ft. to ft.

What is the nearest source of possible contamination:
 Septic tank Lateral lines Pit privy Livestock pens Insecticide storage Other (specify below)
 Sewer lines Cesspool Sewage lagoon Fuel storage Abandoned water well
 Watertight sewer lines Seepage pit Feedyard Fertilizer storage Oil well/gas well

Direction from well Distance from well

FROM	TO	LITHOLOGIC LOG	FROM	TO	LITHO. LOG (cont.) or PLUGGING INTERVALS
0	3	Silty clay			
3	14	Clay			
14	17	Sandy clay			

7 CONTRACTOR'S OR LANDOWNER'S CERTIFICATION: This water well was constructed, reconstructed, or plugged under my jurisdiction and was completed on (mo/day/year) 11/24/14 and this record is true to the best of my knowledge and belief. Kansas Water Well Contractor's License No. 710 This Water Well Record was completed on (mo/day/year) 12/5/14 under the business name of Below Ground Surface, Inc. by (signature) Michael T. Osage

INSTRUCTIONS: Use typewriter or ball point pen. PLEASE PRESS FIRMLY and PRINT clearly. Please fill in blanks and check the correct answers. Send one copy to Kansas Department of Health and Environment, Bureau of Water, Geology Section, 1000 SW Jackson St., Suite 420, Topeka, Kansas 66612-1367. Telephone 785-296-5524. Send one copy to WATER WELL OWNER and retain one for your records. Include fee of \$5.00 for each constructed well. Visit us at <http://www.kdheks.gov/waterwell/index.html>

Public Utility LOCATIONS

LEGEND

- PROPOSED DRILLING LOCATIONS
- MONITORING WELLS INSTALLED 2013
- MONITORING WELLS INSTALLED 2010
- GROUNDWATER FLOW DIRECTION
- - - SITE PROPERTY LINE
- - - PROPERTY LINE
- - - FENCE
- - - FORMER PRODUCT LINES
- - - FORMER FUELING SYSTEM COMPONENTS
- - - STORM SEWER LINE (LESS THAN 5' BGS)
- - - SANITARY SEWER LINE (LESS THAN 5' BGS)
- - - GAS LINE (LESS THAN 5' BGS)
- - - UNDERGROUND ELECTRIC LINE (LESS THAN 5' BGS)
- - - OVERHEAD UTILITY LINE (~ 15' HIGH)
- - - WATER LINE (LESS THAN 5' BGS)
- ◆ PROJECT BENCHMARK
ELEVATION = 1310.47

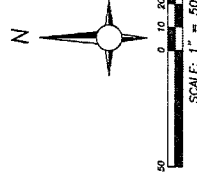

1.0



REVISION TO PROPOSED DRILL LOCATIONS

FORMER CONDO/PHILLIPS #4861
4724 EAST DOUGLAS AVENUE
WICHITA KANSAS

PROJECT NUMBER: 17.75000.4861	CLIENT: LIMITED SITE ASSESSMENT	DRAWN BY: JG 05/19/14
FILE PATH: 481-FLOW		DATE: 05/19/14

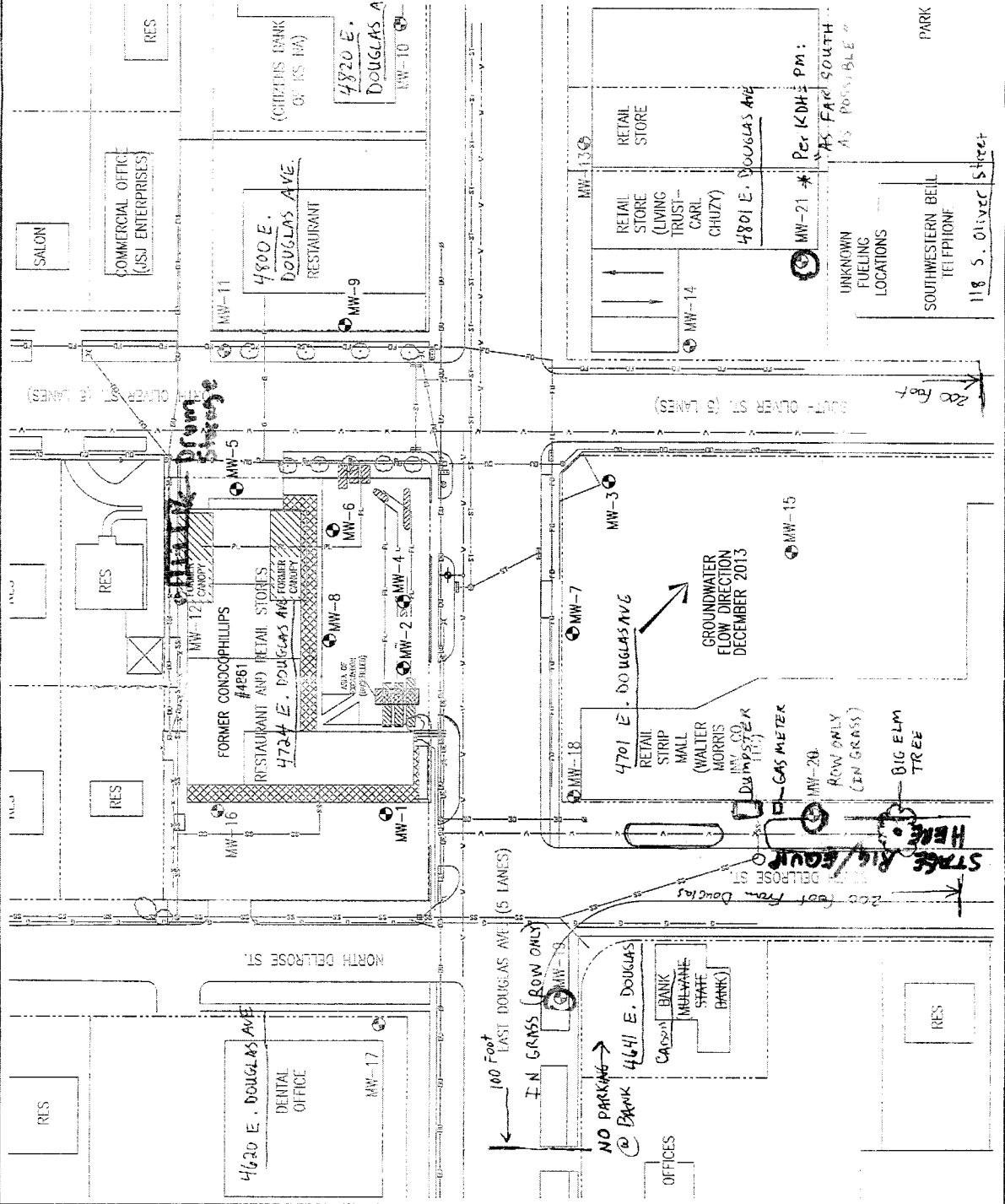

RES
SALON
COMMERCIAL OFFICE
(USJ ENTERPRISES)
RES

4800 E. DOUGLAS AVE. RESTAURANT
MHW-11
CHEPINS PARK (CITY OF KS. HA)
4820 E. DOUGLAS AVE.
MHW-10

RETAIL STORE
MHW-13
RETAIL STORE (LIVING TRUST-CARL CHUZY)
MHW-14
4801 E. DOUGLAS AVE.
MHW-21 * Per KDH PM: AS FAR SOUTH AS POSSIBLE

UNKNOWN FUELING LOCATIONS
SOUTHWESTERN BELL TELEPHONE
118 S. Oliver Street
PARK

FORMER CONDO/PHILLIPS #4861
RESTAURANT AND RETAIL STORES
7734 E. DOUGLAS AVE. FORMER CANOPY
MHW-12
MHW-5
MHW-6
MHW-8
MHW-4
MHW-2
MHW-1
MHW-16
MHW-1
MHW-7
MHW-18
4701 E. DOUGLAS AVE.
RETAIL STRIP MALL (WALTER MORRIS DUMPSTER)
GAS METER
MHW-20
ROW ONLY (EN GRASS)
BIG ELM TREE
GROUNDWATER FLOW DIRECTION DECEMBER 2013
MHW-15

RES
4620 E. DOUGLAS AVE
DENTAL OFFICE
MHW-17
100 FOOT EAST DOUGLAS AVE (5 LANES)
E.N. GRASS (ROW ONLY)
NO PARKING
@ BANK: 4641 E. DOUGLAS
OFFICES
CASSON BANK
MULWANE STATE BANK
RES