

WATER WELL RECORD

Form WWC-5

Division of Water Resources App. No. Mw-21

1 LOCATION OF WATER WELL: County: Sedgewick	Fraction NW ¼ NW ¼ NW ¼ SW ¼	Section Number 24	Township No. T 27 S	Range Number R 1 <input checked="" type="checkbox"/> E <input type="checkbox"/> W
---	---------------------------------	----------------------	------------------------	--

Street/Rural Address of Well Location; if unknown, distance & direction from nearest town or intersection: If at owner's address, check here .
4724 E. Douglas Ave.; Wichita, KS; see attached map

Global Positioning System (GPS) information:
 Latitude: 37.686038 (in decimal degrees)
 Longitude: 97.280282 (in decimal degrees)
 Elevation: 1350
 Datum: WGS 84, NAD 83, NAD 27
 Collection Method:
 GPS unit (Make/Model: Garmin etrek 10)
 Digital Map/Photo, Topographic Map, Land Survey
 Est. Accuracy: <3 m, 3-5 m, 5-15 m, >15 m

2 WATER WELL OWNER: Connoco Phillips
 RR#, Street Address, Box #: 1614-02 Phillips Bldg.
 City, State, ZIP Code: Bartlesville OK 74004

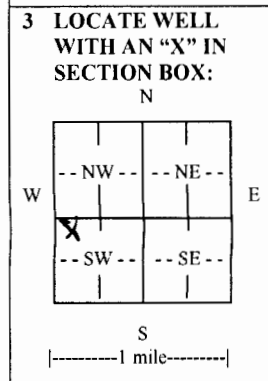

4 DEPTH OF COMPLETED WELL 20 ft.

Depth(s) Groundwater Encountered (1)..... ft. (2)..... ft. (3)..... ft.
 WELL'S STATIC WATER LEVEL..... ft. below land surface measured on mo/day/yr.....
 Pump test data: Well water was..... ft. after..... hours pumping..... gpm
 EST. YIELD..... gpm. Well water was..... ft. after..... hours pumping..... gpm
 Bore Hole Diameter 8.5 in. to 20 ft., and..... in. to..... ft.
 WELL WATER TO BE USED AS: Public water supply Geothermal Injection well
 Domestic Feedlot Oil field water supply Dewatering Other (Specify below)
 Irrigation Industrial Domestic-lawn & garden Monitoring well
 Was a chemical/bacteriological sample submitted to Department? Yes No
 If yes, mo/day/yr sample was submitted.....
 Water well disinfected? Yes No

5 TYPE OF CASING USED: Steel PVC Other

CASING JOINTS: Glued Clamped Welded Threaded
 Casing diameter 2 in. to 5 ft., Diameter..... in. to..... ft., Diameter..... in. to..... ft.
 Casing height above land surface -6 in., Weight..... lbs./ft., Wall thickness or gauge No. Sch 40

TYPE OF SCREEN OR PERFORATION MATERIAL:
 Steel Stainless Steel PVC Other (Specify)

Brass Galvanized Steel None used (open hole)

SCREEN OR PERFORATION OPENINGS ARE:
 Continuous slot Mill slot Gauze wrapped Torch cut Drilled holes None (open hole)
 Louvered shutter Key punched Wire wrapped Saw cut Other (specify)

SCREEN-PERFORATED INTERVALS: From 5 ft. to 20 ft., From..... ft. to..... ft.
 From 4 ft. to..... ft., From..... ft. to..... ft.
 GRAVEL PACK INTERVALS: From 4 ft. to 20 ft., From..... ft. to..... ft.
 From..... ft. to..... ft., From..... ft. to..... ft.

6 GROUT MATERIAL: Neat cement Cement grout Bentonite Other

Grout Intervals: From 2 ft. to 15 ft., From..... ft. to..... ft., From..... ft. to..... ft.

What is the nearest source of possible contamination:
 Septic tank Lateral lines Pit privy Livestock pens Insecticide storage Other (specify below)
 Sewer lines Cesspool Sewage lagoon Fuel storage Abandoned water well
 Watertight sewer lines Seepage pit Feedyard Fertilizer storage Oil well/gas well

Direction from well..... Distance from well.....

FROM	TO	LITHOLOGIC LOG	FROM	TO	LITHO. LOG (cont.) or PLUGGING INTERVALS
0	3	Silty clay			
3	14	clay			
14	17	Sandy clay			
17	20	Clay			

7 CONTRACTOR'S OR LANDOWNER'S CERTIFICATION: This water well was constructed, reconstructed, or plugged under my jurisdiction and was completed on (mo/day/year) 11-24-14 and this record is true to the best of my knowledge and belief. Kansas Water Well Contractor's License No. 710..... This Water Well Record was completed on (mo/day/year) 12-5-14 under the business name of Below Ground Surface, Inc. by (signature) Michael T. Oesley

INSTRUCTIONS: Use typewriter or ball point pen. PLEASE PRESS FIRMLY and PRINT clearly. Please fill in blanks and check the correct answers. Send one copy to Kansas Department of Health and Environment, Bureau of Water, Geology Section, 1000 SW Jackson St., Suite 420, Topeka, Kansas 66612-1367. Telephone 785-296-5524. Send one copy to WATER WELL OWNER and retain one for your records. Include fee of \$5.00 for each constructed well. Visit us at <http://www.kdheks.gov/waterwell/index.html>

Public Utility LOCATIONS

LEGEND

- PROPOSED DRILLING LOCATIONS
- MONITORING WELLS INSTALLED 2013
- MONITORING WELLS INSTALLED 2010
- GROUNDWATER FLOW DIRECTION
- SITE PROPERTY LINE
- PROPERTY LINE
- FENCE
- FORMER PRODUCT LINES
- FORMER FUELING SYSTEM COMPONENTS
- STORM SEWER LINE (LESS THAN 5' BGS)
- SANITARY SEWER LINE (LESS THAN 5' BGS)
- GAS LINE (LESS THAN 5' BGS)
- UNDERGROUND ELECTRIC LINE (LESS THAN 5' BGS)
- OVERHEAD UTILITY LINE (~ 15' HIGH)
- WATER LINE (LESS THAN 5' BGS)
- PROJECT BENCHMARK ELEVATION = 1310.47



SCALE: 1" = 50'

1.0

Cardno ATC
Shaping the Future

REVISION TO PROPOSED DRILL LOCATIONS

FORMER CONOCOPHILLIPS #4861
4724 EAST DOUGLAS AVENUE
WICHITA, KANSAS

PROJECT NUMBER: 17-75000-4861
DOCUMENT: LIMITED SITE ASSESSMENT

DRAWN BY: JG 05/19/14
CHECKED BY: DR 9/9/14
FILE PATH: 4861-FLW0

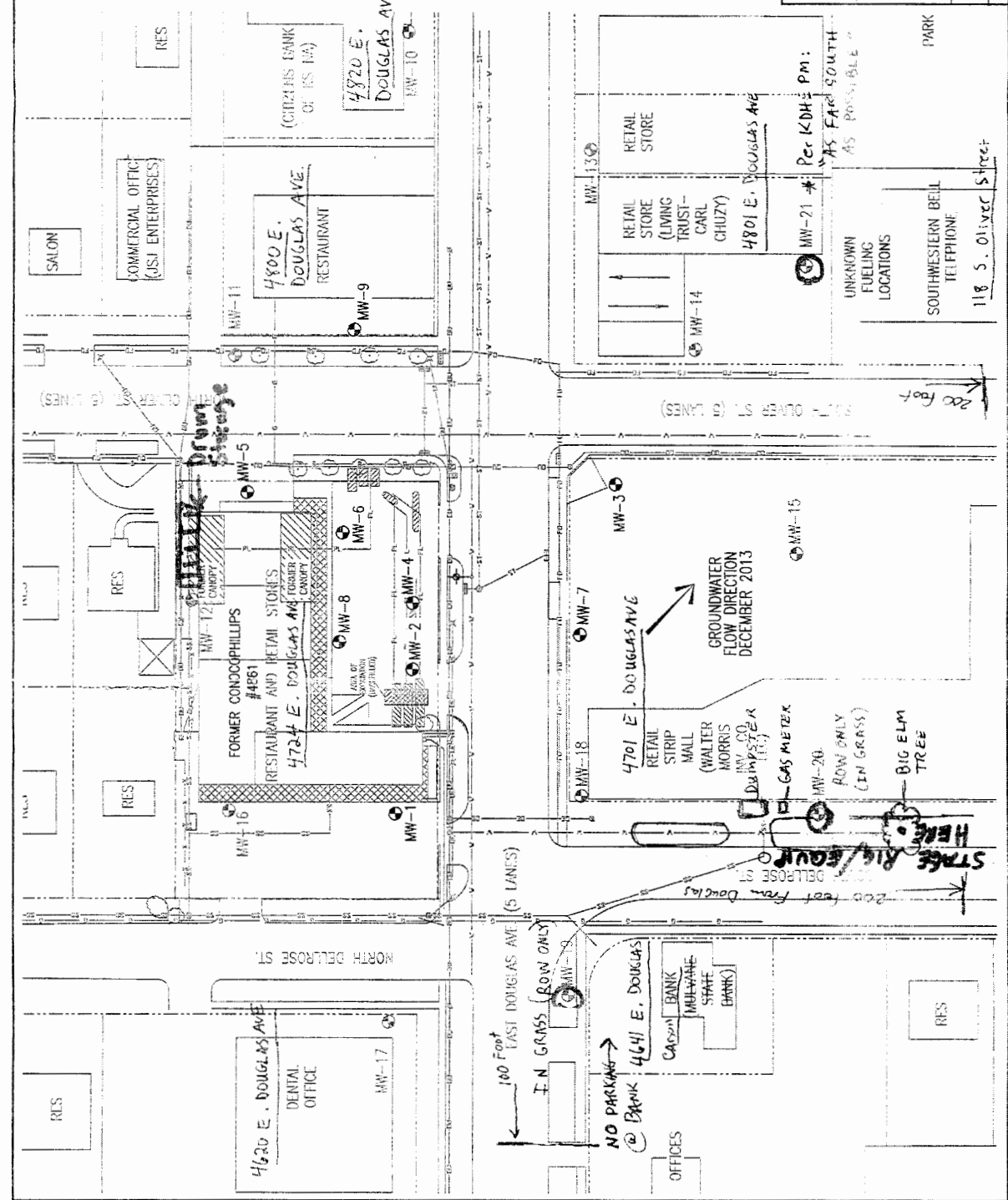

MW-21 * Per KDHE PM:
"AS FACED SOUTH"
"AS POSSIBLE"

UNKNOWN FUELING LOCATIONS

SOUTHWESTERN BELL TELEPHONE

118 S. OLIVE ST

GROUNDWATER FLOW DIRECTION DECEMBER 2013

4701 E. DOUGLAS AVE
RETAIL STRIP MALL
(WALTER MORRIS INV. CO. DUMPSTEAK (T))
GAS METEX

100 Foot EAST DOUGLAS AVE (5 LANES)
IN GRASS (ROW ONLY)

NO PARKING
@ BANK 4641 E. DOUGLAS

Cardno BANK
MILLANE STATE BANK

STAGE RIG ROW
200 feet from Douglas

MW-20
ROW ONLY (IN GRASS)
BIG ELM TREE

FORMER CONOCOPHILLIPS #4861
RESTAURANT AND RETAIL STORES
4724 E. DOUGLAS AVE
AREA OF DISTURBANCE (vegetation)

4800 E. DOUGLAS AVE RESTAURANT

4820 E. DOUGLAS AVE

COMMERCIAL OFFICE (GSJ ENTERPRISES)

SALON

RES

RES

RES

4620 E. DOUGLAS AVE
DENTAL OFFICE

RES

4801 E. DOUGLAS AVE
RETAIL STORE (LIVING TRUST-CARL CHUZY)

RETAIL STORE

RES

RES

RES

RES

RES

RES

RES

RES

RES