

Corrected

WATER WELL RECORD Form WWC-5

Division of Water Resources App. No. [ ] Well ID [ ]

Original Record  Correction  Change in Well Use

1 LOCATION OF WATER WELL: County: Sedgewick Fraction NE NE NE SE Section Number 23 Township Number T 27 S Range Number R 1 E W

2 WELL OWNER: Last Name: Business: ConocoPhillips Address: 1614-02 Phillips Blvd City: Bartlesville State: OK ZIP: 74004 Street or Rural Address where well is located: 4724 E. Douglas; Wichita KS; see attached map

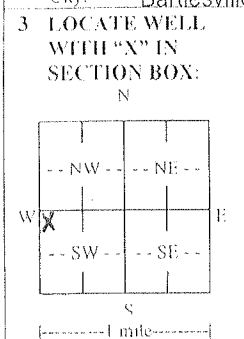

3 LOCATE WELL WITH "X" IN SECTION BOX: 4 DEPTH OF COMPLETED WELL: 20 ft. Depth(s) Groundwater Encountered: 1) ... 2) ... 3) ... or 4) Dry Well WELL'S STATIC WATER LEVEL: ... below land surface, measured on (mo-day-yr) ... above land surface, measured on (mo-day-yr) ... Pump test data: Well water was ... after ... hours pumping ... gpm ... Well water was ... after ... hours pumping ... gpm Estimated Yield: ... gpm Bore Hole Diameter: 8.5 in. to 20 ft. and ... in. to ... ft.

5 Latitude: 37.68579 (decimal degrees) Longitude: -97.28138 (decimal degrees) Horizontal Datum: WGS 84 NAD 83 NAD 27 Source for Latitude/Longitude: GPS (unit make/model: Garmin etrek 10) (WAAS enabled? Yes No) Land Survey Topographic Map Online Mapper: 6 Elevation: ... ft. Ground Level TOC Source: Land Survey GPS Topographic Map Other

7 WELL WATER TO BE USED AS: 1. Domestic: Household Lawn & Garden Livestock 2. Irrigation 3. Feedlot 4. Industrial 5. Public Water Supply: well ID 6. Dewatering: how many wells? 7. Aquifer Recharge: well ID 8. Monitoring: well ID MW-22 9. Environmental Remediation: well ID Air Sparge Soil Vapor Extraction Recovery Injection 10. Oil Field Water Supply: lease 11. Test Hole: well ID Cased Uncased Geotechnical 12. Geothermal: how many bores? a) Closed Loop Horizontal Vertical b) Open Loop Surface Discharge Inj. of Water 13. Other (specify):

Was a chemical/bacteriological sample submitted to KDHE? Yes No If yes, date sample was submitted: Water well disinfected? Yes No

8 TYPE OF CASING USED: Steel PVC Other CASING JOINTS: Glued Clamped Welded Threaded Casing diameter 2 in. to 10 ft. Diameter in. to ft. Diameter in. to ft. Casing height above land surface 6 in. Weight lbs./ft. Wall thickness or gauge No. Sch 40 TYPE OF SCREEN OR PERFORATION MATERIAL: Steel Stainless Steel Fiberglass PVC Brass Galvanized Steel Concrete tile None used (open hole) SCREEN OR PERFORATION OPENINGS ARE: Continuous Slot Mill Slot Gauze Wrapped Torch Cut Drilled Holes Other (Specify) Louvered Shutter Key Punched Wire Wrapped Saw Cut None (Open Hole) SCREEN-PERFORATED INTERVALS: From 10 ft. to 20 ft. From ft. to ft. From ft. to ft. GRAVEL PACK INTERVALS: From 8 ft. to 20 ft. From ft. to ft. From ft. to ft.

9 GROUT MATERIAL: Neat cement Cement grout Bentonite Other Grout Intervals: From 3 ft. to 8 ft. From ft. to ft. From ft. to ft. Nearest source of possible contamination: Septic Tank Lateral Lines Pit Privy Livestock Pens Insecticide Storage Sewer Lines Cess Pool Sewage Lagoon Fuel Storage Abandoned Water Well Watertight Sewer Lines Seepage Pit Feedyard Fertilizer Storage Oil Well/Gas Well Other (Specify) Direction from well? Distance from well? ft.

10 FROM	TO	LITHOLOGIC LOG	FROM	TO	LITHO LOG (cont) or PLUGGING INTERVALS
0	3	silty clay			
3	14	clay			
14	17	sandy clay			
17	20	clay			
Notes:					

11 CONTRACTOR'S OR LANDOWNER'S CERTIFICATION: This water well was constructed, reconstructed, or plugged under my jurisdiction and was completed on (mo-day-year) 08-13-2015... and this record is true to the best of my knowledge and belief. Kansas Water Well Contractor's License No. 710... This Water Well Record was completed on (mo-day-year) 08-16-2015... under the business name of Below Ground Surface, Inc. Signature: [Signature]

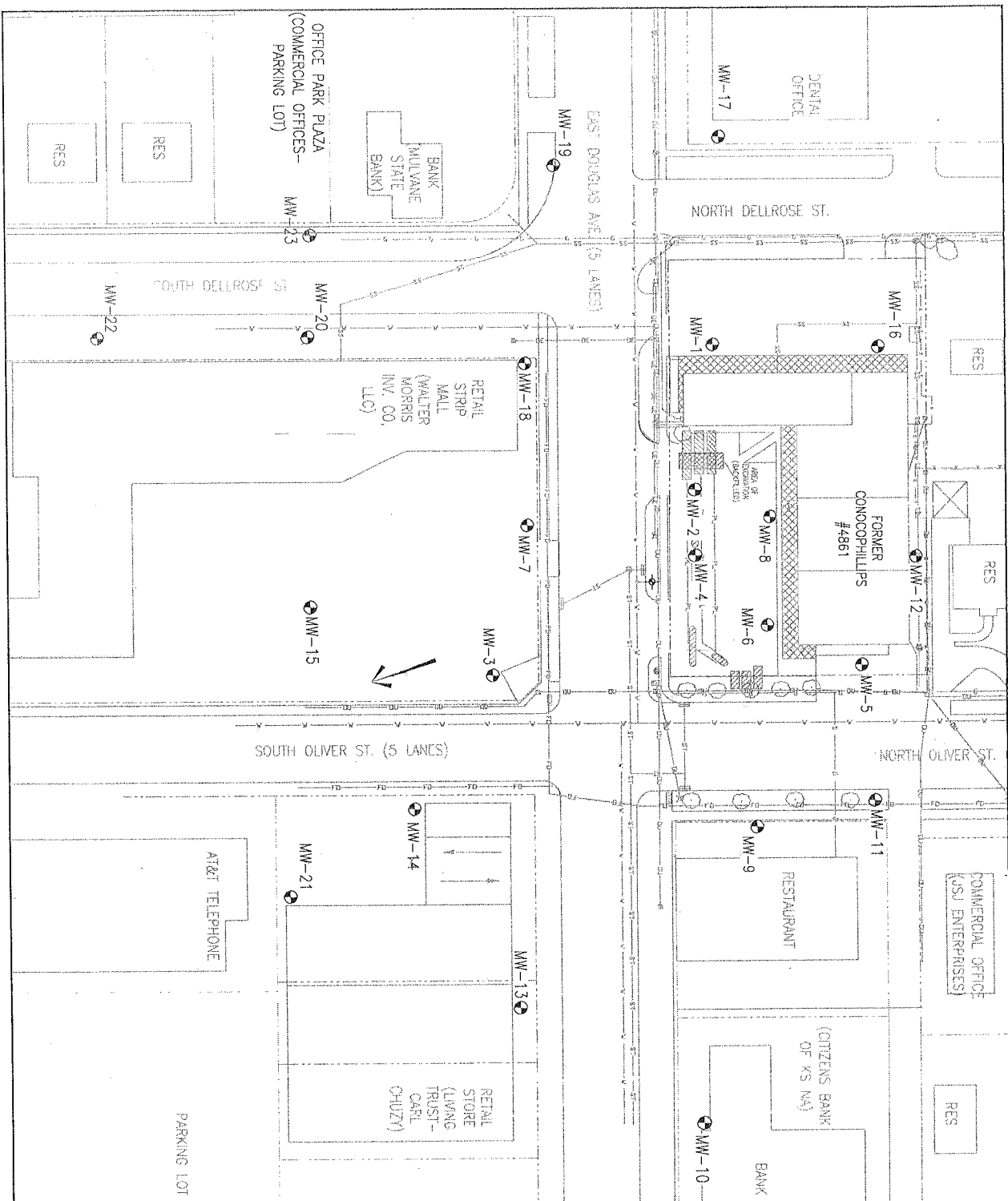

- LEGEND**
- ◉ MW- EXISTING MONITORING WELLS
  - ◉ MW- PROPOSED MONITORING WELLS
  - SITE PROPERTY LINE
  - PROPERTY LINE
  - FENCE
  - FORMER PRODUCT LINES
  - FORMER FUELING SYSTEM COMPONENTS
  - SANITARY SEWER LINE (LESS THAN 5' BGS)
  - GAS LINE (LESS THAN 5' BGS)
  - UNDERGROUND ELECTRIC LINE (LESS THAN 5' BGS)
  - OVERHEAD UTILITY LINE (~ 15' HIGH)
  - WATER LINE (LESS THAN 5' BGS)

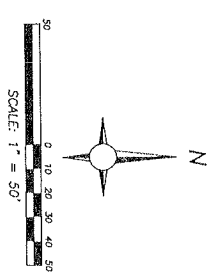

**1.0**

**PROPOSED WELLS**  
 MARCH 2015  
 FORMER CONOCOPHILLIPS #4861  
 4724 EAST DOUGLAS AVENUE  
 WICHITA, KANSAS

**Cardino**  
 ATC  
 Shaping the Future

PROJECT NUMBER: 1775000-4861	DOCUMENT: LIMITED SITE ASSESSMENT - SECOND ADDENDUM	ISSUE DATE: 03/13/15	CHECKED BY:
---------------------------------	--	-------------------------	-------------

FILE PATH: 4861-01.dwg