

DENNIS L HANDKE

1820 NW 59th Terrace
TOPEKA, KANSAS 66618
785-286-4047 Home
785-217-5864 Cell

Meredith Watson
TerraNext, LLC
11904 Grandview Ave.
Grandview, Missouri, 64030

October 27, 2017

RE: Monitor Well Elevation Survey
6327 E. 13th Street, Wichita, Kansas

Proj. 17-00FF
AMOCO #8542
U2-087-01162

Bench Mark: Chisled square on the SW corner of concrete signal light base near NE corner of property.
Elev: 1388.44 North 5240.06 West 44.50 (from SE Cor. Sec.13-27-1E)

MW-12R rim	1389.97	North	5119.80	West	70.51	NE1/4,NE1/4,NE1/4,NE1/4
top pipe	1389.37					Lat= 37.70793 Long = 97.26249
MW-15R rim	1386.65	North	5067.96	East	54.28	NW1/4,NW1/4,NW1/4,NW1/4 (Sec.18-27-2)
top pipe	1386.37					Lat= 37.70781 Long = 97.26205

Elevation derived from existing project.

Lat & Long derived from Wichita East 7.5 minute Quad Map WGS84.

If you have any questions, please feel free to call me. Thank you for the opportunity to be of service to you.

November 3, 2017
Dennis L. Handke RS

Dennis L Handke

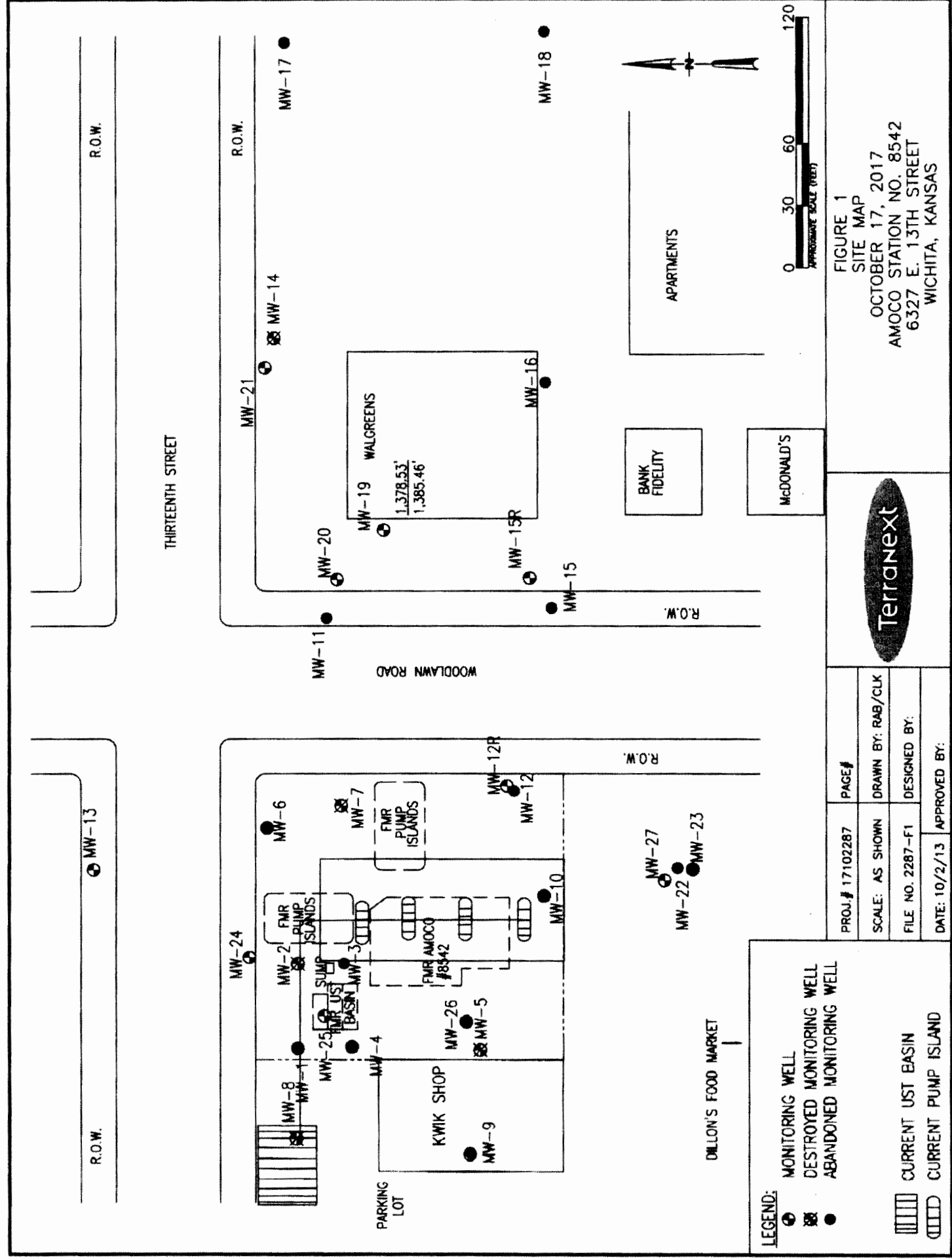

FIGURE 1
 SITE MAP
 OCTOBER 17, 2017
 AMOCO STATION NO. 8542
 6327 E. 13TH STREET
 WICHITA, KANSAS



PROJ.# 17102287	PAGE#
SCALE: AS SHOWN	DRAWN BY: RAB/CLK
FILE NO. 2287-F1	DESIGNED BY:
DATE: 10/2/13	APPROVED BY:

<ul style="list-style-type: none"> Monitoring Well Destroyed Monitoring Well Abandoned Monitoring Well Current UST Basin Current Pump Island
