

WATER WELL RECORD

Form WWC-5

Division of Water Resources App. No.

Well ID

MW2

Original Record Correction Change in Well Use

1 LOCATION OF WATER WELL: County Sedgwick Fraction SW 1/4 SW 1/4 SW 1/4 NE 1/4 Section Number 6 Township Number T 27 S Range Number R 1 E W

2 WELL OWNER: Last Name: Business: KDHE Address: 1000 SW Jackson Blvd City: Topeka State: KS ZIP: 66612 Street or Rural Address where well is located (if unknown, distance and direction from nearest town or intersection): 2600 N Amidon, Wichita KS

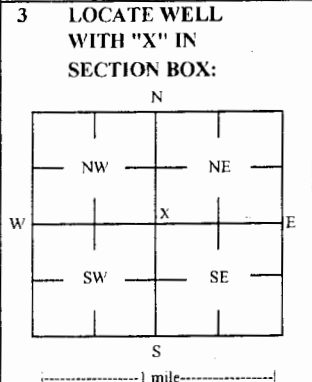

3 LOCATE WELL WITH "X" IN SECTION BOX: 4 DEPTH OF COMPLETED WELL: 25 ft Depth(s) Groundwater Encountered: 1) 25 ft 2) 3) 4) Dry Well WELL'S STATIC WATER LEVEL: 15.84 ft

5 Latitude: 37.73017 (decimal degrees) Longitude: 97.36271 (decimal degrees) Horizontal Datum: WGS 84 X NAD 83 NAD 27 Source for Latitude/Longitude: GPS (unit make/model) (WAAS enabled? Yes No) X Land Survey Topographic Map Online Mapper

6 Elevation: 1314.9 ft Ground Level X TOC Source: X Land Survey GPS Topographic Map Other

7 WELL WATER TO BE USED AS: 1 Domestic: Household Lawn & Garden Livestock Irrigation Feedlot Industrial 5 Public Water Supply: well ID 6 Dewatering: how many wells? 7 Aquifer Recharge: well ID 8 X Monitoring: well ID MW2 9 Environmental Remediation: well ID Air Sparge Soil Vapor Extractor Recovery Injection 10 Oil Field Water Supply: lease 11 Test Hole: well ID Cased Uncased Geotechnical 12 Geothermal: How many bores? a) Closed Loop Horizontal Vertical b) Open Loop Surface Discharge Inj. of Water Other (specify):

Was a chemical/bacteriological sample submitted to KDHE? Yes No X No If yes, date sample was submitted: Water well disinfected? Yes No X No

8 TYPE OF CASING USED: Steel X PVC Other CASING JOINTS: Glued Clamped Welded X Threaded Casing diameter 2 in. to 10 ft, Diameter in. to ft, Diameter in. to ft, Casing height above land surface -0.3 in. Weight lbs./ft. Well thickness or gauge No TYPE OF SCREEN OR PERFORATION MATERIAL: Steel Stainless Steel Fiberglass X PVC Other (Specify) SCREEN OR PERFORATION OPENINGS ARE: Continuous Slot X Mill Slot Gauze Wrapped Torch Cut Drilled Holes Other (Specify) Louvered Shutter Key Punched Wire Wrapped Saw Cut None (Open Hole) SCREEN-PERFORATED INTERVALS: From 10 ft. to 25 ft, From ft. to ft, From ft. to ft, GRAVEL PACK INTERVALS: From 8 ft. to 25 ft, From ft. to ft, From ft. to ft,

9 GROUT MATERIAL: Neat cement Cement grout X Bentonite X Other Concrete: 0-1' Grout intervals: From 1 ft. to 8 ft, From ft. to ft, From ft. to ft,

Nearest source of possible contamination: Septic Tank Lateral Lines Pit Privy Livestock Pens Insecticide Storage Sewer Lines Cess Pool Sewage Lagoon X Fuel Storage Abandoned Water Well Watertight Sewer Lines Seepage Pit Feedyard Fertilizer Storage Oil Well / Gas Well Other (Specify)

Direction from well? Within the basin Distance from well? Within the basin ft

Table with 6 columns: FROM, TO, LITHOLOGIC LOG, FROM, TO, LITHO. LOG (cont.) or PLUGGING INTERVALS. Rows include: 0-0.6 Concrete, 0.6-1 Fine fill sand, 1-1.5 Sandy silt, 1.5-2.5 Clayey silt, 2.5-9.5 Silty clay, 9.5-25 Clayey medium to coarse sand.

Notes: KDHE ID: Amidon 66 Service; U2-087-14460 Target of monitoring well is shallow groundwater, <20' of grout was installed at the direction of KDHE.

11 CONTRACTOR'S OR LANDOWNER'S CERTIFICATION: This water well was X constructed, reconstructed, or plugged under my jurisdiction and was completed on (mo-day-year) 4/3/18 and this record is true to the best of my knowledge and belief. Kansas Water Well Contractor's License No 757 This Water Well Record was completed on (mo-day-year) 5/1/18 under the business name of Larsen & Associates, Inc. Signature

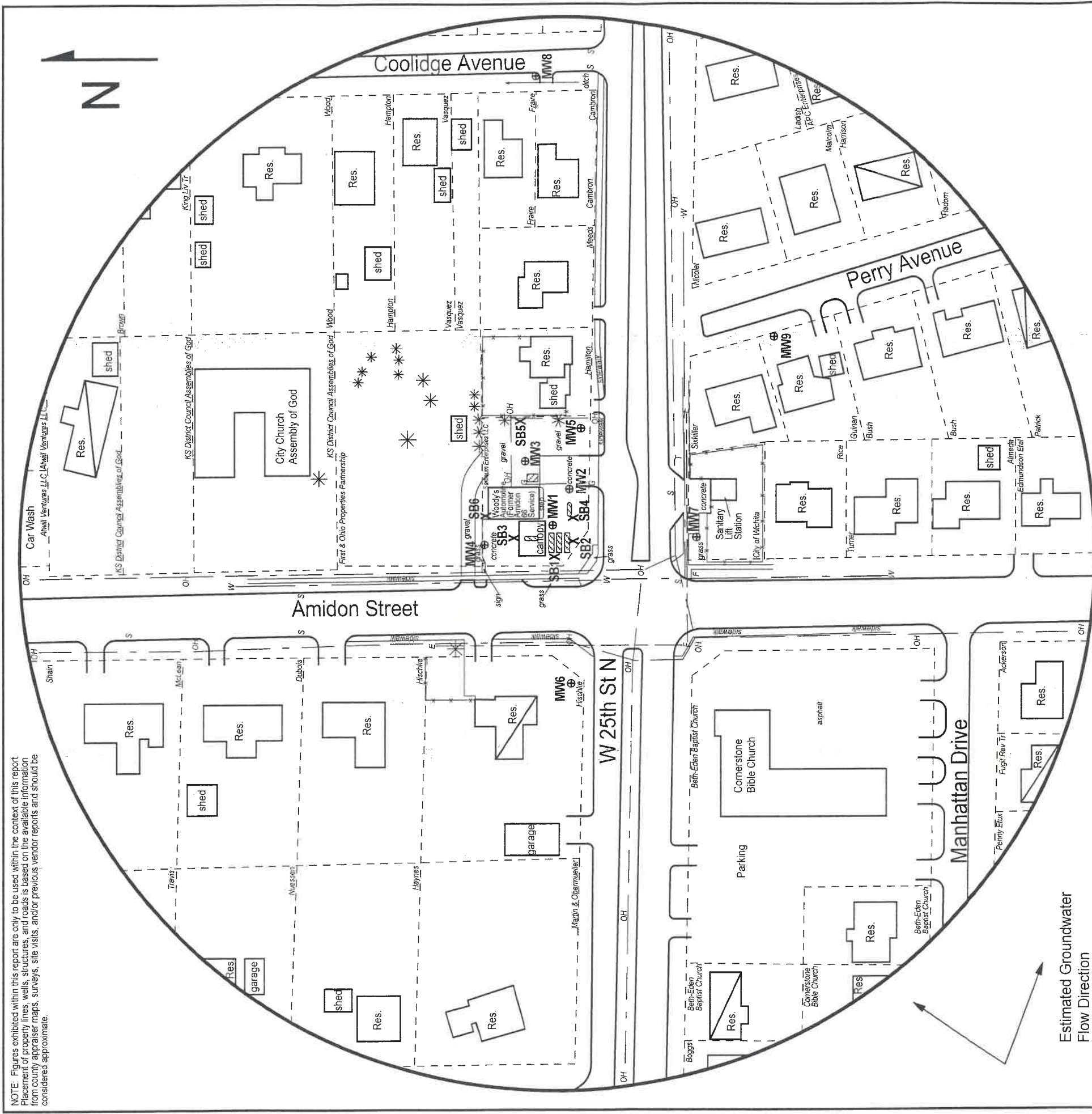

NOTE: Figures exhibited within this report are only to be used within the context of this report. Placement of property lines, wells, structures, and roads is based on the available information from county appraiser maps, surveys, site visits, and/or previous vendor reports and should be considered approximate.

FIGURE 2.2 - 500 FT RADIUS AREA BASE MAP

LEGEND:

- Approximate Location of Former UST Basin and Pump Islands
 - Location of Used Oil AST
 - Building with Basement
 - Approximate Location of Property Line
 - Monitoring Well (Installed 4/2-4/18)
 - Soil Boring (Drilled 4/3-4/18)
 - Fire Hydrant
 - Sewer Meter
 - Telephone Meter
 - Electric Lines (2 - 6 ft BGS)
 - Gas Lines (2 - 6 ft BGS)
 - Overhead Lines (25-40 ft high)
 - Water Lines (2 - 6 ft BGS)
- NOTE: Utility depths, heights and locations are approximate. NOTE: SB5 & SB6 were drilled to collect hydrologic samples.

PROJECT:

Amidon 66 Service
 2600 N. Amidon
 Wichita, KS
 KDHE ID: U2-087-14460
 Date: 4/11/18

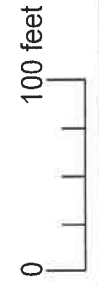

1311 E 25th St., Suite B
 Lawrence, KS 66046
 (785) 841-8707 office
 (785) 865-4282 fax

RECEIVED

MAY 13 2018

BUREAU OF WATER

SEDCHECK

6-27-1E

DENNIS L HANDKE

1820 NW 59th Terrace
TOPEKA, KANSAS 66618
785-286-4047 Home
785-286-1990 Fax

Jessica Chapman
Larsen & Associates
1311 E. 25th Street, Suite B
Lawrence, Kansas, 66046

April 24, 2018

RE: Monitor Well Elevation Survey
2600 N. Amidon, Wichita, Kansas

Proj. 18-00K
Amidon 66 Station
U2-087-14460

Bench Mark: Chisled Sq. on NE corner of concrete signal light base at Southwest corner of property.
Elev: 1314.30 North 2782 West 2590 (from SE Cor. Sec. 6-27-1E)

| | | | | | |
|------|----------|---------|-------|------|-------------------------------|
| MW-1 | rim | 1315.31 | North | 2803 | SW1/4,SW1/4,SW1/4,NE1/4 |
| | top pipe | 1315.11 | West | 2558 | Lat= 37.73021 Long = 97.36282 |
| MW-2 | rim | 1315.20 | North | 2788 | SW1/4,SW1/4,SW1/4,NE1/4 |
| | top pipe | 1314.90 | West | 2525 | Lat= 37.73017 Long = 97.36271 |
| MW-3 | rim | 1315.56 | North | 2824 | SW1/4,SW1/4,SW1/4,NE1/4 |
| | top pipe | 1315.33 | West | 2499 | Lat= 37.73026 Long = 97.36262 |
| MW-4 | rim | 1315.11 | North | 2865 | SW1/4,SW1/4,SW1/4,NE1/4 |
| | top pipe | 1314.82 | West | 2580 | Lat= 37.73038 Long = 97.36290 |
| MW-5 | rim | 1314.75 | North | 2775 | SE1/4,SW1/4,SW1/4,NE1/4 |
| | top pipe | 1314.49 | West | 2475 | Lat= 37.73013 Long = 97.36253 |
| MW-6 | rim | 1314.90 | North | 2783 | SW1/4,SE1/4,SE1/4,NW1/4 |
| | top pipe | 1314.47 | West | 2711 | Lat= 37.73015 Long = 97.36335 |
| MW-7 | rim | 1315.19 | North | 2667 | NW1/4,NW1/4,NW1/4,SE1/4 |
| | top pipe | 1314.87 | West | 2570 | Lat= 37.72983 Long = 97.36286 |
| MW-8 | rim | 1313.19 | North | 2809 | SW1/4,SE1/4,SE1/4,NW1/4 |
| | top pipe | 1312.93 | West | 2143 | Lat= 37.73023 Long = 97.36139 |
| MW-9 | rim | 1314.52 | North | 2594 | NW1/4,NW1/4,NW1/4,SE1/4 |
| | top pipe | 1314.25 | West | 2386 | Lat= 37.72964 Long = 97.36222 |

RECEIVED
MAY 12 2018
BUREAU OF WATER

Lat & Long derived existing Wichita East 7.5' quad map. WGS 84.

Elevation established from KDOT I-235 project NAVD 83.

If you have any questions, please feel free to call me. Thank you for the opportunity to be of service to you.

April 24, 2018
 Dennis L Handke RLS
 LS-786
 Dennis L Handke
 KANSAS
 LAND SURVEYOR