

**WATER WELL RECORD**

**Form WWC-5**

Division of Water Resources App. No.

Well ID **MW4**

Original Record  Correction  Change in Well Use

**1 LOCATION OF WATER WELL:** County Sedgwick Fraction SW ¼ SW ¼ SW ¼ NE ¼ Section Number 6 Township Number T 27 S Range Number R 1  E  W

**2 WELL OWNER:** Last Name: Business: KDHE Address: 1000 SW Jackson Blvd City: Topeka State: KS ZIP: 66612  
 First: Street or Rural Address where well is located (if unknown, distance and direction from nearest town or intersection): 2600 N Amidon, Wichita KS  
 If at owner's address, check here:

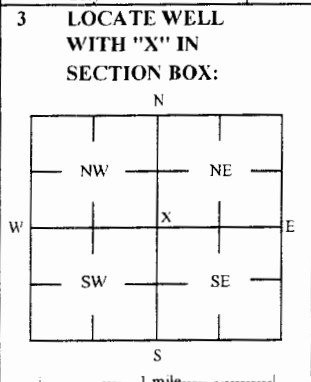

**4 DEPTH OF COMPLETED WELL:** 25 ft  
 Depth(s) Groundwater Encountered: 1) \_\_\_\_\_ ft  
 2) \_\_\_\_\_ ft 3) \_\_\_\_\_ ft, or 4)  Dry Well  
 WELL'S STATIC WATER LEVEL: 15.79 ft.  
 below land surface, measured on (mo-day-yr) 4/11/18  
 above land surface, measured on (mo-day-yr) \_\_\_\_\_  
 Pump test data: Well water was \_\_\_\_\_ ft after \_\_\_\_\_ hours pumping \_\_\_\_\_ gpm  
 Water well was \_\_\_\_\_ ft after \_\_\_\_\_ hours pumping \_\_\_\_\_ gpm  
 Estimated Yield: \_\_\_\_\_ gpm  
 Bore Hole Diameter: 7.25 in to \_\_\_\_\_ ft, and \_\_\_\_\_ in to \_\_\_\_\_ ft

**5 Latitude:** 37.73038 (decimal degrees)  
**Longitude:** 97.36290 (decimal degrees)  
 Horizontal Datum:  WGS 84  NAD 83  NAD 27  
 Source for Latitude/Longitude:  
 GPS (unit make/model: \_\_\_\_\_) (WAAS enabled?  Yes  No)  
 Land Survey  Topographic Map  
 Online Mapper

**6 Elevation:** 1314.82 ft  Ground Level  TOC  
 Source  Land Survey  GPS  Topographic Map  
 Other \_\_\_\_\_

**7 WELL WATER TO BE USED AS:**

1 Domestic: <input type="checkbox"/> Household <input type="checkbox"/> Lawn & Garden <input type="checkbox"/> Livestock <input type="checkbox"/> Irrigation <input type="checkbox"/> Feedlot <input type="checkbox"/> Industrial	5 <input type="checkbox"/> Public Water Supply: well ID _____	10 <input type="checkbox"/> Oil Field Water Supply: lease _____
2 <input type="checkbox"/> Irrigation	6 <input type="checkbox"/> Dewatering: how many wells? _____	11 Test Hole: well ID _____
3 <input type="checkbox"/> Feedlot	7 <input type="checkbox"/> Aquifer Recharge: well ID _____	<input type="checkbox"/> Cased <input type="checkbox"/> Uncased <input type="checkbox"/> Geotechnical
4 <input type="checkbox"/> Industrial	8 <input checked="" type="checkbox"/> Monitoring: well ID <b>MW4</b>	12 Geothermal: How many bores? _____
	9 Environmental Remediation: well ID _____	a) Closed Loop <input type="checkbox"/> Horizontal <input type="checkbox"/> Vertical
	<input type="checkbox"/> Air Sparge <input type="checkbox"/> Soil Vapor Extractor	b) Open Loop <input type="checkbox"/> Surface Discharge <input type="checkbox"/> Inj. of Water
	<input type="checkbox"/> Recovery <input type="checkbox"/> Injection	<input type="checkbox"/> Other (specify): _____

**Was a chemical/bacteriological sample submitted to KDHE?**  Yes  No If yes, date sample was submitted: \_\_\_\_\_  
 Water well disinfected?  Yes  No

**8 TYPE OF CASING USED:**  Steel  PVC  Other \_\_\_\_\_ CASING JOINTS:  Glued  Clamped  Welded  Threaded  
 Casing diameter 2 in. to 10 ft, Diameter \_\_\_\_\_ in. to \_\_\_\_\_ ft, Diameter \_\_\_\_\_ in. to \_\_\_\_\_ ft,  
 Casing height above land surface -0.29 in. Weight \_\_\_\_\_ lbs./ft. Well thickness or gauge No \_\_\_\_\_  
**TYPE OF SCREEN OR PERFORATION MATERIAL:**  
 Steel  Stainless Steel  Fiberglass  PVC  Other (Specify) \_\_\_\_\_  
 Brass  Galvanized Steel  Concrete tile  None used (open hole)  
**SCREEN OR PERFORATION OPENINGS ARE:**  
 Continuous Slot  Mill Slot  Gauze Wrapped  Torch Cut  Drilled Holes  Other (Specify) \_\_\_\_\_  
 Louvered Shutter  Key Punched  Wire Wrapped  Saw Cut  None (Open Hole)  
**SCREEN-PERFORATED INTERVALS:** From 10 ft. to 25 ft, From \_\_\_\_\_ ft. to \_\_\_\_\_ ft, From \_\_\_\_\_ ft. to \_\_\_\_\_ ft,  
**GRAVEL PACK INTERVALS:** From 8 ft. to 25 ft, From \_\_\_\_\_ ft. to \_\_\_\_\_ ft, From \_\_\_\_\_ ft. to \_\_\_\_\_ ft,

**9 GROUT MATERIAL:**  Neat cement  Cement grout  Bentonite  Other Concrete: 0-0.7'  
 Grout intervals: From 0.7 ft. to 8 ft, From \_\_\_\_\_ ft. to \_\_\_\_\_ ft, From \_\_\_\_\_ ft. to \_\_\_\_\_ ft,

**Nearest source of possible contamination:**  
 Septic Tank  Lateral Lines  Pit Privy  Livestock Pens  Insecticide Storage  
 Sewer Lines  Cess Pool  Sewage Lagoon  Fuel Storage  Abandoned Water Well  
 Watertight Sewer Lines  Seepage Pit  Feedyard  Fertilizer Storage  Oil Well / Gas Well  
 Other (Specify) \_\_\_\_\_  
 Direction from well? S Distance from well? ~35 ft

10 FROM	TO	LITHOLOGIC LOG	FROM	TO	LITHO. LOG (cont.) or PLUGGING INTERVALS
0	0.7	Concrete			
0.7	1.5	Fine fill sand			
1.5	11	Silty clay			
11	13	Sandy silt			
13	20	Fine to coarse sand			
20	25	Very coarse sand to gravel			

**Notes:** KDHE ID: Amidon 66 Service: U2-087-14460  
 Target of monitoring well is shallow groundwater, <20' of grout was installed at the direction of KDHE.

**11 CONTRACTOR'S OR LANDOWNER'S CERTIFICATION:** This water well was  constructed,  reconstructed, or  plugged under my jurisdiction and was completed on (mo-day-year) 4/2/18 and this record is true to the best of my knowledge and belief. Kansas Water Well Contractor's License No 757 This Water Well Record was completed on (mo-day-year) 5/1/18 under the business name of Larsen & Associates, Inc. Signature \_\_\_\_\_

Mail 1 white copy along with a fee of \$5.00 for each constructed well to: Kansas Department of Health and Environment, Bureau of Water, GWIS Section, 1000 SW Jackson St., Suite 420, Topeka, Kansas 66612-1367. Mail one to Water Well Owner and retain one for your records. Telephone 785-296-5524.

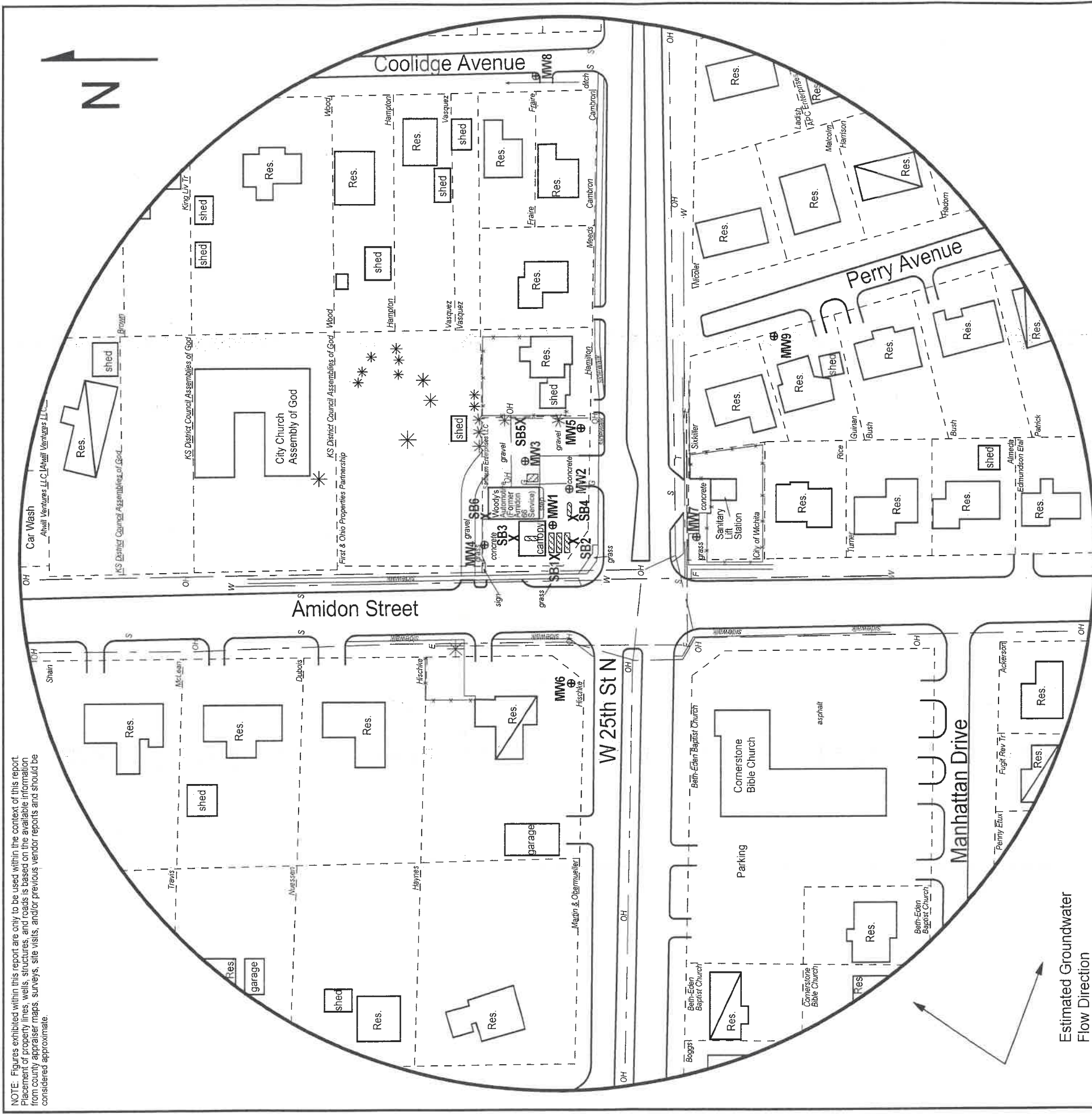

NOTE: Figures exhibited within this report are only to be used within the context of this report. Placement of property lines, wells, structures, and roads is based on the available information from county appraiser maps, surveys, site visits, and/or previous vendor reports and should be considered approximate.

**FIGURE 2.2 - 500 FT RADIUS AREA BASE MAP**

**LEGEND:**

- Approximate Location of Former UST Basin and Pump Islands
  - Location of Used Oil AST
  - Building with Basement
  - Approximate Location of Property Line
  - Monitoring Well (Installed 4/2-4/18)
  - Soil Boring (Drilled 4/3-4/18)
  - Fire Hydrant
  - Sewer Meter
  - Telephone Meter
  - Electric Lines (2 - 6 ft BGS)
  - Gas Lines (2 - 6 ft BGS)
  - Overhead Lines (25-40 ft high)
  - Water Lines (2 - 6 ft BGS)
- NOTE: Utility depths, heights and locations are approximate. NOTE: SB5 & SB6 were drilled to collect hydrologic samples.

**PROJECT:**

Amidon 66 Service  
 2600 N. Amidon  
 Wichita, KS  
 KDHE ID: U2-087-14460  
 Date: 4/11/18



1311 E 25th St., Suite B (785) 841-8707 office  
 Lawrence, KS 66046 (785) 865-4282 fax

RECEIVED

MAY 13 2018

BUREAU OF WATER

SEDCHECK

6-27-1E

# DENNIS L HANDKE

1820 NW 59th Terrace  
TOPEKA, KANSAS 66618  
785-286-4047 Home  
785-286-1990 Fax

Jessica Chapman  
Larsen & Associates  
1311 E. 25<sup>th</sup> Street, Suite B  
Lawrence, Kansas, 66046

April 24, 2018

RE: Monitor Well Elevation Survey  
2600 N. Amidon, Wichita, Kansas

Proj. 18-00K  
Amidon 66 Station  
U2-087-14460

Bench Mark: Chisled Sq. on NE corner of concrete signal light base at Southwest corner of property.  
Elev: 1314.30      North 2782      West 2590      (from SE Cor. Sec. 6-27-1E)

MW-1	rim	1315.31	North	2803	SW1/4,SW1/4,SW1/4,NE1/4
	top pipe	1315.11	West	2558	Lat= 37.73021 Long = 97.36282
MW-2	rim	1315.20	North	2788	SW1/4,SW1/4,SW1/4,NE1/4
	top pipe	1314.90	West	2525	Lat= 37.73017 Long = 97.36271
MW-3	rim	1315.56	North	2824	SW1/4,SW1/4,SW1/4,NE1/4
	top pipe	1315.33	West	2499	Lat= 37.73026 Long = 97.36262
MW-4	rim	1315.11	North	2865	SW1/4,SW1/4,SW1/4,NE1/4
	top pipe	1314.82	West	2580	Lat= 37.73038 Long = 97.36290
MW-5	rim	1314.75	North	2775	SE1/4,SW1/4,SW1/4,NE1/4
	top pipe	1314.49	West	2475	Lat= 37.73013 Long = 97.36253
MW-6	rim	1314.90	North	2783	SW1/4,SE1/4,SE1/4,NW1/4
	top pipe	1314.47	West	2711	Lat= 37.73015 Long = 97.36335
MW-7	rim	1315.19	North	2667	NW1/4,NW1/4,NW1/4,SE1/4
	top pipe	1314.87	West	2570	Lat= 37.72983 Long = 97.36286
MW-8	rim	1313.19	North	2809	SW1/4,SE1/4,SE1/4,NW1/4
	top pipe	1312.93	West	2143	Lat= 37.73023 Long = 97.36139
MW-9	rim	1314.52	North	2594	NW1/4,NW1/4,NW1/4,SE1/4
	top pipe	1314.25	West	2386	Lat= 37.72964 Long = 97.36222

RECEIVED  
MAY 12 2018  
BUREAU OF WATER

Lat & Long derived existing Wichita East 7.5' quad map. WGS 84.

Elevation established from KDOT I-235 project NAVD 83.

If you have any questions, please feel free to call me. Thank you for the opportunity to be of service to you.

April 24, 2018  
 Dennis L Handke RLS  
 LS-786  
 Dennis L Handke  
 KANSAS  
 LAND SURVEYOR