

WATER WELL RECORD

Form WWC-5

Division of Water Resources App. No.

Well ID

Well ID

MW1

Original Record Correction Change in Well Use

1 LOCATION OF WATER WELL: County Sedgwick Fraction NE 1/4 NW 1/4 NE 1/4 NE 1/4 Section Number 32 Township Number T 27 S Range Number R 1 E W

2 WELL OWNER: Last Name: Business: KDHE (Derby Station) Address: 1000 SW Jackson, Suite 410 City: Topeka State: KS ZIP: 66612 Street or Rural Address where well is located (if unknown, distance and direction from nearest town or intersection): 1601 S. Main St Wichita, Kansas 67213

3 LOCATE WELL WITH "X" IN SECTION BOX: N NW NE SW SE S

4 DEPTH OF COMPLETED WELL: 25 ft Depth(s) Groundwater Encountered: 1) 25 ft 2) 3) 4) Dry Well WELL'S STATIC WATER LEVEL: 19.71 ft. X below land surface, measured on (mo-day-yr) 4/11/18

5 Latitude: 37.66420 (decimal degrees) Longitude: 97.33842 (decimal degrees) Horizontal Datum: WGS 84 NAD 83 X NAD 27 Source for Latitude/Longitude: GPS (unit make/model) Land Survey X Topographic Map Online Mapper

6 Elevation 1281.73 ft Ground Level X TOC Source X Land Survey GPS Topographic Map Other

7 WELL WATER TO BE USED AS: 1 Domestic: Household Lawn & Garden Livestock Irrigation Feedlot Industrial 5 Public Water Supply: well ID 6 Dewatering: how many wells? 7 Aquifer Recharge: well ID 8 X Monitoring: well ID MW1 9 Environmental Remediation: well ID Air Sparge Soil Vapor Extractor Recovery Injection 10 Oil Field Water Supply: lease 11 Test Hole: well ID Cased Uncased Geotechnical 12 Geothermal: How many bores? a) Closed Loop Horizontal Vertical b) Open Loop Surface Discharge Inj. of Water Other (specify):

Was a chemical/bacteriological sample submitted to KDHE? Yes X No If yes, date sample was submitted: Water well disinfected? Yes X No

8 TYPE OF CASING USED: Steel X PVC Other CASING JOINTS: Glued Clamped Welded X Threaded Casing diameter 2 in. to 15 ft, Diameter in. to ft, Diameter in. to ft, Casing height above land surface -0.54 in. Weight lbs./ft. Well thickness or gauge No TYPE OF SCREEN OR PERFORATION MATERIAL: Steel Stainless Steel Fiberglass X PVC Other (Specify) Brass Galvanized Steel Concrete tile None used (open hole) SCREEN OR PERFORATION OPENINGS ARE: Continuous Slot X Mill Slot Gauze Wrapped Torch Cut Drilled Holes Other (Specify) Louvered Shutter Key Punched Wire Wrapped Saw Cut None (Open Hole) SCREEN-PERFORATED INTERVALS: From 15 ft. to 25 ft, From ft. to ft, From ft. to ft, GRAVEL PACK INTERVALS: From 13 ft. to 25 ft, From ft. to ft, From ft. to ft,

9 GROUT MATERIAL: Neat cement Cement grout X Bentonite X Other Concrete: 0-1' Grout intervals: From 1 ft. to 13 ft, From ft. to ft, From ft. to ft,

Nearest source of possible contamination: Septic Tank Lateral Lines Pit Privy Livestock Pens Insecticide Storage Sewer Lines Cess Pool Sewage Lagoon X Fuel Storage Abandoned Water Well Watertight Sewer Lines Seepage Pit Feedyard Fertilizer Storage Oil Well / Gas Well Other (Specify) Direction from well? N Distance from well? ~70 ft

10 FROM TO LITHOLOGIC LOG FROM TO LITHO. LOG (cont.) or PLUGGING INTERVALS
0 1.5 Top soil: silt
1.5 4 Silty clay
4 9 Increasing silt grading to clayey silt
9 11 Silt
11 13 Silt with intermittent sand fingers
13 18.5 Very fine sand
18.5 20 Medium sand
20 25 Coarse sand
Notes: KDHE ID: Derby Station; U2-087-12671 Target of monitoring well is shallow groundwater, <20' of grout was installed at the direction of KDHE.

11 CONTRACTOR'S OR LANDOWNER'S CERTIFICATION: This water well was X constructed, reconstructed, or plugged under my jurisdiction and was completed on (mo-day-year) 4/9/18 and this record is true to the best of my knowledge and belief. Kansas Water Well Contractor's License No 757 This Water Well Record was completed on (mo-day-year) 5/2/18 under the business name of Larsen & Associates, Inc. Signature

Mail 1 white copy along with a fee of \$5.00 for each constructed well to: Kansas Department of Health and Environment, Bureau of Water, GWT Section, 1000 SW Jackson St., Suite 420, Topeka, Kansas 66612-1367. Mail one to Water Well Owner and retain one for your records. Telephone 785-296-5524.

SEDCI WICK

DENNIS L HANDKE

1820 NW 59th Terrace
TOPEKA, KANSAS 66618
785-286-4047 Home
785-286-1990 Fax

Jessica Chapman
Larsen & Associates
1311 E. 25th Street, Suite B
Lawrence, Kansas, 66046

April 24, 2018
Revised May 1, 2018

RE: Monitor Well Elevation Survey
110 W. Harry, Wichita, Kansas

Proj. 18-00L
Derby Station
U2-087-12671

Bench Mark: Chisled Sq. on NW corner of concrete signal light base at Southeast corner of property.
Elev: 1146.95 North 26 West 782 (from SE Cor. Sec. 29-27-1E)

MW-1	rim	1282.27	South	47	NE1/4,NW1/4,NE1/4,NE1/4 (Sec. 32-27-1E)
	top pipe	1281.73	West	835	Lat= 37.66420 Long = 97.33842
MW-2	rim	1282.73	South	97	NE1/4,NW1/4,NE1/4,NE1/4 (Sec. 32-27-1E)
	top pipe	1282.48	West	804	Lat= 37.66406 Long = 97.33832
MW-3	rim	1282.07	North	129	SE1/4,SW1/4,SE1/4,SE1/4
	top pipe	1281.72	West	781	Lat= 37.66468 Long = 97.33824
MW-4	rim	1282.57	South	55	NW1/4,NW1/4,NE1/4,NE1/4 (Sec. 32-27-1E)
	top pipe	1282.23	West	1085	Lat= 37.66418 Long = 97.33929
MW-5	rim	1282.54	North	124	SW1/4,SW1/4,SE1/4,SE1/4
	top pipe	1282.32	West	1100	Lat= 37.66467 Long = 97.33934
MW-6	rim	1282.17	South	58	NE1/4,NW1/4,NE1/4,NE1/4 (Sec. 32-27-1E)
	top pipe	1281.84	West	959	Lat= 37.66417 Long = 97.33885

MAY 12 2018

Lat & Long derived existing Wichita East 7.5' quad map. WGS 84.

BUREAU OF WATER

Elevation established from City of Wichita BM. NAVD 27.

If you have any questions, please feel free to call me. Thank you for the opportunity to be of service to you.

Dennis L Handke, RLS

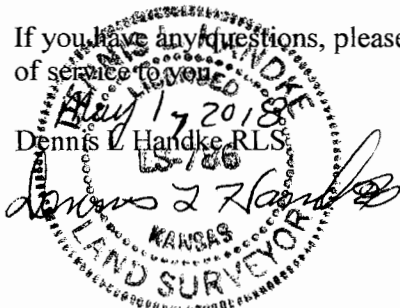

SENECA COUNTY
 sec 29 27S 1E
 SEDGWICK

NOTE: Figures exhibited within this report are only to be used within the context of this report. Placement of property lines, wells, structures, and roads is based on the available information from county appraiser maps, surveys, site visits, and/or previous vendor reports and should be considered approximate.

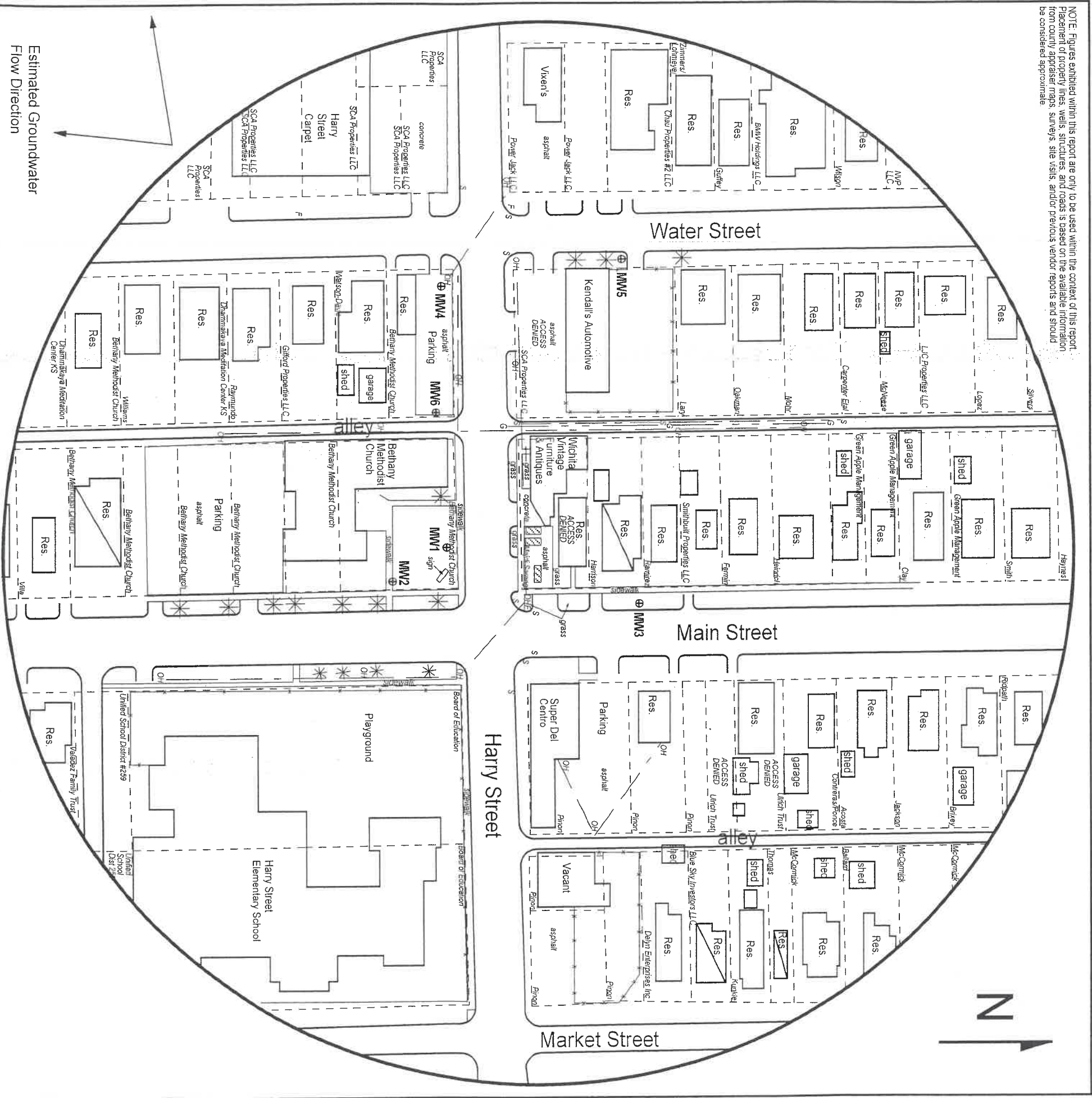

FIGURE 2.2 - 500 FT RADIUS AREA BASE MAP

1311 E 25th St., Suite B
 Lawrence, KS 66046

(785) 841-8707 office
 (785) 865-4282 fax

RECEIVED

MAY 1 2 2018

BUREAU OF WATER

PROJECT:
 Derby Station
 110 W Harry
 Wichita, KS
 KDHE ID: U2-087-12671
 Date: 4/11/18

LEGEND:

- Approximate Location of Former UST Basin
- Building with Basement
- Approximate Location of Property Line
- Monitoring Well (Installed 4/9-10/18)
- Fire Hydrant
- Gas Lines (2 - 6 ft BGS)
- Overhead Lines (25-40 ft high)
- Sanitary Sewer (2 - 6 ft BGS)

NOTE: Utility depths, heights and locations are approximate.

